

### 26. Fuel Filler Pipe

#### A: REMOVAL

##### WARNING:

- Place “NO FIRE” signs near the working area.
- Be careful not to spill fuel on the floor.

- 1) Lower the fuel pressure. <Ref. to FU(H4DOTC)-54, RELEASING OF FUEL PRESSURE, OPERATION, Fuel.>
- 2) Open the fuel filler flap lid and remove the filler cap.
- 3) Disconnect the battery ground cable.

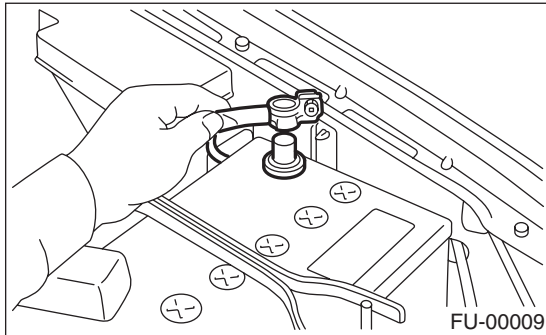

- 4) Remove the screws holding packing in place.

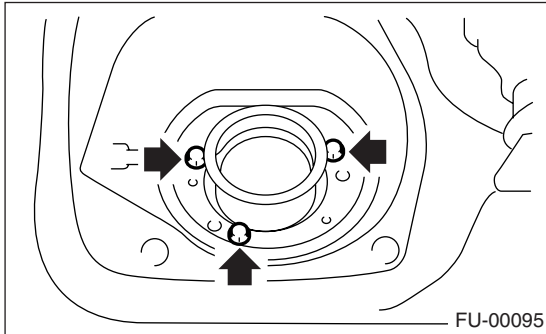

- 5) Lift-up the vehicle.
- 6) Remove the rear right side wheel nuts.
- 7) Remove the rear right side wheel.

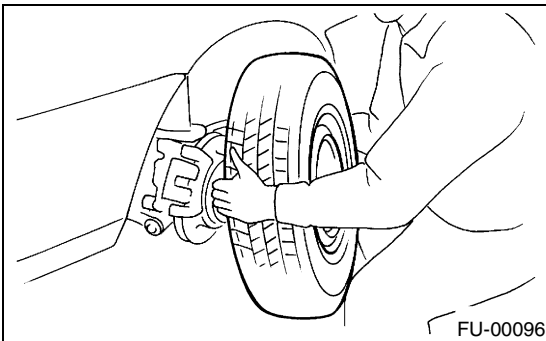

- 8) Drain the fuel from fuel tank. Set a container under the vehicle and remove the drain plug from fuel tank.

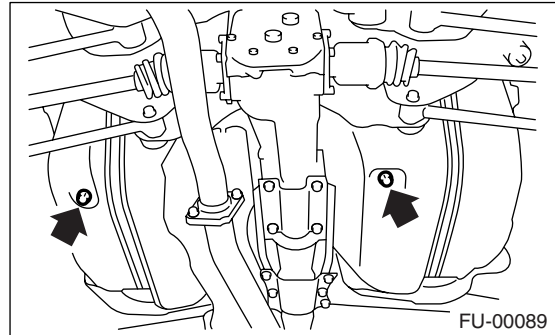

- 9) Tighten the fuel drain plug and then install the front right side tank cover.

##### Tightening torque:

**26 N·m (2.65 kgf-m, 19.2 ft-lb)**

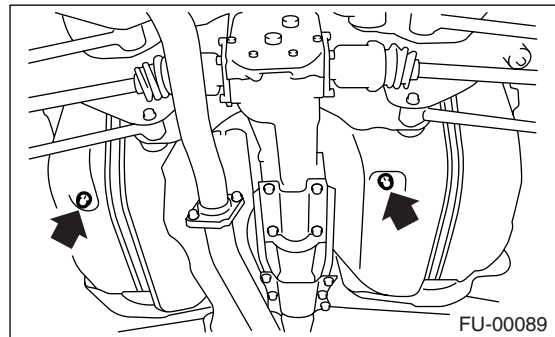

- 10) Remove the fuel filler pipe protector.

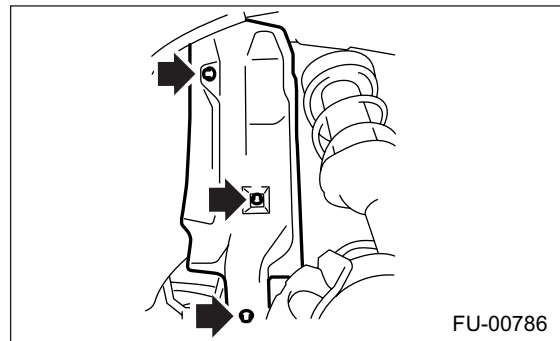

- 11) Separate the evaporation hoses from the clip of fuel filler pipe.

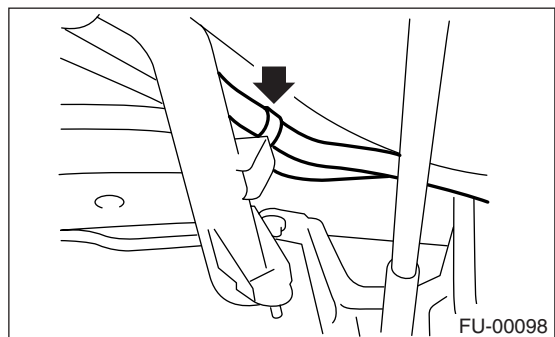

# FUEL FILLER PIPE

FUEL INJECTION (FUEL SYSTEMS)

12) Disconnect the evaporation hoses from the pipes.

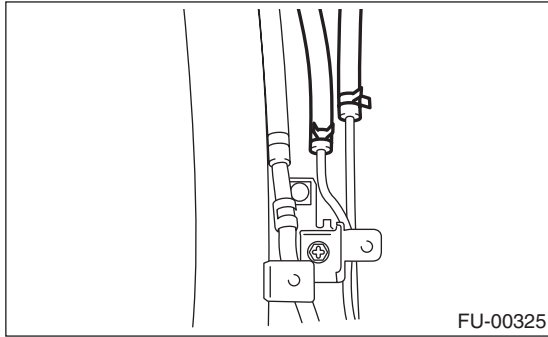

13) Remove the bolts which hold fuel filler pipe bracket on the body.

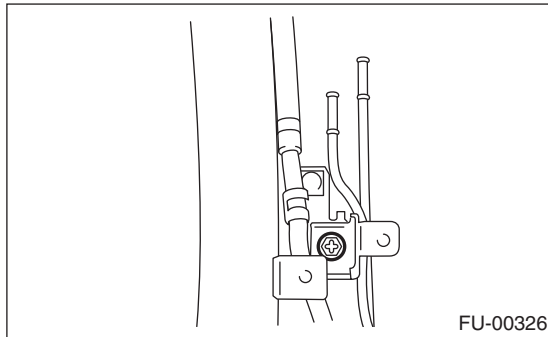

14) Loosen the clamp and separate the fuel filler hose (A) from fuel filler pipe.

15) Move the clip and separate the evaporation hose (B).

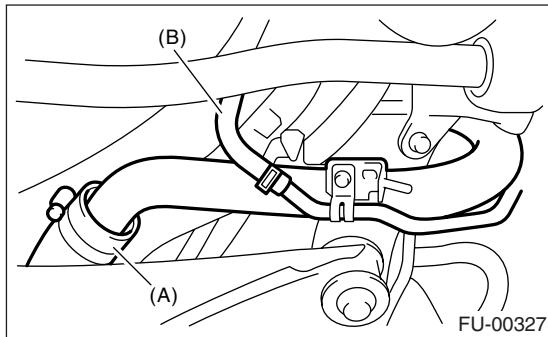

16) Remove the fuel filler pipe to under side of the vehicle.

17) Remove the air vent pipe together with clip from the body.

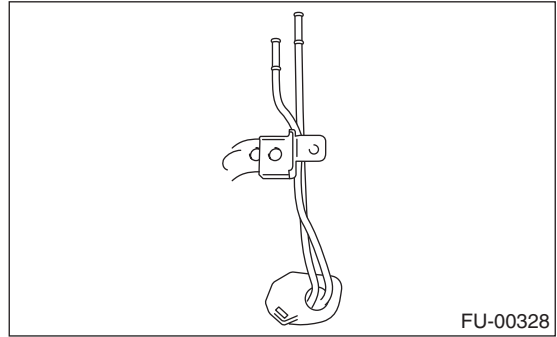

## B: INSTALLATION

1) Hold the fuel filler flap open.

2) Set the fuel saucer (A) with rubber packing (C) and insert the fuel filler pipe into the hole from the inner side of apron.

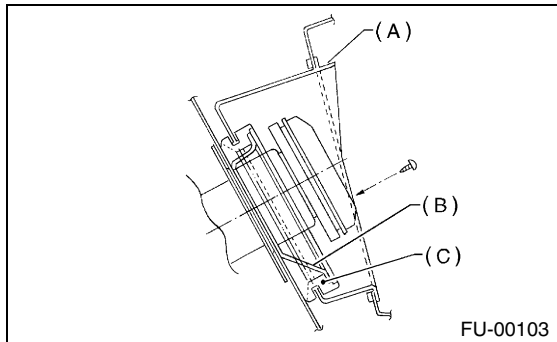

3) Align the holes in fuel filler pipe neck and set the cup (B), and tighten the screws.

### NOTE:

If edges of rubber packing are folded toward the inside, straighten it with a screwdriver.

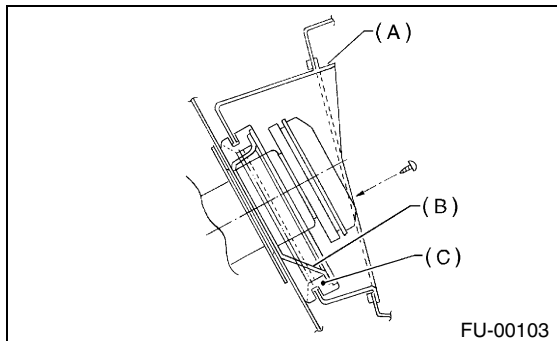

## FUEL FILLER PIPE

### FUEL INJECTION (FUEL SYSTEMS)

4) Install the evaporation pipes.

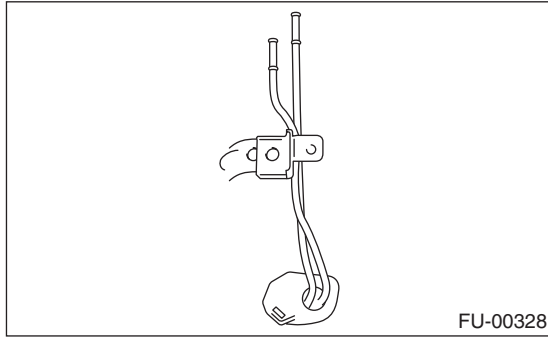

5) Connect the evaporation hose to pipes.

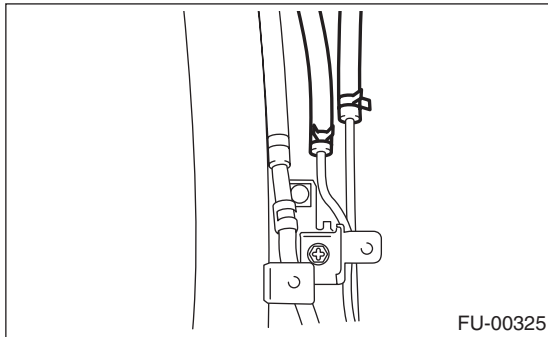

6) Insert the fuel filler hose (A) approximately 35 to 40 mm (1.38 to 1.57 in) over the lower end of fuel filler pipe and tighten the clamp.

#### CAUTION:

Do not allow clips to touch air vent hose (B) and rear suspension crossmember.

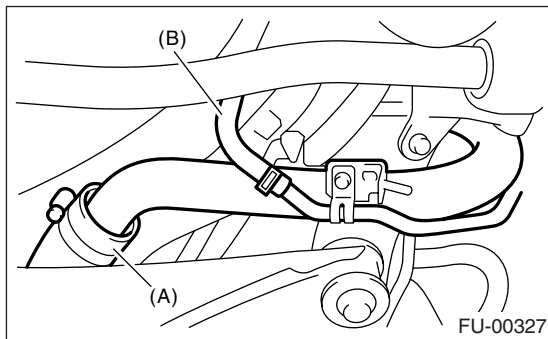

7) Insert the air vent hose approximately 25 to 30 mm (0.98 to 1.18 in) into the lower end of air vent pipe and hold clip.

$L = 27.5 \pm 2.5 \text{ mm (1.083} \pm 0.098 \text{ in)}$

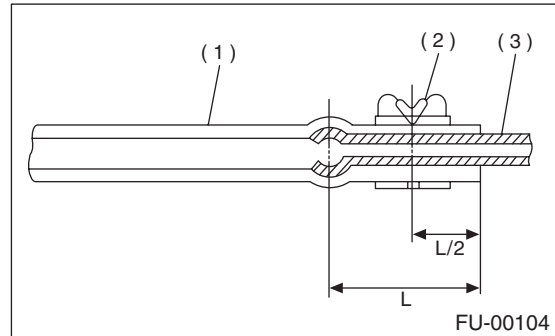

- (1) Hose
- (2) Clip
- (3) Pipe

8) Tighten the bolt which holds fuel filler pipe bracket on the body.

#### Tightening torque:

$7.4 \text{ N} \cdot \text{m (0.75 kgf} \cdot \text{m, 5.4 ft} \cdot \text{lb)}$

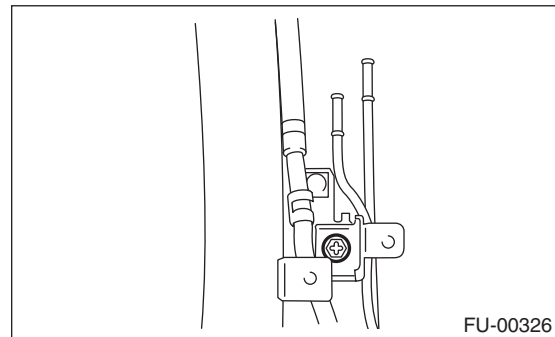

9) Tighten the bolts which hold evaporation hoses onto the clip of fuel filler pipe.

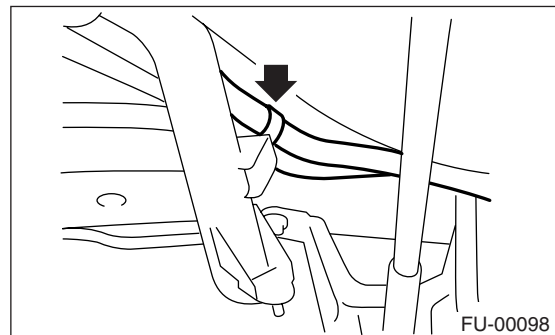

10) Install the fuel filler pipe protector.

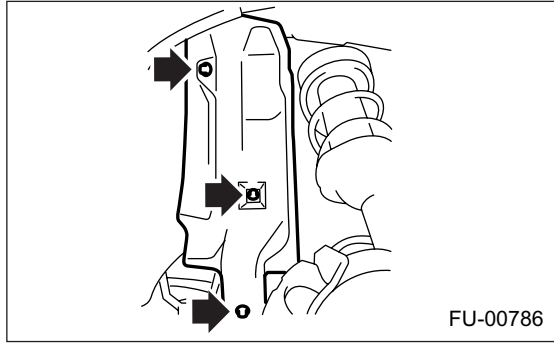

11) Install the rear right wheel.

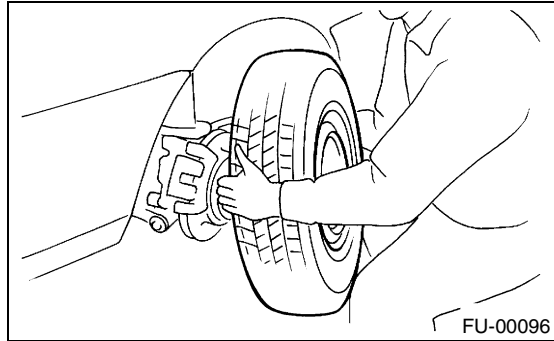

12) Lower the vehicle.

13) Tighten the wheel nuts.

14) Connect the connector to the fuel pump relay.

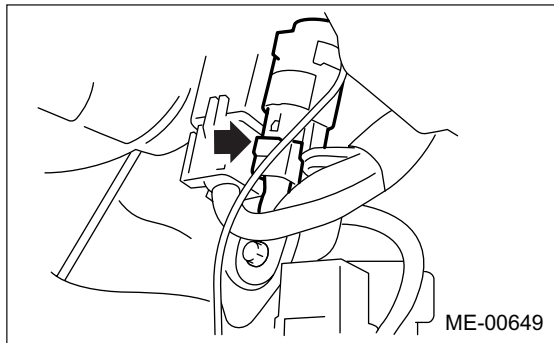

15) Connect the battery ground terminal.

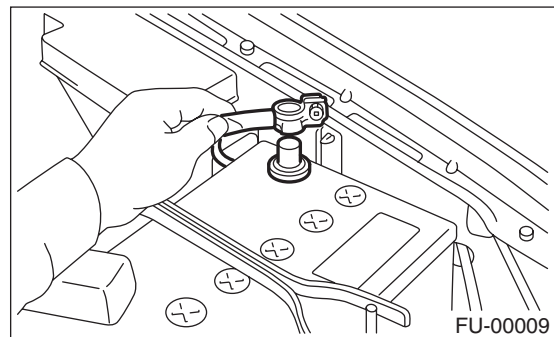

### C: DISASSEMBLY

1) Move the clip, and disconnect the evaporation hose from joint pipe.

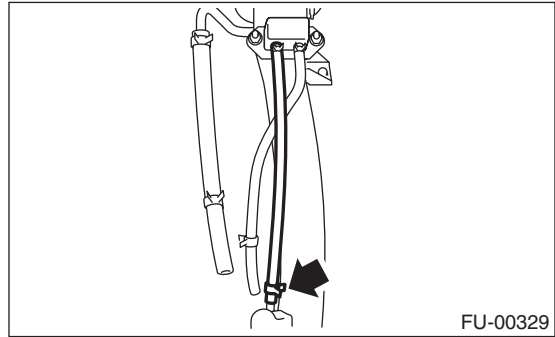

2) Remove the bolt which installs the joint pipe on fuel filler pipe.

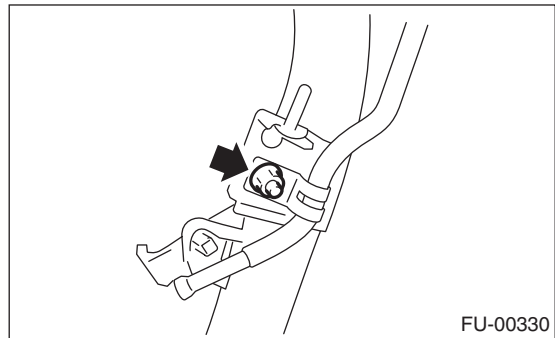

3) Disconnect the evaporation hose from the fuel filler pipe.

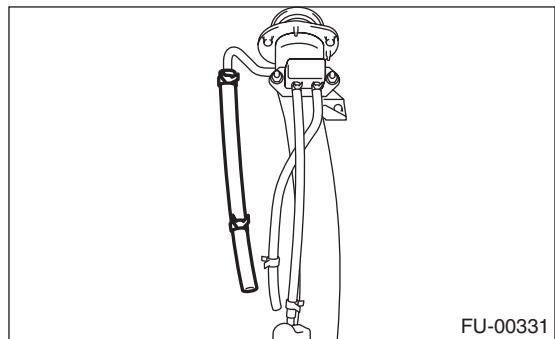

4) Remove the shut valve from the fuel filler pipe.  
<Ref. to EC(H4DOTC)-18, REMOVAL, Shut Valve.>

## FUEL FILLER PIPE

### FUEL INJECTION (FUEL SYSTEMS)

---

#### D: ASSEMBLY

1) Install the shut valve on the fuel filler pipe. <Ref. to EC(H4DOTC)-18, INSTALLATION, Shut Valve.>

2) Connect the evaporation hose to the fuel filler pipe.

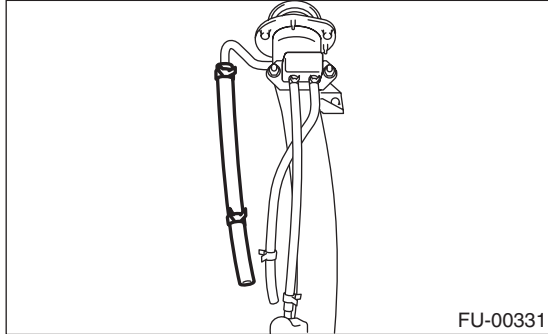

3) Connect the evaporation hose to the evaporation pipe.

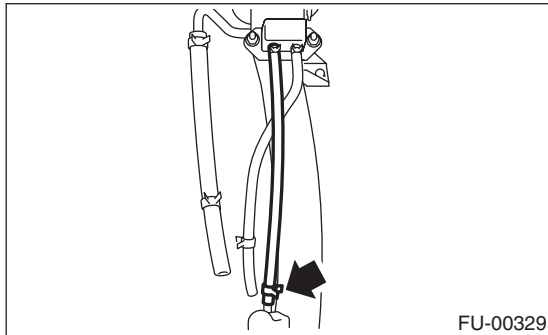

4) Install the evaporation pipe to the fuel filler pipe.

