

24.Fuel

A: OPERATION

1. RELEASING OF FUEL PRESSURE

WARNING:

- Place “NO FIRE” signs near the working area.
- Be careful not to spill fuel on the floor.

- 1) Disconnect the connector from the fuel pump relay.



- 2) Start the engine and run it until it stalls.
- 3) After the engine stalls, crank it for five more seconds.
- 4) Turn the ignition switch to OFF.

2. DRAINING FUEL

WARNING:

- Place “NO FIRE” signs near the working area.
- Be careful not to spill fuel on the floor.

- 1) Set the vehicle on the lift.
- 2) Disconnect the battery ground cable.

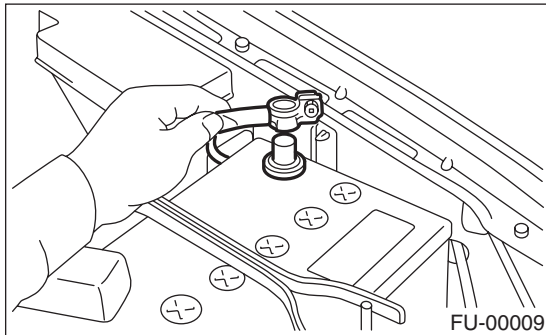

- 3) Lift-up the vehicle.
- 4) Drain the fuel from the fuel tank. Set a container under the vehicle and remove drain plug from the fuel tank.

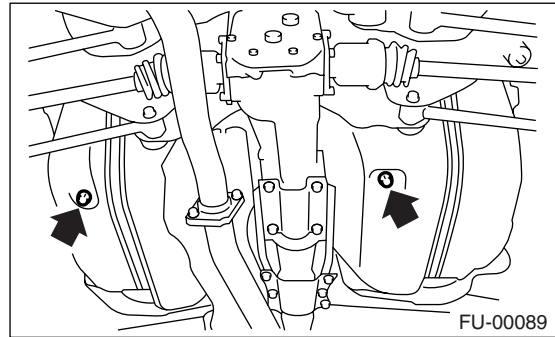

- 5) Tighten the fuel drain plug.

Tightening torque:

26 N·m (2.65 kgf-m, 19.2 ft-lb)

