

# PURGE CONTROL SOLENOID VALVE

EMISSION CONTROL (AUX. EMISSION CONTROL DEVICES)

## 6. Purge Control Solenoid Valve

### A: REMOVAL

- 1) Disconnect the ground terminal from battery.

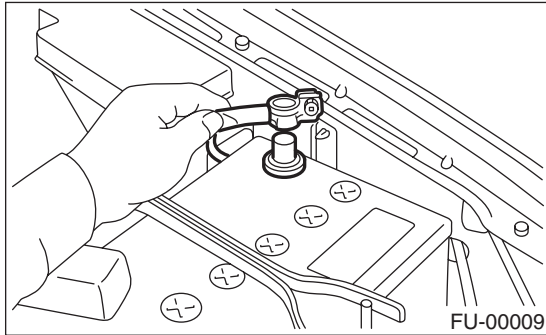

- 2) Disconnect the connector and hoses from purge control solenoid valve.
- 3) Remove the bolt which installs the purge control solenoid valve onto intake manifold.

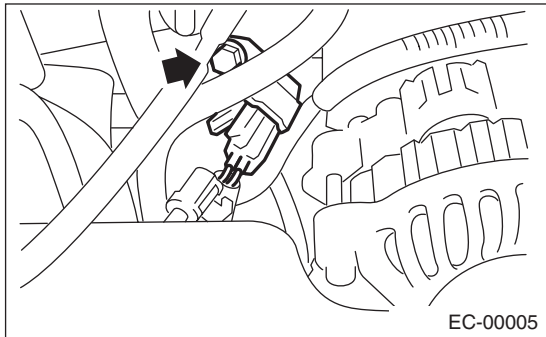

### B: INSTALLATION

Install in the reverse order of removal.

**Tightening torque:**

**16 N·m (1.6 kgf-m, 11.6 ft-lb)**

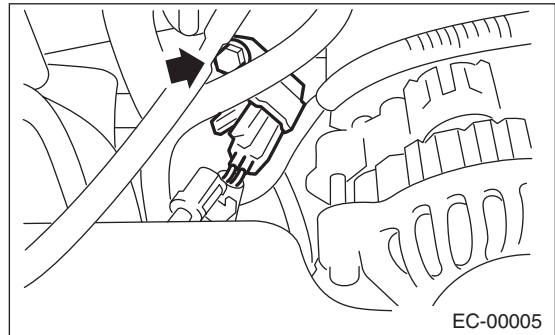

### CAUTION:

**Carefully connect the evaporation hoses.**

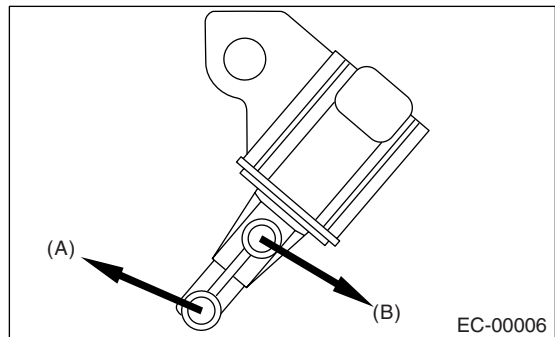

(A) To intake manifold

(B) To purge value

### C: INSPECTION

Make sure the hoses are not cracked or loose.