

2. Accelerator Pedal

A: REMOVAL

- 1) Disconnect the ground cable from battery.
- 2) Remove the lock nut from accelerator cable bracket.
- 3) Separate the accelerator cable from bracket.
- 4) Remove the accelerator cable end from throttle cam.

NOTE:

Be careful not to kink the accelerator cable.

• Non-turbo model

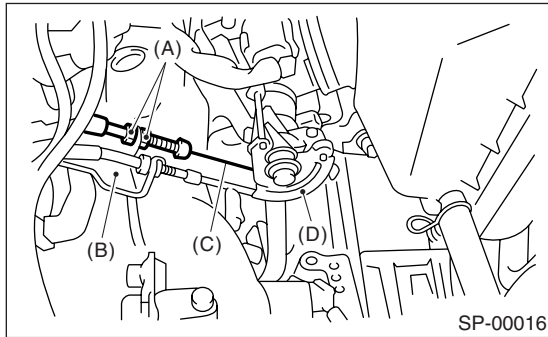

• Turbo model

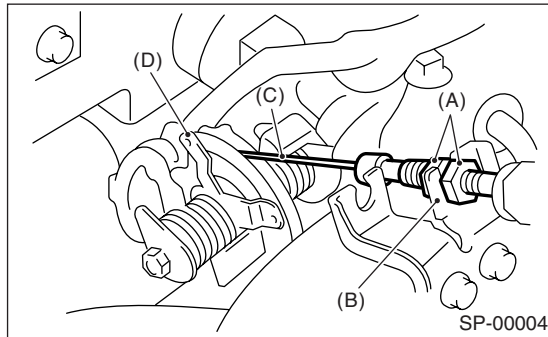

- (A) Lock nut
- (B) Accelerator cable bracket
- (C) Accelerator cable
- (D) Throttle cam

- 5) Remove the clip inside engine compartment.

• Non-turbo model

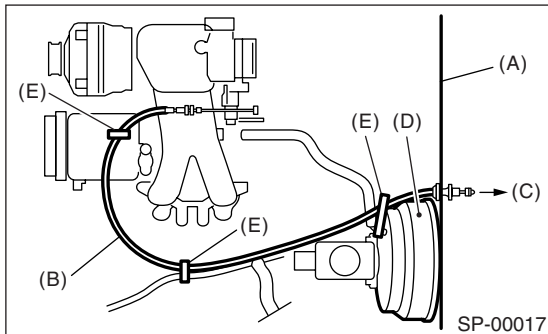

• Turbo model

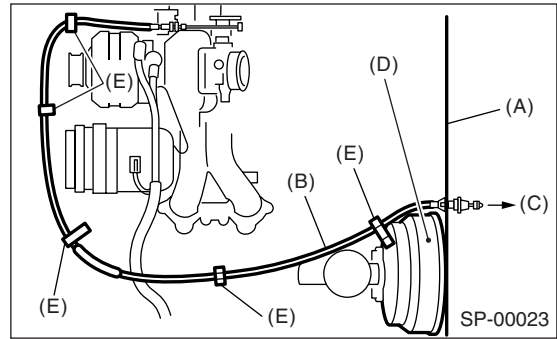

- (A) Toe board
- (B) Accelerator cable
- (C) To accelerator pedal
- (D) Brake booster
- (E) Clip

- 6) Remove the instrument panel lower cover from instrument panel.

- 7) Remove the accelerator pedal connecting bolt from accelerator pedal bracket.

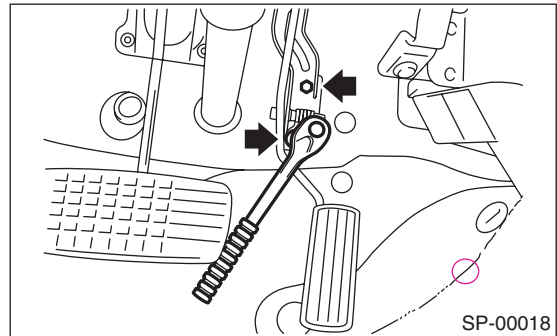

- 8) Disconnect the grommet from toe board.

NOTE:

From the engine compartment side, push the grommet (A) into hole.

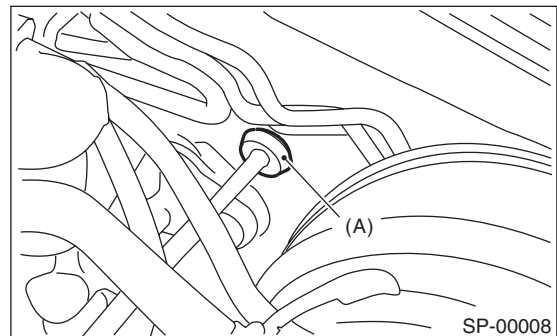

- 9) Pull out the cable from toe board hole.

ACCELERATOR PEDAL

SPEED CONTROL SYSTEMS

10) Disconnect the accelerator cable bushing from accelerator pedal lever.

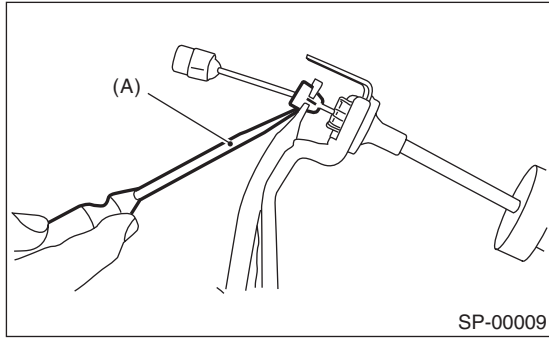

(A) Flat tip screwdriver

11) Disconnect the accelerator cable stopper (A) from bracket.

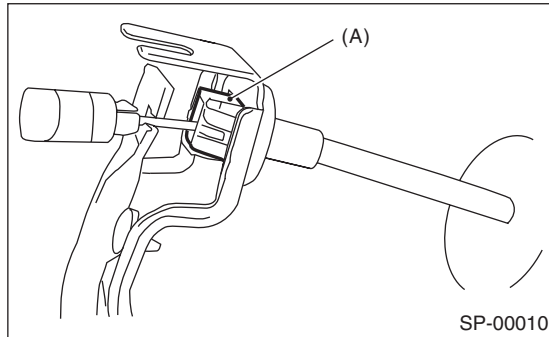

12) Separate the accelerator cable and bracket.

B: INSTALLATION

1) Install in the reverse order of removal.

NOTE:

- If the cable clamp is damaged, replace it with a new one.
- Never fail to cover the outer cable end with boot.
- Be careful not to kink the accelerator cable.

2) Install the pedal and then adjust it. <Ref. to SP(H4SO)-5, ADJUSTMENT, Accelerator Pedal.>

C: DISASSEMBLY

- 1) Remove the clip, and then remove the accelerator pedal lever from bracket.
- 2) Pull out the spring pin, and then remove the accelerator pedal from accelerator pedal lever.

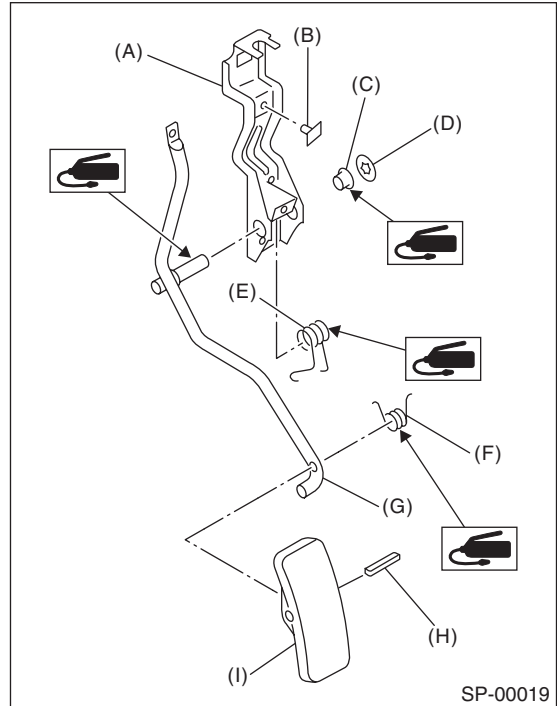

- (A) Accelerator bracket
- (B) Stopper
- (C) Bushing
- (D) Clip
- (E) Accelerator spring
- (F) Accelerator pedal spring
- (G) Accelerator pedal lever
- (H) Spring pin
- (I) Accelerator pedal

D: ASSEMBLY

Assemble in the reverse order of disassembly .

NOTE:

Clean and apply grease to the portions indicated in the figure.

Grease:

Part No. 003602010

SUNLIGHT No.2 or equivalent

E: INSPECTION

- 1) Lightly move the pedal pad in lateral direction to ensure that pedal deflection is within the specified range.
- 2) If excessive deflection is noted, replace the bushing and clip with new ones.

Deflection of accelerator pedal:

Service limit

$\pm 2.0 \text{ mm } (\pm 0.079 \text{ in})$ or less

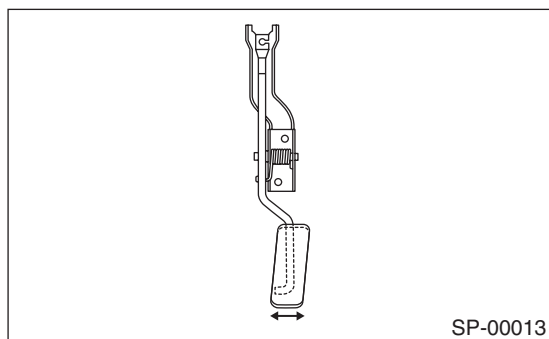

F: ADJUSTMENT

- 1) Check the pedal stroke and free play by operating accelerator pedal by hand.
- 2) If it is not within the specified values, adjust it by turning the accelerator cable locknut.

Free play at pedal pad: L

$0 - 4 \text{ mm } (0 - 0.16 \text{ in})$

Stroke at pedal pad: A

$52 - 57 \text{ mm } (2.05 - 2.24 \text{ in})$

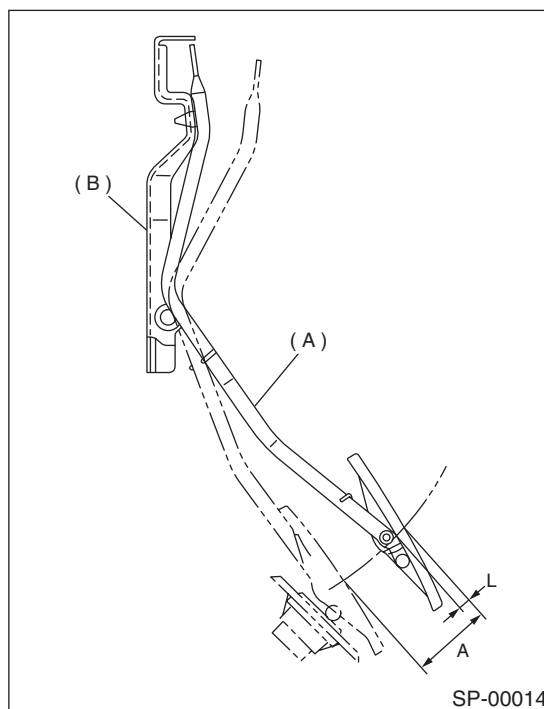

(A) Accelerator pedal

(B) Accelerator pedal bracket

Accelerator cable lock nut tightening torque:

$12 \text{ N}\cdot\text{m } (1.2 \text{ kgf}\cdot\text{m}, 9 \text{ ft}\cdot\text{lb})$