

IDLE AIR CONTROL SOLENOID VALVE

FUEL INJECTION (FUEL SYSTEMS)

11. Idle Air Control Solenoid Valve

A: REMOVAL

- 1) Disconnect the ground cable from battery.

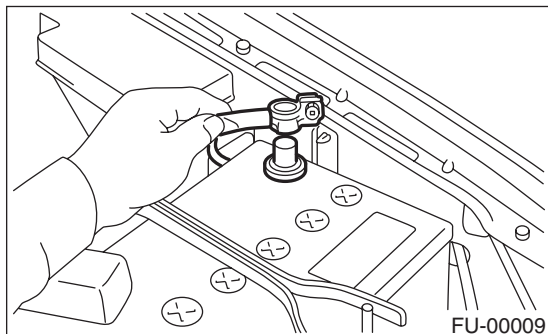

- 2) Disconnect the connector from idle air control solenoid valve.

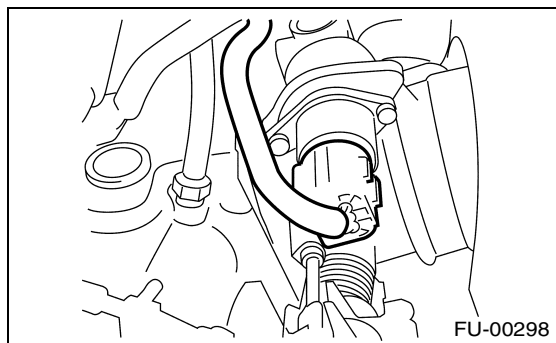

- 3) Remove the idle air control solenoid valve from throttle body.

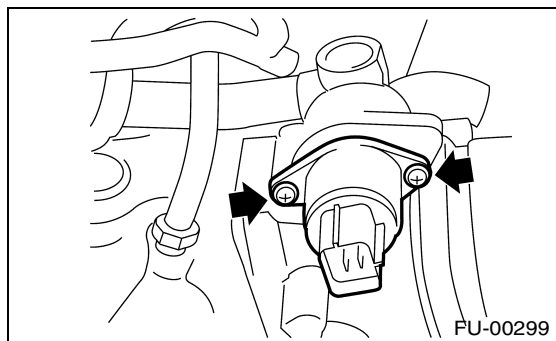

B: INSTALLATION

Install in the reverse order of removal.

NOTE:

Replace the gaskets with new ones.

Tightening torque:

1.6 N·m (0.16 kgf-m, 1.2 ft-lb)

