

# PURGE CONTROL SOLENOID VALVE

EMISSION CONTROL (AUX. EMISSION CONTROL DEVICES)

## 5. Purge Control Solenoid Valve

### A: REMOVAL

1) Disconnect the ground cable from battery.

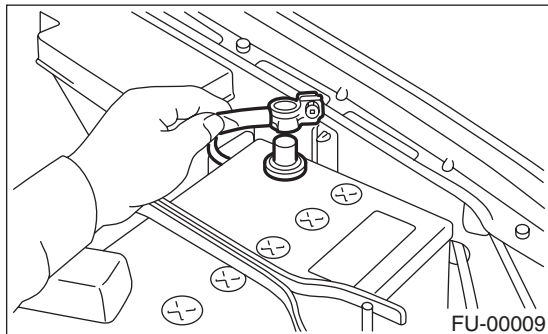

2) Remove the bolt which installs purge control solenoid valve onto intake manifold.

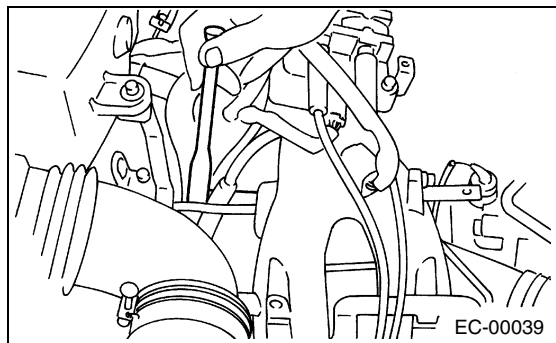

3) Take out purge control solenoid valve through the bottom of the intake manifold.

4) Disconnect the connector and hoses from purge control solenoid valve.

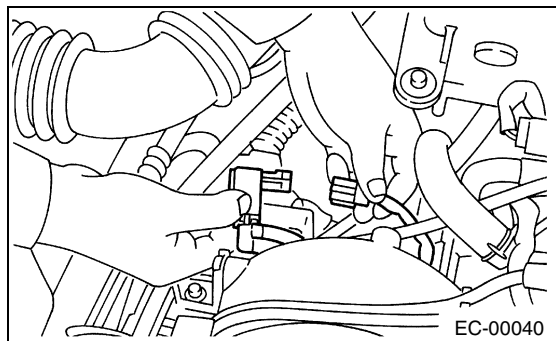

### B: INSTALLATION

Install in the reverse order of removal.

**Tightening torque:**

**19 N·m (1.9 kgf-m, 14.0 ft-lb)**

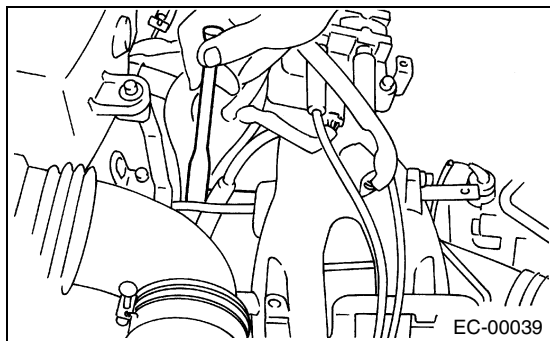

**NOTE:**

Connect the evaporation hose as shown in the following figure.

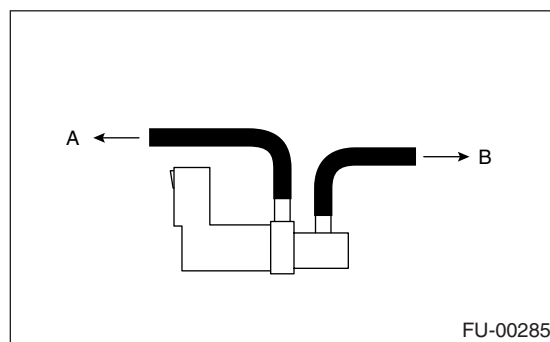

(A) To fuel pipe

(B) To intake manifold

### C: INSPECTION

Make sure the hoses are not cracked or loose.