

## DRAIN VALVE

EMISSION CONTROL (AUX. EMISSION CONTROL DEVICES)

### 15.Drain Valve

#### A: REMOVAL

- 1) Set the vehicle on a lift.
- 2) Disconnect the ground cable from battery.

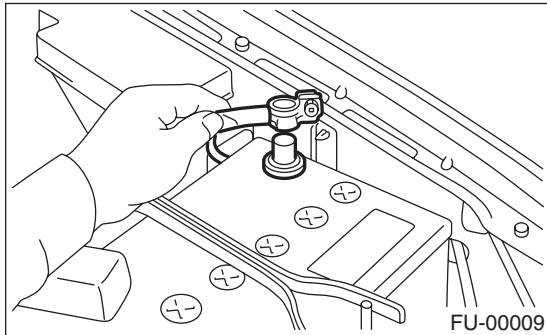

- 3) Lift up the vehicle.
- 4) Remove the canister. <Ref. to EC(H4SO)-5, REMOVAL, Canister.>
- 5) Disconnect the connector from drain valve.

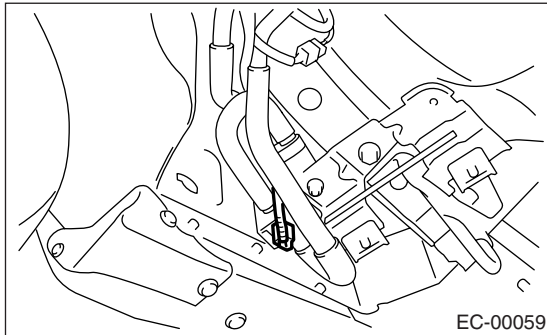

- 6) Disconnect the evaporation hoses (A) from joint pipes.

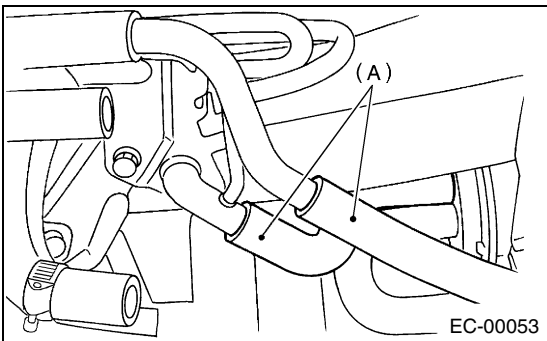

- 7) Remove the bolt which installs the drain filter and drain valve brackets on body, and remove them as a unit.

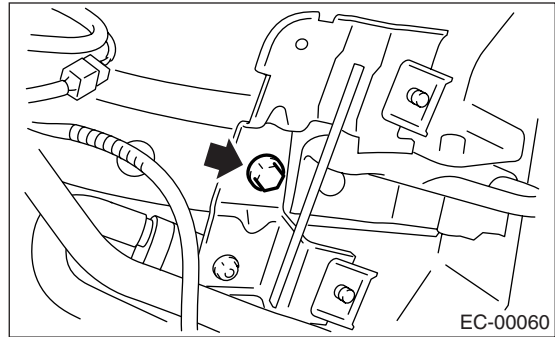

- 8) Disconnect the evaporation hoses from drain valve.
- 9) Remove the nuts, and then remove the drain valve.

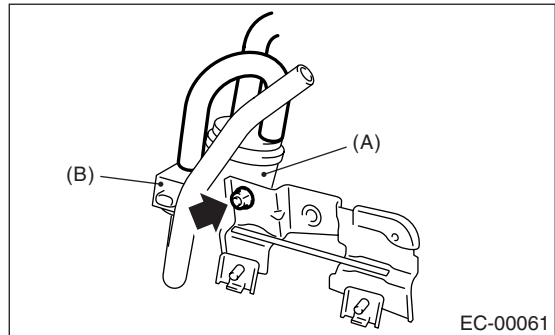

- (A) Drain filter  
(B) Drain valve

## DRAIN VALVE

EMISSION CONTROL (AUX. EMISSION CONTROL DEVICES)

### B: INSTALLATION

Install in the reverse order of removal.

**Tightening torque:**

**23 N·m (2.3 kgf-m, 16.6 ft-lb)**

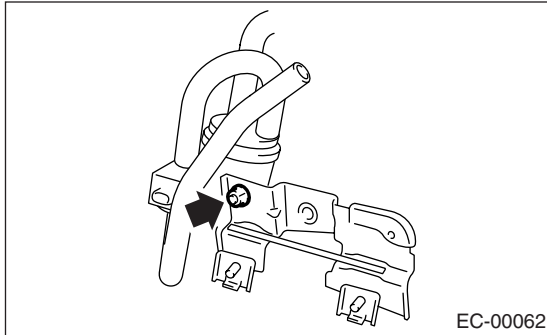

**Tightening torque:**

**33 N·m (3.4 kgf-m, 25 ft-lb)**

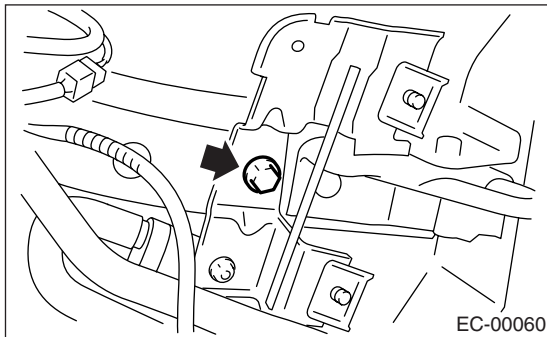

### C: INSPECTION

- 1) Make sure all hoses are installed correctly.
- 2) Make sure the hoses are not cracked or loose.

## **DRAIN VALVE**

EMISSION CONTROL (AUX. EMISSION CONTROL DEVICES)

---