

# RESERVOIR TANK

POWER ASSISTED SYSTEM (POWER STEERING)

## 8. Reservoir Tank

### A: REMOVAL

#### 1. NON-TURBO MODEL

- 1) Remove the air intake duct. <Ref. to IN(H4SO)-7, REMOVAL, Air Intake Duct.>
- 2) Drain the fluid from the reservoir tank.
- 3) Disconnect the pipe D from the return hose and suction hose from the oil pump.

#### CAUTION:

- Do not allow fluid from the hose end to come into contact with pulley belt.
- To prevent foreign matter from entering the hose and pipe, cover the open ends of them with a clean cloth.

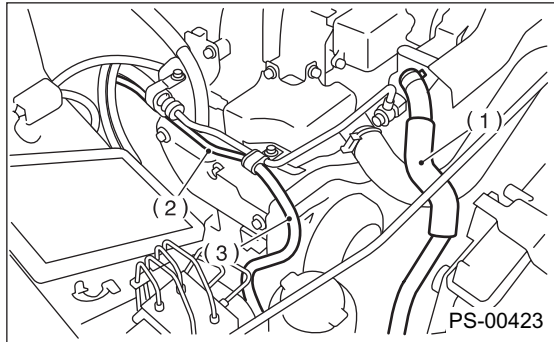

- (1) Suction hose
- (2) Pipe D
- (3) Return hose

- 4) Remove the reservoir tank from the bracket by pulling it upwards.

#### 2. TURBO MODEL

- 1) Remove the air intake duct. <Ref. to IN(H4DOTC)-10, REMOVAL, Intake Duct.>
- 2) Drain the fluid from the reservoir tank.

- 3) Disconnect the return hose and suction hose from the reservoir tank.

#### CAUTION:

- Do not allow fluid from the hose end to come into contact with pulley belt.
- To prevent foreign matter from entering the hose, cover the open ends of them with a clean cloth.

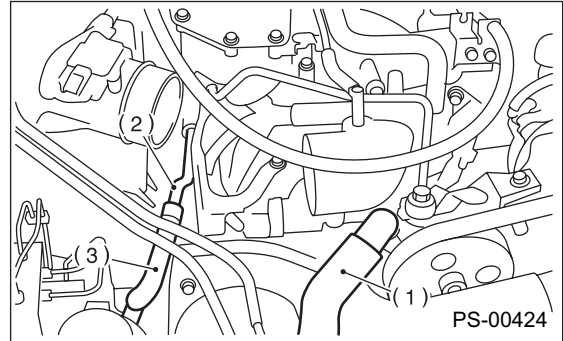

- (1) Suction hose
- (2) Pipe D
- (3) Return hose

- 4) Remove the reservoir tank from the bracket by pulling it upwards.

### B: INSTALLATION

#### 1. NON-TURBO MODEL

- 1) Install the reservoir tank to the bracket.
- 2) Connect the pipes D to the return hose and suction hose to the oil pump.

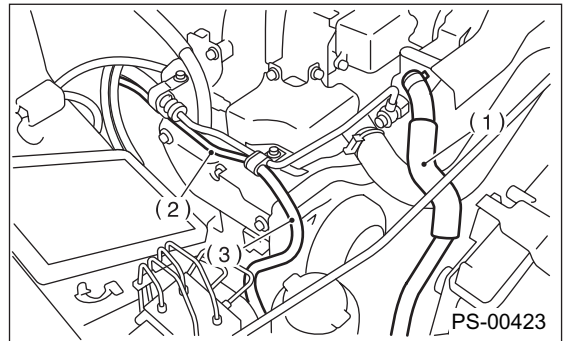

- (1) Suction hose
- (2) Pipe D
- (3) Return hose

- 3) Feed the specified power steering fluid. <Ref. to PS-71, Power Steering Fluid.>

# RESERVOIR TANK

## POWER ASSISTED SYSTEM (POWER STEERING)

---

### 2. TURBO MODEL

- 1) Install the reservoir tank to the bracket.
- 2) Connect the pressure hose and suction hose to the oil pump.

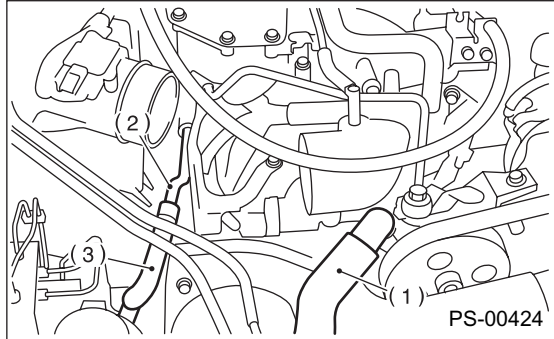

- (1) Suction hose
- (2) Pipe D
- (3) Return hose

- 3) Feed the specified power steering fluid. <Ref. to PS-71, Power Steering Fluid.>

### C: INSPECTION

Check the reservoir tank for cracks, breakage, or damage. If any cracks, breakage, or damage is found, replace the reservoir tank.