

UNIVERSAL JOINT

POWER ASSISTED SYSTEM (POWER STEERING)

3. Universal Joint

A: REMOVAL

- 1) Remove the steering wheel. <Ref. to PS-18, REMOVAL, Steering Wheel.>
- 2) Remove the universal joint bolts and then remove the universal joint.

CAUTION:

Scribe alignment marks on universal joint so that it can be reassembled at the original serration.

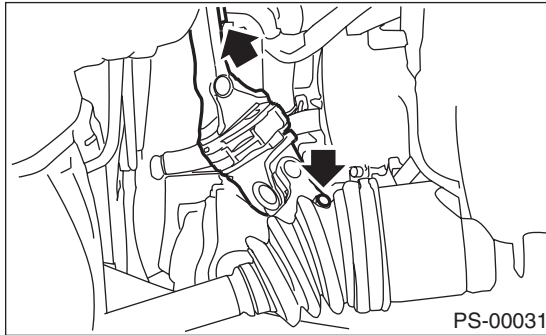

B: INSTALLATION

- 1) Install the universal joint.
 - (1) Align the cutout at serrated section of the column shaft and yoke, then insert the universal joint into the column shaft.

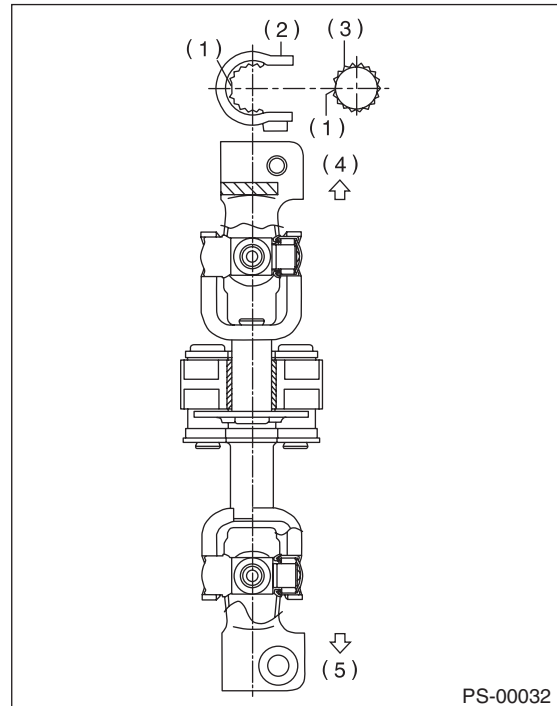

- (1) Cutout
- (2) Yoke
- (3) Column shaft
- (4) Column shaft side
- (5) Gearbox side

- (2) Align the bolt hole on the gearbox side of universal joint with the cutout at the serrated section of gearbox assembly. Lower the universal joint completely.

- (3) Temporarily tighten the bolt on the gearbox side. Raise the universal joint to make sure the bolt is properly passing through the cutout at the serrated section.

- (4) Tighten the bolt.

Tightening torque:

24 N·m (2.4 kgf-m, 17.4 ft-lb)

CAUTION:

- Make sure that universal joint bolt is tightened through notch in shaft serration.
- Excessively large tightening torque of universal joint bolts may lead to heavy steering wheel operation.

Standard clearance between gearbox to DOJ:

Over 14 mm (0.55 in)

UNIVERSAL JOINT

POWER ASSISTED SYSTEM (POWER STEERING)

2) Align the center of roll connector. <Ref. to AB-17, ADJUSTMENT, Roll Connector.>

CAUTION:

Ensure that front wheel are set straight forward direction.

3) Install the steering wheel and airbag module. <Ref. to PS-18, INSTALLATION, Steering Wheel.>

WARNING:

Always refer to “Air Bag System” before performing airbag module service. <Ref. to AB-12, CAUTION, Driver's Airbag Module.> and <Ref. to AB-12, INSTALLATION, Driver's Airbag Module.>

UNIVERSAL JOINT

POWER ASSISTED SYSTEM (POWER STEERING)

C: INSPECTION

Clean the disassembled parts with a cloth, and check for wear, damage, or any other faults. If necessary, repair or replace faulty parts.

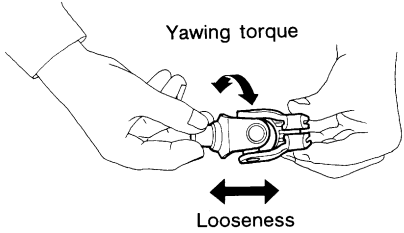
Inspection	Corrective action
<ul style="list-style-type: none"> Free play Swinging torque Yawing torque Looseness  <p>PS-00366</p> <p>Standard value of universal joint free play: 0 mm (0 in) Max. value of universal joint swinging torque: 0.3 N·m (0.03 kgf·m, 0.2 ft·lb)</p>	<p>Replace if faulty.</p>

Measurement of folding torque of universal joint is as shown in the figures.

Service limit:

Maximum load; 7.3 N (0.74 kgf, 1.64 lb) or less

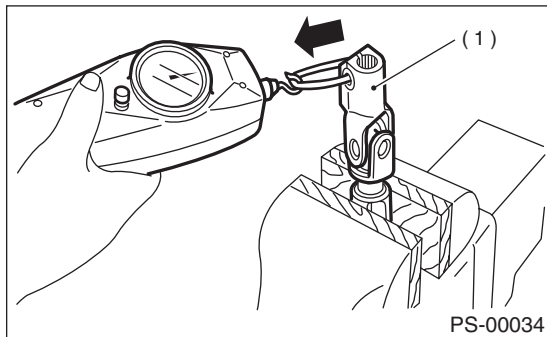

(1) Yoke (gearbox side)

Service limit:

Maximum load; 7.3 N (0.74 kgf, 1.64 lb) or less

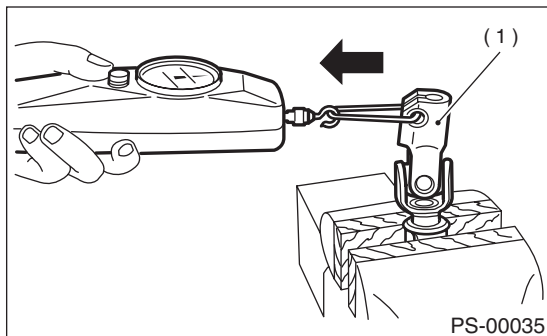

(1) Yoke (gearbox side)

Service limit:

Maximum load; 7.3 N (0.74 kgf, 1.64 lb) or less

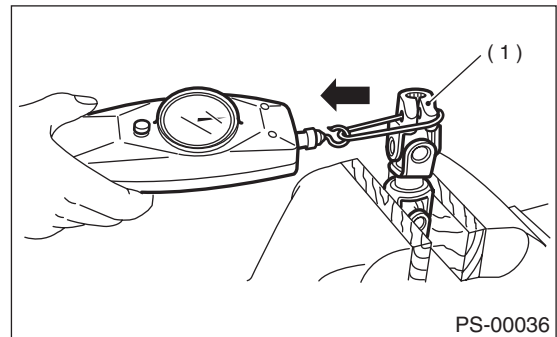

(1) Yoke (Steering column side)

Service limit:

Maximum load; 7.3 N (0.74 kgf, 1.64 lb) or less

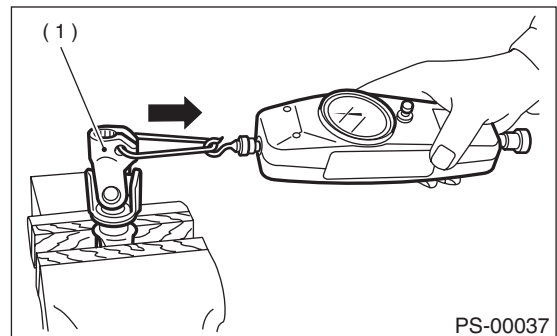

(1) Yoke (Steering column side)