

10. Rear Drum Brake Assembly

A: REMOVAL

- 1) Loosen the wheel nuts, jack-up the vehicle, support it with rigid racks, and remove the wheel.
- 2) Release the parking brake.
- 3) Remove the brake drum from brake assembly. <Ref. to BR-30, REMOVAL, Rear Drum Brake Drum.>
- 4) Remove the brake shoe. <Ref. to BR-28, REMOVAL, Rear Drum Brake Shoe.>
- 5) Unscrew the brake hose flare nut and disconnect the brake hose.

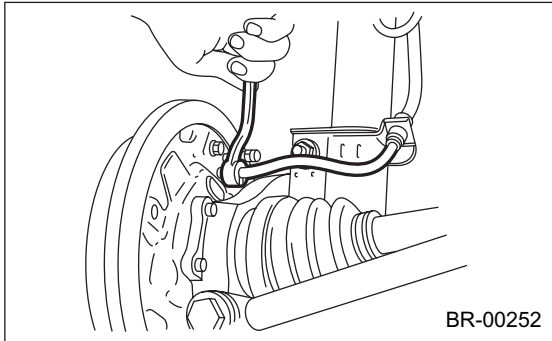

- 6) Remove the hub. <Ref. to DS-23, REMOVAL, Rear Axle.>
- 7) Disconnect the ABS sensor from back plate. (only vehicle equipped ABS)
- 8) Remove the brake assembly.

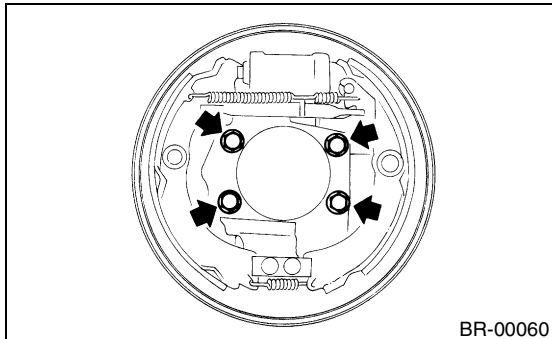

- 9) Remove the bolts installing the wheel cylinder on back plate, and remove it.

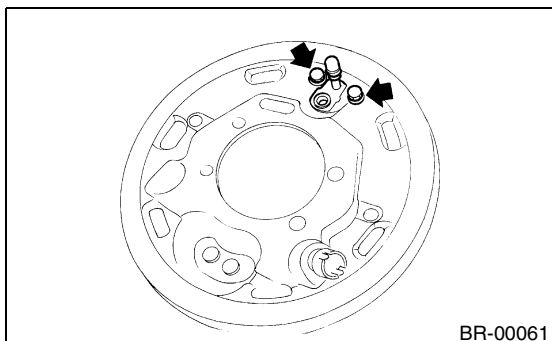

B: INSTALLATION

- 1) Clean the back plate and wheel cylinder.
- 2) Install the wheel cylinder on back plate, and tighten bolts.

Tightening torque:

10 N·m (1.0 kgf-m, 7.2 ft-lb)

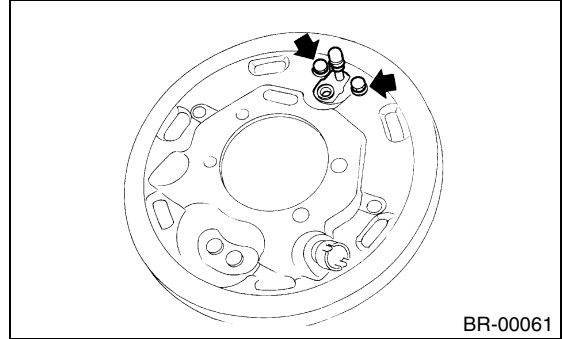

- 3) Apply grease to the portions indicated by arrows in Figure.

Brake grease:

Dow Corning Molykote No. 7439 (Part No. 725191460)

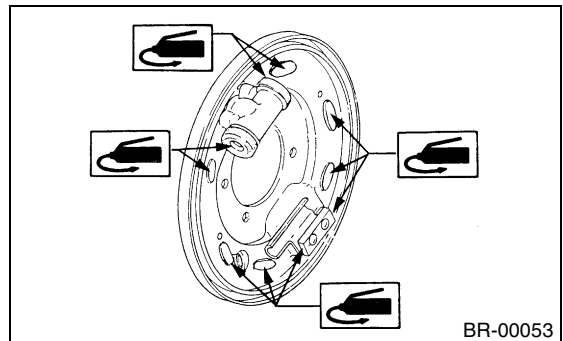

REAR DRUM BRAKE ASSEMBLY

BRAKE

4) Install the brake assembly on housing, and tighten the bolts to install back plate.

Tightening torque:

53 N·m (5.4 kgf-m, 39.1 ft-lb)

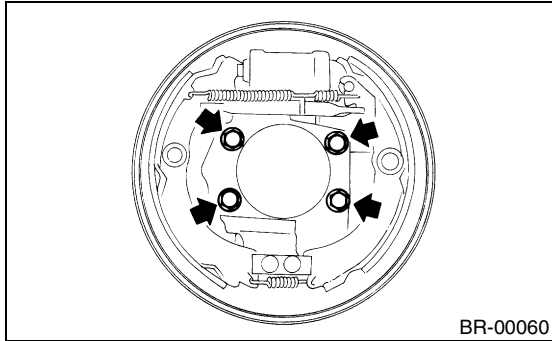

5) Install the hub. <Ref. to DS-26, INSTALLATION, Rear Axle.>

6) Connect the brake hose, and tighten the brake hose flange nut.

Tightening torque:

15 N·m (1.5 kgf-m, 10.8 ft-lb)

7) Connect the ABS sensor to back plate. (only vehicle equipped with ABS)

Tightening torque:

32 N·m (3.3 kgf-m, 24 ft-lb)

8) Apply grease to the adjusting screw and both ends of adjuster.

Brake grease:

Dow Corning Molykote No. 7439 (Part No. 725191460)

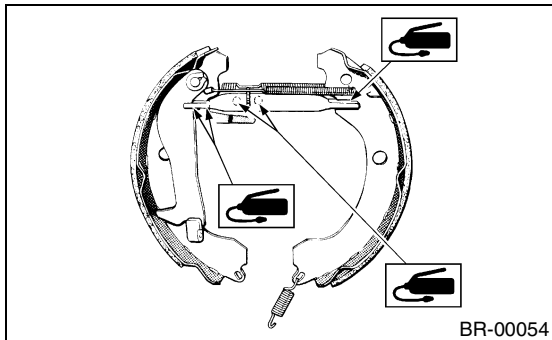

9) Install the brake shoe. <Ref. to BR-29, INSTALLATION, Rear Drum Brake Shoe.>

10) Install brake drum. <Ref. to BR-30, INSTALLATION, Rear Drum Brake Drum.>

11) After installing brake assembly, bleed air from brake line. <Ref. to BR-44, Air Bleeding.>

C: DISASSEMBLY

1) Remove the right and left dust boots from wheel cylinder.

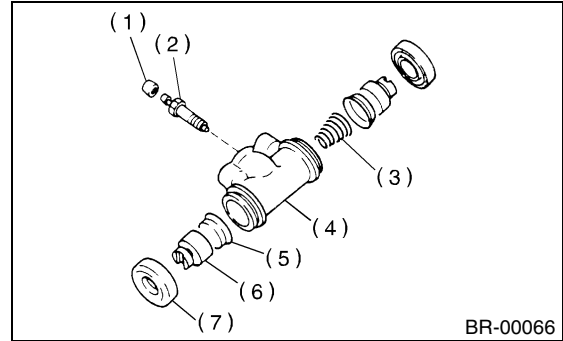

- (1) Bleeder cap
- (2) Bleeder screw
- (3) Spring
- (4) Cylinder
- (5) Cup
- (6) Piston
- (7) Boot

2) Remove the piston, cup, spring and air bleeder screw and cap.

D: ASSEMBLY

1) Clean all parts with brake fluid. Check and replace faulty parts.

- Cup and boot for damage or fatigue
- Cylinder, piston and spring or damage or rust formation

2) Assemble in the reverse order of disassembly.

(1) When installing the cup, use ST, apply brake fluid to the frictional surface for smooth installation and pay attention to cup direction.

(2) STs are available in different sizes.

CAUTION:

- When replacing the repair kit, make sure that the sizes of cylinder and cup are the same as those which were replaced.
- Use only the tool of the correct size.

ST: ADAPTER	
Applicable size	Part No.
19.0 mm (3/4 in)	926460000

CAUTION:

While assembling, be careful to prevent any metal chip, dust or dirt from entering the wheel cylinder.

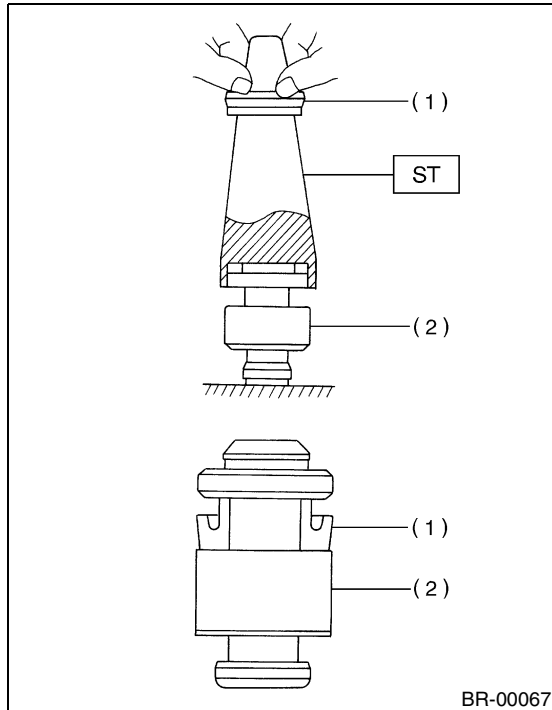

- (1) Cup
(2) Piston

3) Apply rubber grease to the boot inside as shown in figure.

CAUTION:

Never use brake grease.

Grease:

NIGLUBE RX-2 (Part No. 003606000)

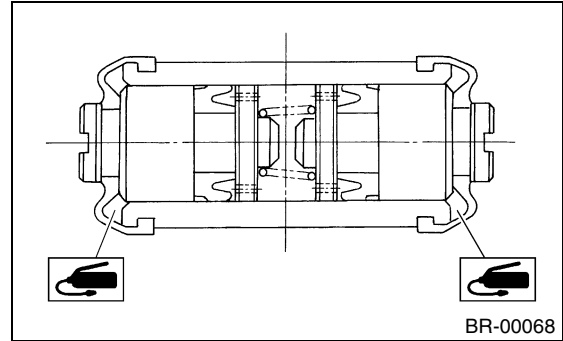

E: INSPECTION

1) Inspect the wheel cylinder for leakage.

2) If the deformation or wear of back plate, shoe, etc. are notable, replace them.