

8. G Sensor

A: REMOVAL

- 1) Disconnect the ground terminal from battery.

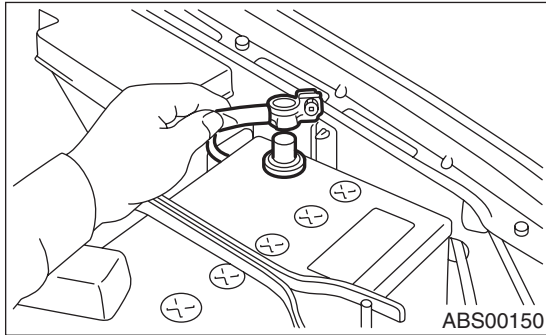

- 2) Remove the console cover.
<Ref. to EI-42, Console Box.>
- 3) Disconnect the connector from G sensor.
- 4) Remove the G sensor from body.

CAUTION:

- Do not drop or bump the G sensor.
- Do not disassemble the G sensor and bracket.

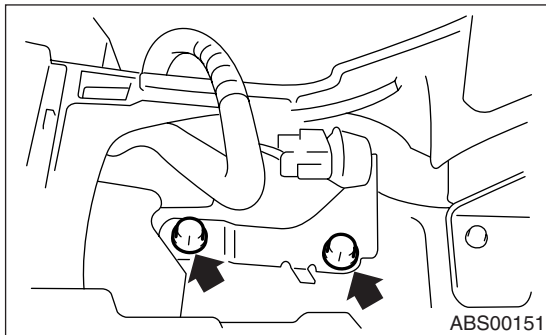

B: INSTALLATION

- 1) Install in the reverse order of removal.

CAUTION:

Do not drop or bump the G sensor.

Tightening torque (G sensor):

18 N·m (1.8 kgf-m, 13 ft-lb)

C: INSPECTION

Step	Check	Yes	No
1	Do you have the SUBARU SELECT MONITOR?	Go to step 5.	Go to step 2.
2	CHECK G SENSOR. 1) Turn the ignition switch to OFF. 2) Remove the G sensor from vehicle. 3) Connect the connector to G sensor. 4) Turn the ignition switch to ON. 5) Measure the voltage between G sensor connector terminals. Connector & terminal: (B292) No. 2 (+) — No. 3 (–) Is the voltage within specified values when the G sensor is horizontal?	Between 2.1 and 2.5V Go to step 3.	Replace G sensor.
3	CHECK G SENSOR. Measure the voltage between G sensor connector terminals. Connector & terminal: (B292) No. 2 (+) — No. 3 (–) Is the voltage within specified values when the G sensor is inclined forwards to 90°?	Between 3.7 and 4.1V Go to step 4.	Replace G sensor.
4	CHECK G SENSOR. Measure the voltage between G sensor connector terminals. Connector & terminal: (B292) No. 2 (+) — No. 3 (–) Is the voltage within specified values when the G sensor is inclined backwards to 90°?	Between 0.5 and 0.9V G sensor is normal.	Replace G sensor.
5	CHECK G SENSOR. 1) Turn the ignition switch to OFF. 2) Connect the select monitor connector to data link connector. 3) Turn the select monitor into {BRAKE CONTROL} mode. 4) Set the display in the {Current Data Display & Save} mode. 5) Read the G sensor output voltage. Is the indicated reading within specified values when the vehicle is in horizontal position?	Between 2.1 and 2.5V Go to step 6.	Replace G sensor.
6	CHECK G SENSOR. 1) Remove the console box. 2) Remove the G sensor from vehicle. (Do not disconnect connector.) 3) Read the select monitor display. Is the indicated reading within specified values when the G sensor is inclined forwards to 90°?	Between 3.7 and 4.1V Go to step 7.	Replace G sensor.
7	CHECK G SENSOR. Read the select monitor display. Is the indicated reading within specified values when the G sensor is inclined backwards to 90°?	Between 0.5 and 0.9V G sensor is normal.	Replace G sensor.