

5. Front Inner Remote

A: REMOVAL

- 1) Remove the door trim. <Ref. to EI-38, REMOVAL, Front Door Trim.>
- 2) Remove the sealing cover. <Ref. to EB-14, REMOVAL, Front Sealing Cover.>
- 3) Remove the screw and the two rod joints.
- 4) Remove the front inner remote.

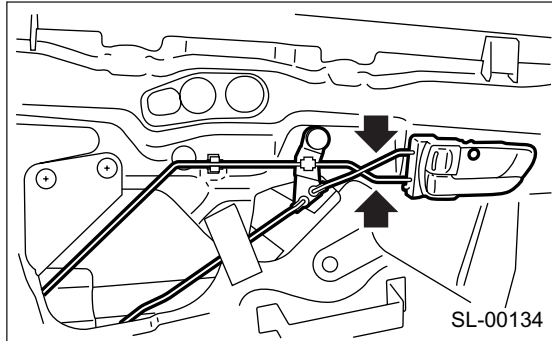

B: INSTALLATION

Install in the reverse order of removal.

CAUTION:

Make sure the lock works properly after installation.

C: INSPECTION

- 1) Make sure the rod is not deformed.
- 2) Make sure the lever and rod work smoothly.