

3. Combination Meter Assembly

A: REMOVAL

- 1) Disconnect the battery ground cable.
- 2) Set the tilt steering at the lowest position.
- 3) Remove the screws and detach the meter visor.

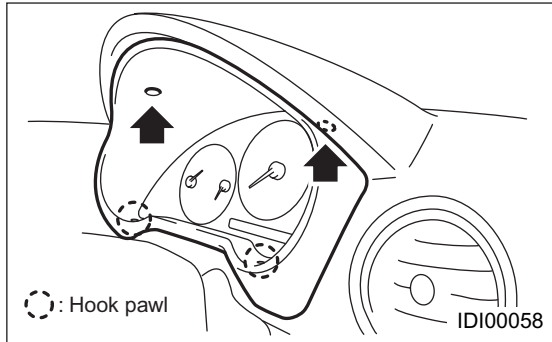

- 4) Remove the screws of combination meter and pull out the meter toward you.

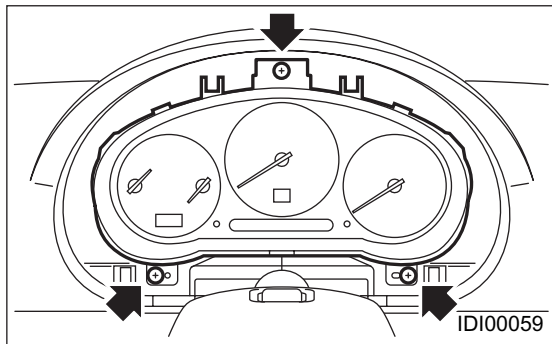

- 5) Disconnect the connector in the upper area of combination meter to remove the meter.

CAUTION:

- Be careful not to damage the meter or instrument panel.
- Pay particular attention to avoid damaging the meter glass.

B: INSTALLATION

Install in the reverse order of removal.

CAUTION:

- Make sure the electrical connector is connected securely.
- Make sure that each meter operates normally.

COMBINATION METER ASSEMBLY

INSTRUMENTATION/DRIVER INFO

C: DISASSEMBLY

CAUTION:

Use gloves to avoid damage and getting fingerprints on the glass surface and meter surfaces.

- 1) Disengage claw (F) to remove case (B) from back cover (A).
- 2) Disengage claw (G) to remove meter glass (E), reflector (D) and window plate (C) from inner case.

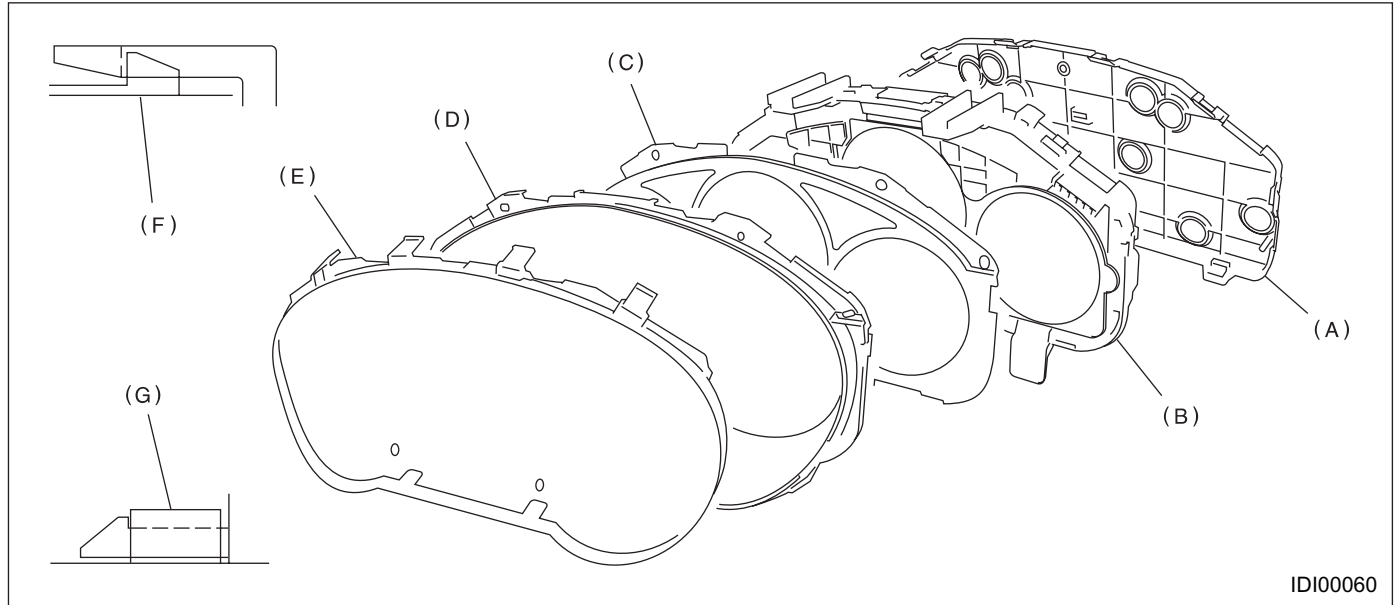

- 3) Pull up claw (A) in portion (B) of combination meter printed circuit (C) with combination pliers. Push out speedometer and tachometer assembly (D) and fuel gauge and water temperature gauge assembly (E) using hole (F).
- 4) Pull up the claw in the center of combination meter printed circuit (C), and remove the combination meter printed circuit from case (G).

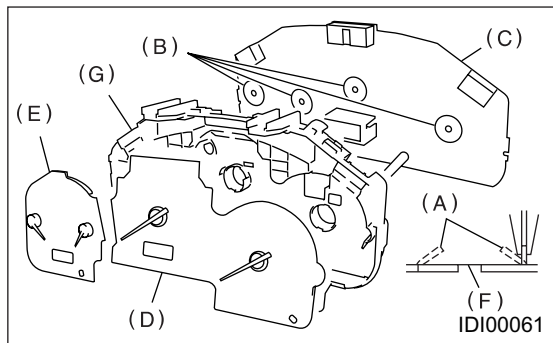

1. BULB REPLACEMENT

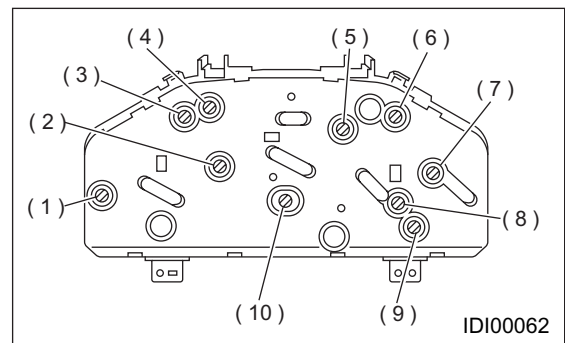

- (1) Tachometer
- (2) Speedometer and tachometer
- (3) Turn RH
- (4) HI-beam
- (5) Speedometer
- (6) Turn LH
- (7) Fuel gauge
- (8) Engine coolant temperature gauge
- (9) LCD (Outside temperature indicator)
- (10) LCD (Odometer and tripmeter)

D: ASSEMBLY

Assemble in the reverse order of disassembly.