

20. Rear Quarter Trim

A: REMOVAL

1. SEDAN

- 1) Remove the rear seat. <Ref. to SE-11, REMOVAL, Rear Seat.>
- 2) Remove the side sill rear cover. <Ref. to EI-47, REMOVAL, Lower Inner Trim.>
- 3) Remove the rear pillar lower cover (A).
- 4) Remove the seatbelt lower anchor bolt, and then remove the rear pillar upper trim (B).

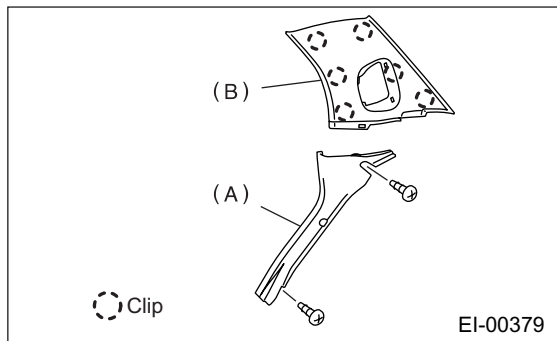

2. WAGON

- 1) Remove the rear seat. <Ref. to SE-11, REMOVAL, Rear Seat.>
- 2) Remove the side sill rear cover.
- 3) Remove the rear rail trim (A).
- 4) Loosen the screws and clips to remove the rear quarter upper trim (B).
- 5) Remove the rear skirt trim (C).
- 6) Loosen the bolts and clips to remove the rear quarter lower trim (D).

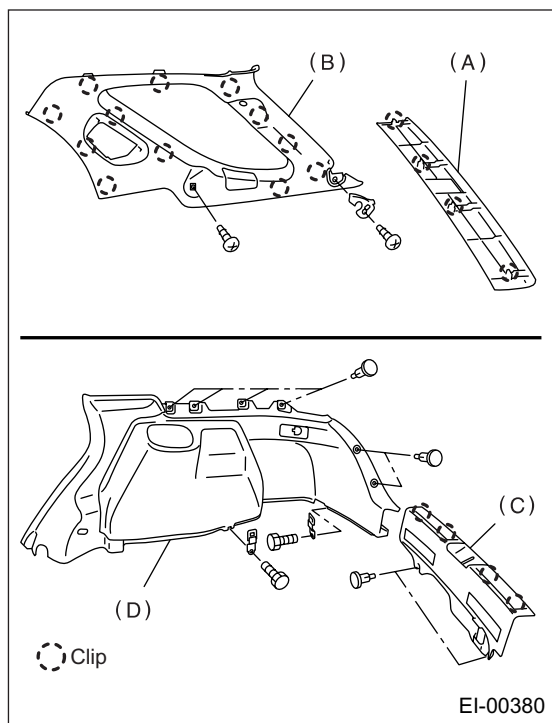

B: INSTALLATION

Install in the reverse order of removal.

CAUTION:

Be sure to securely hook pawls of inner trim panel to body flange.

NOTE:

When installing the rear quarter upper trim, be sure to set the rear mole as shown in the figure.

