

3. MT Gear Shift Lever

S501236

A: REMOVAL

S501236A18

- 1) Remove console box. <Ref. to EI-24 REMOVAL, Console Box.>
- 2) Remove plate from the body.

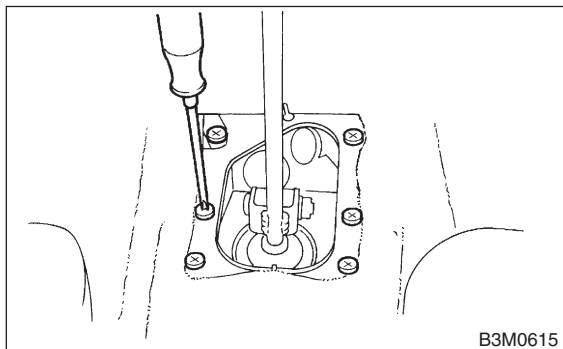

- 3) Remove stay from bracket.

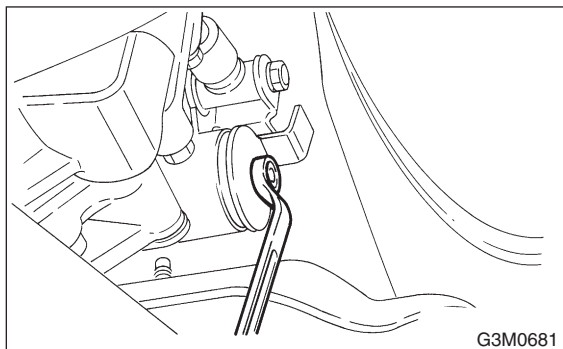

- 4) Remove rod from joint.

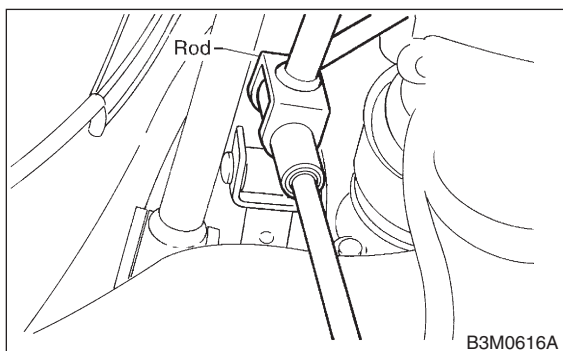

- 5) Remove the exhaust cover and remove cushion rubber from the body.

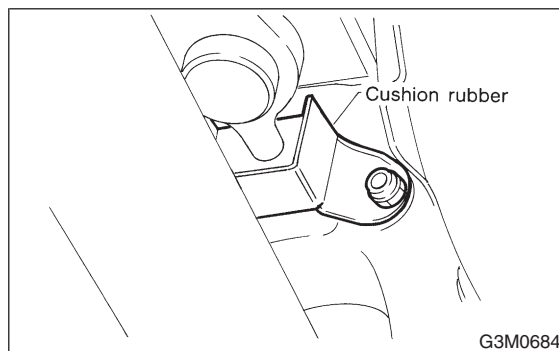

- 6) Remove gearshift lever.

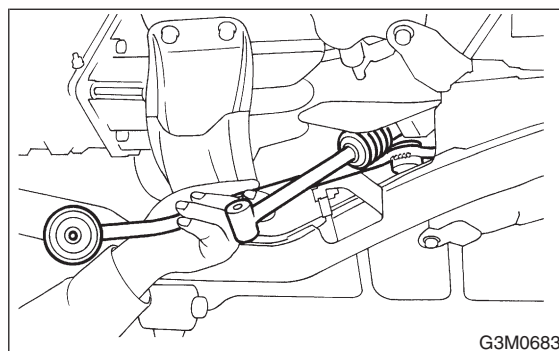

B: INSTALLATION

S501236A11

- 1) Put into gearshift lever to passenger compartment.
- 2) Mount boot plate on the body.
- 3) Install console box <Ref. to EI-24 INSTALLATION, Console Box.> and gearshift knob.

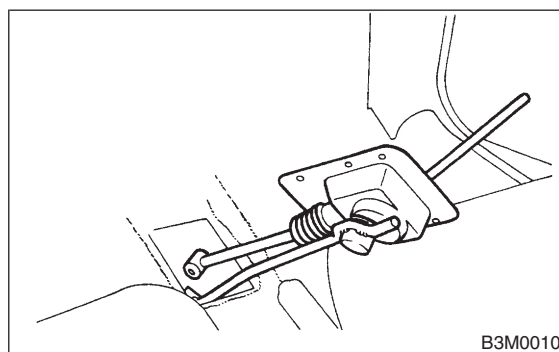

4) Mount cushion rubber on the body.

Tightening torque:

18 N·m (1.8 kgf-m, 13.0 ft-lb)

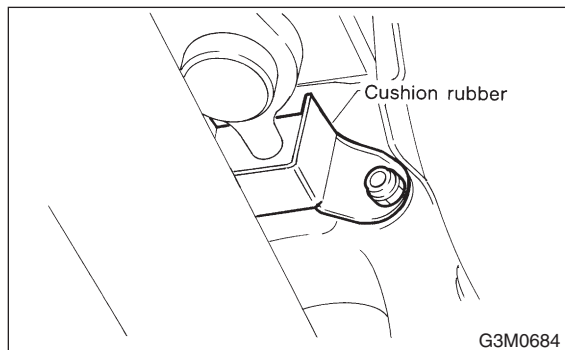

5) Connect rod to the joint.

Tightening torque:

18 N·m (1.8 kgf-m, 13.0 ft-lb)

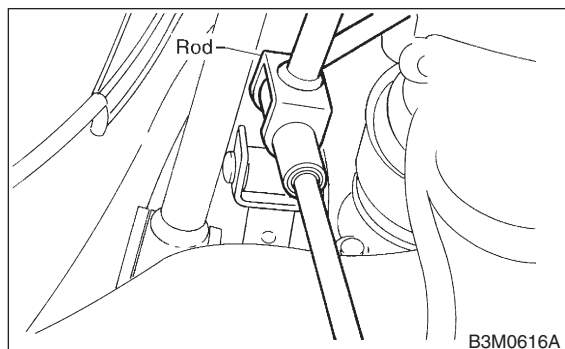

6) Connect stay to the bracket.

Tightening torque:

18 N·m (1.8 kgf-m, 13.0 ft-lb)

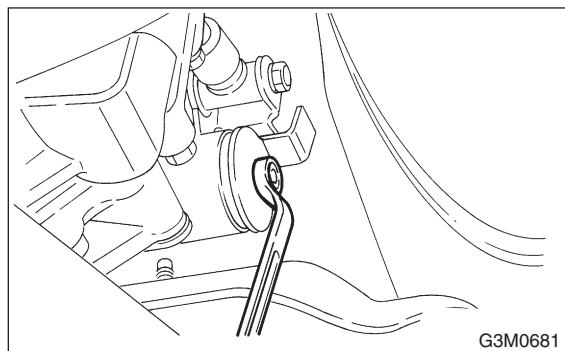

7) Install the exhaust cover.

C: DISASSEMBLY

S501236A06

1) Disconnect locking wire.

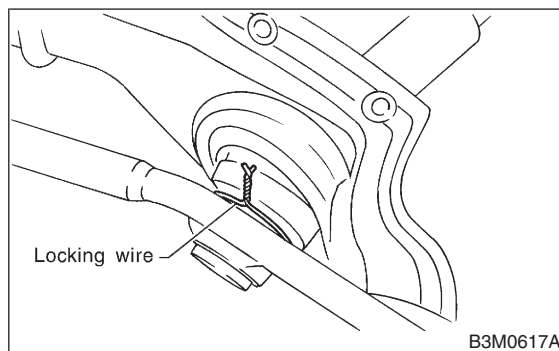

2) Remove rod from lever.

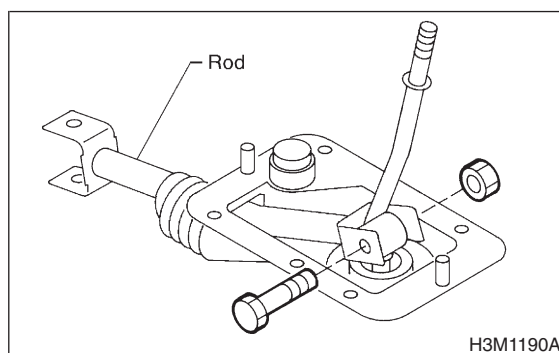

3) Remove snap ring, then disconnect lever from stay.

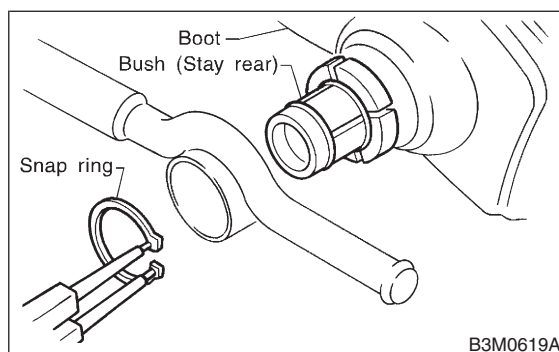

4) Remove boot from gearshift lever.

5) Remove O-ring, then disconnect bush (Stay rear).

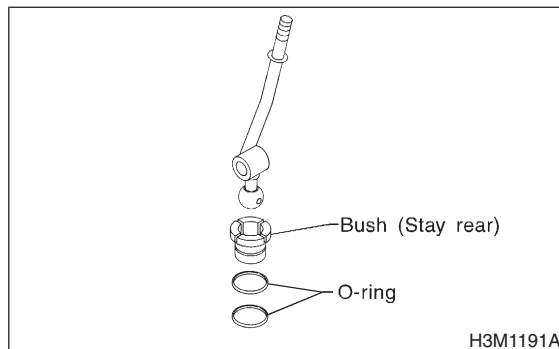

MT GEAR SHIFT LEVER

Control Systems

6) Draw out spring pin, then remove bush (Shift lever) from lever.

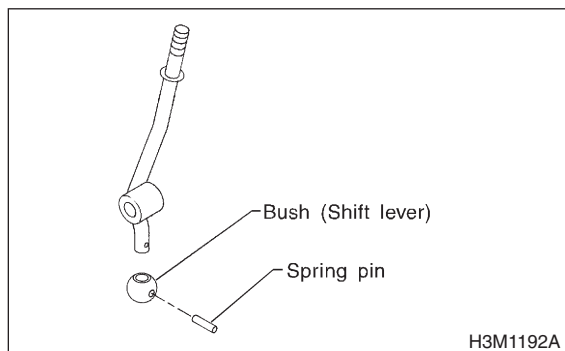

6) Install snap ring to the bottom of the bush (Stay rear).

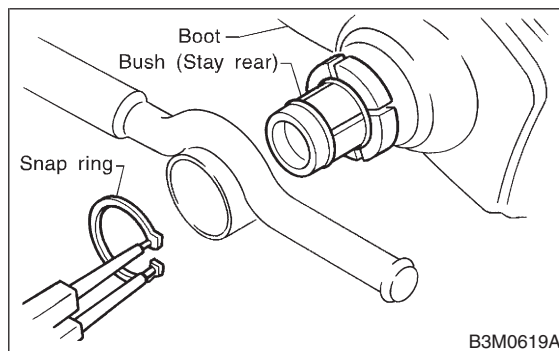

D: ASSEMBLY S501236A02

- 1) Clean all parts before assembly.
- 2) Mount the following parts on the stay.

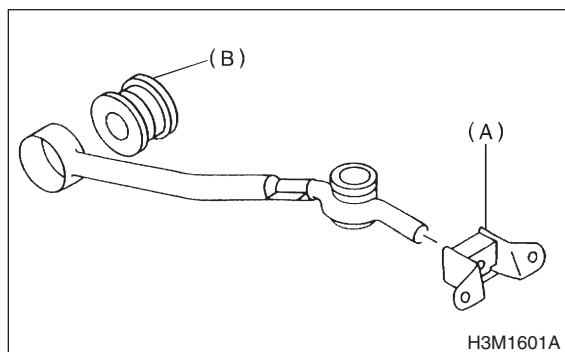

- (A) Cushion rubber
(B) Bush (Stay front)

3) Mount each parts (Boot, O-ring, bush and spacer) on the gearshift lever.

CAUTION:

- Always use new O-rings.
- Apply grease [NIGHTIGHT LYW No. 2 or equivalent] to the inner and side surfaces of the bush when installing spacer.

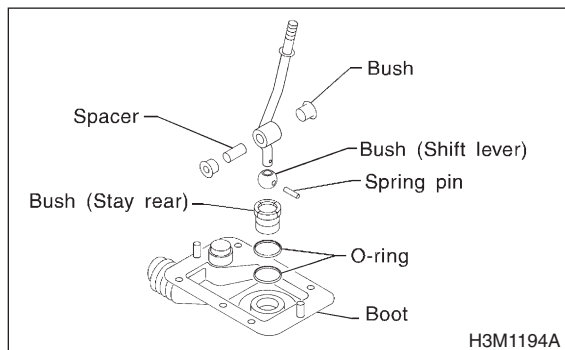

- 4) Insert the lever into the boot hole.
- 5) Mount lever on the stay.

7) Tighten with locking wire to the extent that the boot will not come off.

CAUTION:

Always use new locking wire.

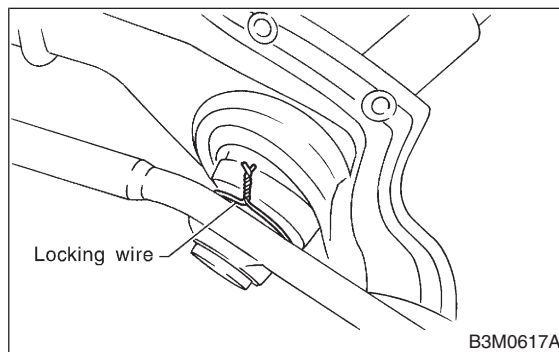

- 8) Insert the rod into the boot hole.
- 9) Connect rod to gearshift lever.

Tightening torque:

12 N·m (1.2 kgf-m, 8.7 ft-lb)

Rocking torque:

0.7 N·m (0.07 kgf-m, 0.5 ft-lb) or less

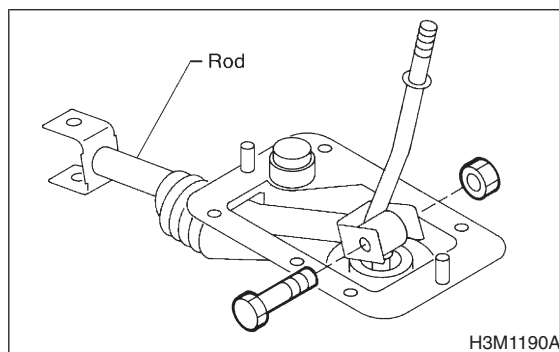

10) Check that there is no excessive play and that parts move smoothly.

E: INSPECTION

S501236A10

Check each parts (Bush, cushion, spacer, boot, stay and rod etc.) for deformation, damage and wear. Repair or replace any defective parts. Determine defective parts by comparing with new parts.

