

## 10. Clutch Cable S504259

### A: REMOVAL S504259A18

- 1) Disconnect clutch cable from release lever.
- 2) Remove clutch cable clamp from pedal bracket.

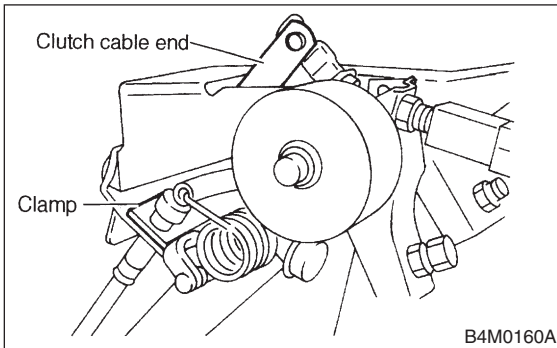

- 3) Disconnect clutch cable from pedal bracket and pedal end.
- 4) Remove clutch cable from body.

#### CAUTION:

**Before removing clutch cable from toe board, remove grommet. Slowly remove clutch cable, being careful not to scratch it.**

### B: INSTALLATION S504259A11

- 1) Clean clutch pedal fitting hole, and apply grease. Connect clutch cable to clutch pedal.

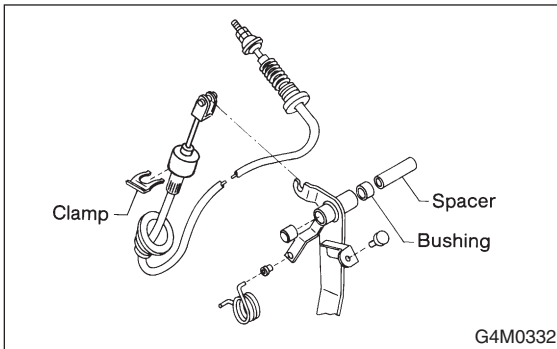

- 2) Fit clutch pedal to pedal bolt, and connect clutch cable to bracket with clamp.
- 3) Connect clutch cable end to pedal end.
- 4) Connect clutch cable from release lever.
- 5) Install grommet to toe board.
- 6) Adjust after cable installation. <Ref. to CL-26 INSTALLATION, Clutch Cable.>