

4. Rear Trailing Link

S201107

A: REMOVAL

S201107A18

- 1) Loosen rear wheel nuts.
- 2) Jack-up vehicle, support it with safety stands (rigid racks) and remove rear wheels.
- 3) Remove both rear parking brake clamp and ABS sensor harness. (only vehicle equipped with ABS)
- 4) Remove bolt which secure trailing link to trailing link bracket.

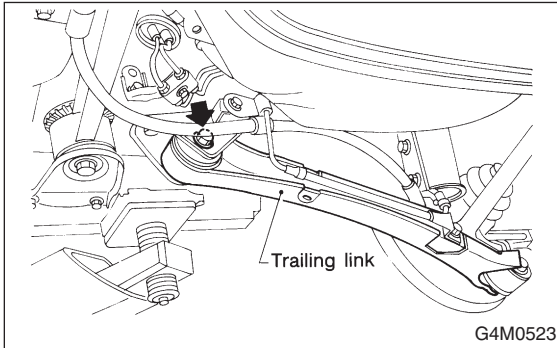

- 5) Remove bolt which secure trailing link to rear housing.

B: INSTALLATION

S201107A11

Install in the reverse order of removal.

CAUTION:

Always tighten rubber bushing location when wheels are in full contact with the ground and vehicle is at curb weight condition.

NOTE:

Check wheel alignment and adjust if necessary.

REAR TRAILING LINK

Rear Suspension

C: DISASSEMBLY

S201107A06

1. FRONT BUSHING

S201107A0601

Using ST, press front bushing out of place.

ST 927720000 INSTALLER & REMOVER SET

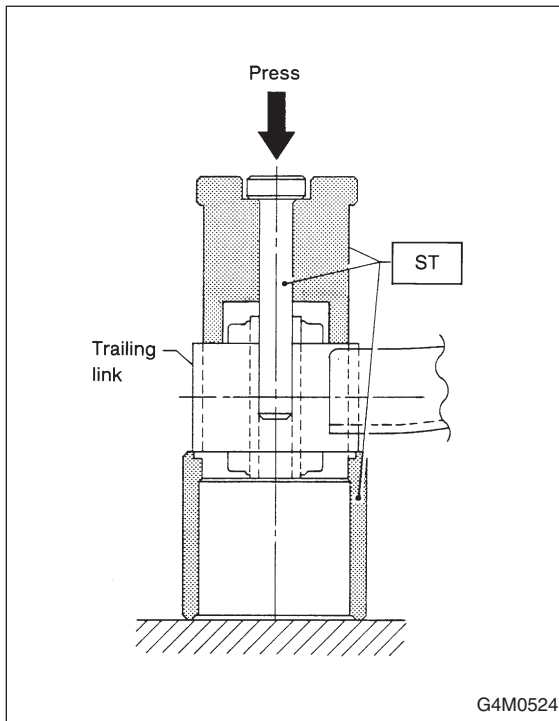

2. REAR BUSHING

S201107A0602

1) Remove housing. <Ref. to DS-22 REMOVAL, Rear Axle.>

2) Using ST, press rear bushing out of place.

ST 927730000 INSTALLER & REMOVER SET

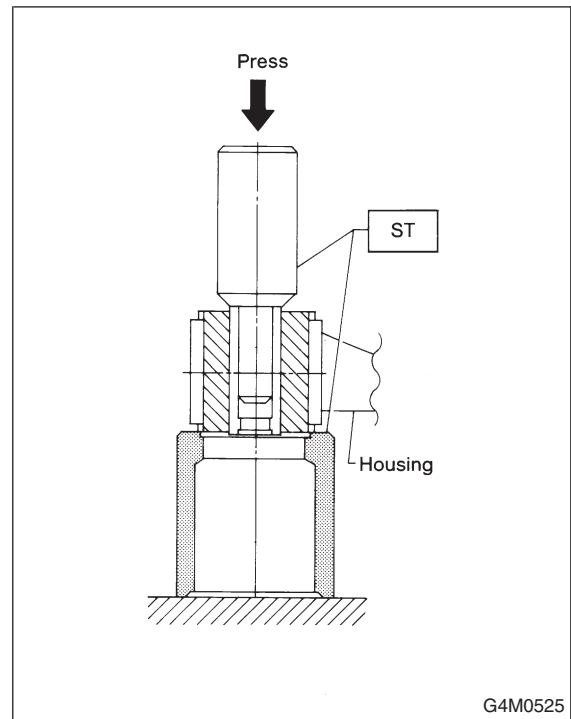

D: ASSEMBLY S201107A02

Assemble in the reverse order of disassembly.

1. FRONT BUSHING S201107A0201

Using ST, press bushing into trailing link.
ST 927720000 INSTALLER & REMOVER SET

CAUTION:

When installing bushing, turn ST plunger upside down and press it until the plunger end surface contacts the trailing link end surface.

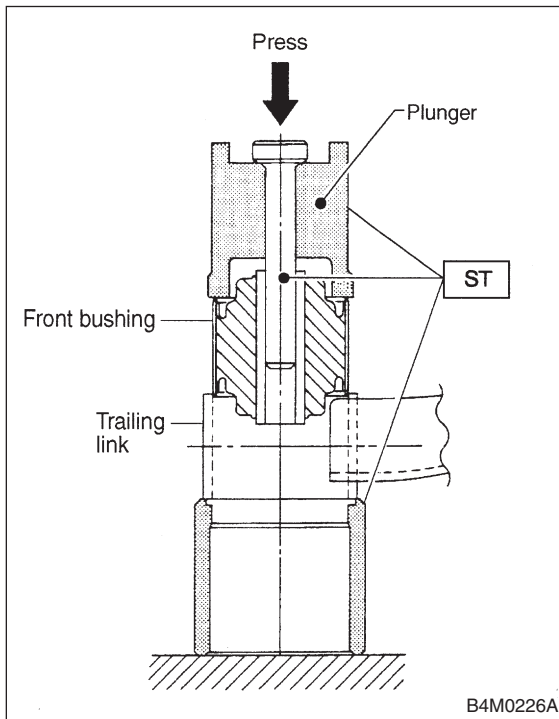

CAUTION:

Install front bushing in the proper direction, as shown in figure.

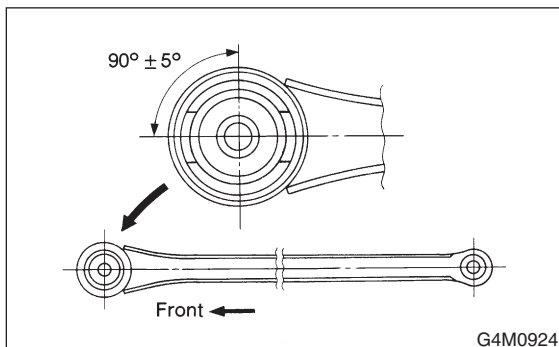

2. REAR BUSHING S201107A0202

1) Using ST, press bushing into trailing link.
ST 927730000 INSTALLER & REMOVER SET

NOTE:

If it is difficult to press bushing into trailing link, apply water-diluted TIRE LUBE to the inner surface of ST as a lubricant.

Specified lubricant:

TIRE LUBE : water = 1 : 3

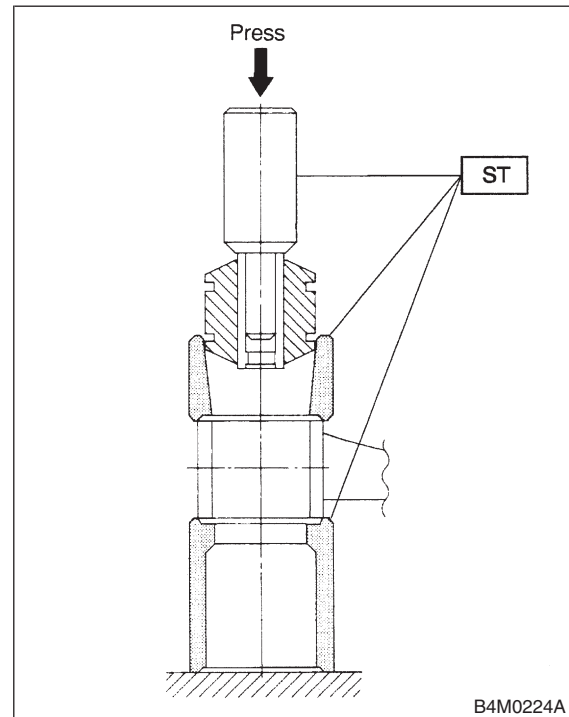

REAR TRAILING LINK

Rear Suspension

2) Press ST plunger until bushing flange protrudes beyond trailing link.

ST 927730000 INSTALLER & REMOVER SET

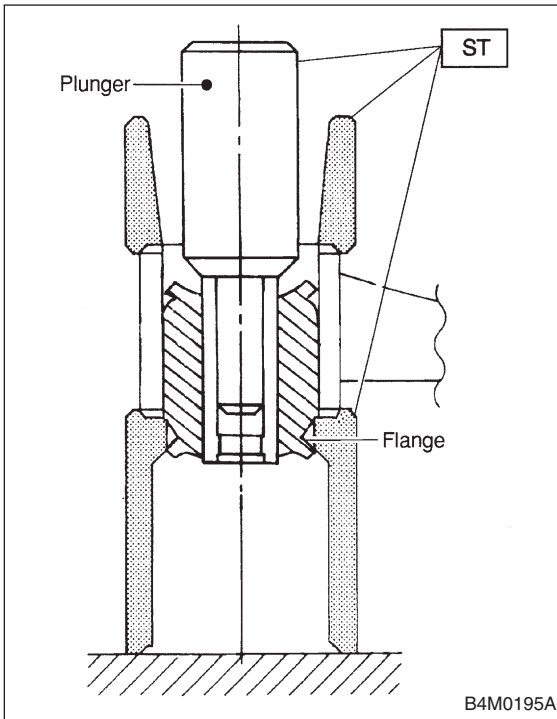

E: INSPECTION S201107A10

Check trailing links for bends, corrosion or damage.

3) Turn trailing link upside down. Press ST plunger in the direction opposite that outlined in the former procedure until bushing is correctly positioned in trailing link.

ST 927730000 INSTALLER & REMOVER SET

