

## 3. Accelerator Pedal Cable S107007

### A: REMOVAL S107007A18

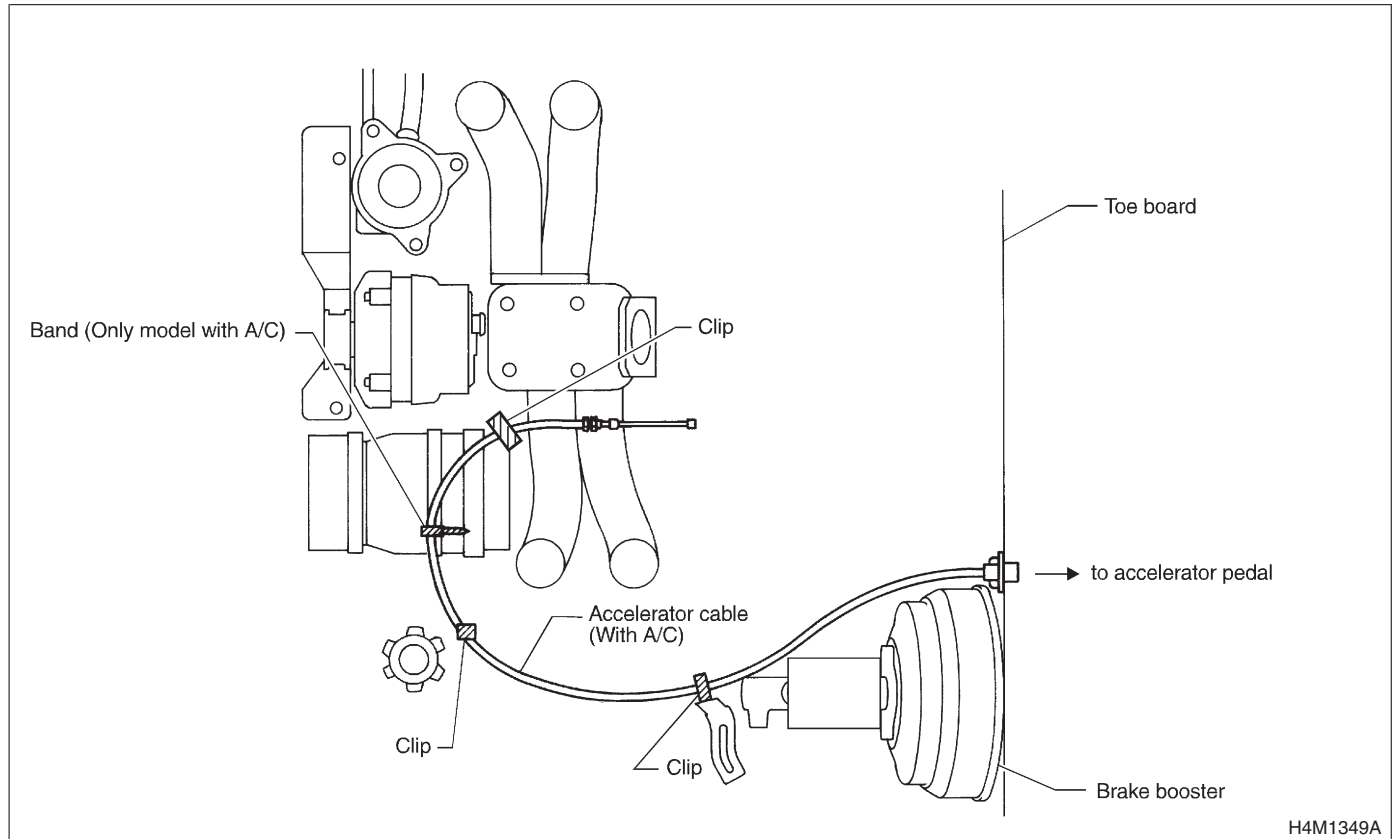

- 1) Disconnect accelerator cable from connector inside engine compartment first.
- 2) Remove lock nut from accelerator cable bracket.
- 3) Separate accelerator cable from bracket, then unlock inner cable.

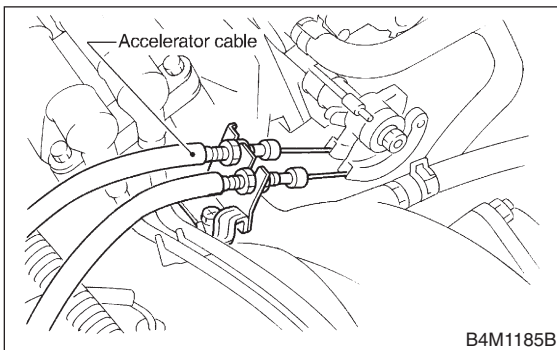

- 7) Working inside engine compartment, remove cable connection by turning toe board clockwise.

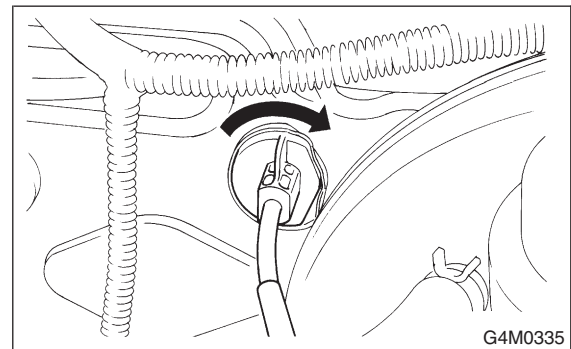

- 8) Pull out the cable from the toe board hole.

- 4) Remove cable end from throttle cam using your fingertips.

#### CAUTION:

**Be careful not to bend inner cable.**

- 5) Disconnect cable end from accelerator cable bracket inside driver compartment.
- 6) Remove clip inside engine compartment.

## B: INSTALLATION S107007A11

1) Install in the reverse order of removal.

### CAUTION:

- Be careful not to kink accelerator cable.
- Make sure that holder and casing cap are securely connected.

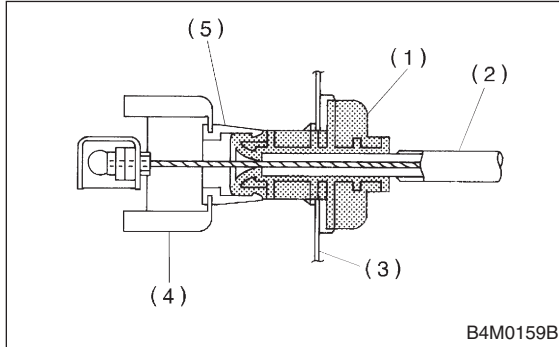

- (1) Casing cap
- (2) Accelerator cable
- (3) Toe board
- (4) Accelerator pedal bracket
- (5) Holder

2) Inspect after cable installation. <Ref. to SP-6 INSPECTION, Accelerator Pedal Cable.>

## C: INSPECTION S107007A10

- 1) Make sure the inner cable is not twisted or frayed.
- 2) Make sure the outer cable is not cracked.