

FUEL SUB LEVEL SENSOR

Fuel Injection (Fuel Systems)

25. Fuel Sub Level Sensor S105023

A: REMOVAL S105023A18

- 1) Disconnect battery ground cable.

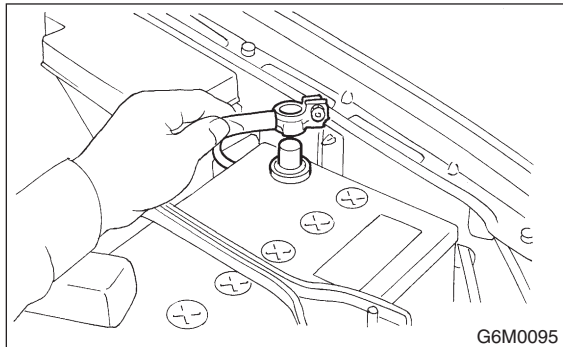

- 2) Remove fuel filler cap.
- 3) Remove service hole cover.

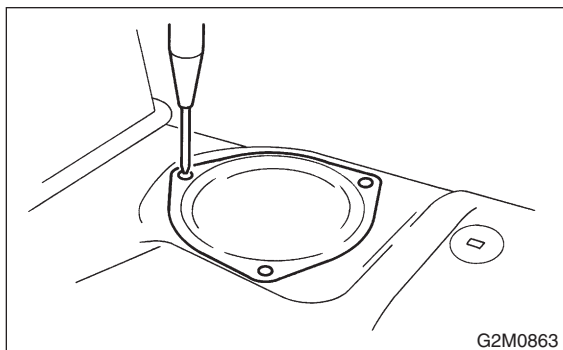

- 4) Disconnect connector from fuel sub level sensor, and disconnect jet pump hose.

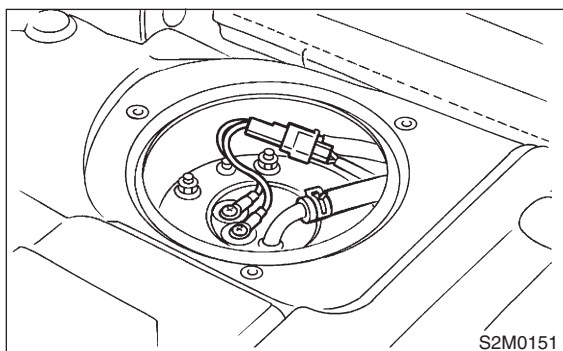

- 5) Remove bolts which install fuel sub level sensor on fuel tank.

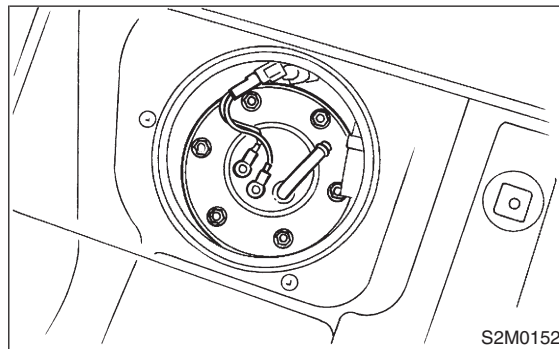

- 6) Remove fuel sub level sensor.

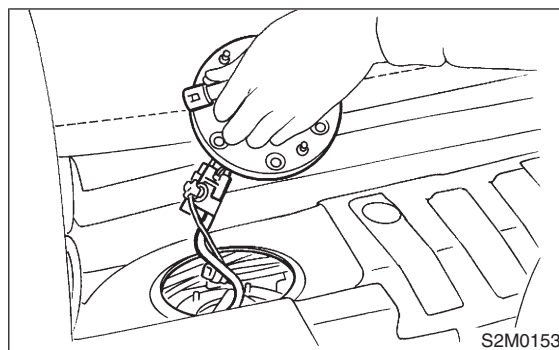

B: INSTALLATION S105023A11

Install in the reverse order of removal.

Tightening torque:

T: 4.4 N·m (0.45 kgf-m, 3.3 ft-lb)

