

4. Electrical Components Location

S008507

A: LOCATION

S008507A13

1. ENGINE (2200 cc MODELS)

S008507A1305

● Module

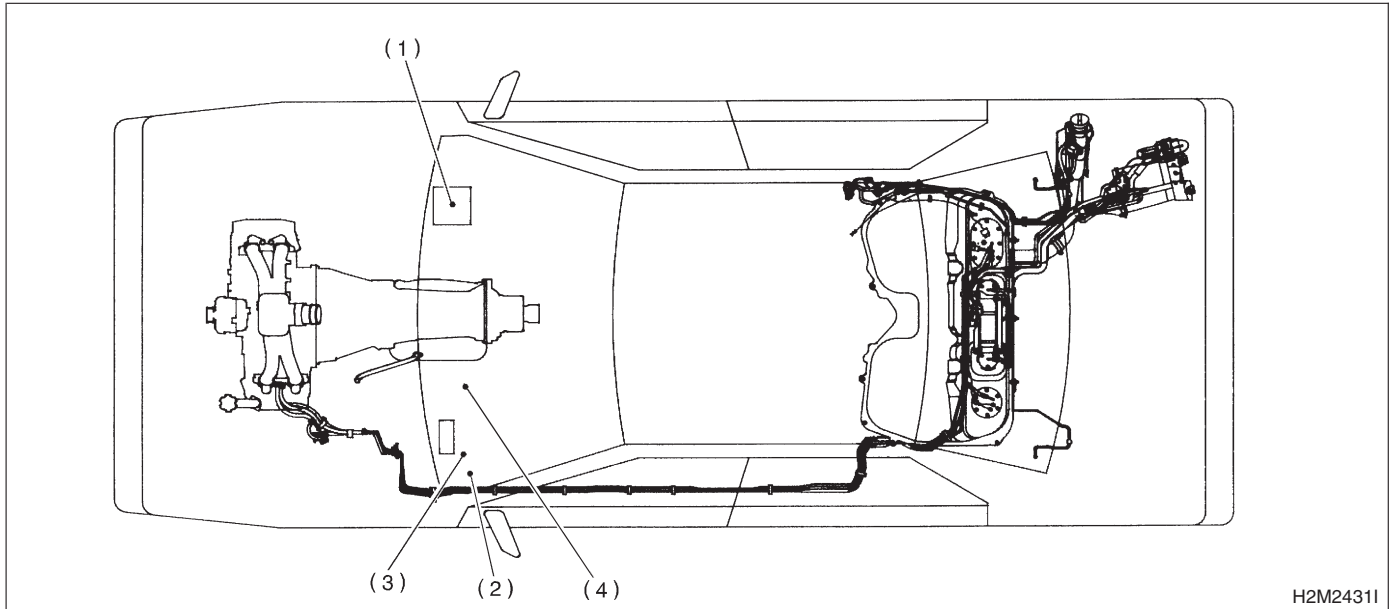

H2M2431I

- | | |
|--|---|
| (1) Engine control module (ECM) | (3) Test mode connector |
| (2) Data link connector (for Subaru Select Monitor and OBD-II general scan tool) | (4) CHECK ENGINE malfunction indicator lamp (MIL) |

ELECTRICAL COMPONENTS LOCATION

Engine

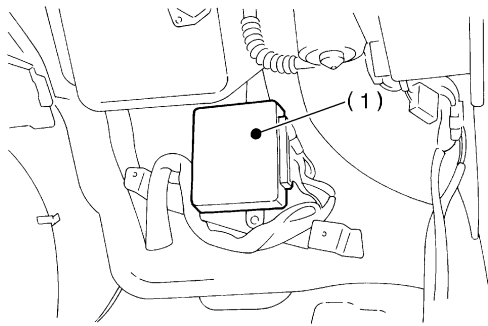

B3M0183E

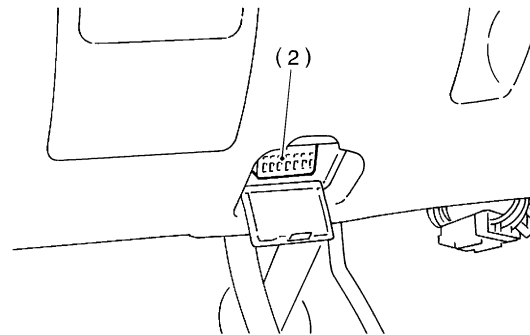

S2M0258J

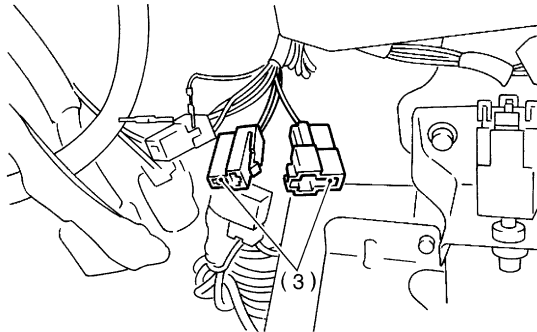

S2M0259D

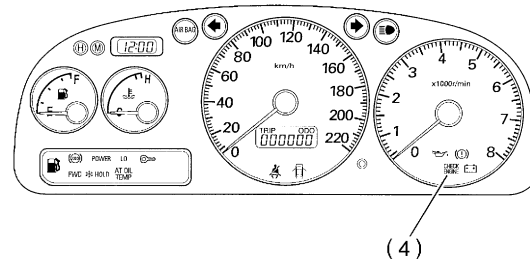

H2M2446D

ELECTRICAL COMPONENTS LOCATION

Engine

● Sensor

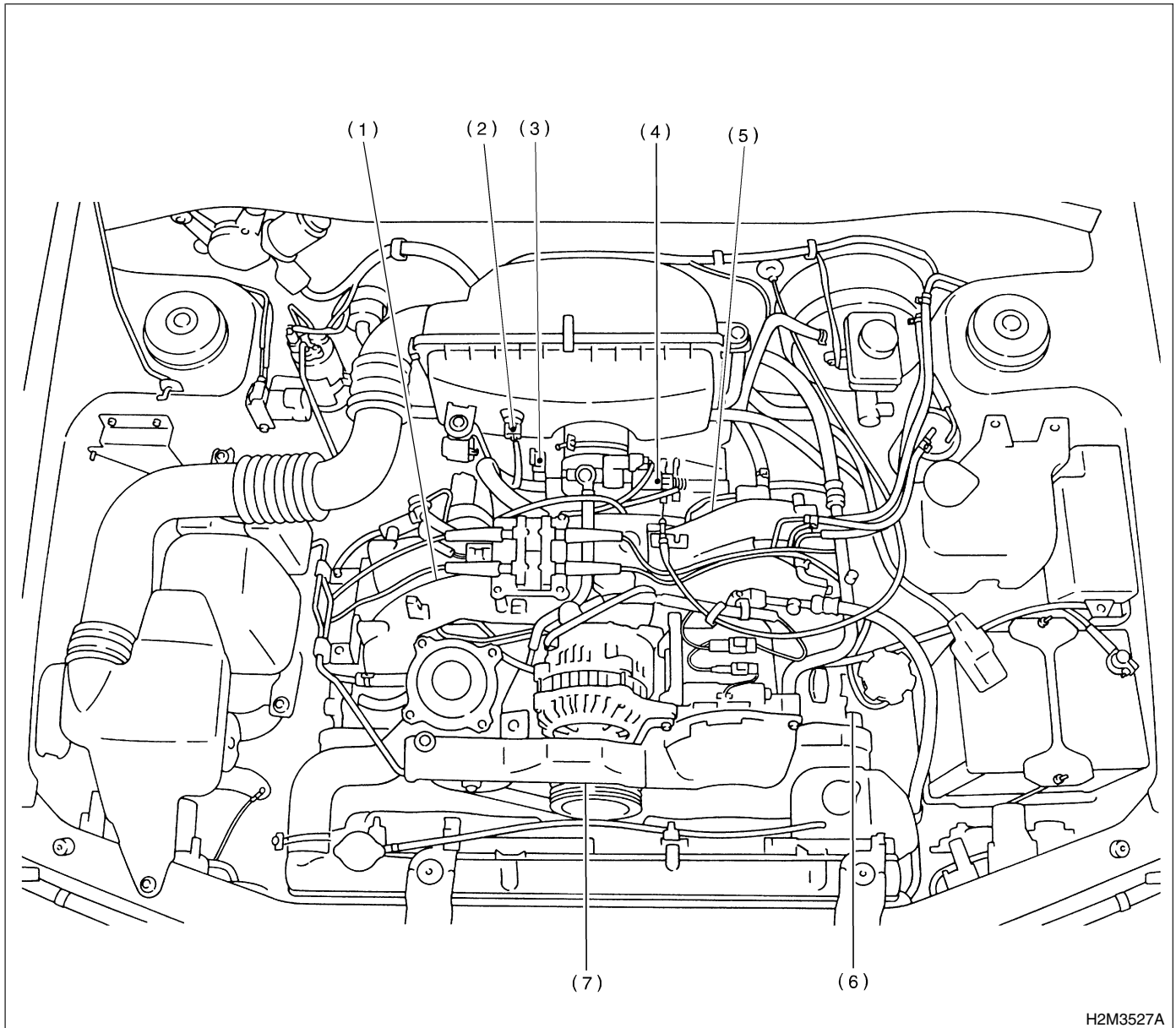

(1) Engine coolant temperature sensor

(2) Intake air temperature sensor

(3) Throttle position sensor

(4) Intake manifold pressure sensor

(5) Knock sensor

(6) Camshaft position sensor

(7) Crankshaft position sensor

ELECTRICAL COMPONENTS LOCATION

Engine

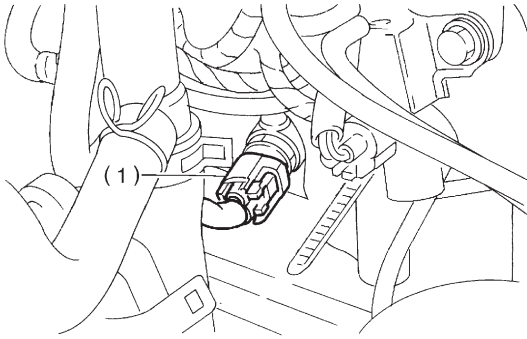

S2M1248A

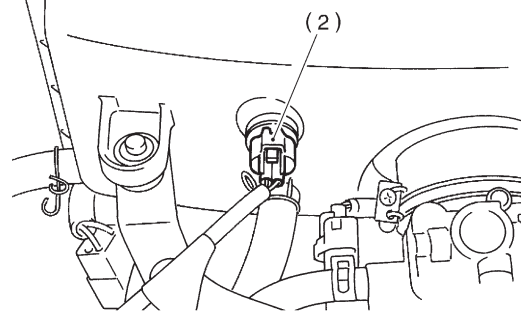

B2M2250A

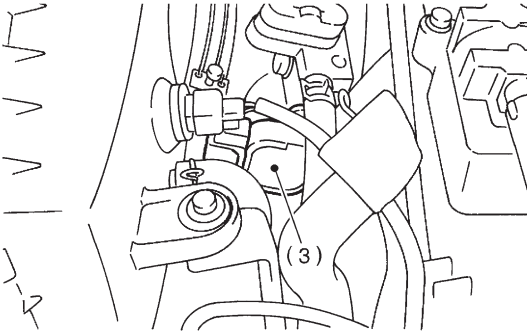

B2M2251A

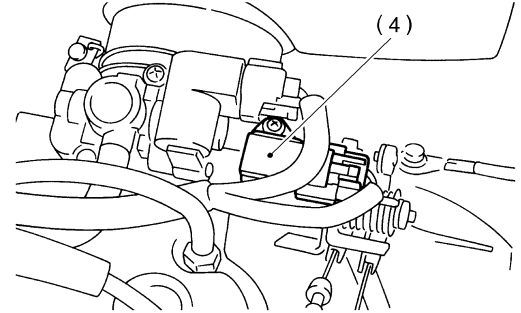

B2M3702A

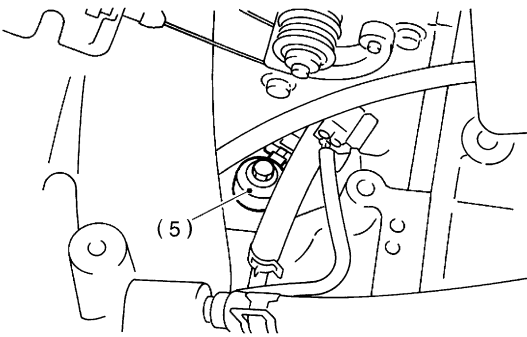

B2M2241A

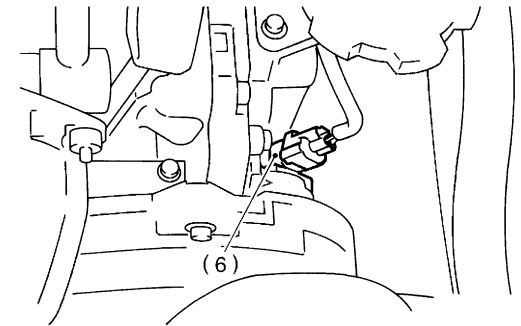

B2M2242A

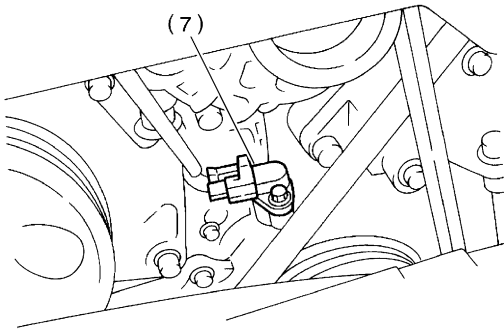

B2M0213J

SUBARU.

ELECTRICAL COMPONENTS LOCATION

Engine

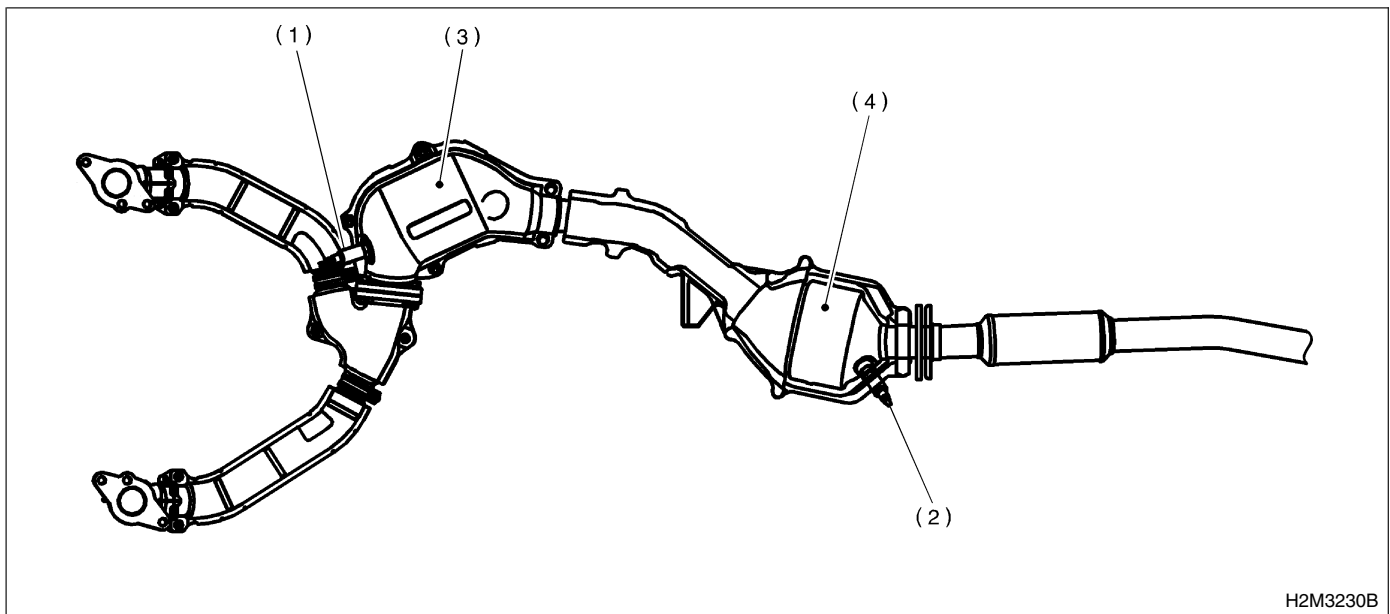

- (1) Front oxygen (A/F) sensor
- (2) Rear oxygen sensor
- (3) Front catalytic converter
- (4) Rear catalytic converter

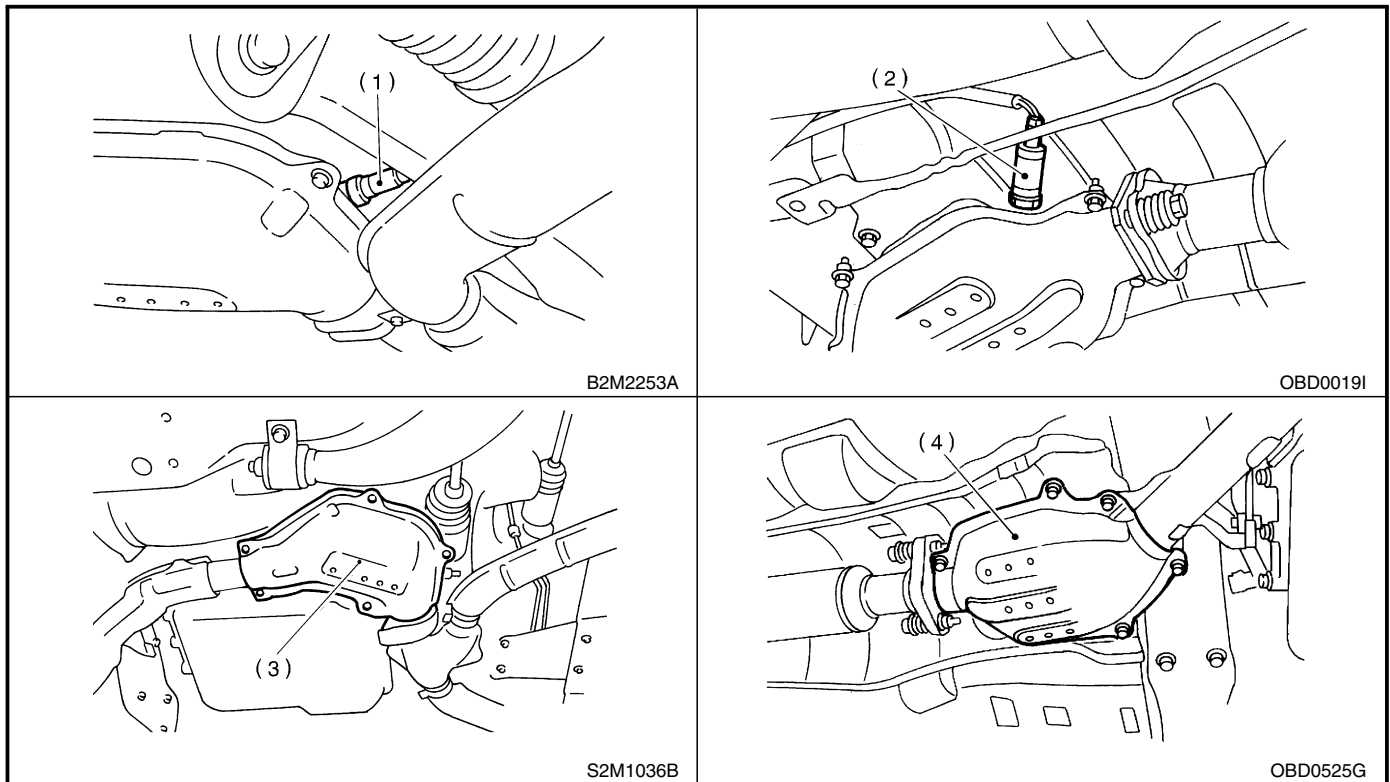

ELECTRICAL COMPONENTS LOCATION

Engine

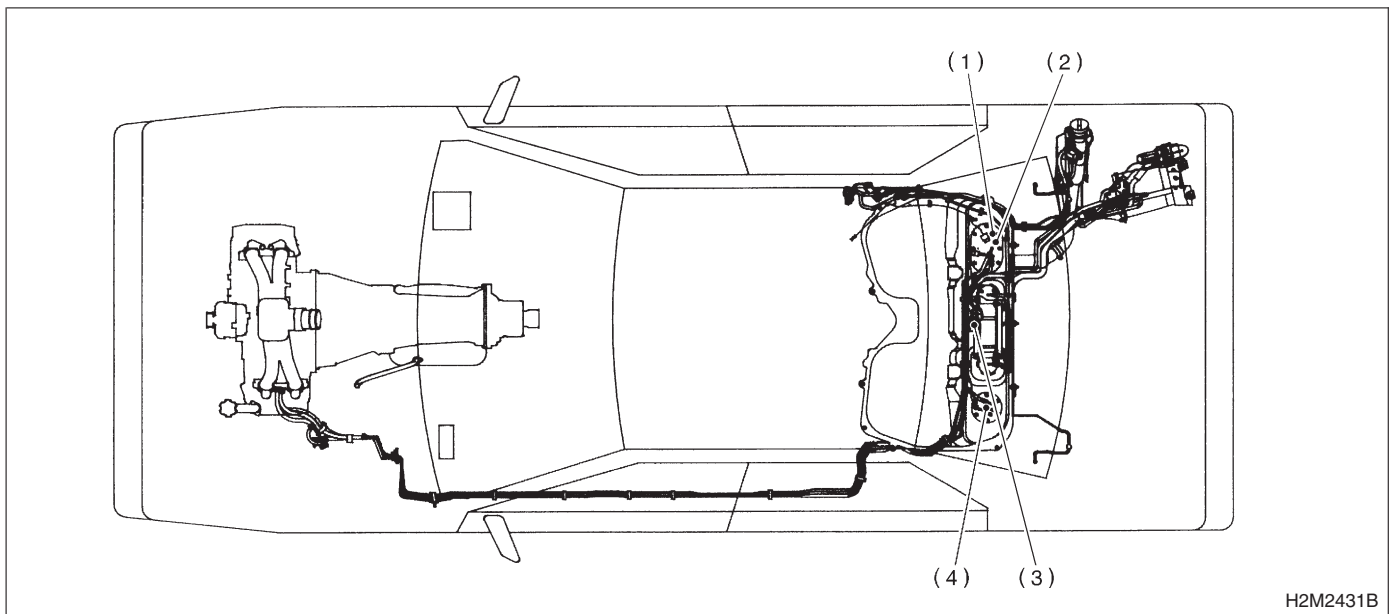

H2M2431B

- (1) Fuel level sensor
- (2) Fuel temperature sensor

- (3) Fuel tank pressure sensor
- (4) Fuel sub level sensor

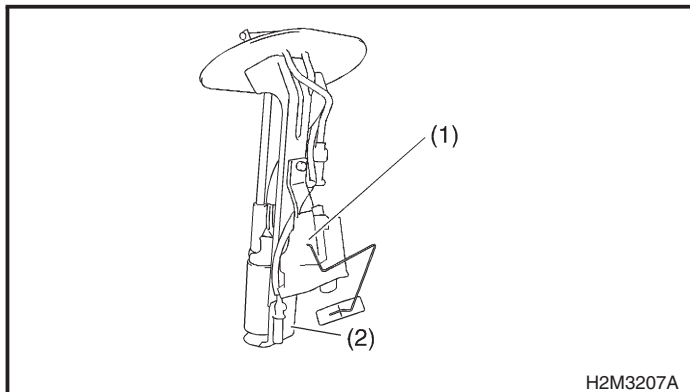

H2M3207A

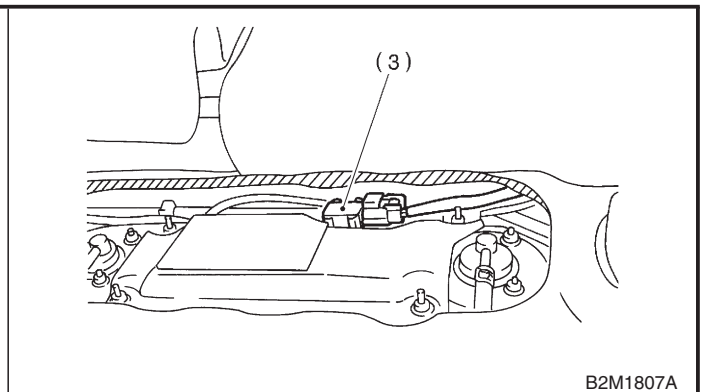

B2M1807A

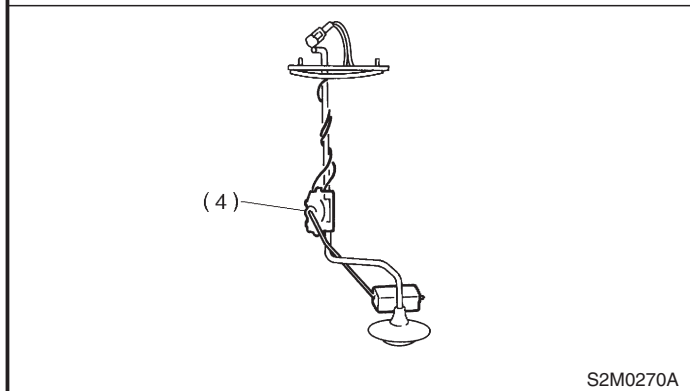

S2M0270A

SUBARU.

ELECTRICAL COMPONENTS LOCATION

Engine

● Solenoid Valve, Emission Control System Parts And Ignition System Parts

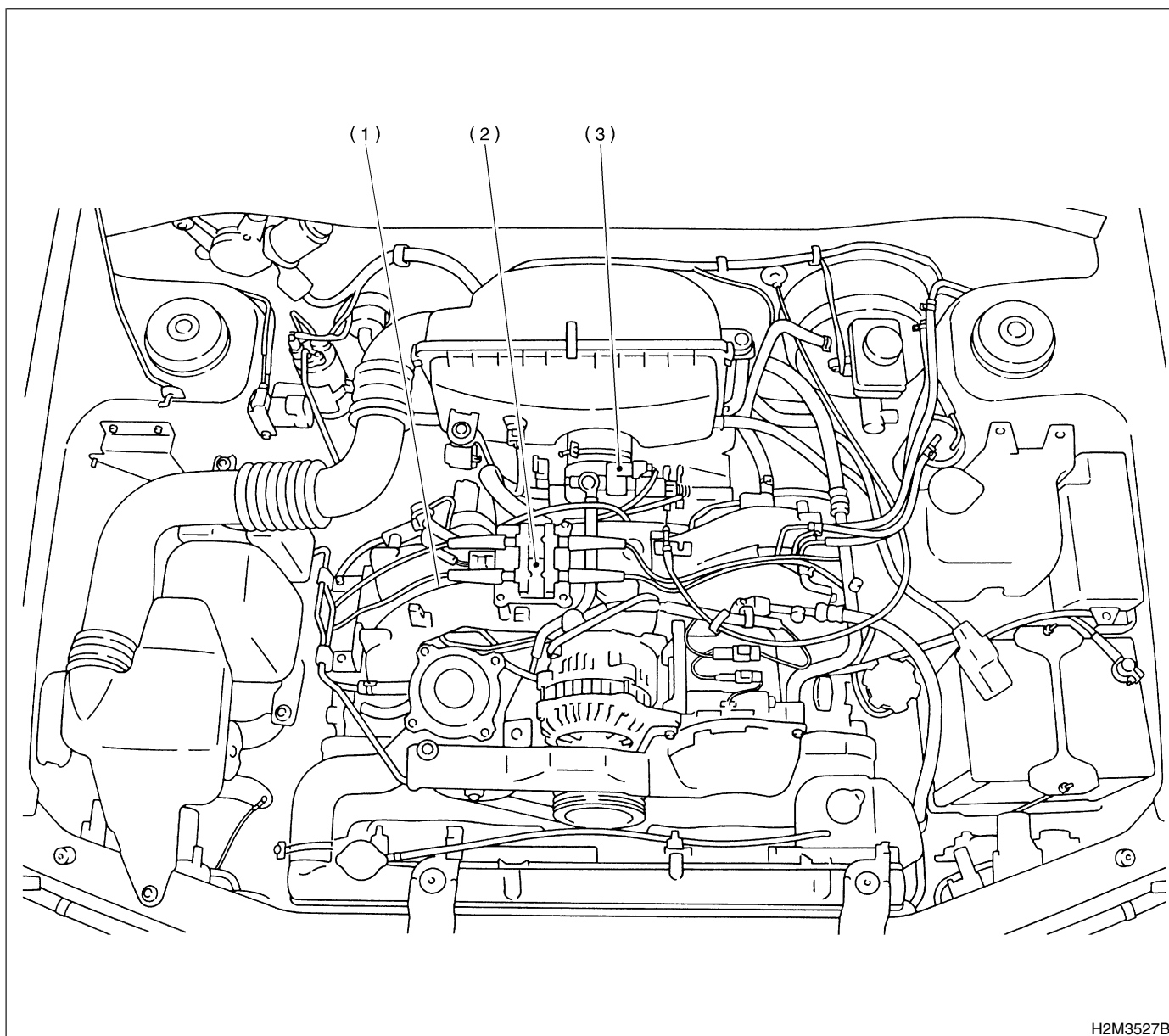

H2M3527B

(1) Purge control solenoid valve

(2) Ignition coil & ignitor ASSY

(3) Idle air control solenoid valve

ELECTRICAL COMPONENTS LOCATION

Engine

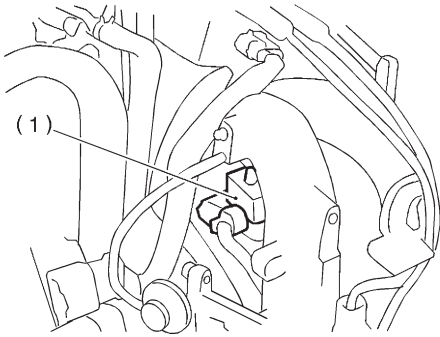

B2M2254A

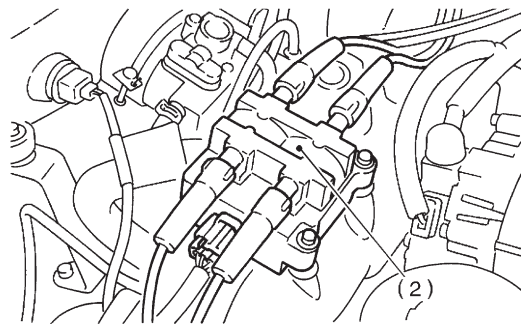

B2M2255A

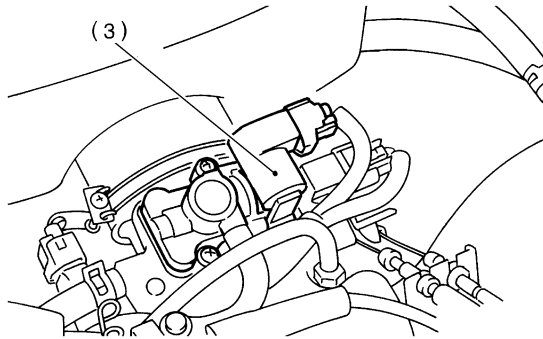

B2M2256B

SUBARU.

ELECTRICAL COMPONENTS LOCATION

Engine

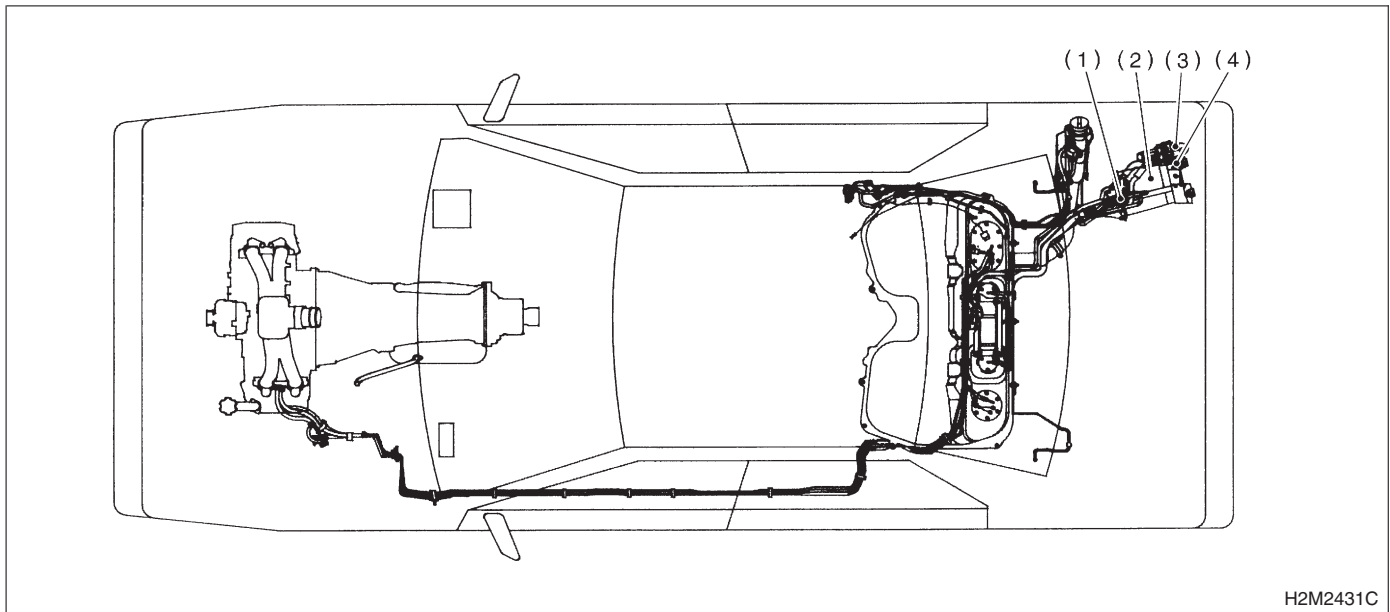

- (1) Pressure control solenoid valve
- (2) Canister

- (3) Drain valve
- (4) Drain filter

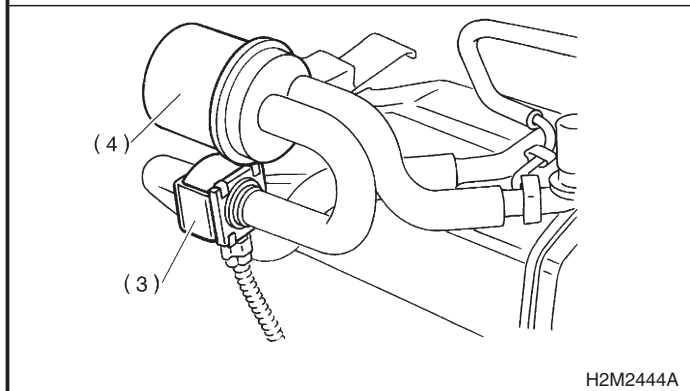
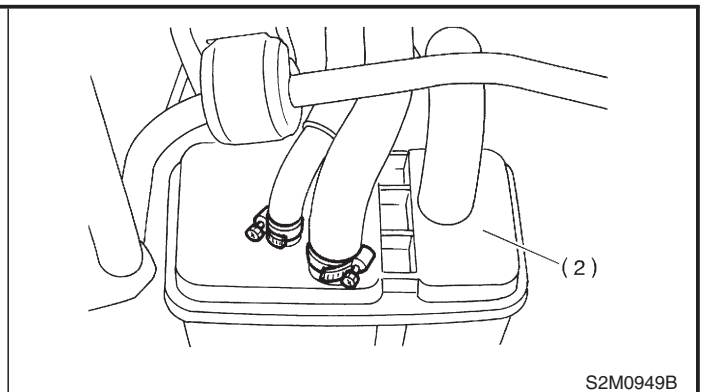
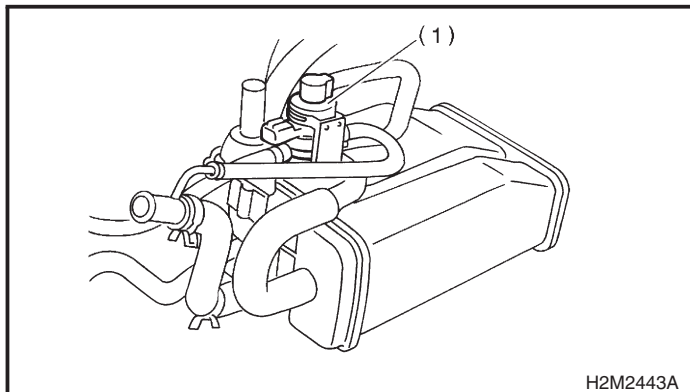

SUBARU.

MEMO:

ELECTRICAL COMPONENTS LOCATION

Engine

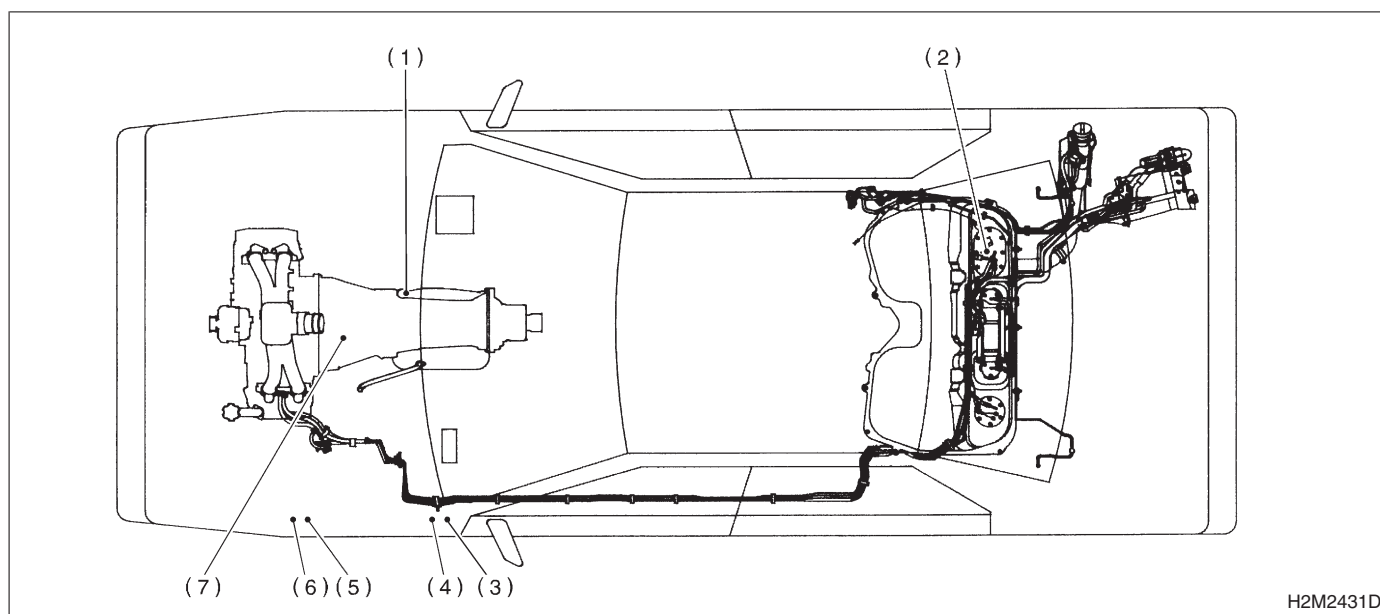

- | | | |
|---|-----------------------------|----------------------------|
| (1) Inhibitor switch (AT vehicles only) | (3) Main relay | (6) Radiator sub fan relay |
| (2) Fuel pump | (4) Fuel pump relay | (7) Starter |
| | (5) Radiator main fan relay | |

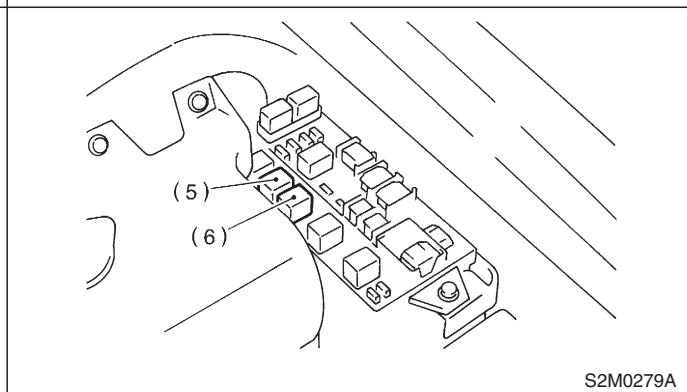
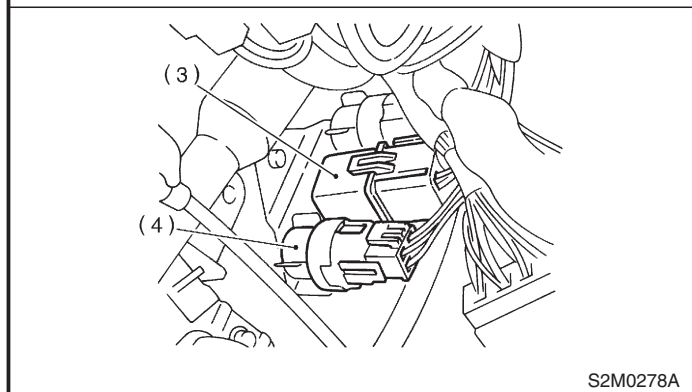
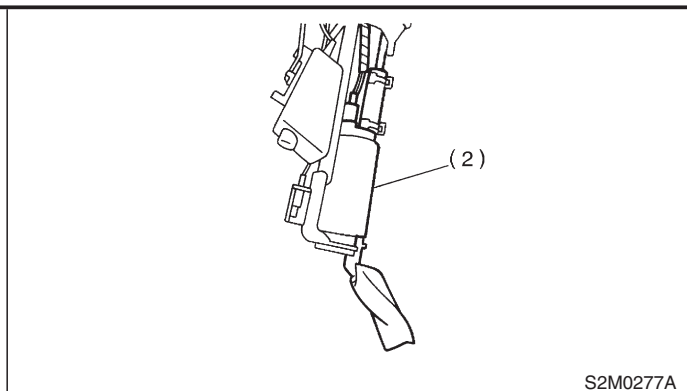
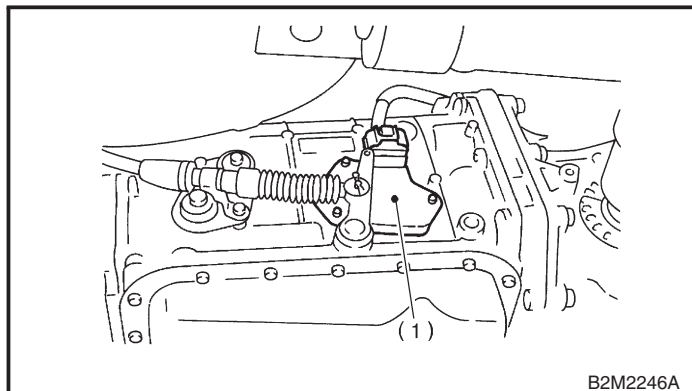

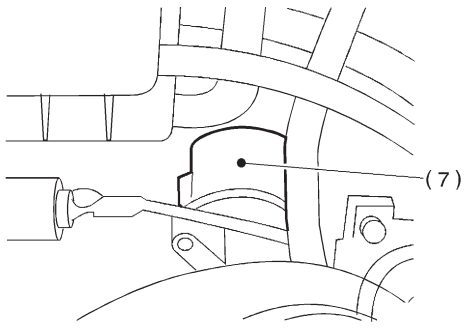

B2M2247B

SUBARU.

ELECTRICAL COMPONENTS LOCATION

Engine

2. ENGINE (2500 cc MODELS) S008507A1306

● Module

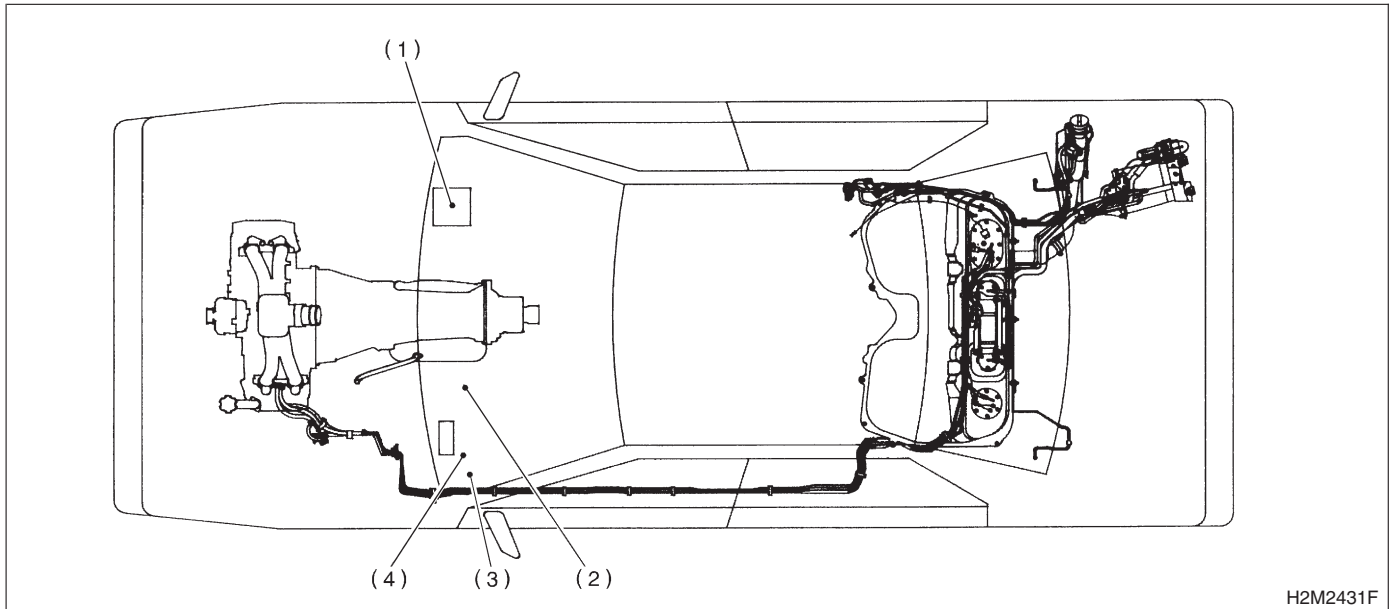

H2M2431F

- | | |
|--|---|
| (1) Engine control module (ECM) | (3) Test mode connector |
| (2) Data link connector (for Subaru Select Monitor and OBD-II general scan tool) | (4) CHECK ENGINE malfunction indicator lamp (MIL) |

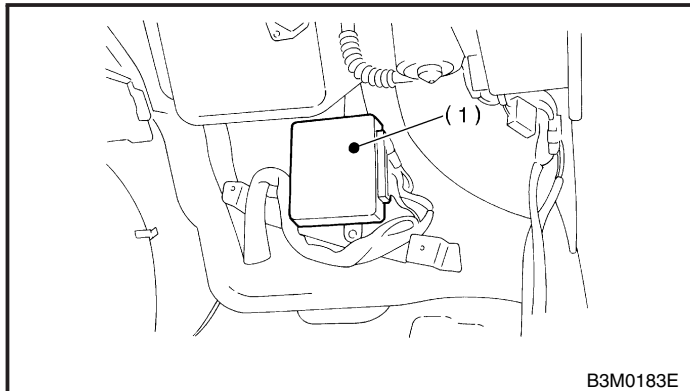

B3M0183E

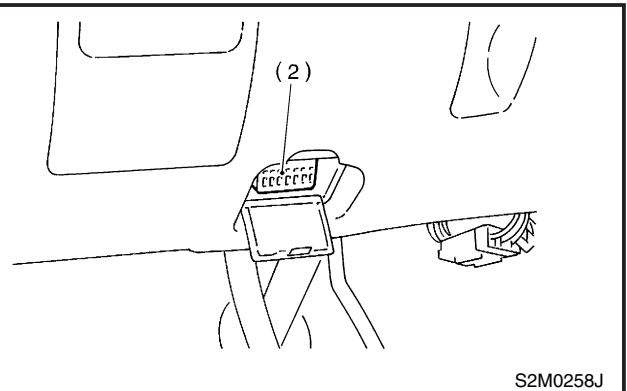

S2M0258J

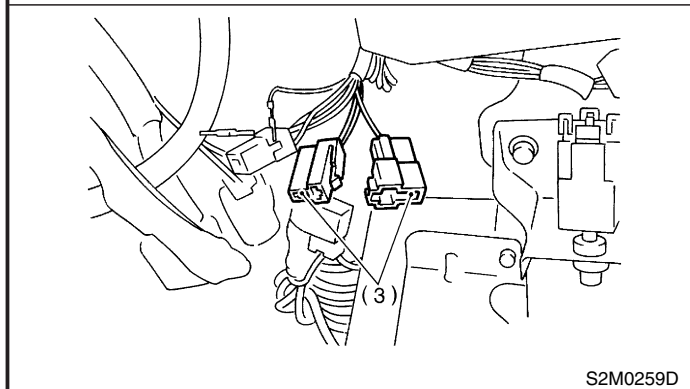

S2M0259D

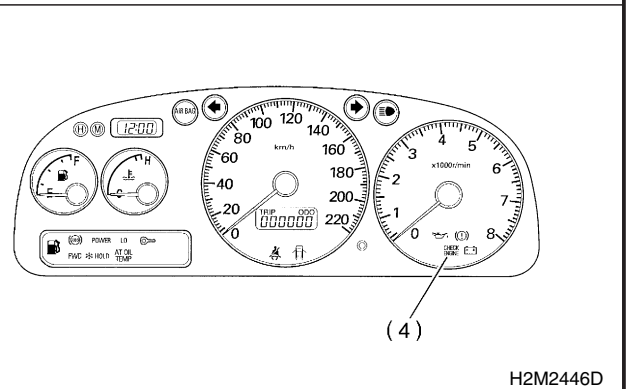

H2M2446D

MEMO:

ELECTRICAL COMPONENTS LOCATION

Engine

● Sensor

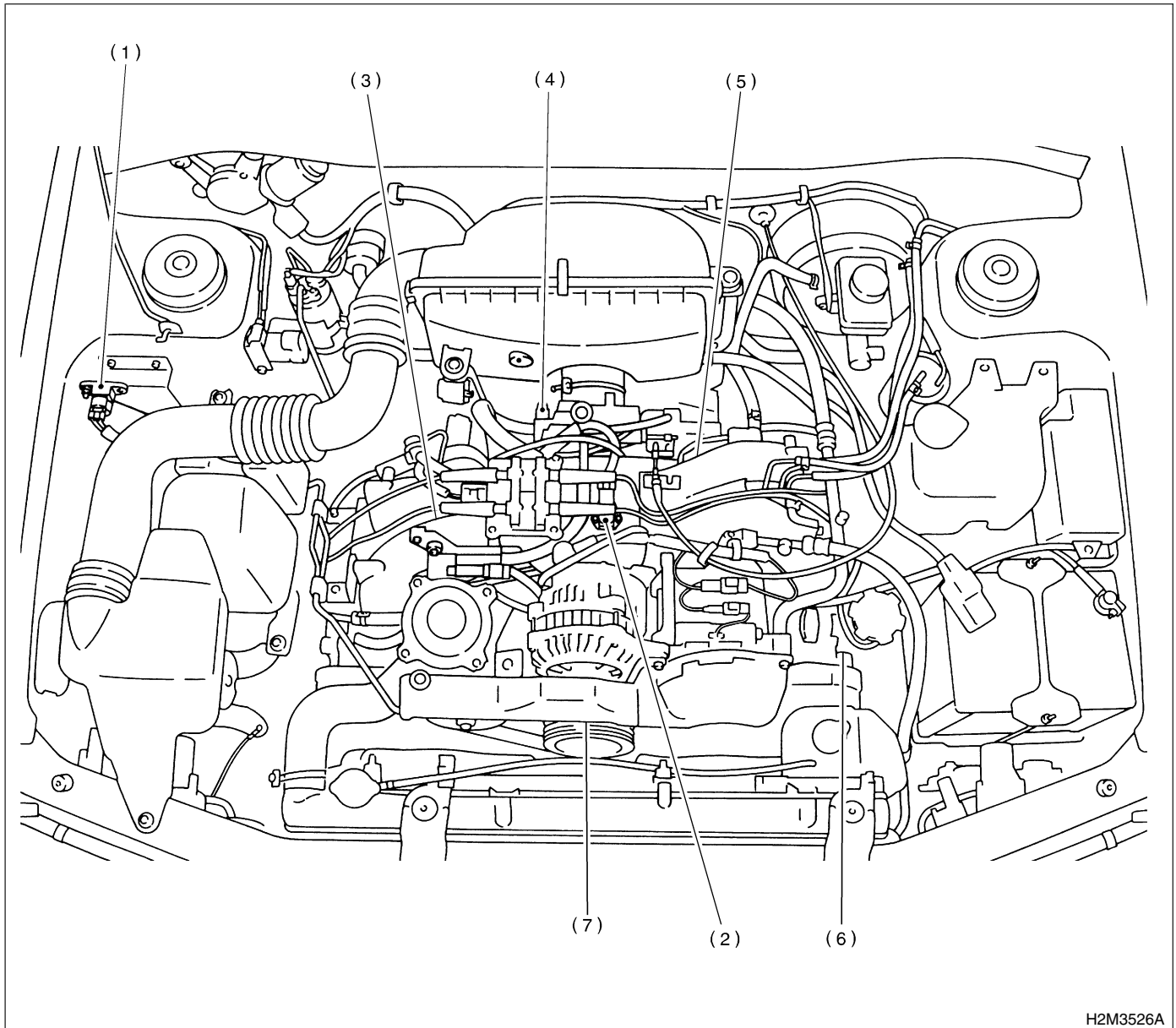

- | | | |
|--|---------------------------------------|------------------------------|
| (1) Atmospheric pressure sensor | (3) Engine coolant temperature sensor | (5) Knock sensor |
| (2) Intake air temperature and pressure sensor | (4) Throttle position sensor | (6) Camshaft position sensor |
| | (7) Crankshaft position sensor | |

ELECTRICAL COMPONENTS LOCATION

Engine

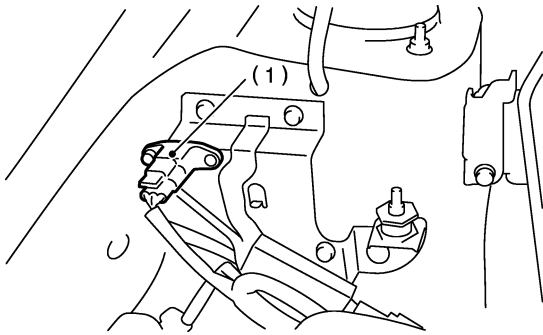

B2M3713A

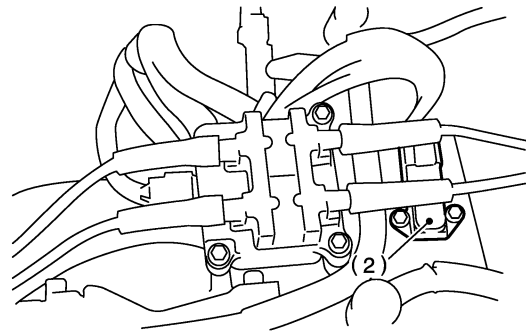

B2M3714A

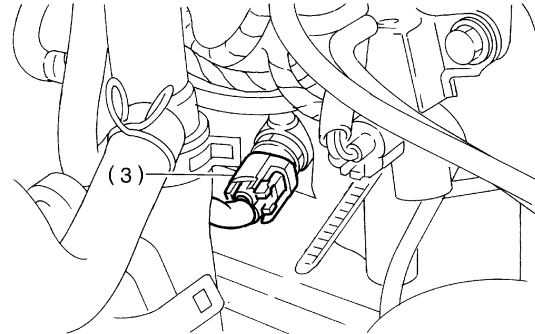

S2M1248B

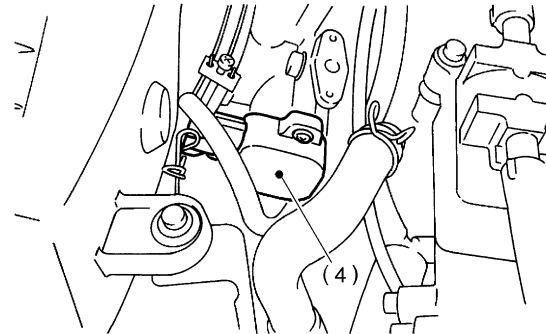

B2M2240A

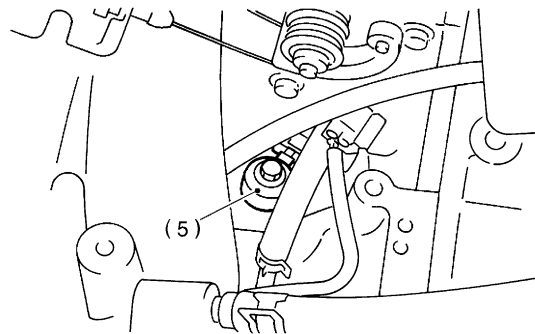

B2M2241A

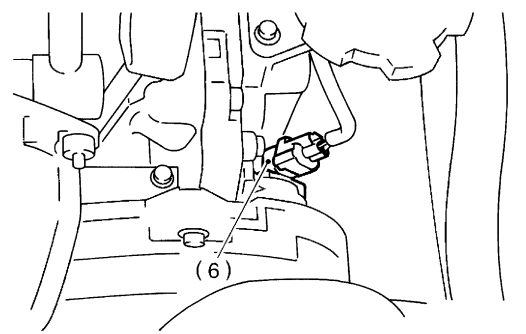

B2M2242A

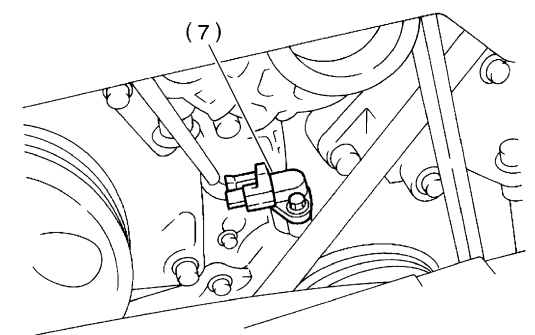

B2M0213J

SUBARU.

ELECTRICAL COMPONENTS LOCATION

Engine

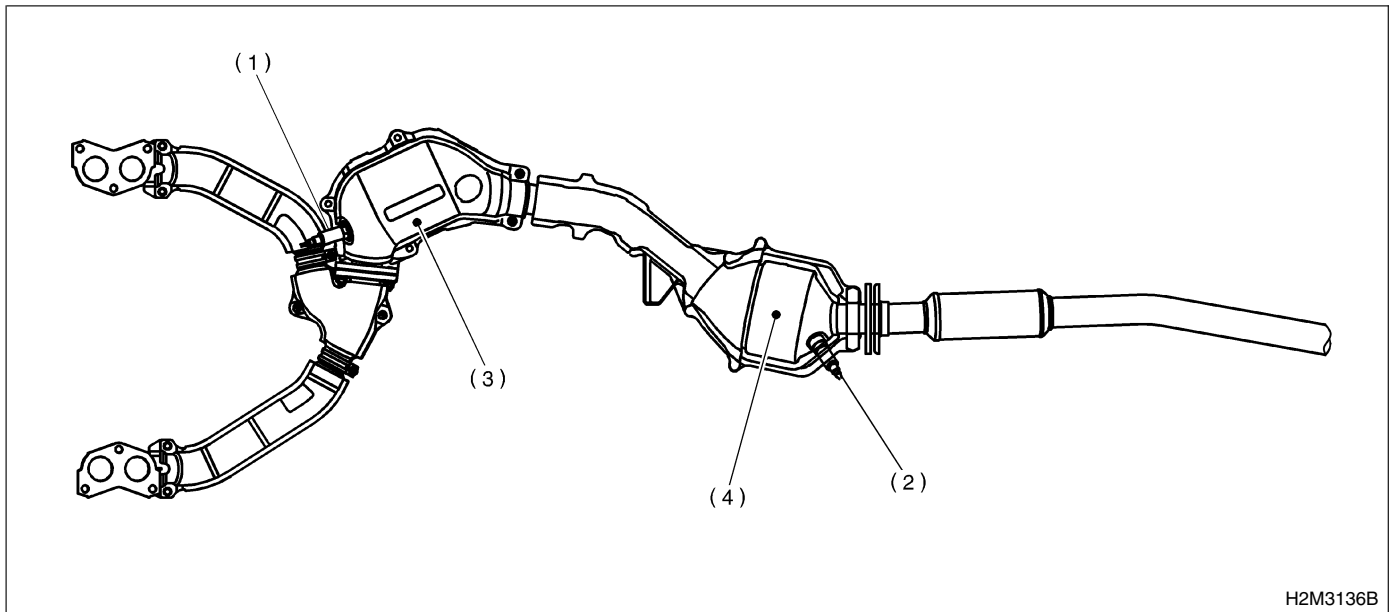

- (1) Front oxygen (A/F) sensor
- (2) Rear oxygen sensor
- (3) Front catalytic converter
- (4) Rear catalytic converter

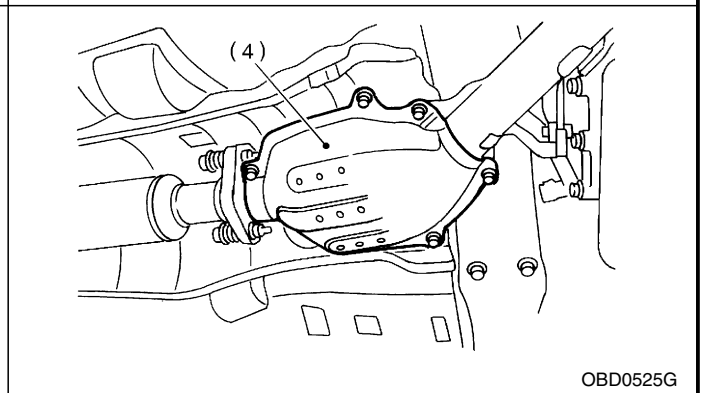
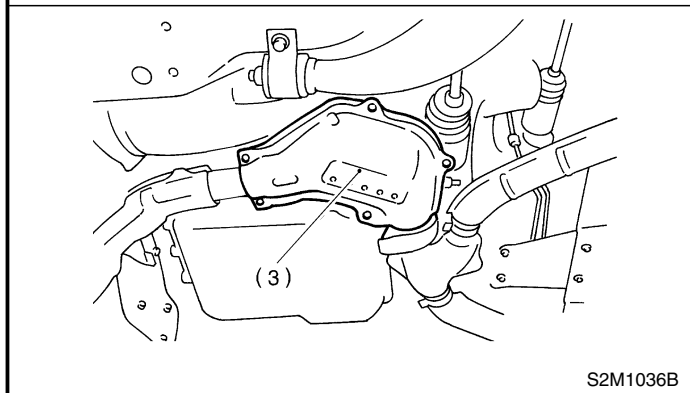
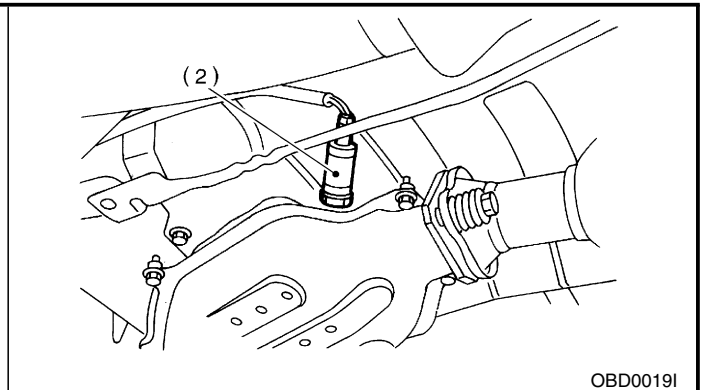
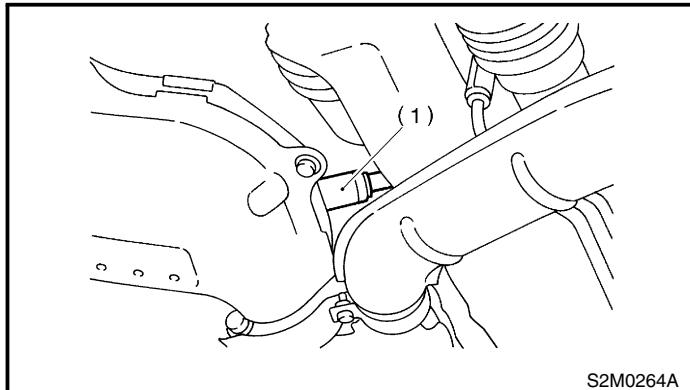

ELECTRICAL COMPONENTS LOCATION

Engine

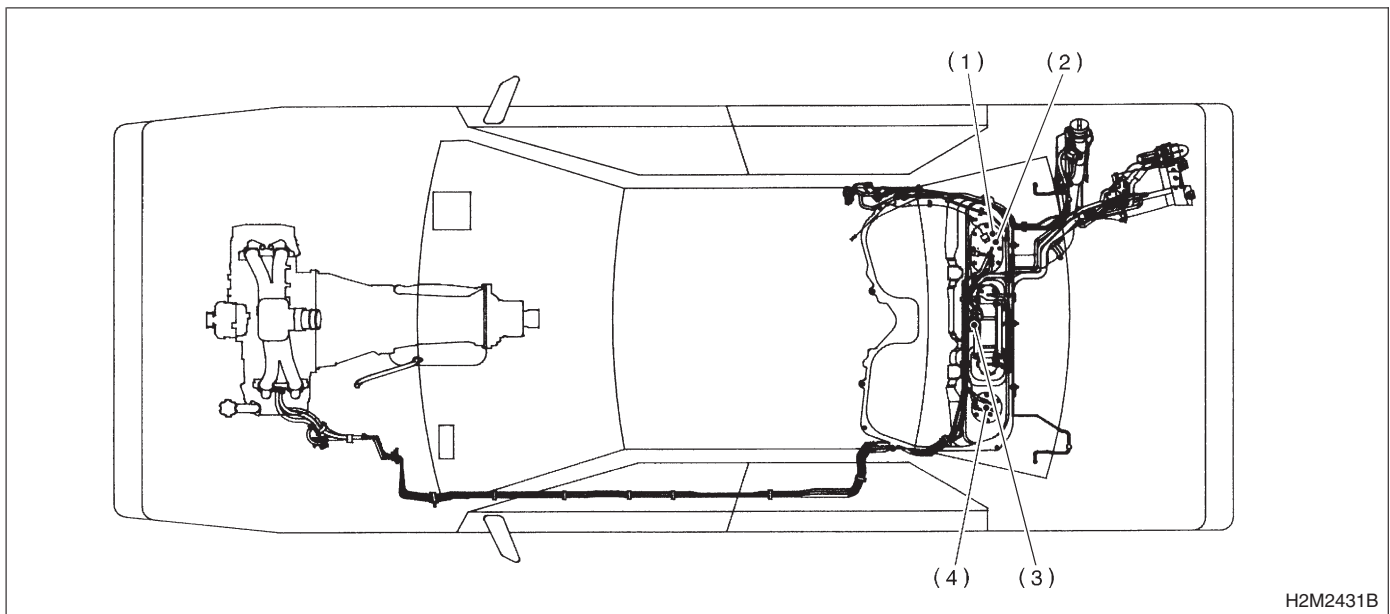

H2M2431B

- (1) Fuel level sensor
- (2) Fuel temperature sensor

- (3) Fuel tank pressure sensor
- (4) Fuel sub level sensor

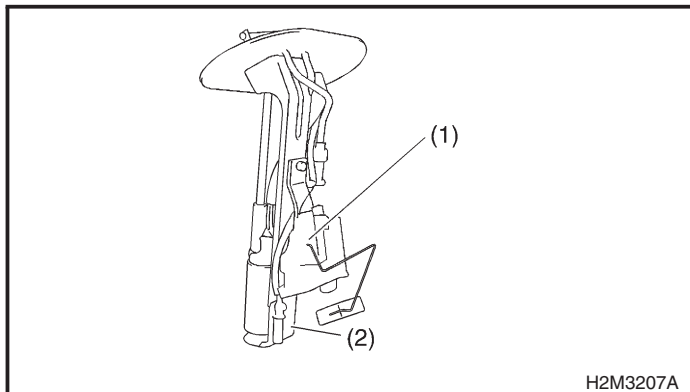

H2M3207A

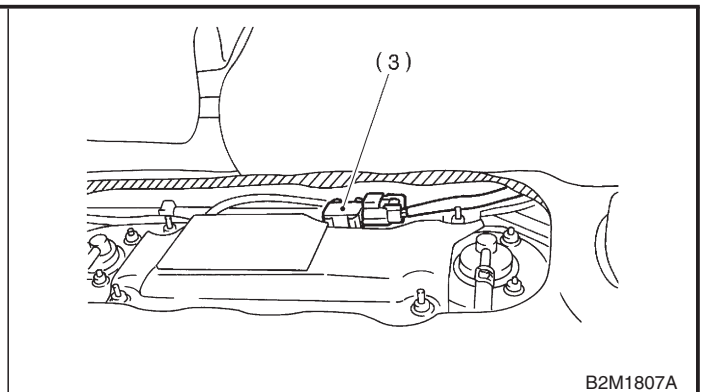

B2M1807A

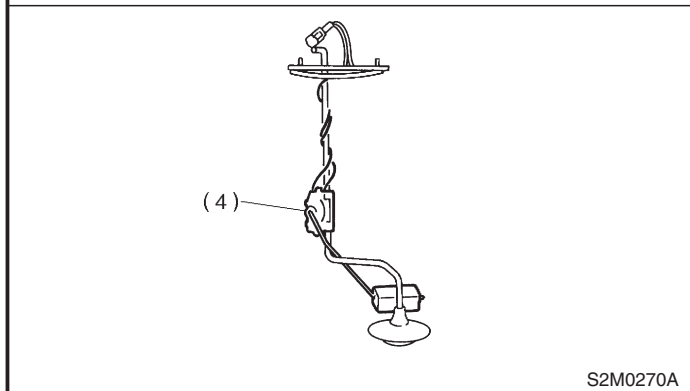

S2M0270A

SUBARU.

ELECTRICAL COMPONENTS LOCATION

Engine

● Solenoid Valve, Emission Control System Parts And Ignition System Parts

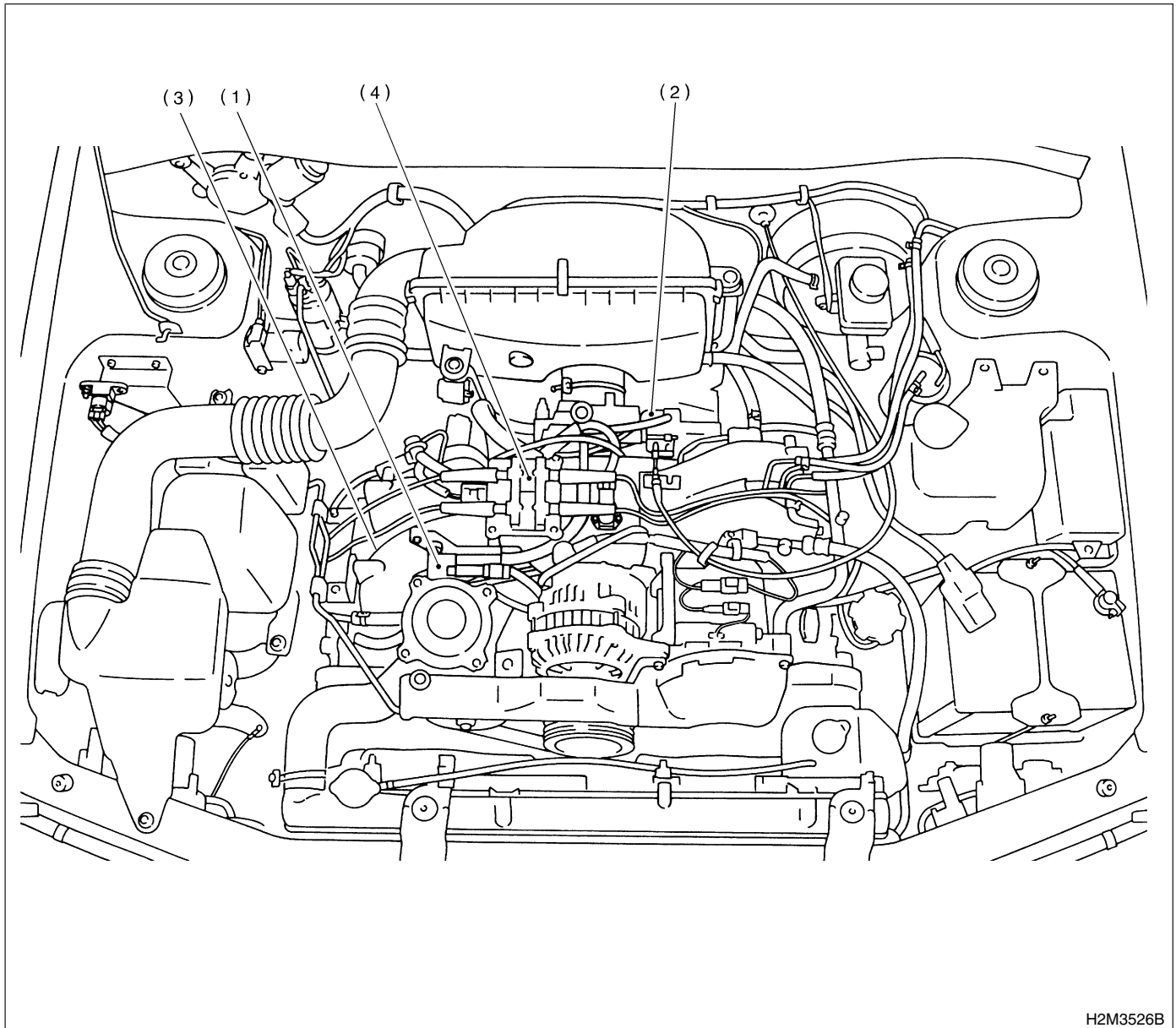

- (1) Air assist injector solenoid valve
- (2) Idle air control solenoid valve

- (3) Purge control solenoid valve
- (4) Ignition coil & ignitor ASSY

ELECTRICAL COMPONENTS LOCATION

Engine

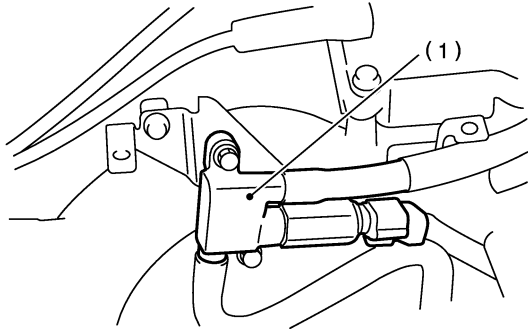

B2M3715A

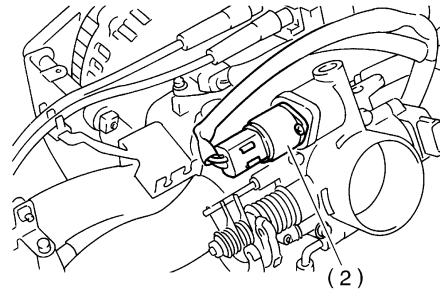

H2M3259A

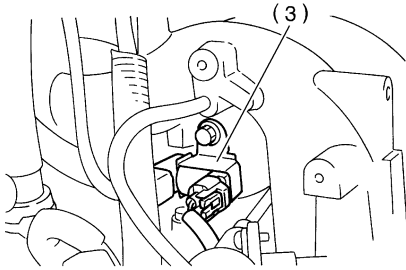

H2M3258B

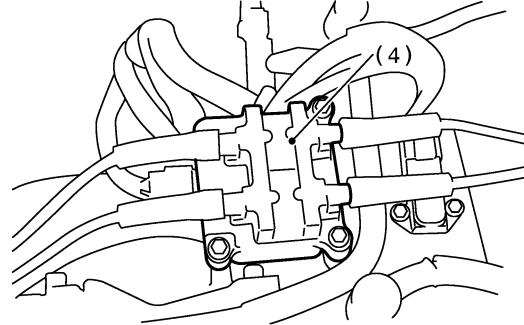

B2M3720A

ELECTRICAL COMPONENTS LOCATION

Engine

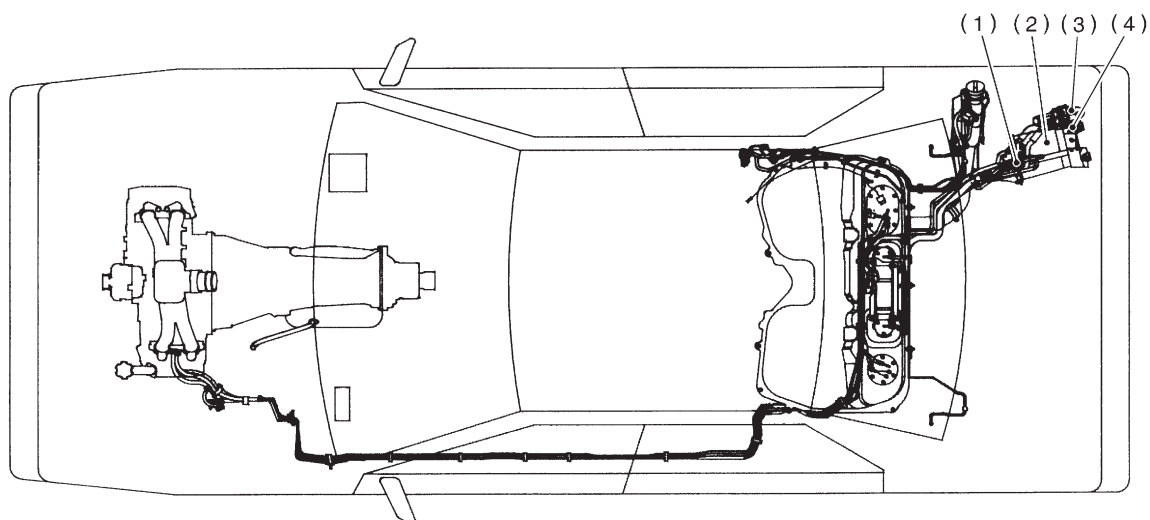

H2M2431C

- (1) Pressure control solenoid valve
- (2) Canister

- (3) Drain valve
- (4) Drain filter

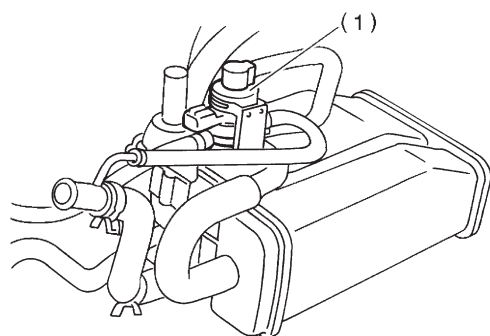

H2M2443A

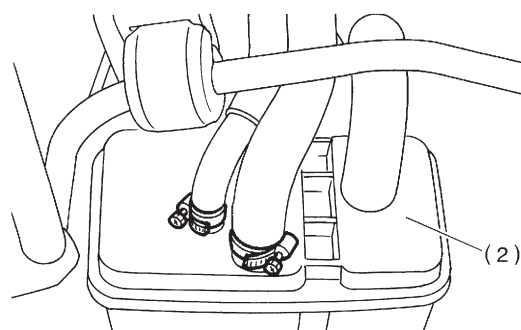

S2M0949B

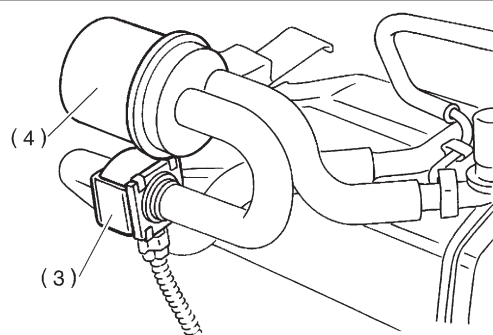

H2M2444A

SUBARU.

MEMO:

ELECTRICAL COMPONENTS LOCATION

Engine

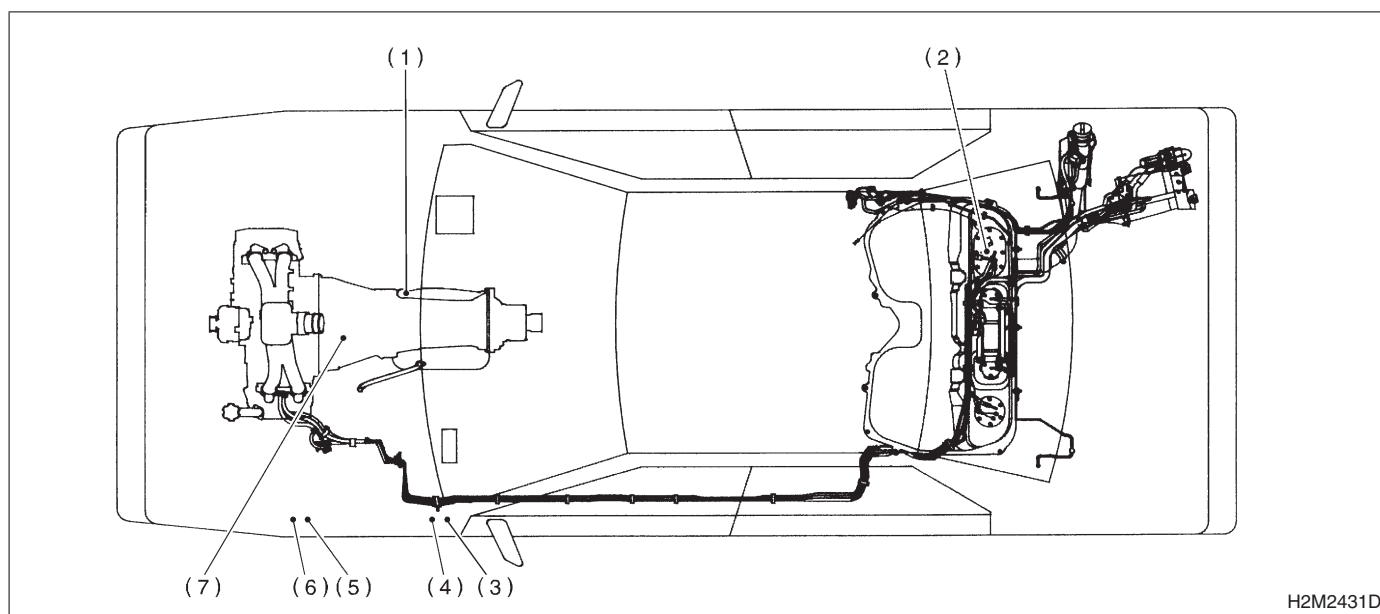

- | | | |
|---|-----------------------------|----------------------------|
| (1) Inhibitor switch (AT vehicles only) | (3) Main relay | (6) Radiator sub fan relay |
| (2) Fuel pump | (4) Fuel pump relay | (7) Starter |
| | (5) Radiator main fan relay | |

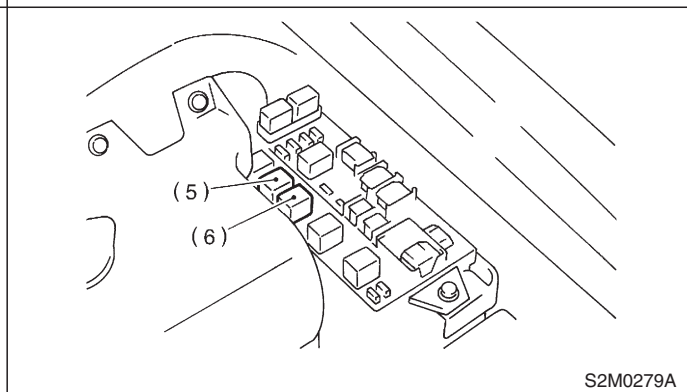
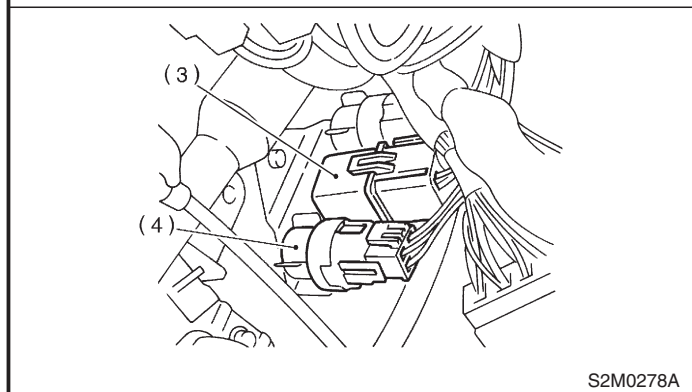
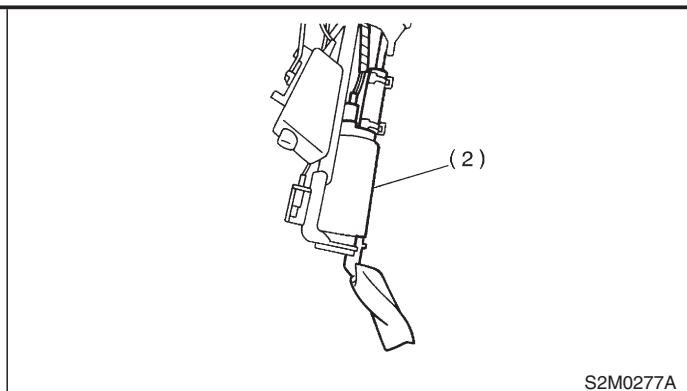
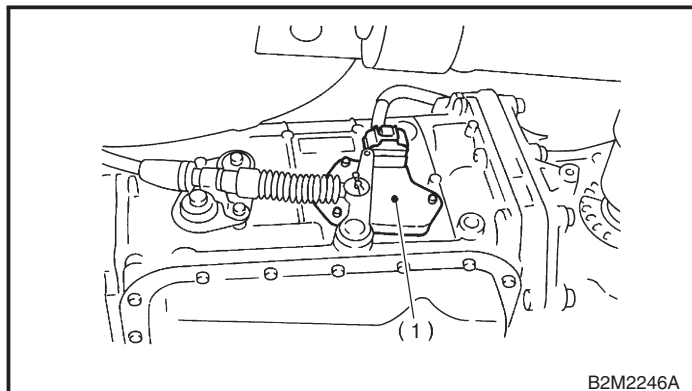

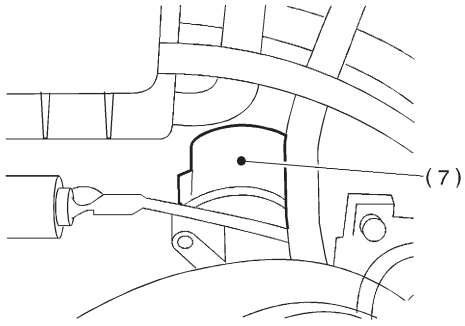

B2M2247B

SUBARU.

ELECTRICAL COMPONENTS LOCATION

Engine

3. TRANSMISSION S008507A1302

● Module

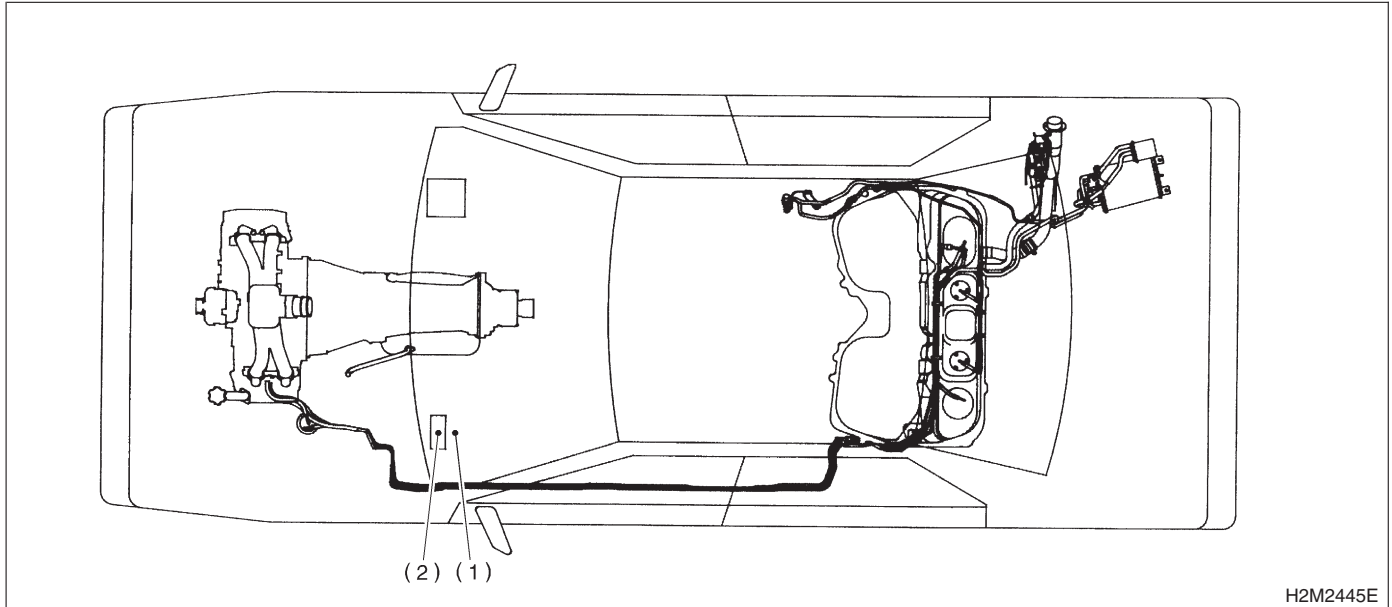

(1) Transmission Control Module (TCM) (for AT vehicles)

(2) AT diagnostic indicator light (for AT vehicles)

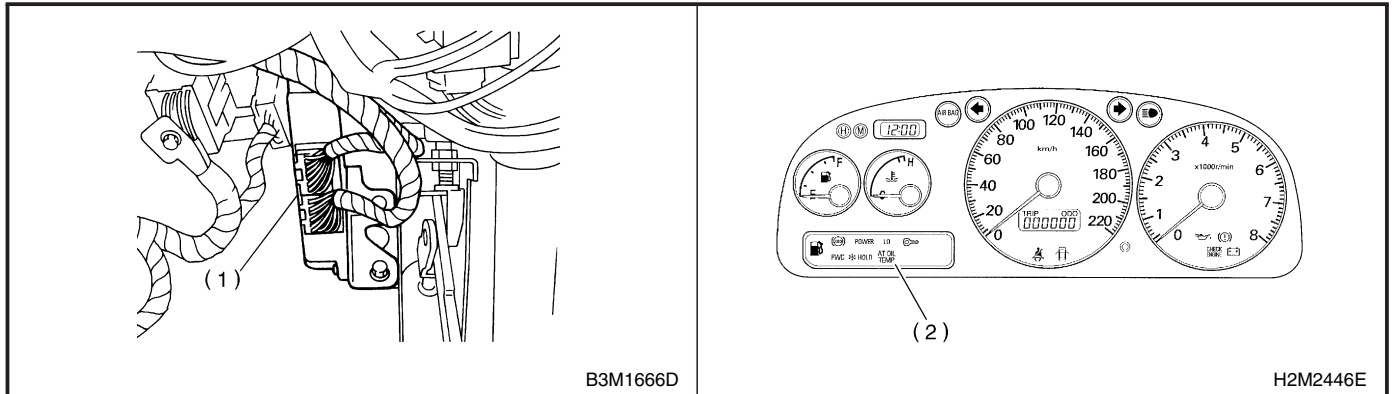

B3M1666D

● Sensor

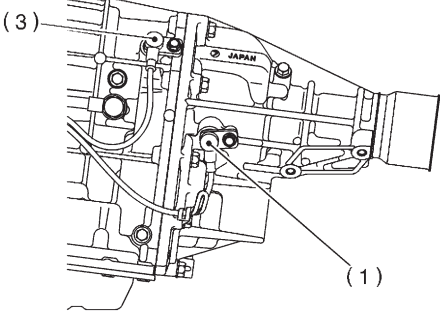
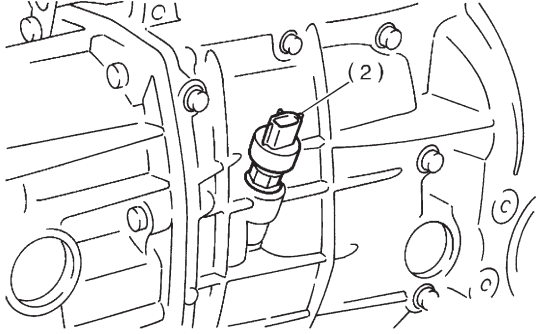
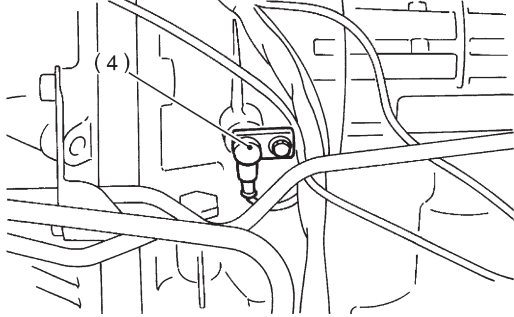
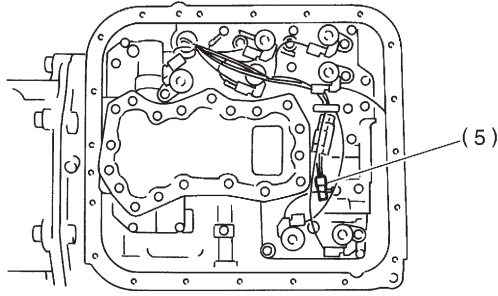
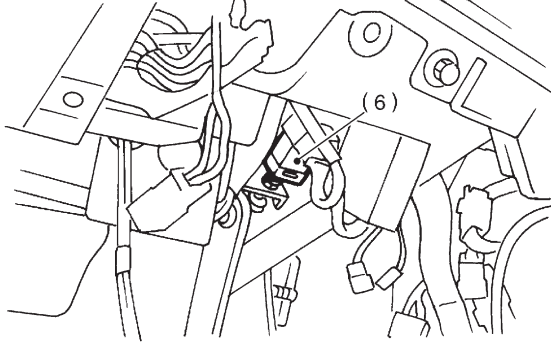
 <p data-bbox="678 554 776 573">B2M2258A</p>	 <p data-bbox="1365 554 1463 573">B2M2259A</p>
 <p data-bbox="678 940 776 959">B2M2260A</p>	 <p data-bbox="1365 940 1463 959">B2M2261A</p>
 <p data-bbox="678 1352 776 1371">OBD0653B</p>	<p data-bbox="1024 1157 1263 1192">SUBARU</p>

- (1) Vehicle speed sensor 1 (for AT vehicles)
- (2) Vehicle speed sensor 2 (for MT vehicles)
- (3) Vehicle speed sensor 2 (for AT vehicles)
- (4) Torque converter turbine speed sensor
- (5) ATF temperature sensor (for AT vehicles)
- (6) Brake light switch

ELECTRICAL COMPONENTS LOCATION

Engine

● Solenoid Valve And Switch (AT Vehicles)

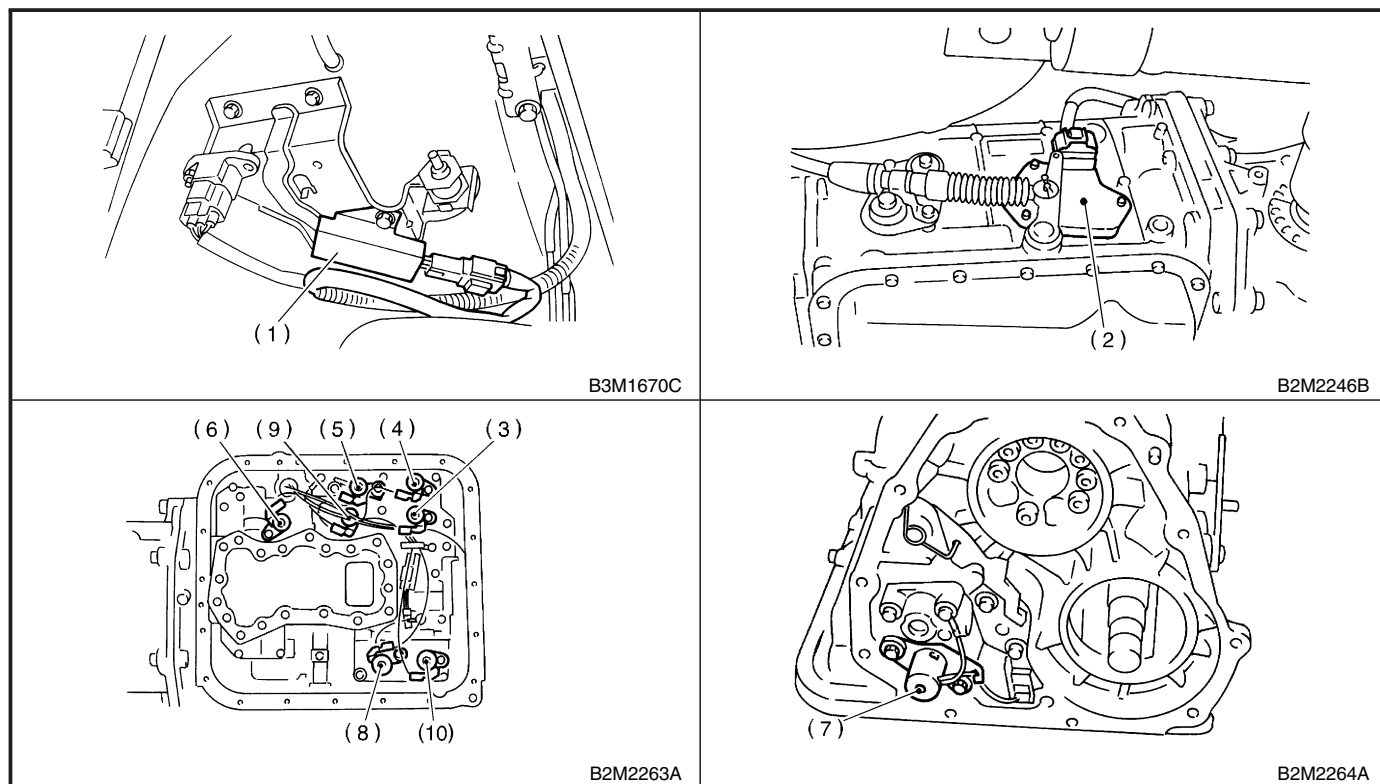

- (1) Dropping resistor
- (2) Inhibitor switch
- (3) Shift solenoid valve 1
- (4) Shift solenoid valve 2
- (5) Line pressure duty solenoid
- (6) Lock-up duty solenoid
- (7) Transfer duty solenoid
- (8) 2-4 brake duty solenoid
- (9) Low clutch timing solenoid valve
- (10) 2-4 brake timing solenoid valve

● Solenoid Valve And Switch (MT Vehicles)

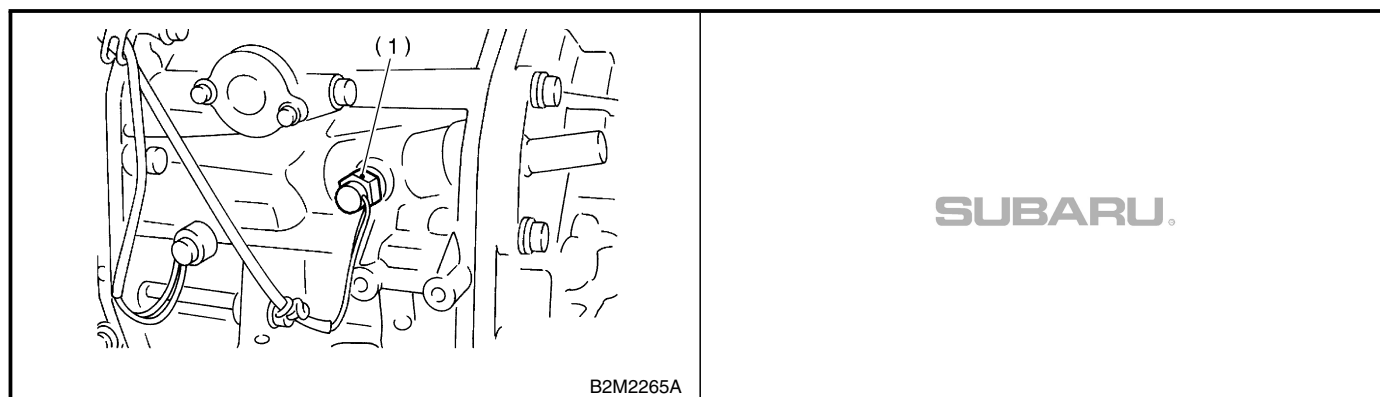

- (1) Neutral position switch