

# VENT VALVE

Emission Control (Aux. Emission Control Devices)

## 12. Vent Valve S110033

### A: REMOVAL S110033A18

1) Remove fuel tank. <Ref. to FU-66 REMOVAL, Fuel Tank.>

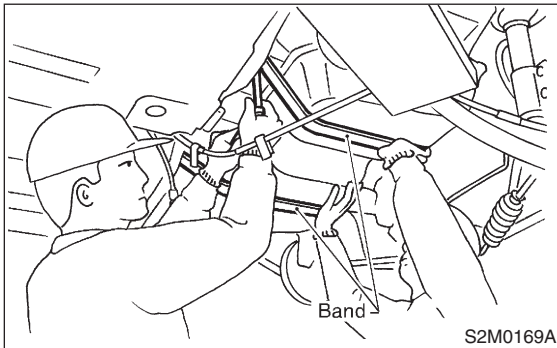

2) Remove protector cover.

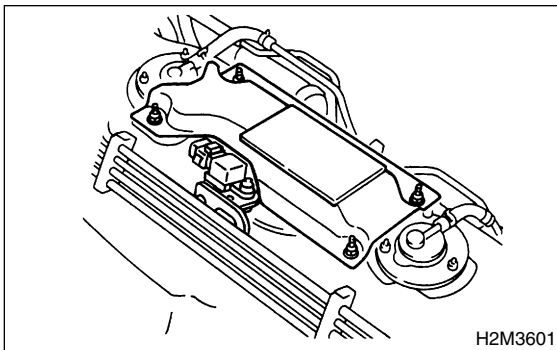

3) Move clips, and disconnect hoses from vent valve.

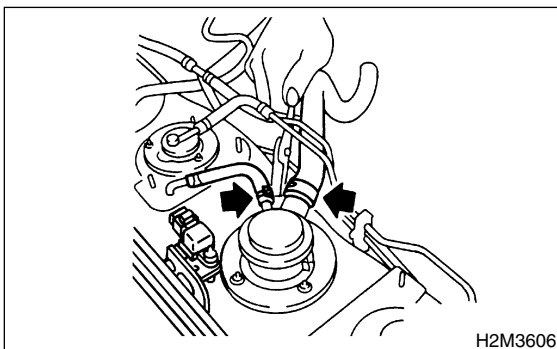

4) Remove nuts which install vent valve on fuel tank.

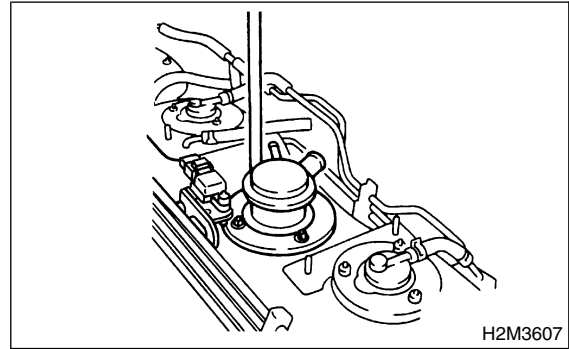

### B: INSTALLATION S110033A11

Install in the reverse order of removal.

**CAUTION:**  
Replace rubber seat with a new one.

**Tightening torque:**  
*T: 4.4 N·m (0.45 kgf·m, 3.3 ft·lb)*

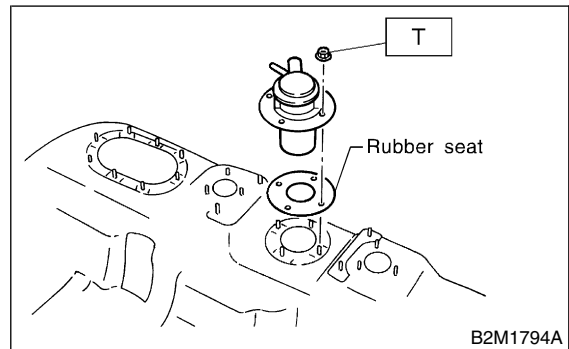

### C: INSPECTION S110033A10

Make sure that hoses are not cracked or loose.