

FUEL TEMPERATURE SENSOR

Emission Control (Aux. Emission Control Devices)

7. Fuel Temperature Sensor S110032

A: REMOVAL S110032A18

- 1) Release fuel pressure. <Ref. to FU-64 RELEASING OF FUEL PRESSURE, Fuel.>
- 2) Open fuel filler lid, and remove fuel filler cap.

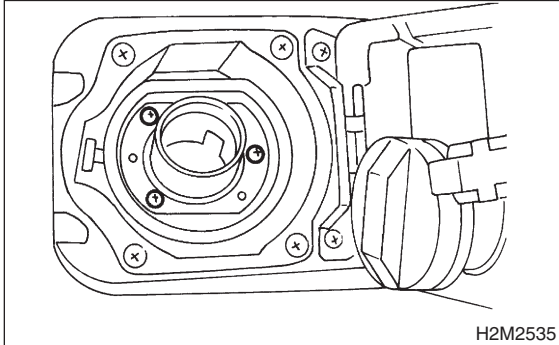

- 3) Disconnect battery ground cable.

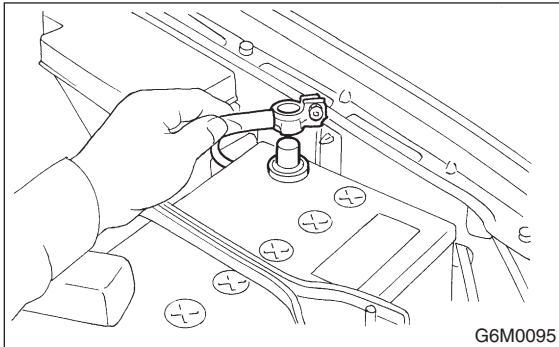

- 4) Disconnect connector from fuel pump.

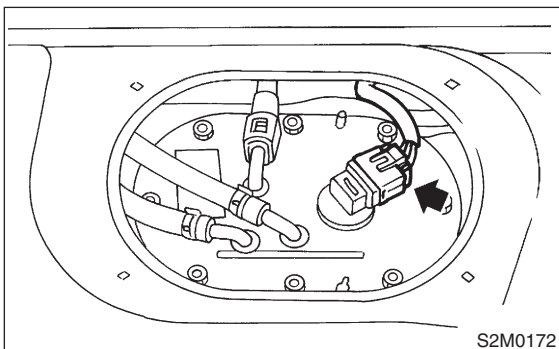

- 5) Move clips, and then disconnect fuel delivery hose (A), return hose (B) and jet pump hose (C).

- 6) Disconnect quick connector, and then disconnect fuel delivery hose (A). <Ref. to FU-85 REMOVAL, Fuel Delivery, Return and Evaporation Lines.>

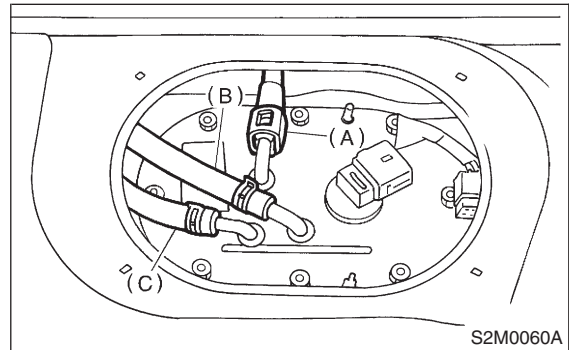

- 7) Remove nuts which install fuel pump assembly onto fuel tank.

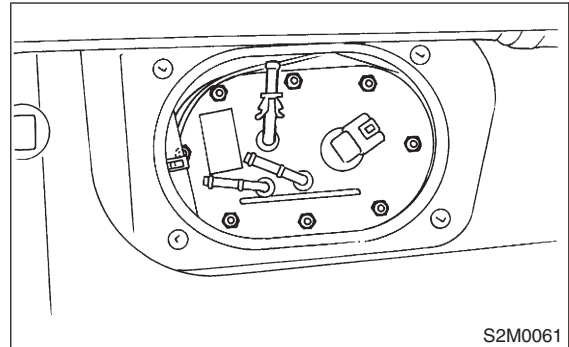

- 8) Take off fuel pump assembly from fuel tank.

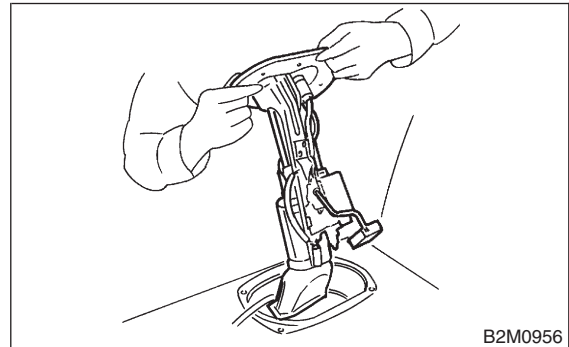

- 9) Disconnect connector from fuel pump bracket.

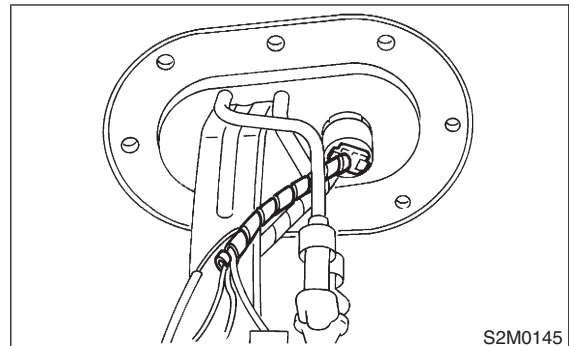

FUEL TEMPERATURE SENSOR

Emission Control (Aux. Emission Control Devices)

10) Remove main fuel level sensor from fuel pump assembly. <Ref. to EC-9 REMOVAL, Main Fuel Level Sensor.>

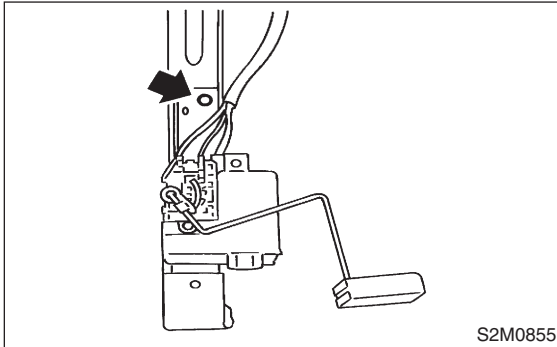

(4) Connect connector to fuel pump relay.

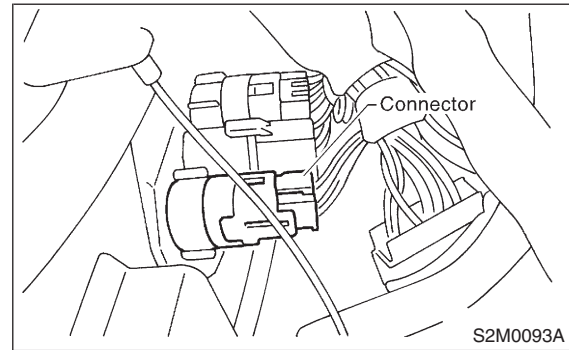

NOTE:

Fuel temperature sensor is a unit with fuel pump. If replacing it, replace as a fuel pump.

B: INSTALLATION

S110032A11

CAUTION:

Leave fuel filler cap open when tightening nuts, to prevent fuel from flowing out through fuel delivery and return pipes. Close fuel filler cap after tightening nuts.

Install in the reverse order of removal. Do the following:

- (1) Always use new gaskets.
- (2) Ensure sealing portion is free from fuel or foreign particles before installation.
- (3) Tighten nuts in alphabetical sequence shown in figure to specified torque.

Tightening torque:

4.4 N·m (0.45 kgf-m, 3.3 ft-lb)

