

FRONT CATALYTIC CONVERTER

Emission Control (Aux. Emission Control Devices)

2. Front Catalytic Converter S110017

A: REMOVAL S110017A18

- 1) Disconnect battery ground cable.

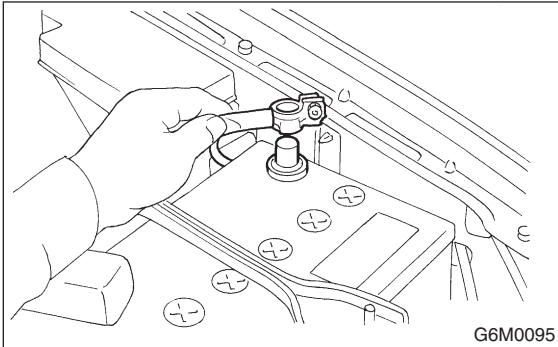

- 2) Disconnect front oxygen (A/F) sensor connector.

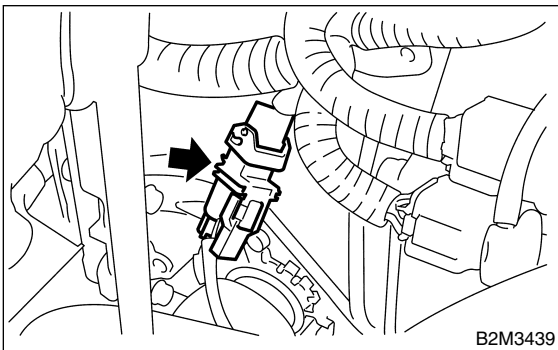

- 3) Lift-up the vehicle.
4) Remove under cover.
5) Disconnect rear oxygen sensor connector.

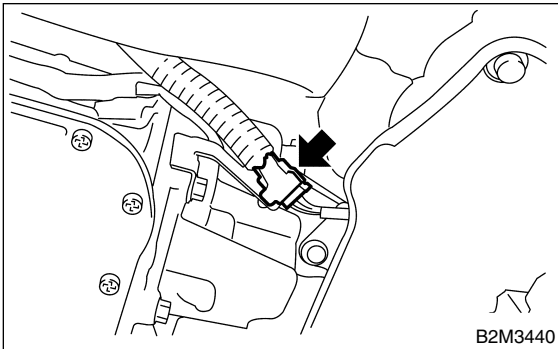

- 6) Separate front and rear catalytic converter assembly from rear exhaust pipe.

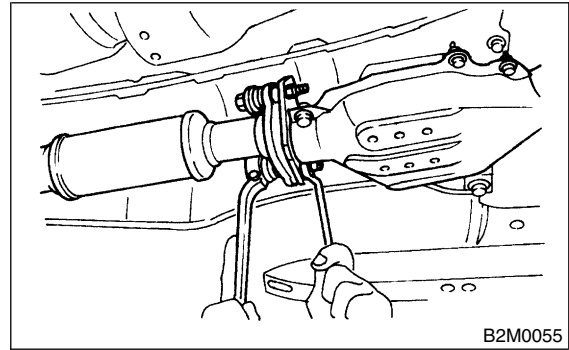

- 7) Remove front exhaust pipe from cylinder heads.

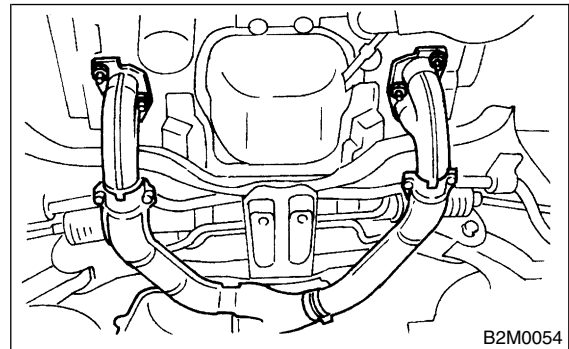

- 8) Remove front and rear catalytic converter assembly from hanger bracket.

CAUTION:

- Be careful not to pull down center exhaust pipe.
- After removing center exhaust pipe, do not apply excessive pulling force on rear exhaust pipe.

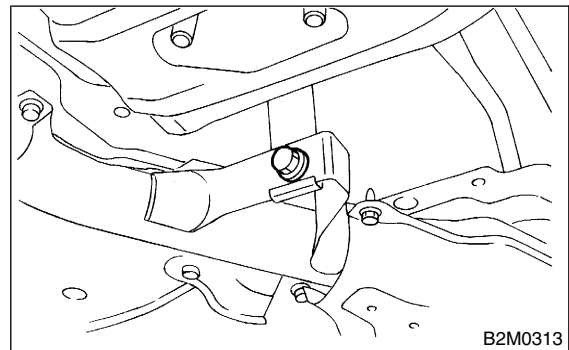

FRONT CATALYTIC CONVERTER

Emission Control (Aux. Emission Control Devices)

9) Separate front and rear catalytic converter assembly from front exhaust pipe.

NOTE:

The rear catalytic converter is integrated with front catalytic converter. Therefore, the procedure for removing rear catalytic converter is the same as the description above.

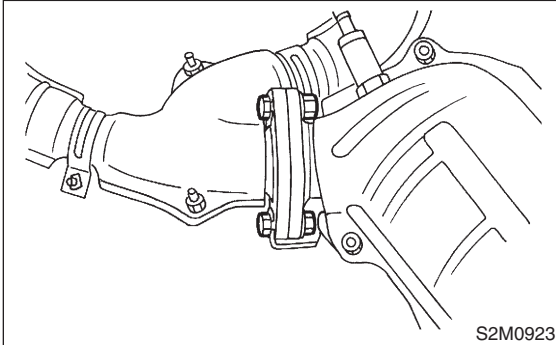

B: INSTALLATION

S110017A11

CAUTION:

Replace gaskets with new ones.

1) Install front and rear catalytic converter assembly to front exhaust pipe.

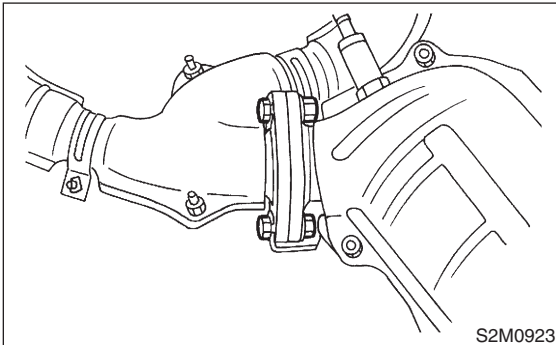

2) Install front and rear catalytic converter assembly.

Temporarily tighten bolt which installs center exhaust pipe to hanger bracket.

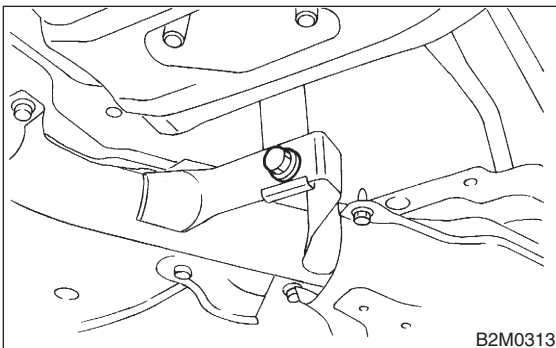

3) Install front exhaust pipe to cylinder heads.

Tightening torque:

30 N-m (3.1 kgf-m, 22.4 ft-lb)

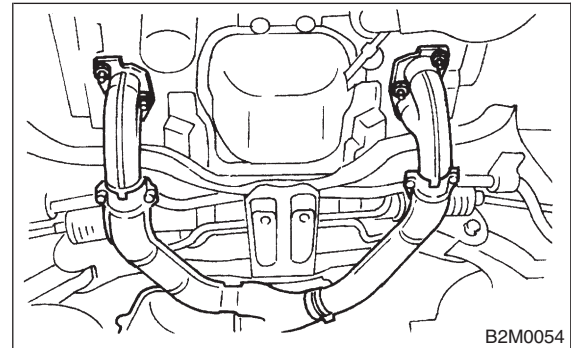

4) Install front and rear catalytic converter assembly to rear exhaust pipe.

Tightening torque:

18 N-m (1.8 kgf-m, 13.0 ft-lb)

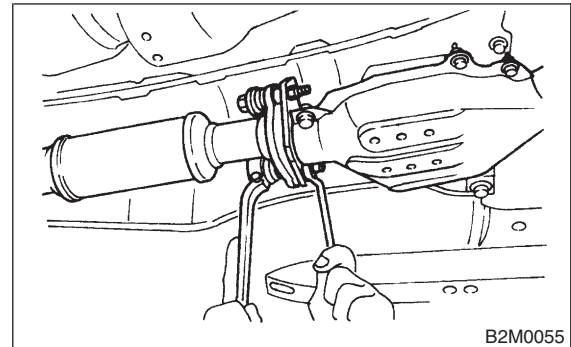

5) Tighten bolt which holds front and rear catalytic converter assembly to hanger bracket.

Tightening torque:

35 N-m (3.6 kgf-m, 26.0 ft-lb)

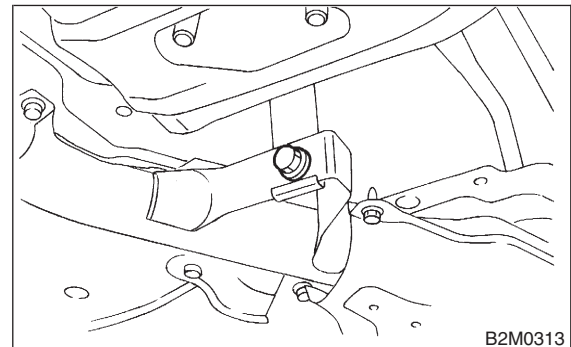

FRONT CATALYTIC CONVERTER

Emission Control (Aux. Emission Control Devices)

- 6) Connect rear oxygen sensor connector.

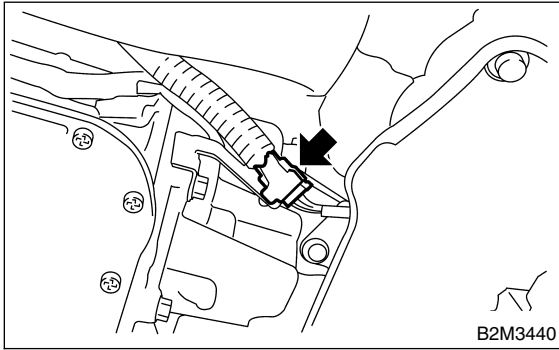

- 7) Install under cover.
8) Lower the vehicle.
9) Connect connector to front oxygen (A/F) sensor.

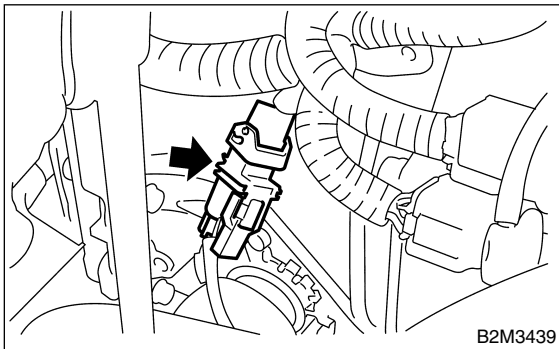

- 10) Connect battery ground cable.

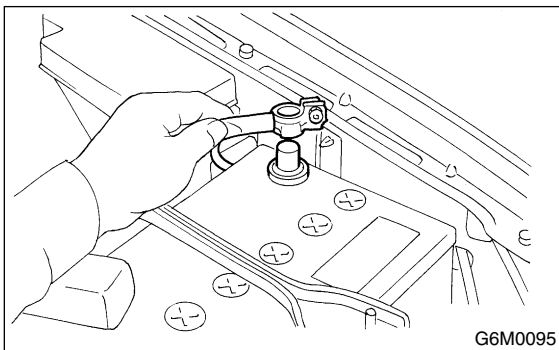

C: INSPECTION

S110017A10

- 1) Make sure there are no exhaust leaks from connections and welds.
2) Make sure there are no holes or rusting.