

## 9. Rear Drum Brake Assembly

S405179

### A: REMOVAL

S405179A18

- 1) Remove wheel.
- 2) Remove axle nut.
- 3) Remove brake drum
- 4) Unscrew the brake pipe flare nut and disconnect brake pipe.

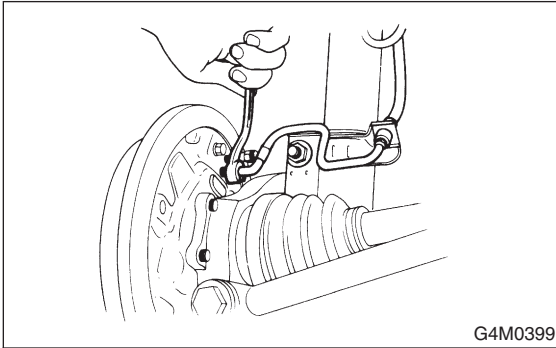

G4M0399

- 5) Remove hub. <Ref. to DS-22 REMOVAL, Rear Axle.>
- 6) Remove the bolts installing back plate, and then, remove brake assembly.

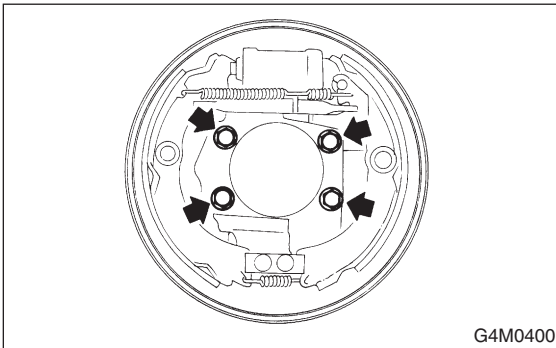

G4M0400

- 7) Remove the bolts installing wheel cylinder on back plate, and remove it.

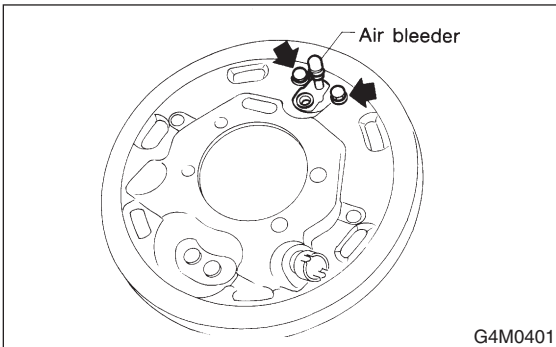

G4M0401

### B: INSTALLATION

S405179A11

- 1) Install wheel cylinder on back plate, and tighten bolts.

#### Tightening torque:

**10 N·m (1.0 kgf-m, 7.2 ft-lb)**

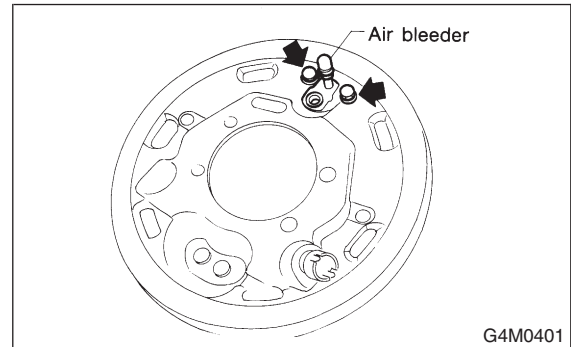

G4M0401

- 2) Install brake assembly on housing, and tighten bolts to install back plate.

#### Tightening torque:

**52 N·m (5.3 kgf-m, 38.3 ft-lb)**

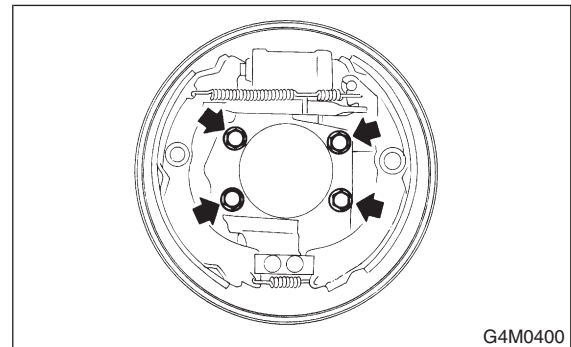

G4M0400

- 3) Install hub. <Ref. to DS-25 INSTALLATION, Rear Axle.>
- 4) Connect brake pipe, and tighten brake pipe flange nut.

#### Tightening torque:

**14.7 N·m (1.5 kgf-m, 10.8 ft-lb)**

- 5) Set the outside diameter of brake shoes less than 0.5 — 0.8 mm (0.020 — 0.031 in) in comparison with the inside diameter of brake drum.
- 6) Install brake drum.
- 7) After installing brake assembly, bleed air from brake line.

## C: DISASSEMBLY

S405179A06

- 1) Remove right and left dust boots from wheel cylinder.
- 2) Remove piston, cup, spring and air bleeder screw and cap.

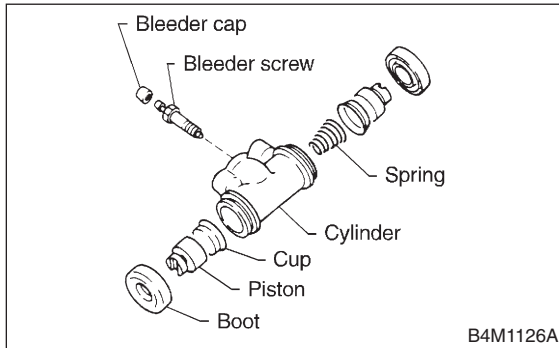

## D: ASSEMBLY

S405179A02

- 1) Clean all parts in brake fluid. Check and replace faulty parts.
  - Cup and boot for damage or fatigue
  - Cylinder, piston and spring or damage or rust formation
- 2) Assembly is the reverse order of disassembly.
  - (1) When installing the cup, use ST, apply brake fluid to the frictional surface for smooth installation and pay attention to cup direction.
  - (2) STs are available in different sizes.

### CAUTION:

- When replacing the repair kit, make sure that the sizes of cylinder and cup are the same as those which were replaced.
- Use only the tool of the correct size.

ST: ADAPTER	
Applicable size	Part No.
19.05 mm (3/4 in)	926460000

### CAUTION:

While assembling, be careful to prevent any metal chip, dust or dirt from entering the wheel cylinder.

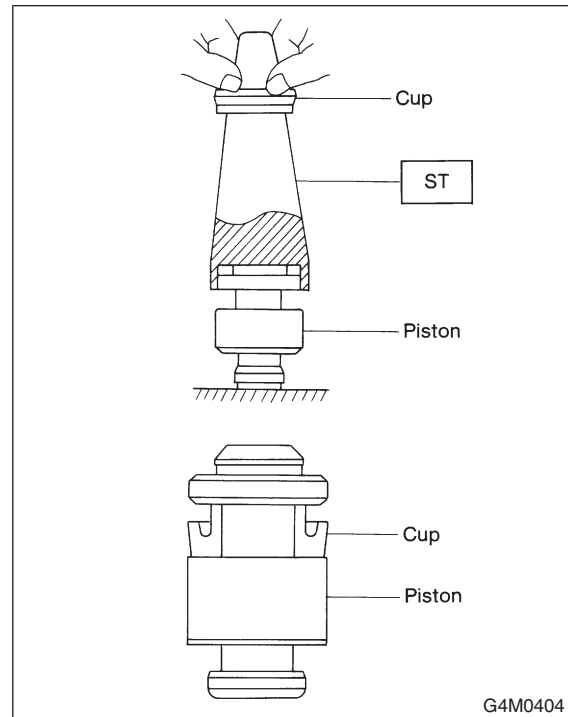

# REAR DRUM BRAKE ASSEMBLY

## Brake

3) Apply rubber grease to the boot inside as shown in Figure.

### Grease:

**NIGLUBE RX-2 (Part No. 003606000)**

### CAUTION:

**Never use brake grease.**

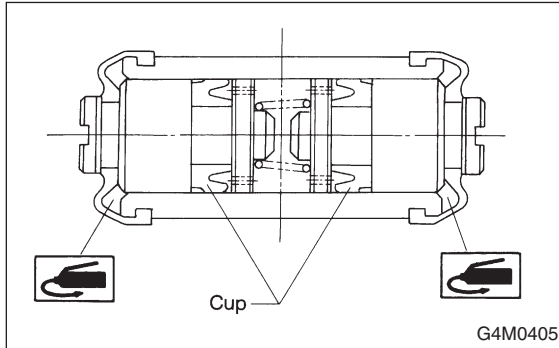

## E: INSPECTION

S405179A10

- 1) If the inside surface of brake drum is streaked, correct the surface. And, if it is unevenly worn, taperingly streaked, or the outside surface of brake drum is damaged, correct or replace it.
- 2) Measure the drum inner diameter.

**Drum inner diameter: "L"**

**Standard: 228.6 mm (9 in)**

**Service limit: 230.6 mm (9.08 in)**

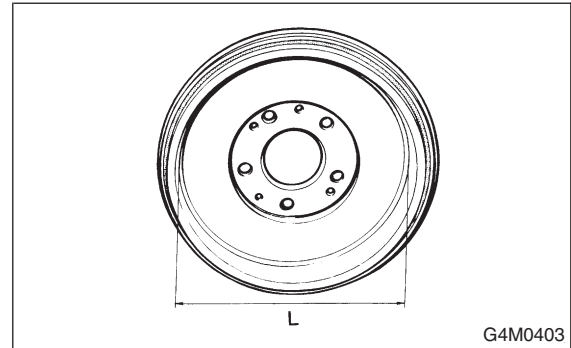

- 3) Measure the lining thickness.

**Lining thickness:**

**Standard: 4.1 mm (0.161 in)**

**Service limit: 1.5 mm (0.059 in)**

- 4) If the deformation or wear of back plate, shoe, etc. are notable, replace them.
- 5) When the shoe return spring tension is excessively weakened, replace it, taking care to identify upper and lower springs.