

5. Front Wiper Motor and Link

S902406

A: REMOVAL S902406A18

1) Detach weatherstrip and cowl panel. <Ref. to EI-20 REMOVAL, Cowl Panel.>

NOTE:

Apply silicone oil or soap water to both sides of cowl net to facilitate removal.

2) Disconnect electric connector, and remove motor attaching bolts.

Tightening torque:

5.9 N·m (0.6 kgf-m, 4.3 ft-lb)

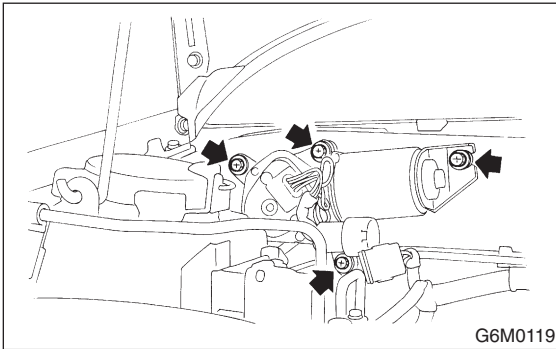

3) Remove nut securing motor link on the back side of motor.

Tightening torque:

15 N·m (1.5 kgf-m, 10.8 ft-lb)

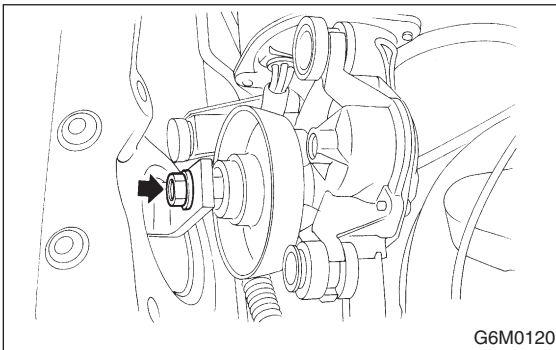

4) Remove nuts which secure sleeve unit.

Tightening torque:

5.9 N·m (0.6 kgf-m, 4.3 ft-lb)

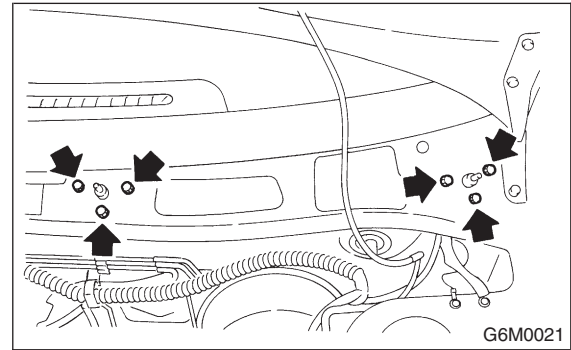

5) Remove wiper link from service hole in front panel.

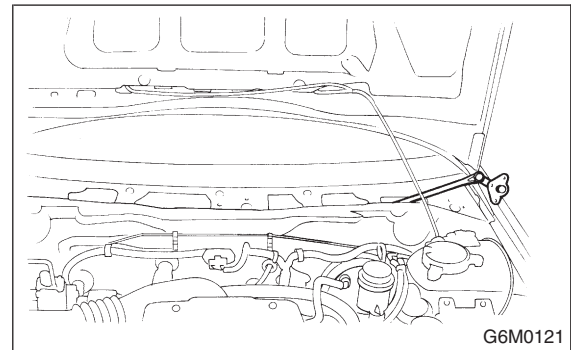

B: INSTALLATION S902406A11

Install in the reverse order of removal.

FRONT WIPER MOTOR AND LINK

Wiper and Washer Systems

C: INSPECTION S902406A10

1) Check wiper motor operation at low speed:
Connect battery to wiper motor. Check wiper motor for proper operation at low speed.

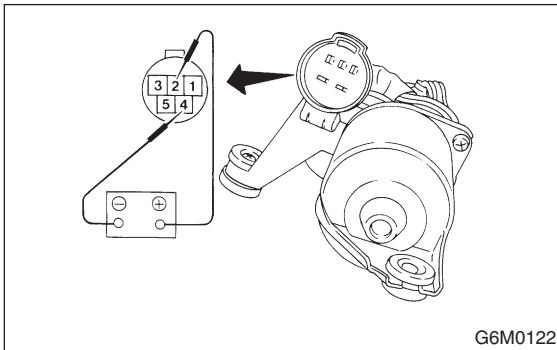

2) Check wiper motor operation at high speed:
Connect battery wiper motor. Check wiper motor for proper operation at high speed.

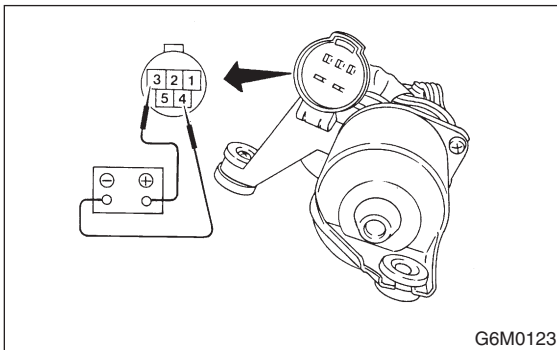

3) Check wiper motor for proper stoppage:
Connect battery to wiper motor. After operating wiper motor at low speed, disconnect battery to stop it.

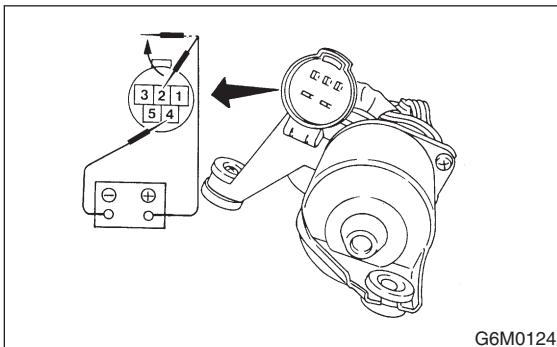

4) Reconnect battery and ensure that wiper motor stops at "AUTO STOP" after operating at low speed.

