

3. Rear Seat S908350

A: REMOVAL S908350A18

1. SEDAN AND COUPE S908350A1803

- 1) Remove bolts securing hinges (located at front of cushion) to body.
- 2) Slightly raise front of cushion while pushing down on cushion in the direction of "C". With cushion held in that position, move it forward until it is unhooked.

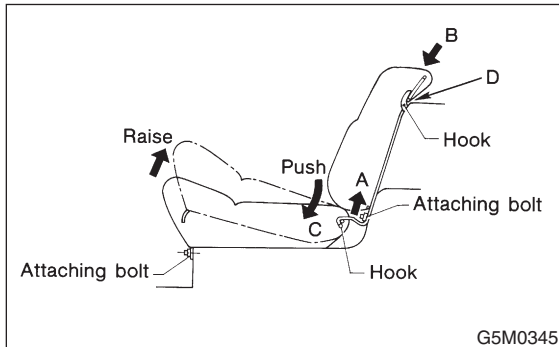

- 3) Remove bolts securing lower portion of backrest to body.
- 4) Lift rear seat backrest in direction "A" until it is released from upper hooks.

2. WAGON S908350A1801

- 1) Remove bolts securing hinges (located at front of seat) to body.

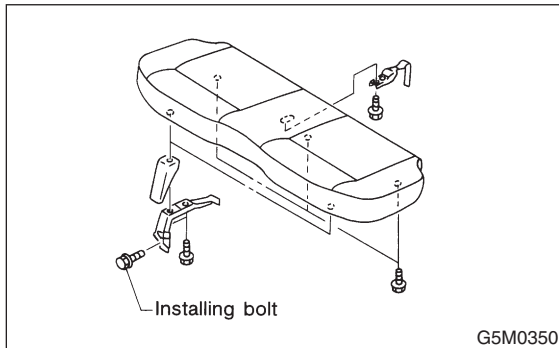

- 2) Pull strap (located in middle rear portion of cushion) to release lock. Lift cushion out and away from body.
- 3) Pull knobs (located at each side of backrest's upper portion) up to release lock, and fold backrest all the way forward.

- 4) Remove the bolt and then remove backrest (LH side).
- 5) Remove the bolt and then remove backrest (RH side) from hinge bracket.

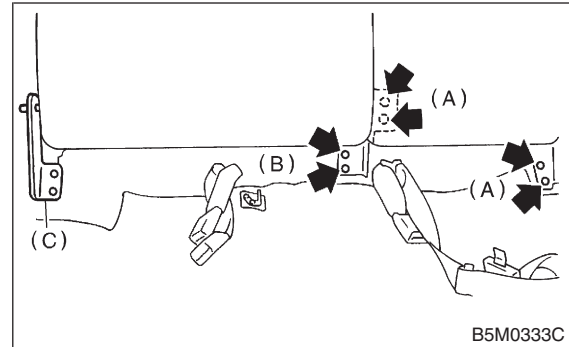

- (A) Bolt (LH side)
- (B) Bolt (RH side)
- (C) Hinge bracket

B: INSTALLATION

S908350A11

1. SEDAN AND COUPE

S908350A1103

- 1) Before installing backrest, ensure that trim panel, insulator and seat belt are properly installed.
- 2) Transfer outer seat belt webbing to front of backrest and fold backrest forward. Attach seat belt webbing to upper hooks (2 places), and move pillow in the direction of "B" until backrest is aligned with lower mounting holes in body.

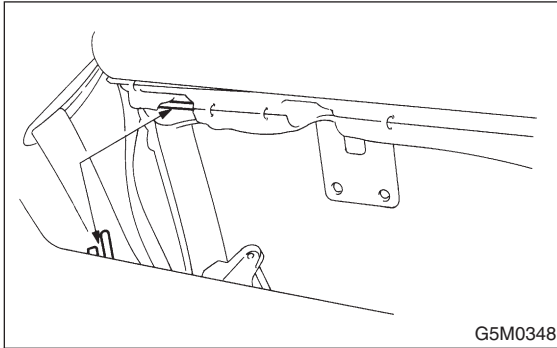

- 3) Secure lower center and both sides of backrest to body with bolts.
- 4) Slightly raise front section of cushion while pushing down on cushion in the direction of "C". With cushion held in that position, attach rear section of cushion to hooks at lower frame location.
- 5) Secure front of cushion to body with bolts.

CAUTION:

- Before installing seat, ensure that seat belt is placed on cushion.
- Confirm that winding of three-point type seat belt can operate regularly.

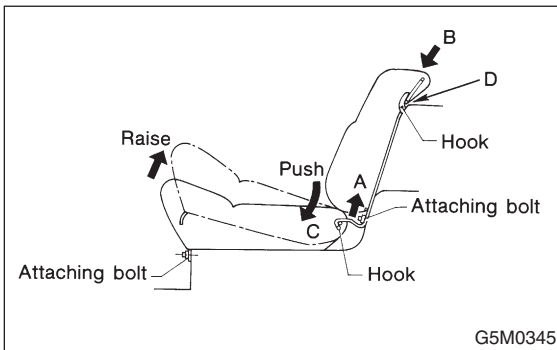
**2. WAGON**

S908350A1101

- 1) Install hinge bracket to body.
- 2) Insert right backrest hinge pin into hole in bracket. Tilt backrest backward until striker engages with lock.
- 3) Secure right backrest center hinge to body using a bolt.

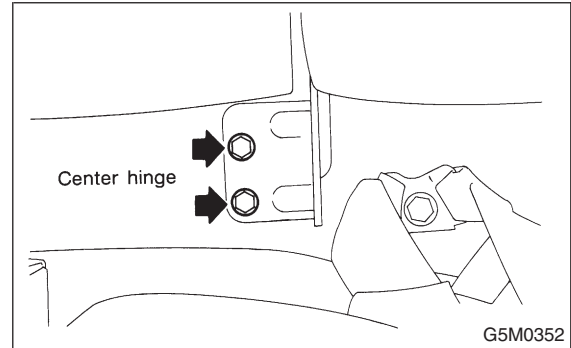

- 4) Temporarily install left backrest side hinge to body using a bolt, and fold backrest forward to the floor.
- 5) Roll up mat (located at rear of left backrest), and install center hinge using a bolt.
- 6) Tilt left backrest until striker engages with lock, and tighten bolt.
- 7) Install hinges to front of cushion and tighten with bolts. Check that lock properly engages.

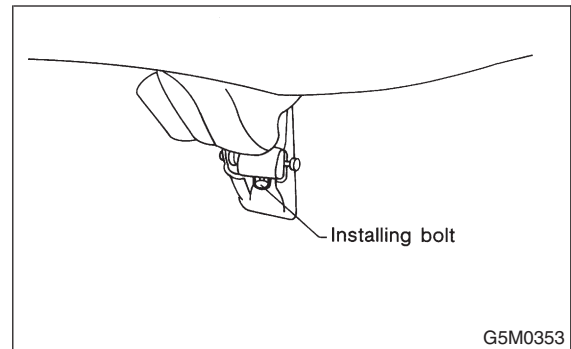

- 8) Fold backrest onto cushion and overlap trunk mat and mat at rear of backrest.

CAUTION:

- Do not allow center seat belt to get under cushion when folding cushion.
- Ensure that side seat belt tongue is free from cushion and trim panel.
- Lift front of cushion to ensure that cushion is properly locked.