

## 14. Rear Quarter Trim S911358

### A: REMOVAL S911358A18

#### 1. REAR QUARTER PILLAR UPPER TRIM PANEL (WAGON) S911358A1803

- 1) Set rear seat cushion up.
- 2) Remove rear seat backrest.
- 3) Remove rear quarter lower trim.
- 4) Remove rear rail trim.
- 5) Remove rear quarter upper front trim.
- 6) Remove rear quarter upper rear trim.

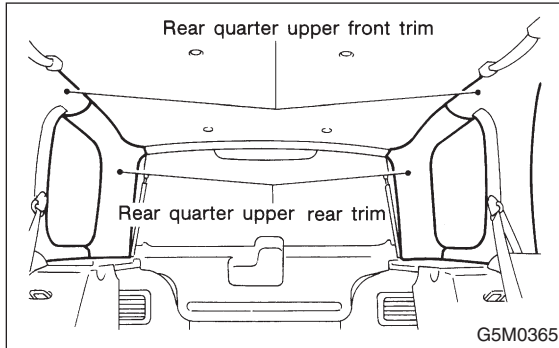

#### 2. REAR QUARTER LOWER TRIM PANEL (WAGON) S911358A1804

- 1) Remove luggage cover.
- 2) Set rear seat cushion up.
- 3) Remove rear seat backrest.
- 4) Remove rear skirt trim.
- 5) Remove clip and screw then disconnect connector (RH side).
- 6) Remove rear seat belt lower anchor then remove rear quarter lower trim.

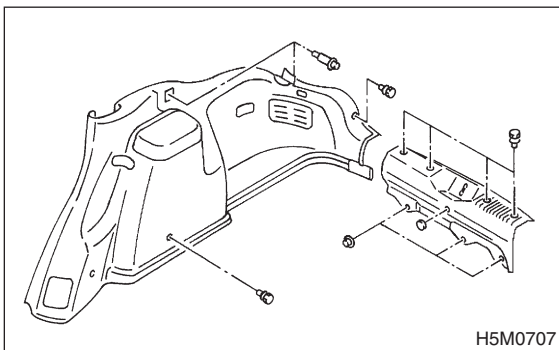

### B: INSTALLATION S911358A11

#### 1. REAR QUARTER PILLAR UPPER TRIM PANEL (WAGON) S911358A1101

Install in the reverse order of removal.

##### CAUTION:

Be sure to securely hook pawls of rear quarter pillar trim panel to body flange.

#### 2. REAR QUARTER LOWER TRIM PANEL (WAGON) S911358A1102

Install in the reverse order of removal.

##### CAUTION:

Be careful not to ride trim panel over harness, insulators, etc.