

5. Mud Guard S911374

A: REMOVAL S911374A18

- 1) Jack-up vehicle to remove tire.
- 2) Remove screws and clips. Move mud guard toward the center of the body and remove mud guard.

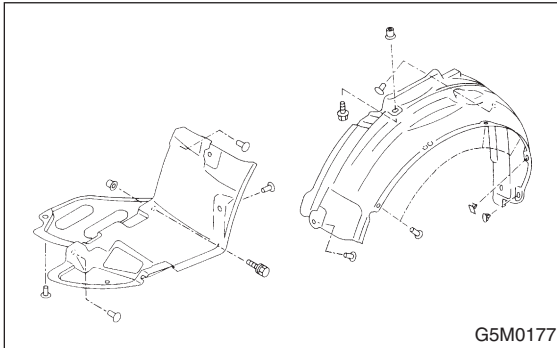

- 3) Remove clip and screws.

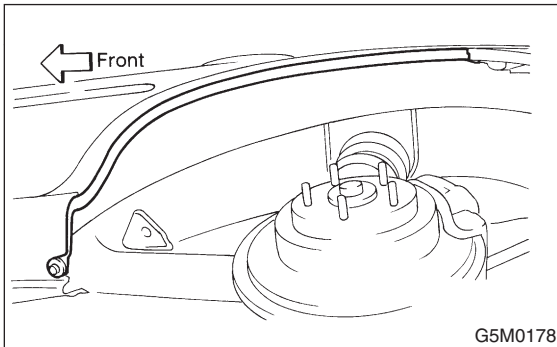

- 4) Remove arch protectors.

B: INSTALLATION S911374A11

Insert hook into body, and tighten it with screw and clip.