

# GENERAL DESCRIPTION

## Exterior Body Panels

### 1. General Description S913001

#### A: SPECIFICATIONS S913001E49

#### 1. SEDAN AND WAGON S913001E4901

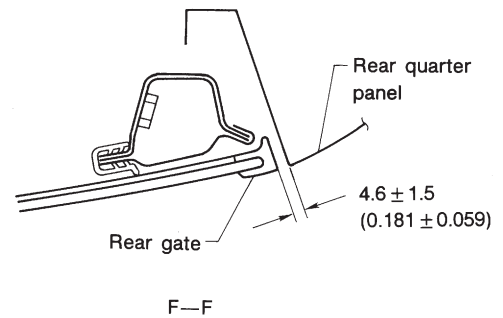
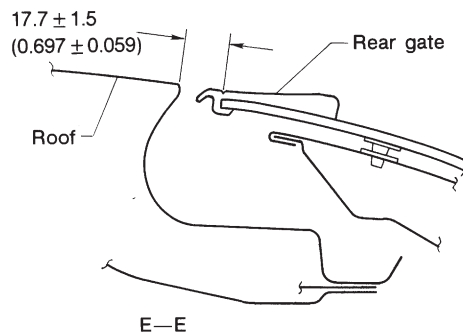
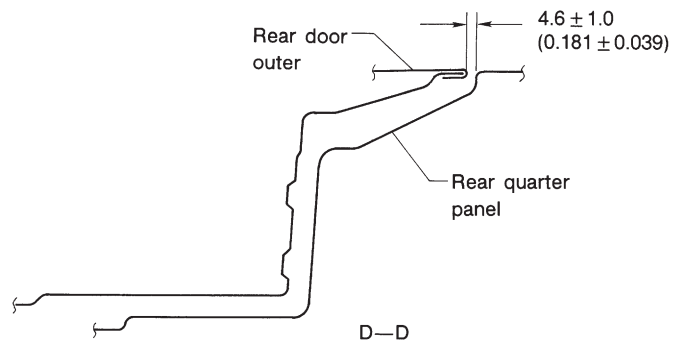
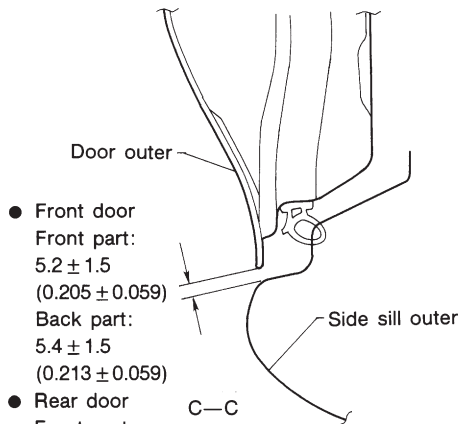
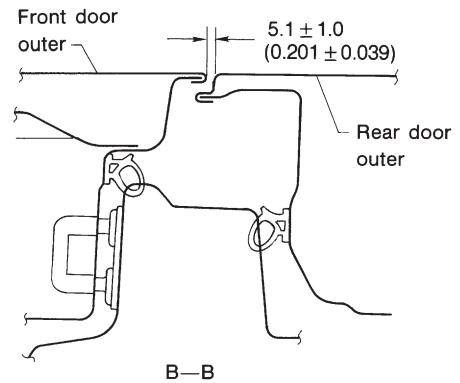
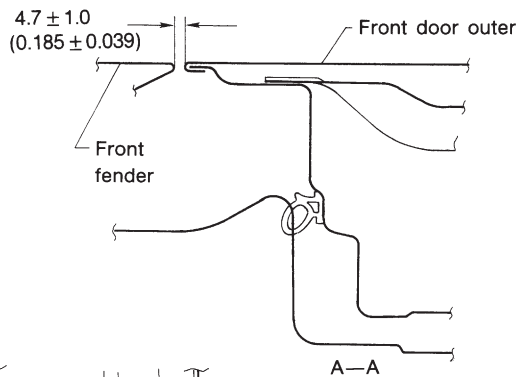
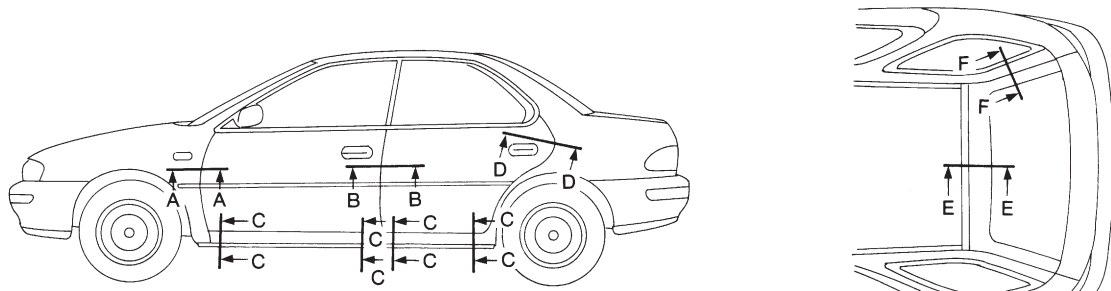

Unit: mm (in)

G5M0485

## 2. COUPE S913001E4902

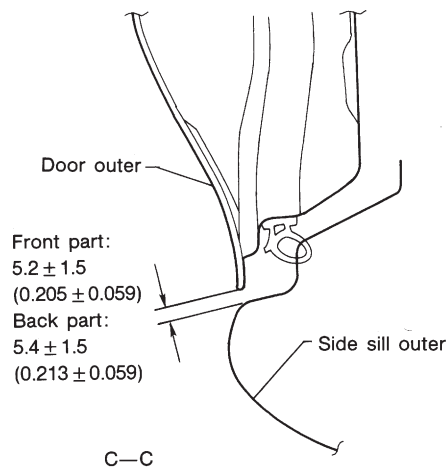
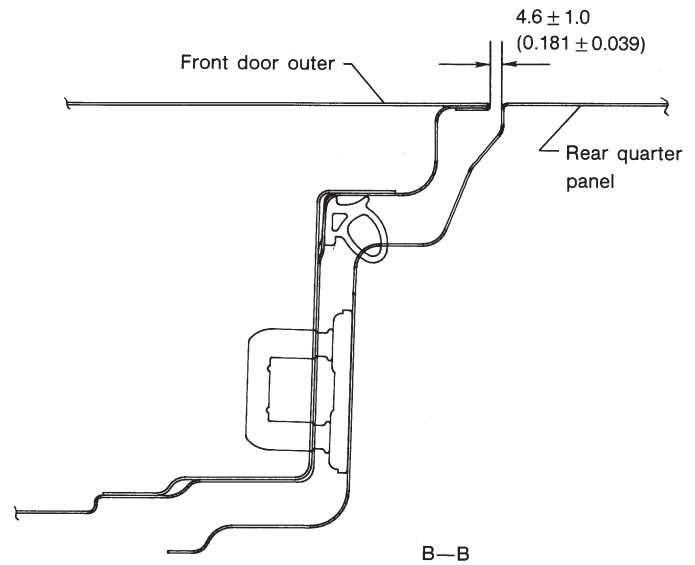
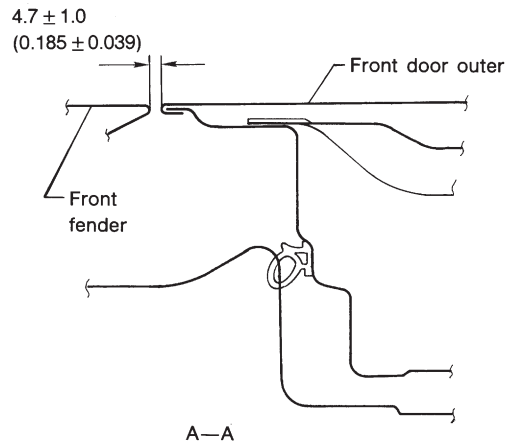
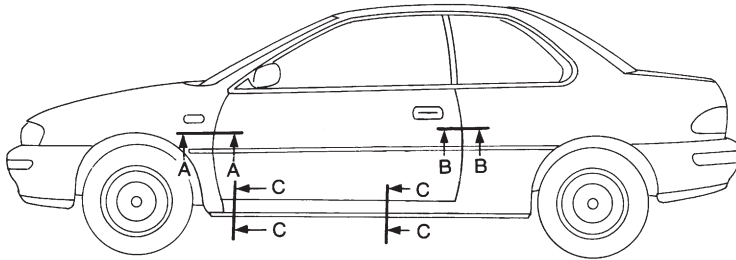

Unit: mm (in)

G5M0637

# GENERAL DESCRIPTION

Exterior Body Panels

## B: COMPONENT S913001A05

### 1. FRONT HOOD S913001A0501

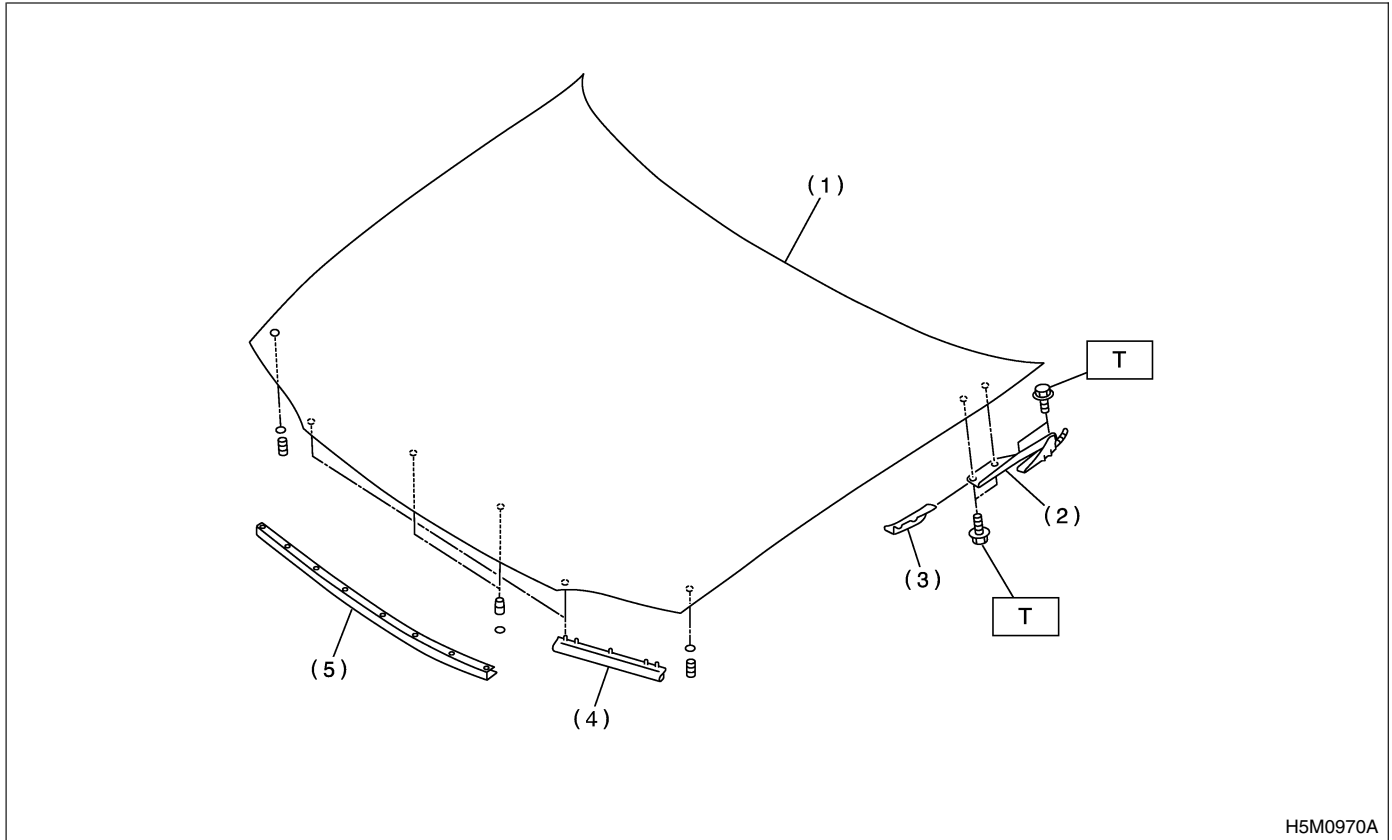

- (1) Front hood
- (2) Hinge (RH, LH)
- (3) Hood hinge cover (RH, LH)
- (4) Seal (Front hood) SD
- (5) Seal (Front hood) CTR

**Tightening torque: N·m (kgf-m, ft-lb)**  
**T: 14 (1.4, 10.1)**

## 2. FRONT DOOR PANEL S913001A0502

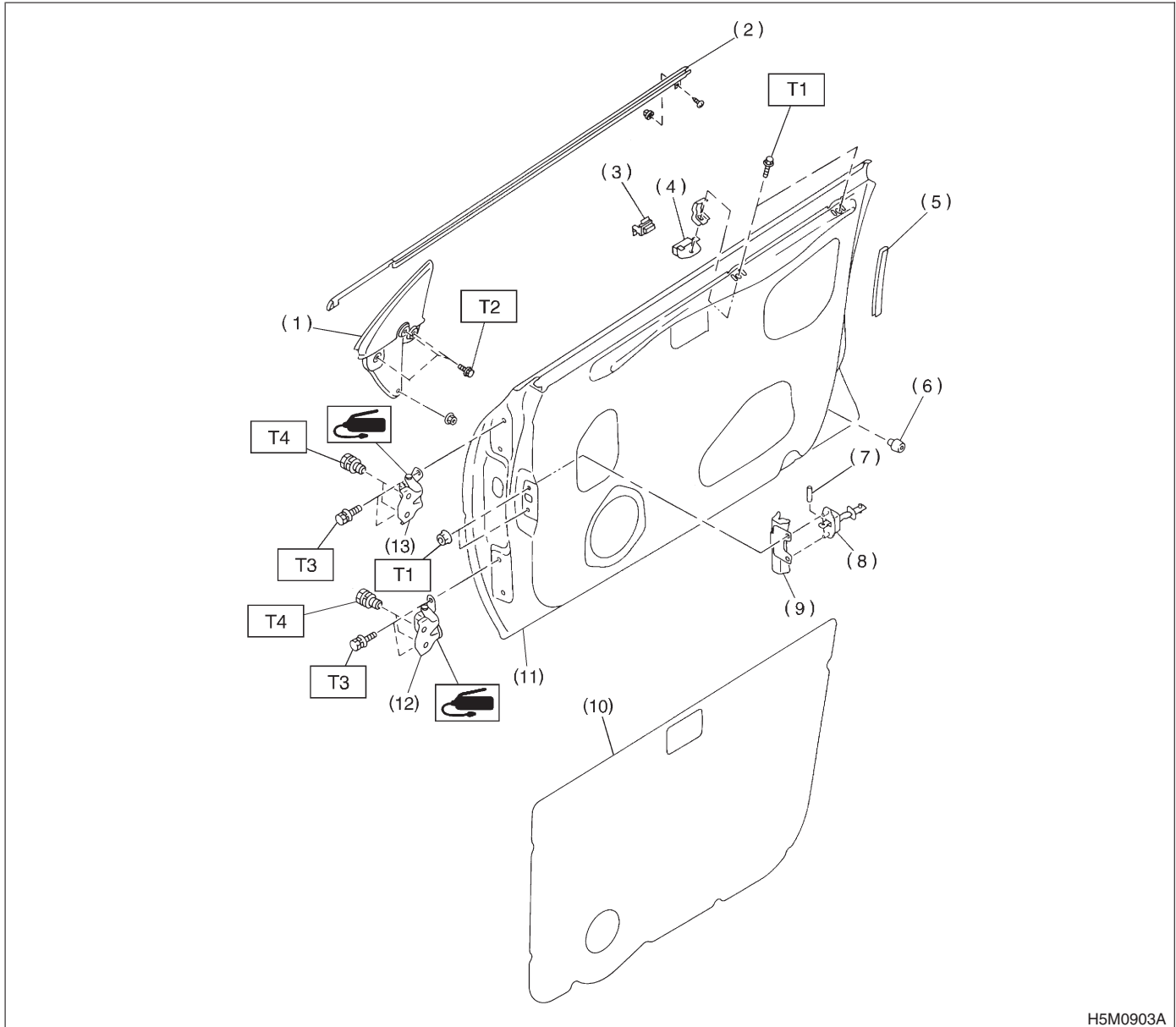

H5M0903A

- |                        |                    |
|------------------------|--------------------|
| (1) Gusset             | (8) Checker        |
| (2) Weatherstrip       | (9) Guide          |
| (3) Stabilizer (Outer) | (10) Sealing cover |
| (4) Stabilizer (Inner) | (11) Door panel    |
| (5) Protector          | (12) Lower hinge   |
| (6) Stopper            | (13) Upper hinge   |
| (7) Knock pin          |                    |

### **Tightening torque: N·m (kgf-m, ft-lb)**

**T1: 7.4 (0.75, 5.4)**

**T2: 13 (1.3, 9.4)**

**T3: 25 (2.5, 18.1)**

**T4: 29 (3.0, 21.7)**

# GENERAL DESCRIPTION

Exterior Body Panels

## 3. REAR DOOR PANEL S913001A0503

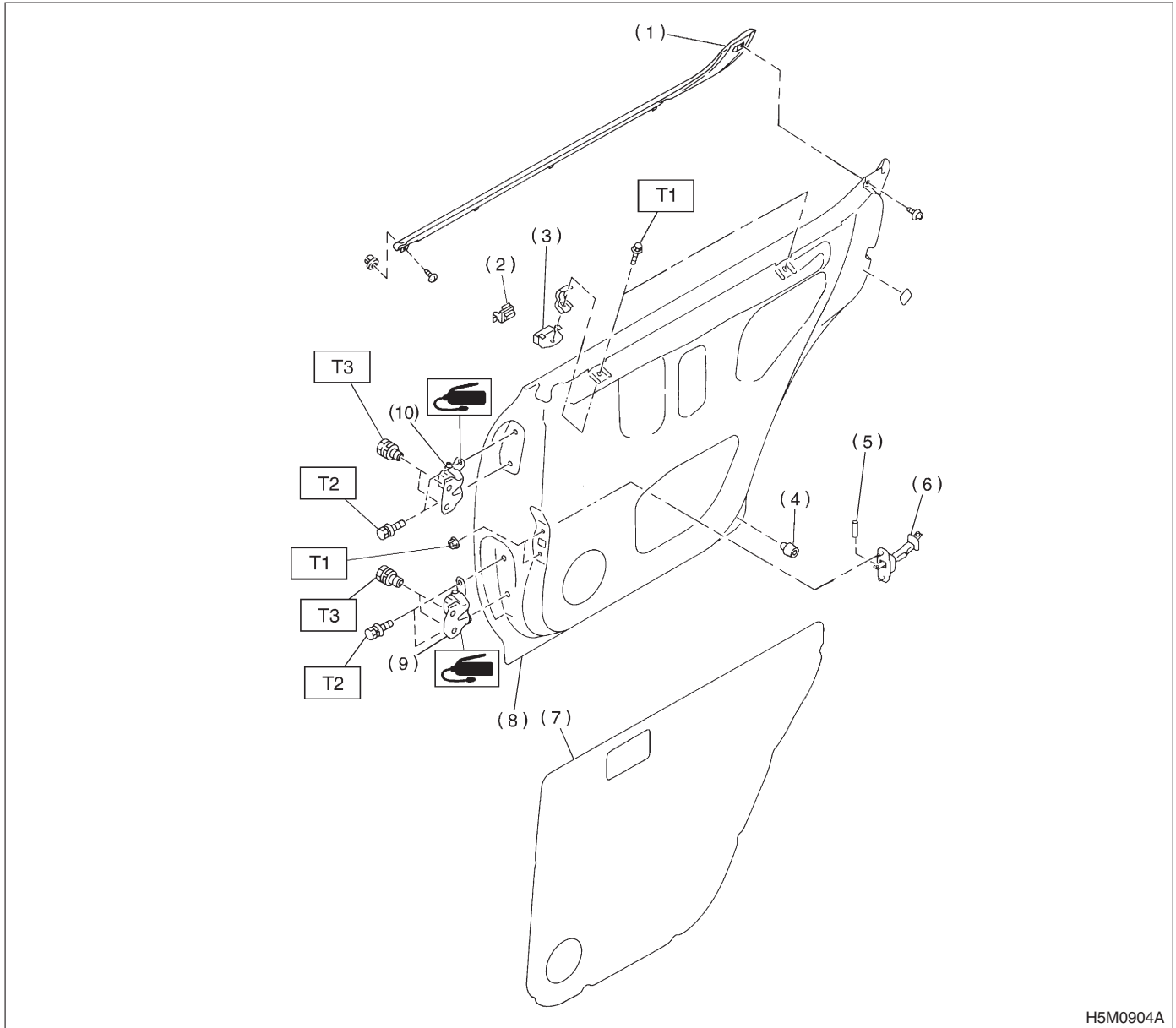

- |                        |                   |
|------------------------|-------------------|
| (1) Weatherstrip       | (7) Seating cover |
| (2) Stabilizer (Outer) | (8) Door panel    |
| (3) Stabilizer (Inner) | (9) Lower hinge   |
| (4) Stopper            | (10) Upper hinge  |
| (5) Knock pin          |                   |
| (6) Checker            |                   |

**Tightening torque: N·m (kgf-m, ft-lb)**

**T1: 7.4 (0.75, 5.4)**

**T2: 25 (2.5, 18.1)**

**T3: 29 (3.0, 21.7)**

## 4. TRUNK LID PANEL S913001A0504

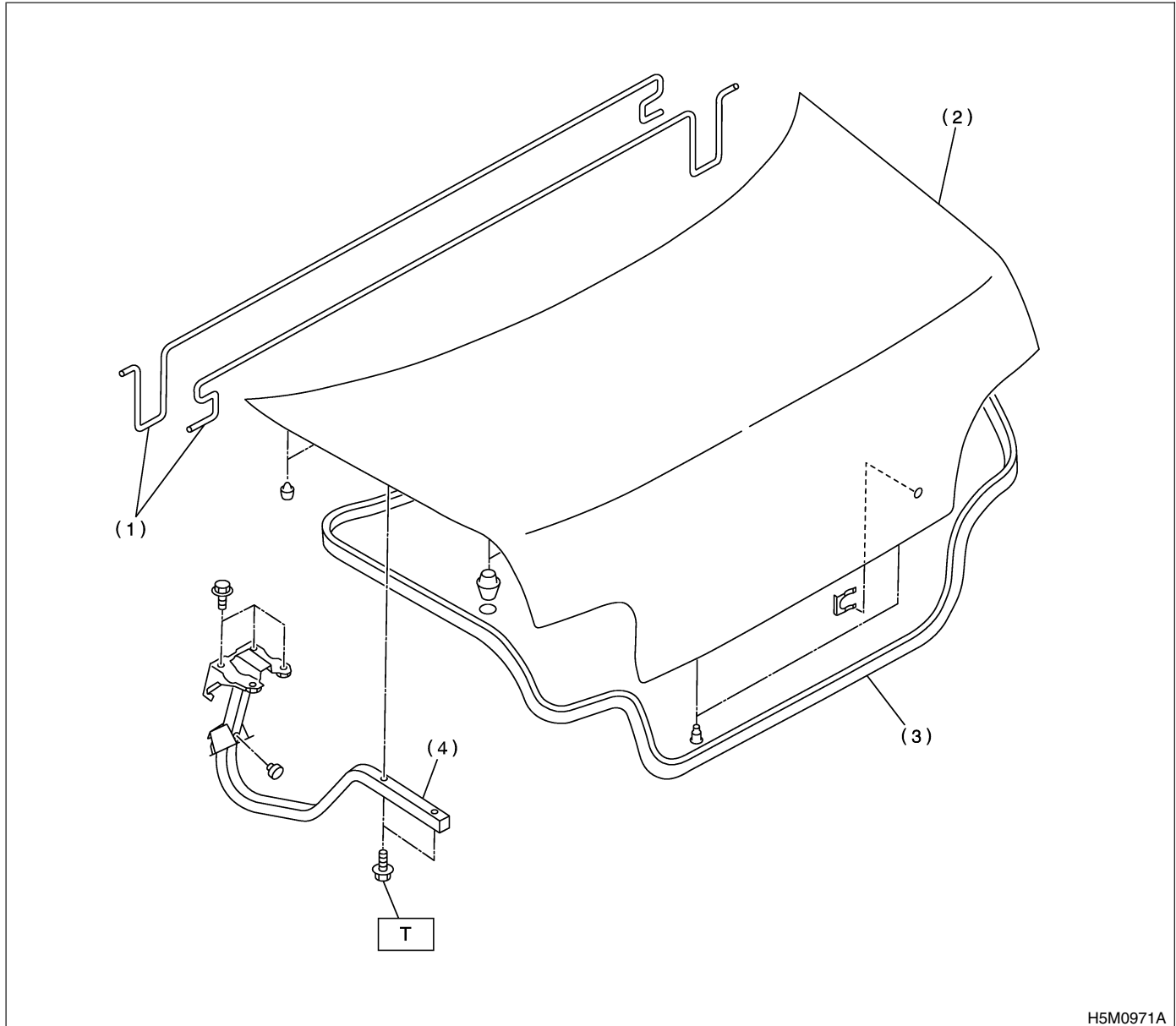

- (1) Torsion bar
- (2) Trunk lid
- (3) Weatherstrip
- (4) Hinge ASSY

**Tightening torque: N·m (kgf-m, ft-lb)**  
**T: 14 (1.4, 10.1)**

# GENERAL DESCRIPTION

Exterior Body Panels

## 5. REAR GATE PANEL S913001A0505

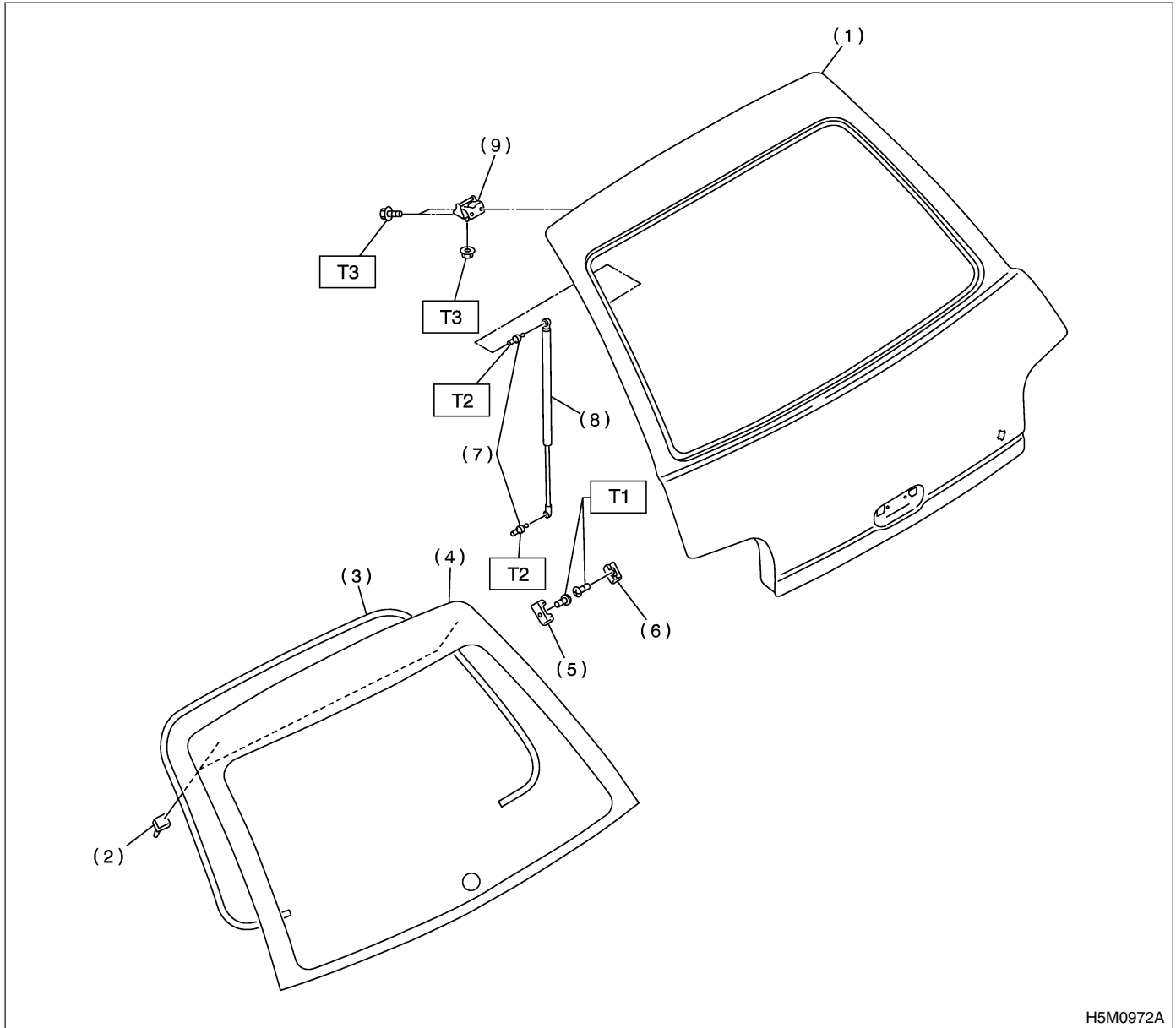

H5M0972A

- |               |                           |
|---------------|---------------------------|
| (1) Rear gate | (6) Rear gate side buffer |
| (2) Glass pin | (7) Stud                  |
| (3) Trim      | (8) Gas stay              |
| (4) Glass     | (9) Hinge                 |
| (5) Buffer    |                           |

**Tightening torque: N·m (kgf-m, ft-lb)**

**T1: 7.4 (0.75, 5.4)**

**T2: 14 (1.4, 10.1)**

**T3: 25 (2.5, 18.1)**

# GENERAL DESCRIPTION

Exterior Body Panels

## C: CAUTION

S913001A03

● Exterior body panels are heavy. Do not drop and damage the panels. During removal and installation, do not damage the panel painting surface.

- While removing mounting bolts, using assistance devices such as a support jack will help support the panel.
- Be careful not to lose small parts.

## D: PREPARATION TOOL

S913001A17

### 1. SPECIAL TOOL

S913001A1701

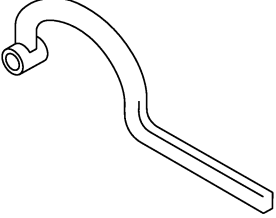
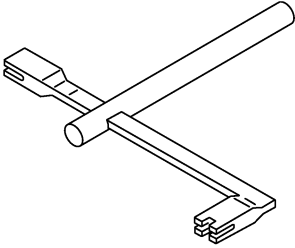
ILLUSTRATION	TOOL NUMBER	DESCRIPTION	REMARKS
 B5M1117	925610000	WRENCH	Used for removing and installing door hinge.
 B5M1118	927780000	REMOVER	Used for removing and installing trunk torsion bar.

### 2. GENERAL TOOL

S913001A1702

TOOL NAME	REMARKS
Support Jack	Used for supporting door panel.