

DATUM POINTS

Body Structure

2. Datum Points S906540

A: LOCATION S906540A13

Various master repair locations are established as datum points used during body repairs. In addition, guide holes, locators and indents are provided to facilitate panel replacement and achieve alignment accuracy.

NOTE:

Left and right datum points are all symmetrical to each other.

1. ENGINE COMPARTMENT AND ROOM S906540A1304

● Sedan and wagon

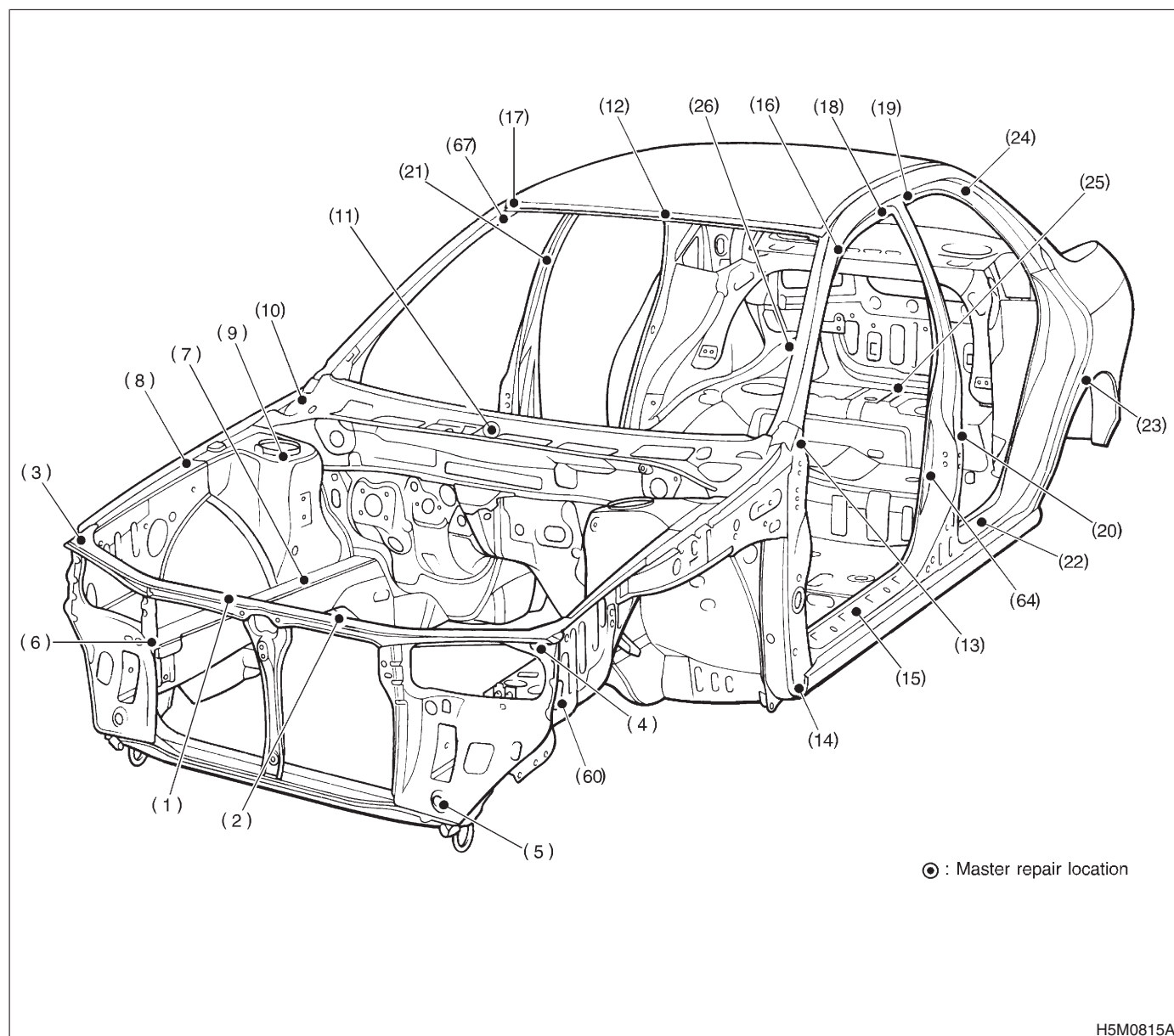

DATUM POINTS

Body Structure

- | | | |
|---|---|--|
| (1) Radiator panel (UPR) repair bolt hole M8 (Right) | (10) Hood hinge attaching bolt hole M8 (Symmetrical) | (20) Center pillar gauge hole 10 mm (0.39 in) dia. (Symmetrical) |
| (2) Radiator panel (UPR) repair bolt hole M8 (Left) | (11) Cowl panel mounting hole 5 mm (0.20 in) dia. (Located in center of vehicle.) | (21) Belt anchor attaching bolt hole (Symmetrical) |
| (3) Fender attaching bolt hole M6 (Symmetrical) | (12) Front rail (Inner) mirror attaching bolt hole 8 mm (0.31 in) dia. | (22) Wax coat hole, 20 mm (0.79 in) dia. (Symmetrical) |
| (4) Headlight attaching bolt hole M6 (Symmetrical) | (13) Fender attaching bolt hole M6 (Symmetrical) | (23) Rear door switch attaching hole 20 mm (0.79 in) dia. (Symmetrical) |
| (5) Radiator panel side gauge hole 24 mm (0.94 in) dia. (Symmetrical) | (14) Front pillar gauge hole 20 mm (0.79 in) dia. (Symmetrical) | (24) Retainer attaching square hole 7 mm (0.28 in) (Symmetrical) |
| (6) Front bumper mounting hole 14 x 17 mm (0.55 x 0.67 in) dia. (Symmetrical) | (15) Wax coat hole, 20 mm (0.79 in) dia. (Symmetrical) | (25) Spare tire attaching bolt hole M8 |
| (7) Front crossmember attaching bolt hole 12.4 mm (0.488 in) dia. (Symmetrical) | (16) Retainer attaching square hole 7 mm (0.28 in) (Symmetrical) | (26) Air draw hole 7 mm (0.28 in) dia. (Symmetrical) |
| (8) Fender attaching bolt hole M6 (Symmetrical) | (17) Sun visor attaching hole 20 mm (0.79 in) dia. (Symmetrical) | (60) Fender attaching bolt hole M6 (Symmetrical) |
| (9) Front strut mounting hole 10 mm (0.39 in) dia. (Symmetrical) | (18) Retainer attaching square hole 7 mm (0.28 in) (Symmetrical) | (64) Door switch attaching hole 20 mm (0.79 in) dia. (Symmetrical) |
| | (19) Retainer attaching square hole 7 mm (0.28 in) (Symmetrical) | (67) Front glass attaching hole Right 6.5 mm (0.256 in) dia. Left 6.5 x 10 mm (0.256 x 0.39 in) dia. |

DATUM POINTS

Body Structure

● Coupe

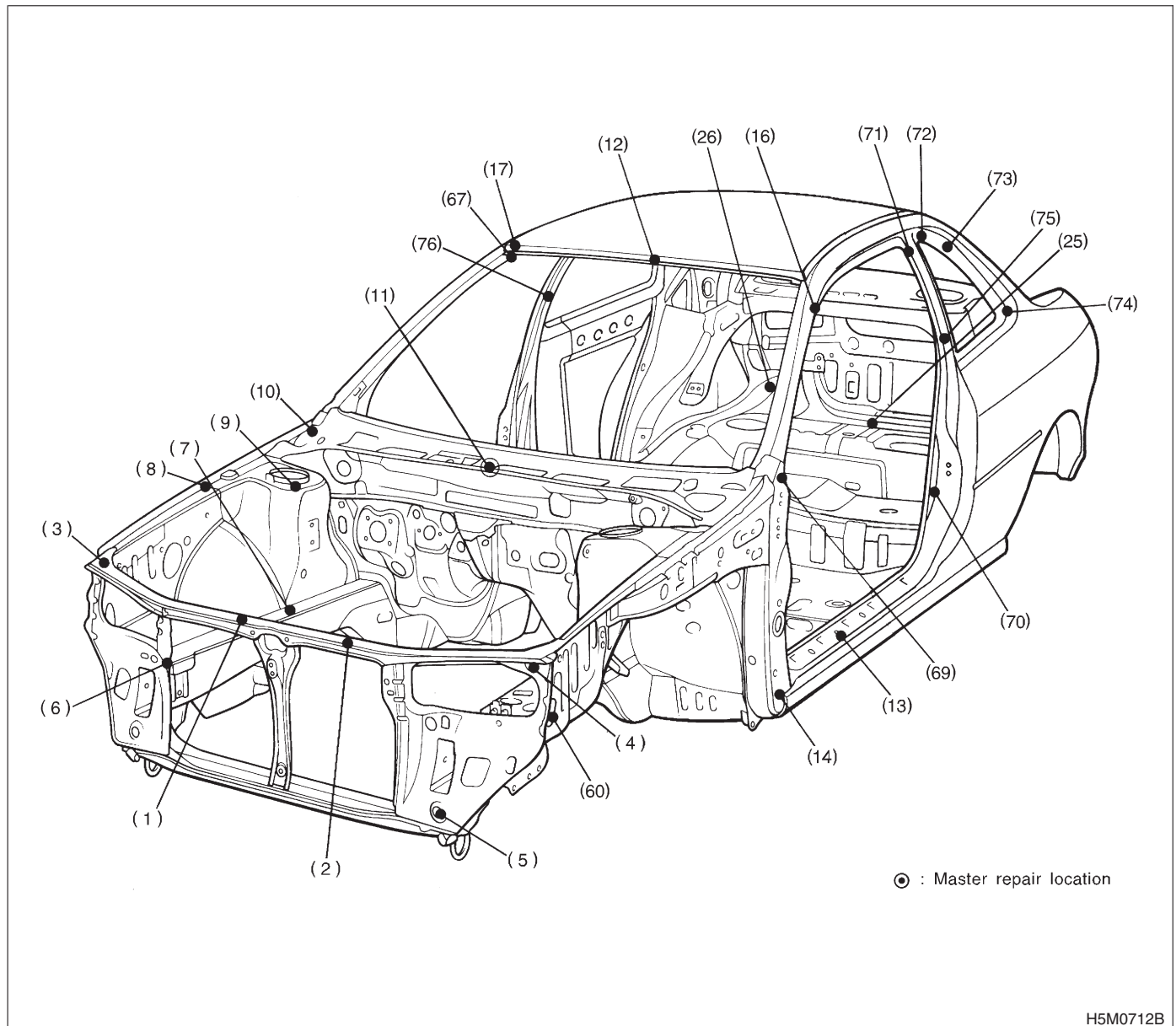

DATUM POINTS

Body Structure

- | | | |
|---|--|--|
| (1) Radiator panel (UPR) repair bolt hole M8 (Right) | (11) Cowl panel mounting hole 5 mm (0.20 in) dia. (Located in center of vehicle.) | (70) Door switch attaching hole 13.5 mm (0.531 in) dia. (Symmetrical) |
| (2) Radiator panel (UPR) repair bolt hole M8 (Left) | (12) Front rail (Inner) mirror attaching bolt hole 8 mm (0.31 in) dia. | (71) Retainer attaching square hole 8 mm (0.31 in). (Symmetrical) |
| (3) Fender attaching bolt hole M6 (Symmetrical) | (13) Fender attaching bolt hole M6 (Symmetrical) | (72) Rear quarter glass attaching hole 8 mm (0.31 in) dia. (Symmetrical) |
| (4) Headlight attaching bolt hole M6 (Symmetrical) | (14) Front pillar gauge hole 20 mm (0.79 in) dia. (Symmetrical) | (73) Rear quarter glass attaching hole 7 mm (0.28 in) dia. (Symmetrical) |
| (5) Radiator panel side gauge hole 24 mm (0.94 in) dia. (Symmetrical) | (16) Retainer attaching square hole 7 mm (0.28 in) (Symmetrical) | (74) Rear quarter glass attaching hole 8 x 5.5 mm (0.31 x 0.217 in) dia. (Symmetrical) |
| (6) Front bumper mounting hole 14 x 17 mm (0.55 x 0.67 in) dia. (Symmetrical) | (17) Sun visor attaching hole 20 mm (0.79 in) dia. (Symmetrical) | (75) Retainer attaching square hole 8 mm (0.31 in). (Symmetrical) |
| (7) Front crossmember attaching bolt hole 12.4 mm (0.488 in) dia. (Symmetrical) | (25) Spare tire attaching bolt hole M8 | (76) Seat belt anchor attaching bolt hole 16 mm (0.63 in) dia. (Symmetrical) |
| (8) Fender attaching bolt hole M6 (Symmetrical) | (26) Air draw hole 7 mm (0.28 in) dia. (Symmetrical) | |
| (9) Front strut mounting hole 10 mm (0.39 in) dia. (Symmetrical) | (60) Fender attaching bolt hole M6 (Symmetrical) | |
| (10) Hood hinge attaching bolt hole M8 (Symmetrical) | (67) Front glass attaching hole Right 6.5 mm (0.256 in) dia. Left 6.5 x 10 mm (0.256 x 0.39 in) dia. | |
| | (69) Wax coat hole 20 mm (0.79 in) dia. (Symmetrical) | |

DATUM POINTS

Body Structure

2. LUGGAGE COMPARTMENT AND ROOM S906540A1305

● Sedan and coupe

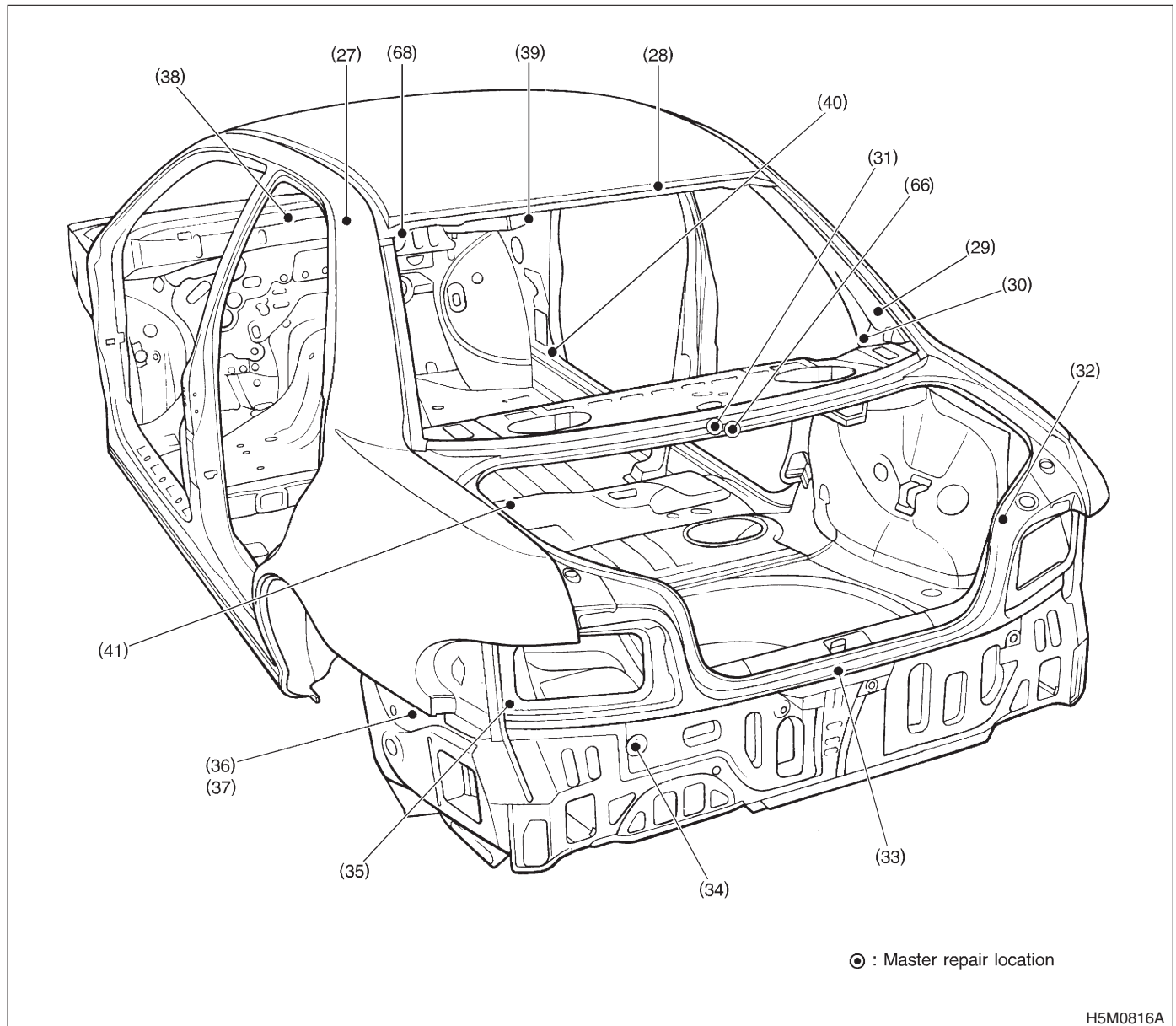

DATUM POINTS

Body Structure

- | | | |
|--|--|---|
| (27) Rear pillar (Inner) gauge hole 8 mm (0.31 in) dia. (Symmetrical) | (33) Rear skirt (UPR) cutout (Repair locator) | (39) Steering support beam attaching bolt hole M8 (Symmetrical) |
| (28) Rear roof trim attaching hole 8 mm (0.31 in) dia. (Symmetrical) | (34) Rear skirt gauge hole 20 mm (0.79 in) dia. (Symmetrical) | (40) Front pillar (Inner) gauge hole 10 mm (0.39 in) dia. (Symmetrical) |
| (29) Rear quarter trim attaching hole 8 mm (0.31 in) dia. (Symmetrical) | (35) Rear combination light mounting hole 9 mm (0.35 in) dia. (Symmetrical) | (41) Floor mat attaching clip hole 8 mm (0.31 in) dia. (Symmetrical) |
| (30) Seat belt anchor attaching bolt hole (Symmetrical) | (36) Rear quarter bumper side gauge hole 20 mm (0.79 in) dia. (Left) | (66) Rear panel (Center) repair locator (Located in center of vehicle.) |
| (31) Reinforcement (Rear panel rear) repair locator (Located in center of vehicle) | (37) Rear quarter bumper side gauge hole 20 mm (0.79 in) dia. (Right) | (68) Rear glass attaching hole (Right): 6.5 mm (0.256 in) dia. (Left): 6.5 x 10 mm (0.256 x 0.39 in) dia. |
| (32) Rear corner patch at flange (Symmetrical) | (38) Instrument panel attaching square hole 22 x 34.5 mm (0.87 x 1.358 in) (Right) | |

DATUM POINTS

Body Structure

● Wagon

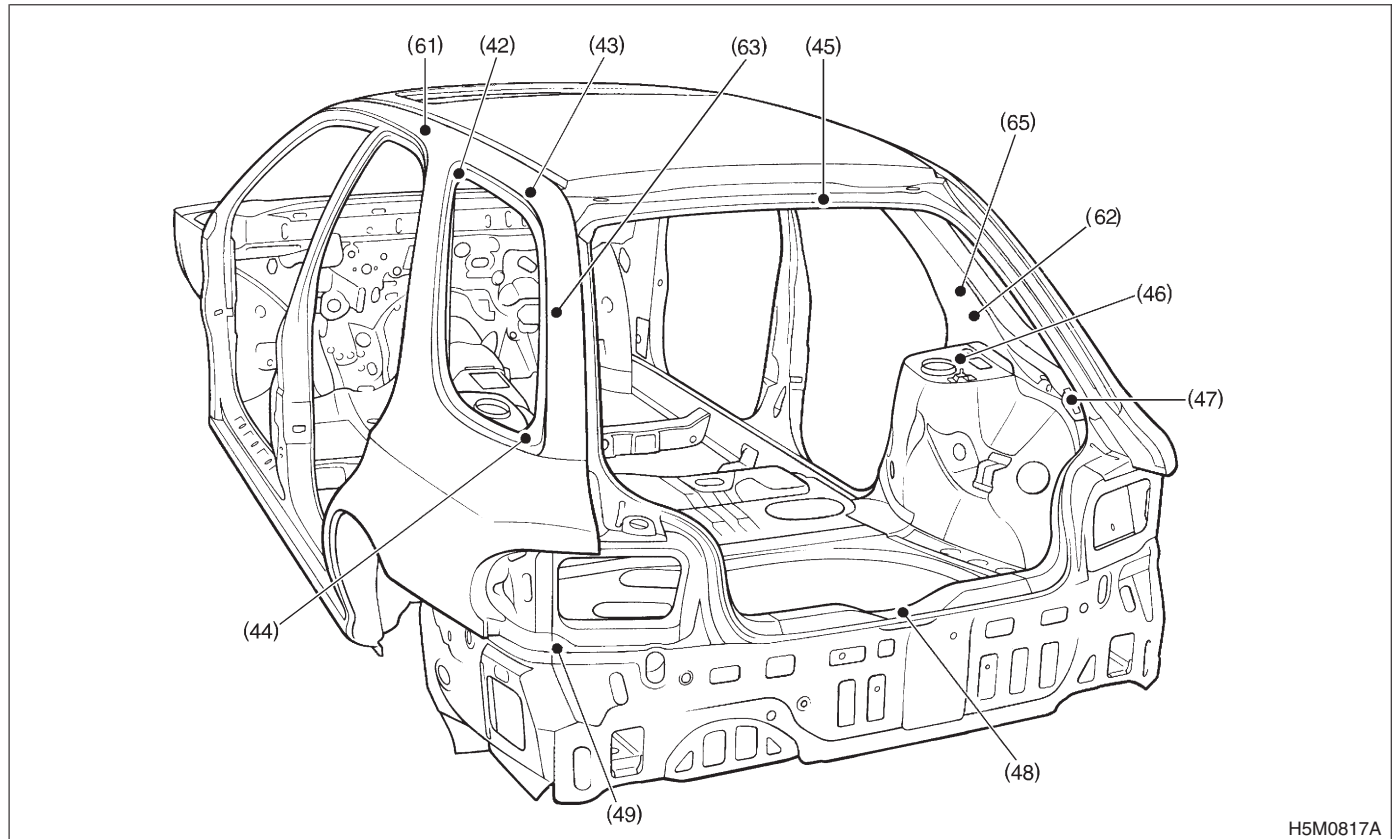

H5M0817A

- | | | |
|--|--|---|
| (42) Rear quarter glass attaching hole 8 mm (0.31 in) dia. (Symmetrical) | (46) Rear strut mounting hole 10 mm (0.39 in) dia. (Symmetrical) | (61) Side rail (Inner) gauge hole 8 mm (0.31 in) dia. (Symmetrical) |
| (43) Roof rail attaching hole 10 mm (0.39 in) dia. (Symmetrical) | (47) Rear gate stay attaching bolt hole M8 (Symmetrical) | (62) Rear quarter trim attaching hole 8 mm (0.31 in) dia. (Symmetrical) |
| (44) Rear quarter glass attaching hole 8 x 15 mm (0.31 x 0.59 in) dia. (Symmetrical) | (48) Child seat anchor attaching bolt hole | (63) Rear quarter harness attaching clip hole 7 mm (0.28 in) dia. (Symmetrical) |
| (45) Rear roof trim attaching hole 8 mm (0.31 in) dia. (Symmetrical) | (49) Rear combination light mounting hole 10 mm (0.39 in) dia. (Symmetrical) | (65) Seat belt anchor attaching bolt hole (Symmetrical) |

3. UNDER BODY S906540A1306

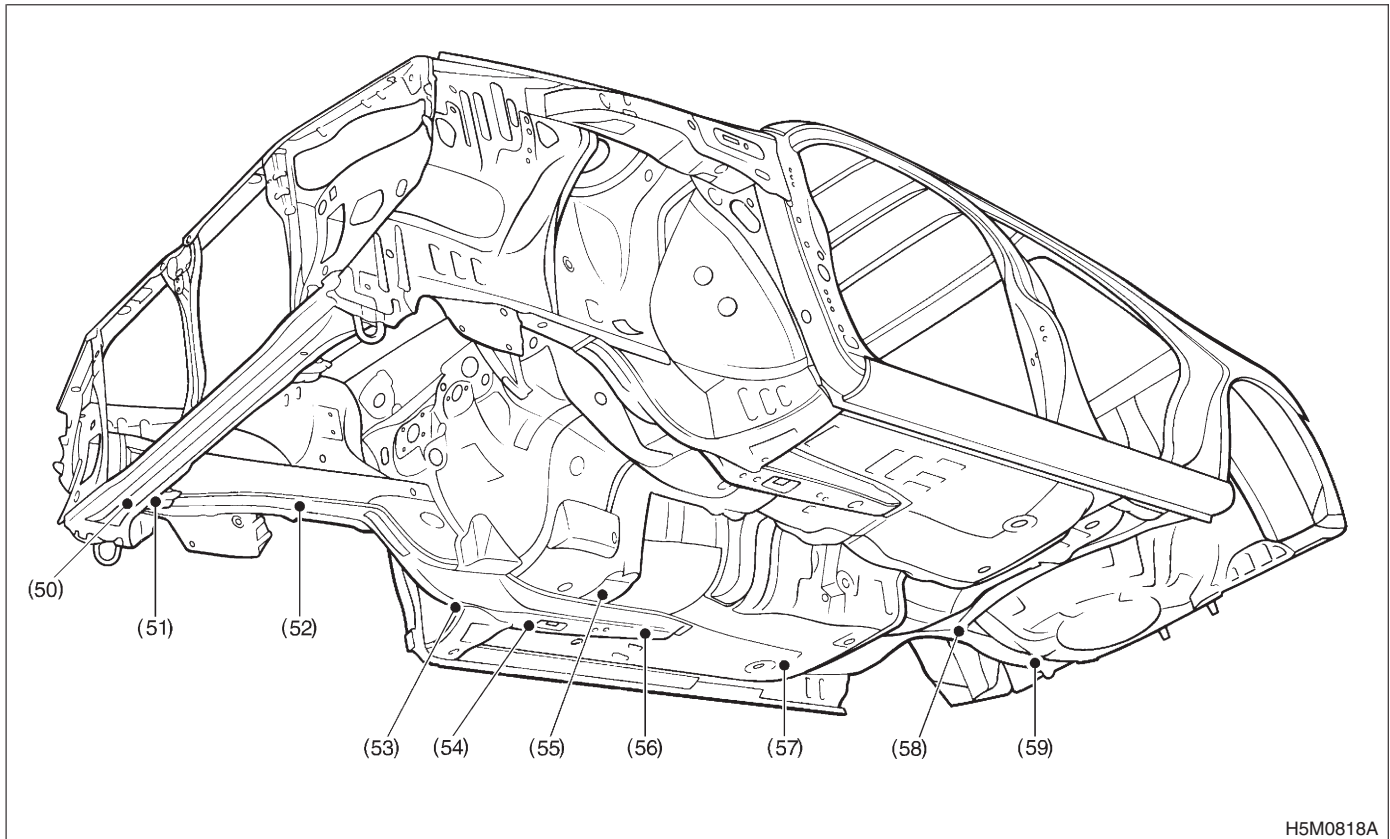

H5M0818A

- | | | |
|---|---|--|
| (50) Radiator panel (LWR) frame gauge hole 15 mm (0.59 in) dia. (Symmetrical) | (53) Front suspension attaching bolt hole M14 | (57) Rear differential attaching bolt hole M12 (Symmetrical) |
| (51) Front side frame gauge hole 20 mm (0.79 in) dia. (Symmetrical) | (54) Side frame gauge hole 20 mm (0.79 in) dia. (Symmetrical) | (58) Rear suspension attaching bolt hole M12 (Symmetrical) |
| (52) Front crossmember attaching hole 12.4 mm (0.488 in) dia. (Symmetrical) | (55) Transmission mount attaching bolt hole M10 (Symmetrical) | (59) Rear side frame gauge hole 15 mm (0.59 in) dia. (Symmetrical) |
| | (56) Side frame gauge hole 15 mm (0.59 in) dia. (Symmetrical) | |

DATUM POINTS

Body Structure

4. DATUM POINT LOCATION

S906540A1307

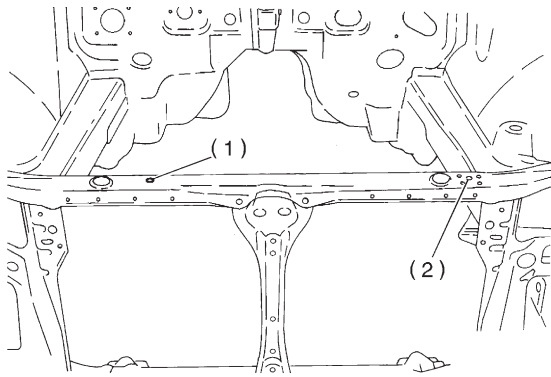

H5M0819A

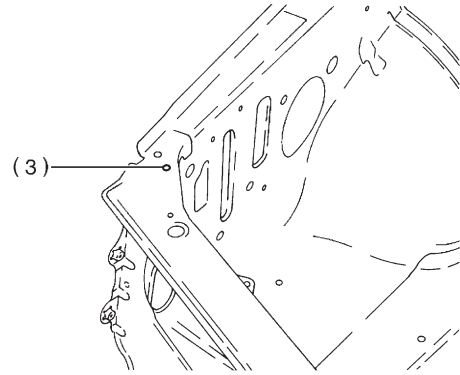

H5M0823A

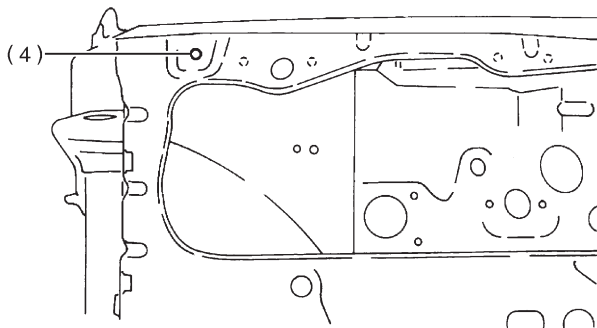

H5M0820A

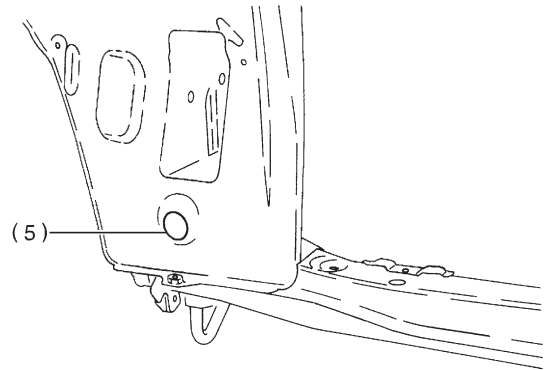

H5M0824A

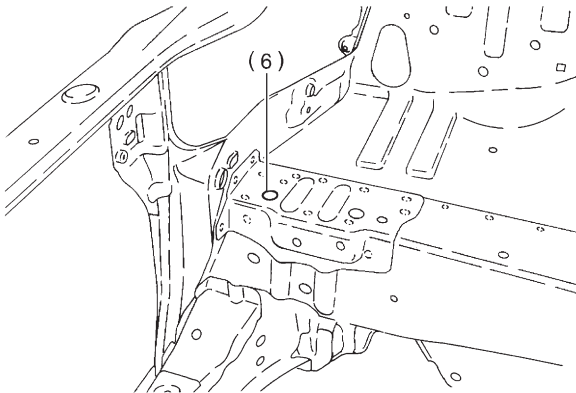

H5M0821A

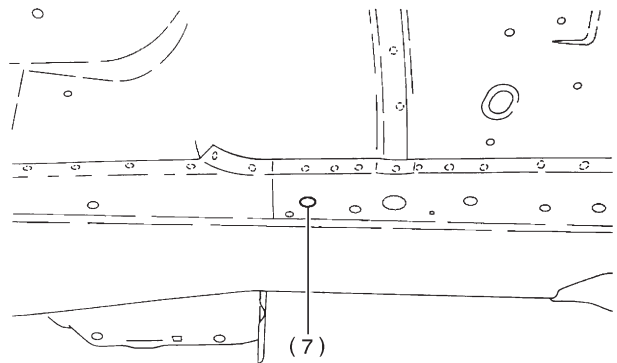

H5M0825A

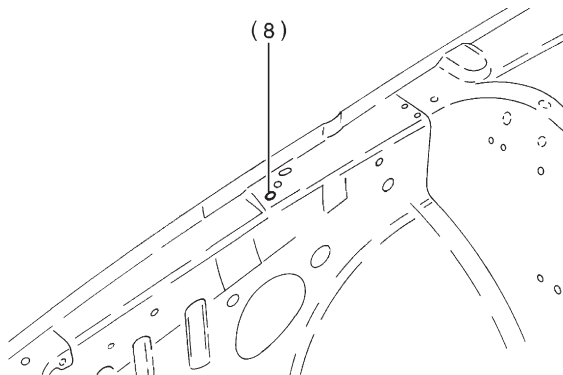

H5M0822A

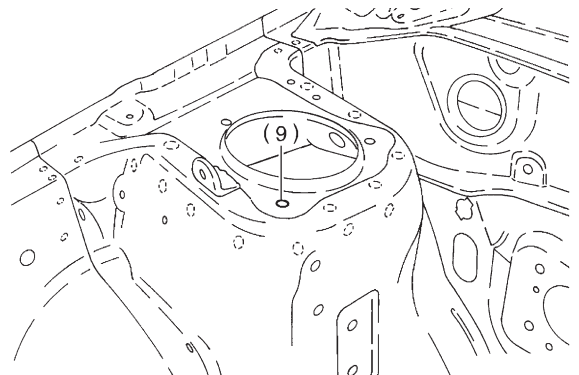

H5M0826A

DATUM POINTS

Body Structure

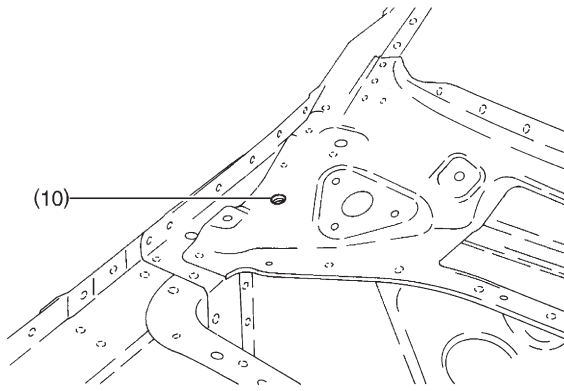

H5M0827A

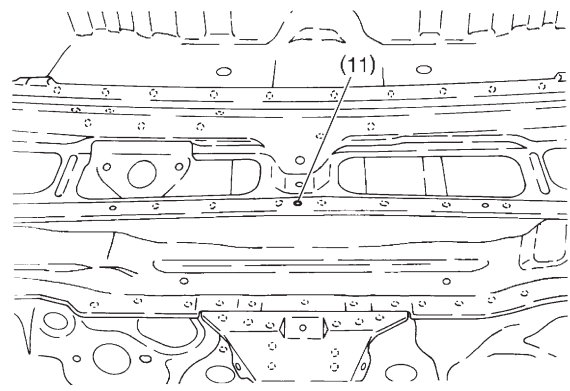

H5M0831A

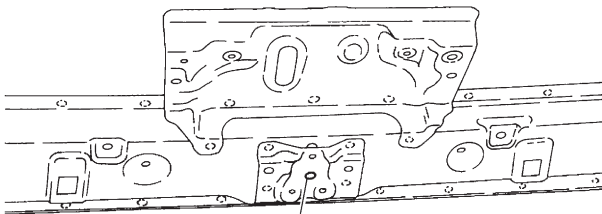

H5M0828A

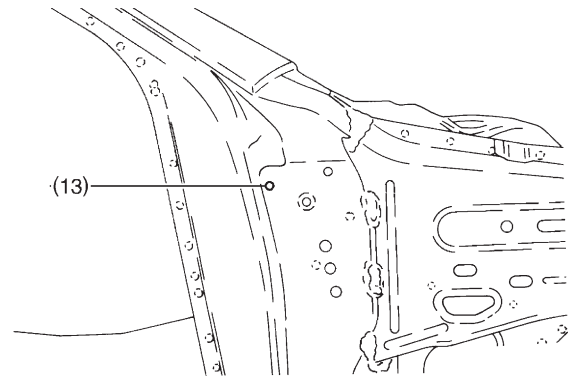

H5M0832A

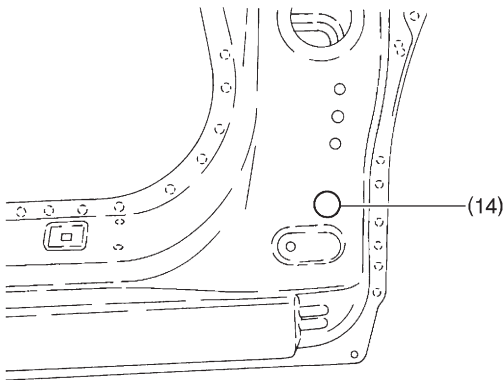

H5M0829A

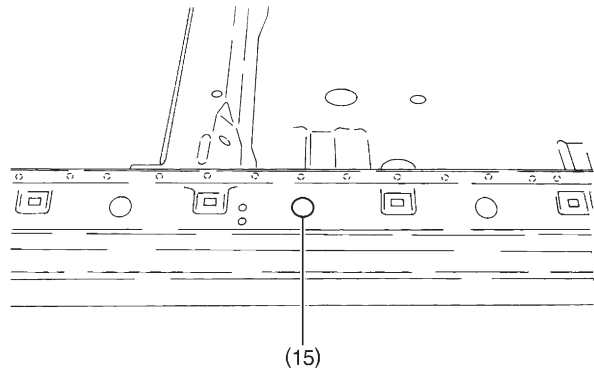

H5M0833A

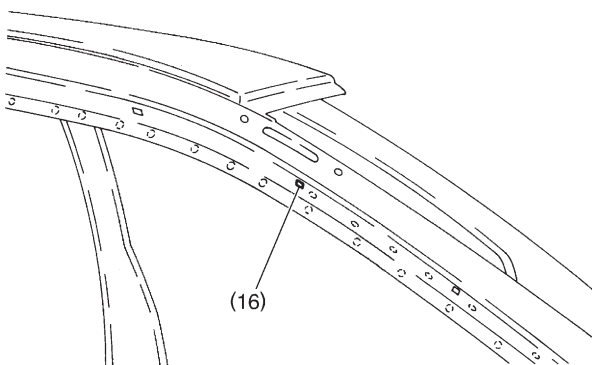

H5M0830A

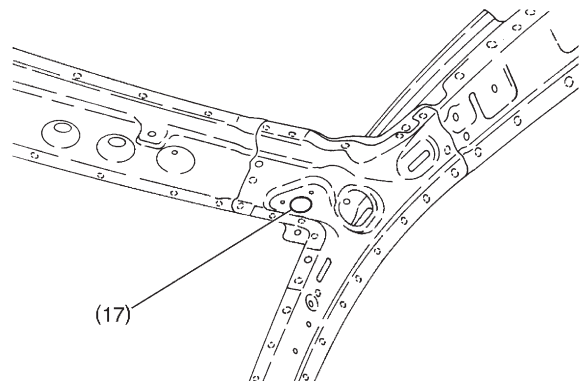

H5M0834A

DATUM POINTS

Body Structure

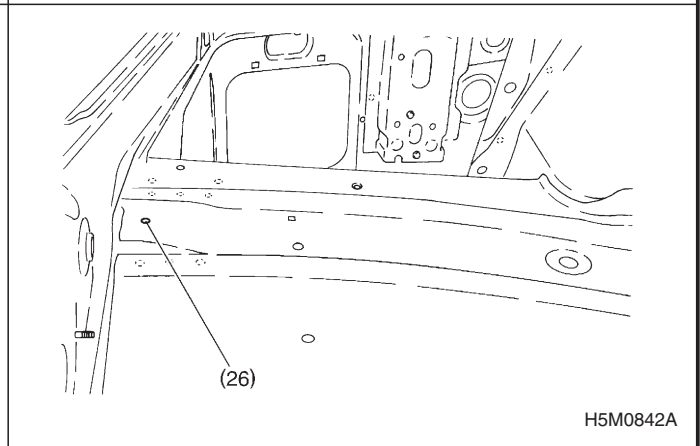
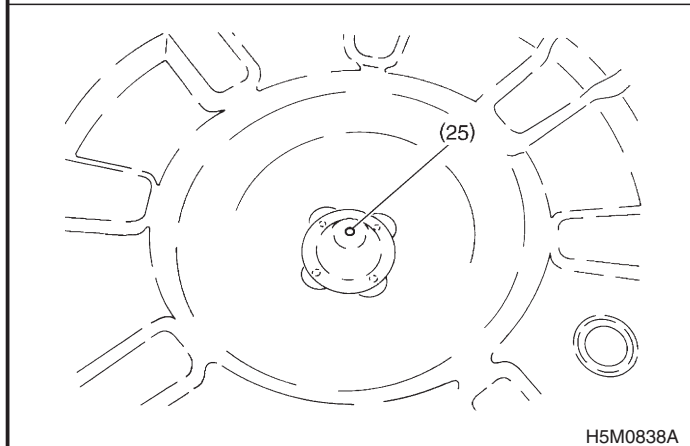
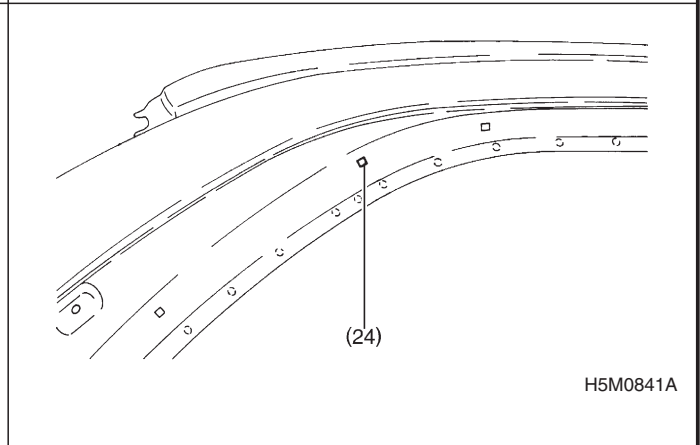
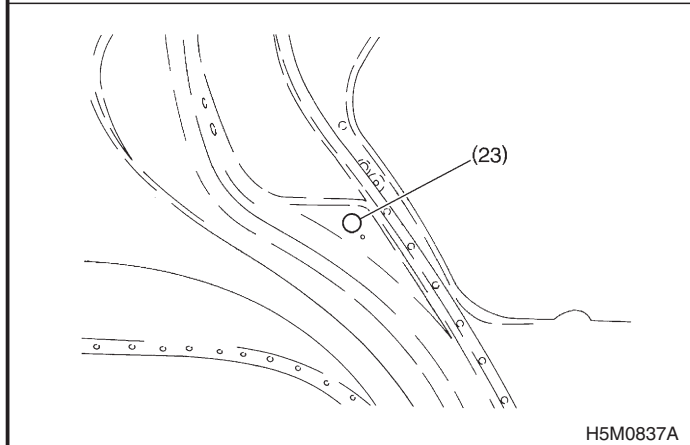
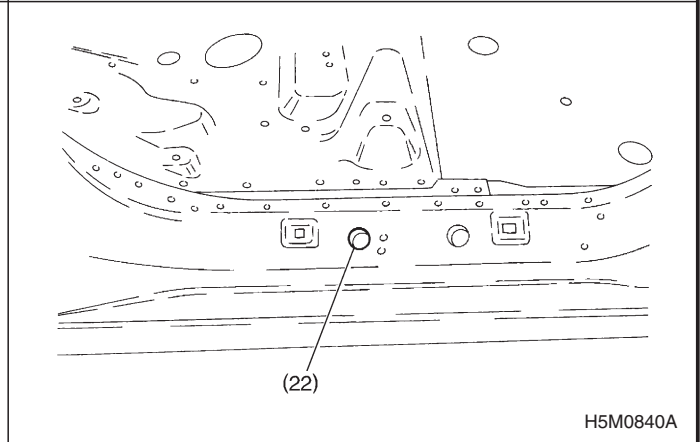
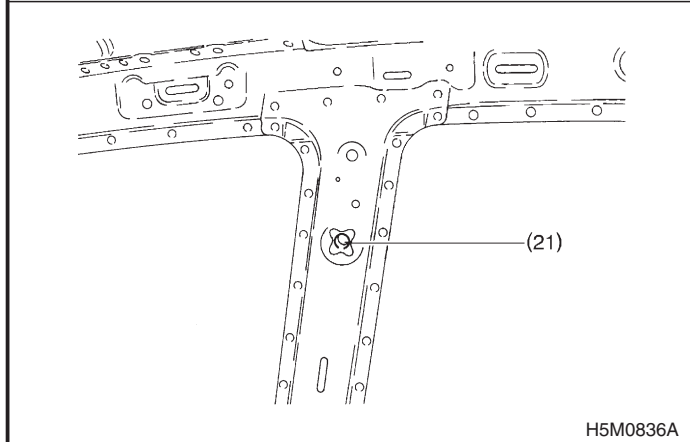
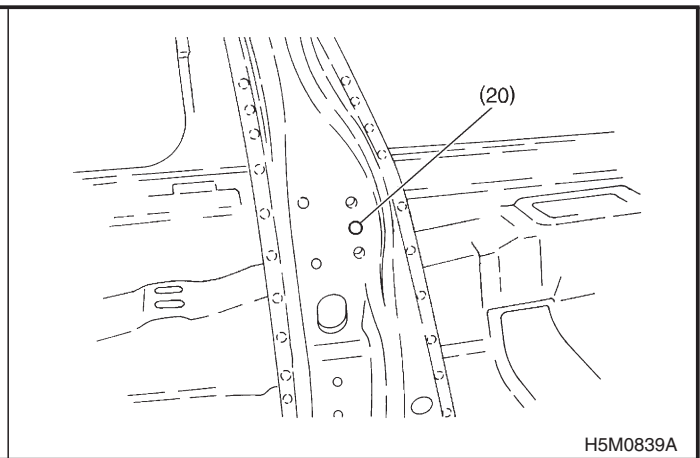
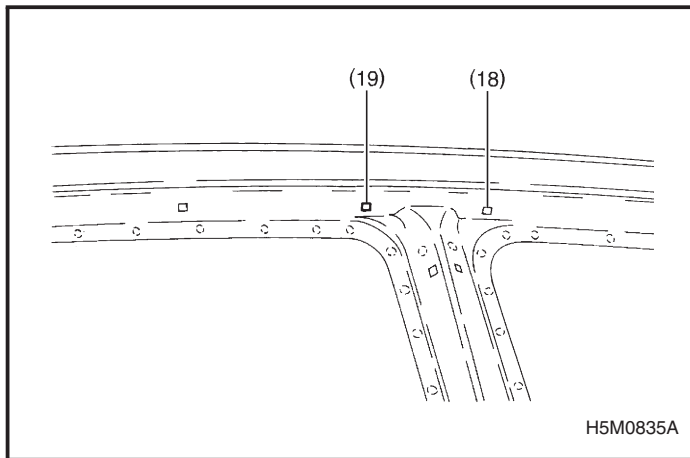

DATUM POINTS

Body Structure

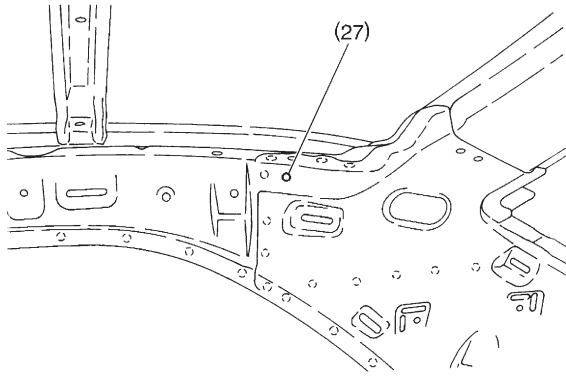

H5M0843A

Sedan

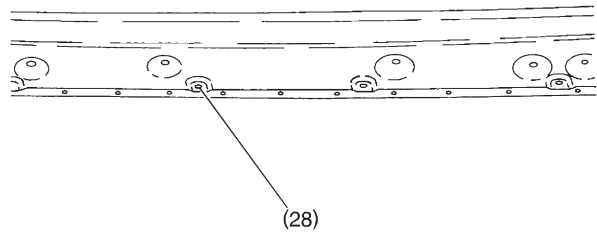

H5M0847A

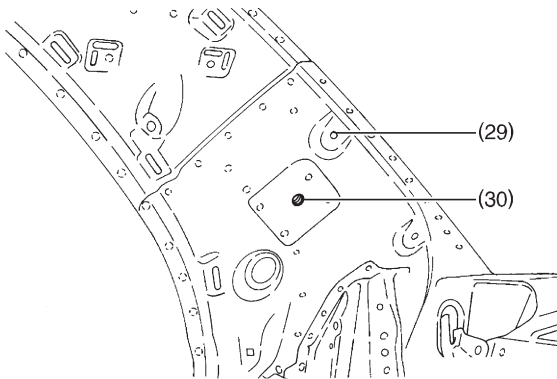

H5M0844A

Sedan

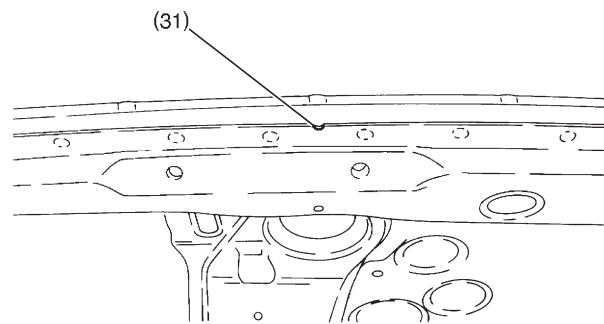

H5M0848A

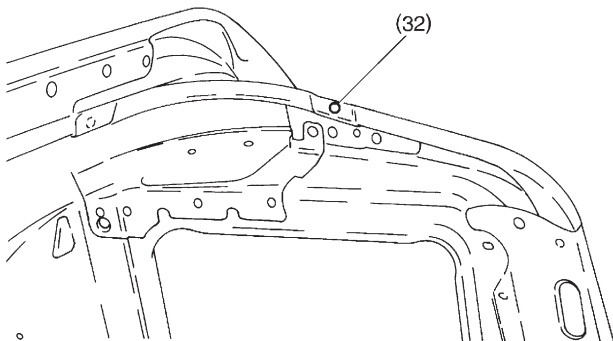

H5M0845A

Sedan

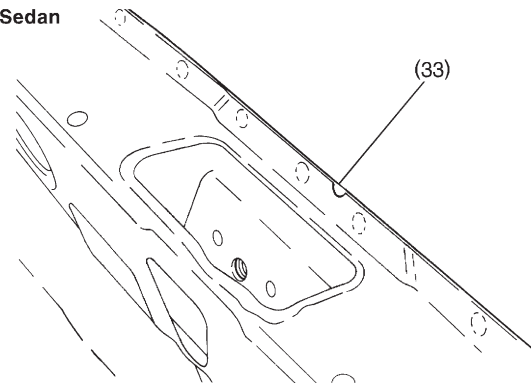

H5M0849A

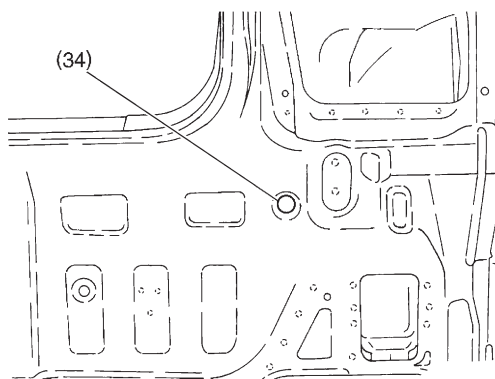

H5M0846A

Sedan

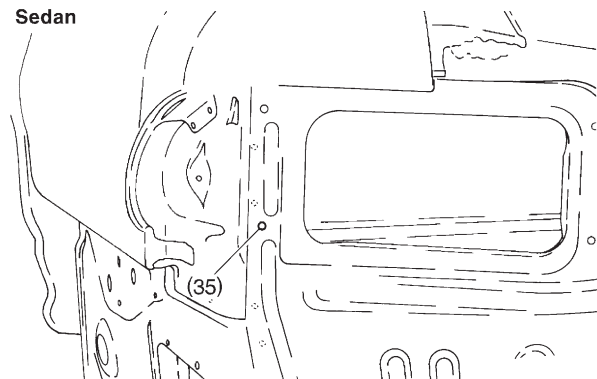

H5M0850A

DATUM POINTS

Body Structure

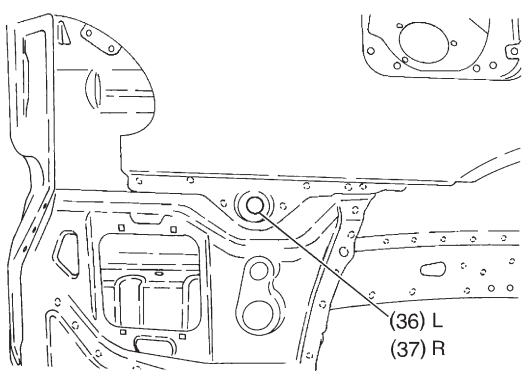
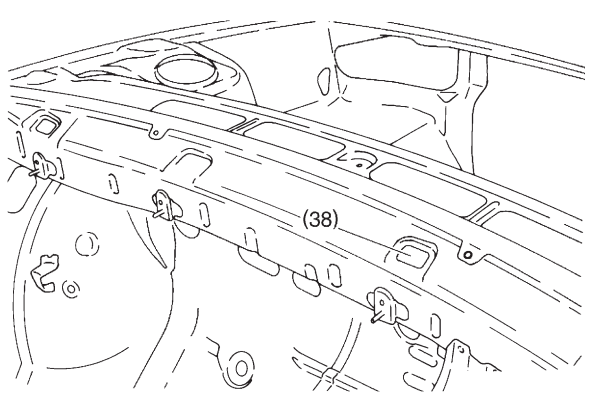
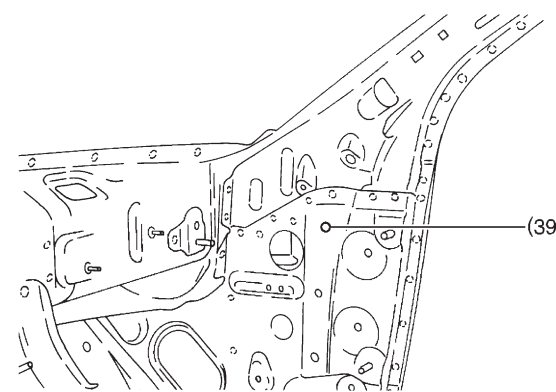
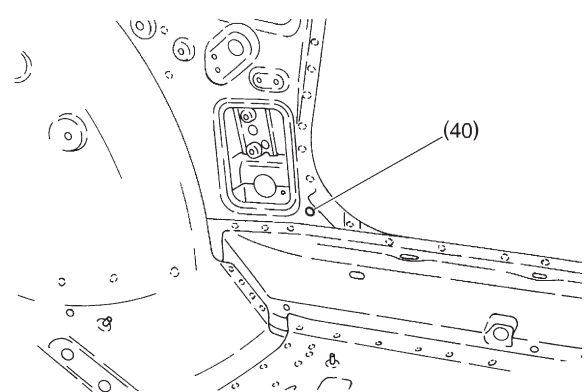
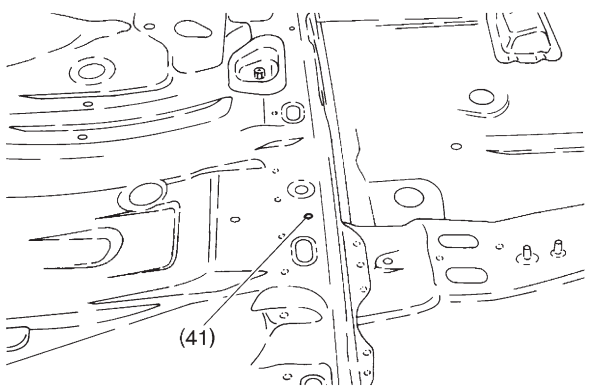
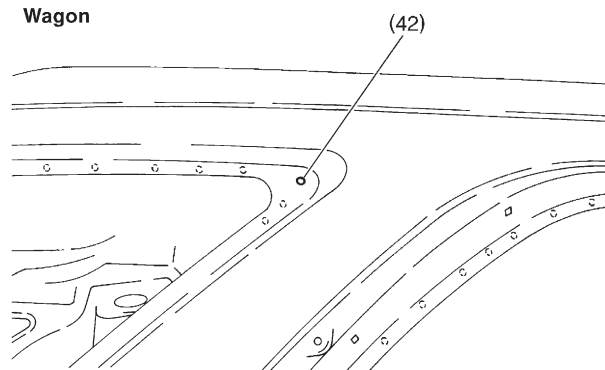
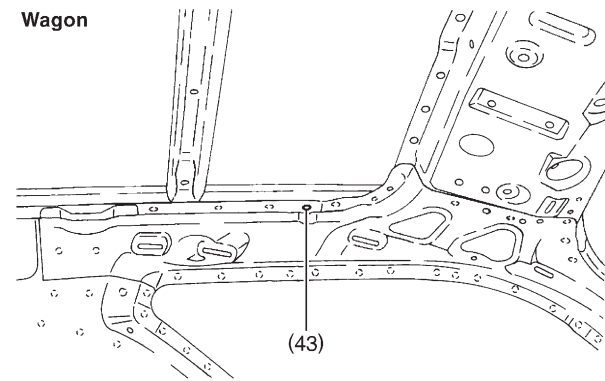
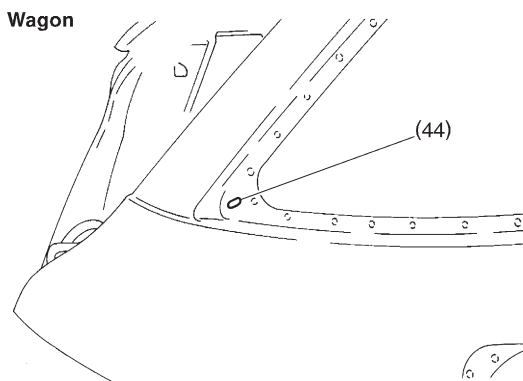
 <p>(36) L (37) R</p> <p>H5M0851A</p>	 <p>(38)</p> <p>H5M0855A</p>
 <p>(39)</p> <p>H5M0852A</p>	 <p>(40)</p> <p>H5M0856A</p>
 <p>(41)</p> <p>H5M0853A</p>	<p>Wagon</p>  <p>(42)</p> <p>H5M0857A</p>
<p>Wagon</p>  <p>(43)</p> <p>H5M0854A</p>	<p>Wagon</p>  <p>(44)</p> <p>H5M0858A</p>

Wagon

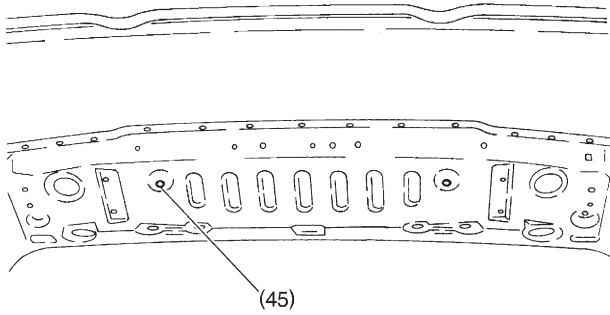

H5M0859A

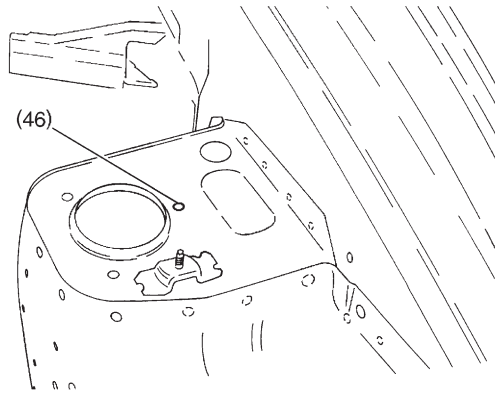

H5M0863A

Wagon

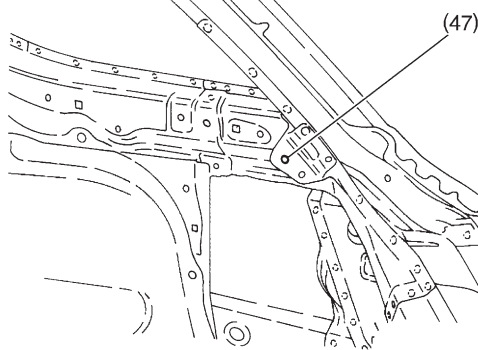

H5M0860A

Wagon

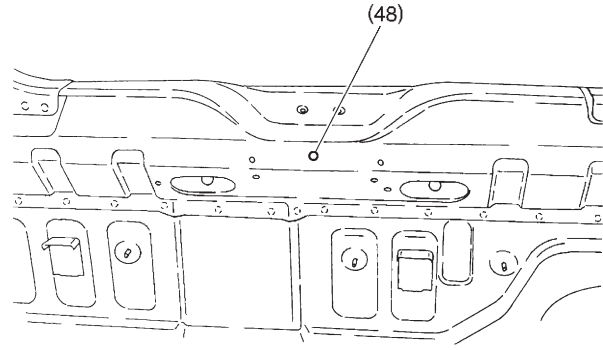

H5M0864A

Wagon

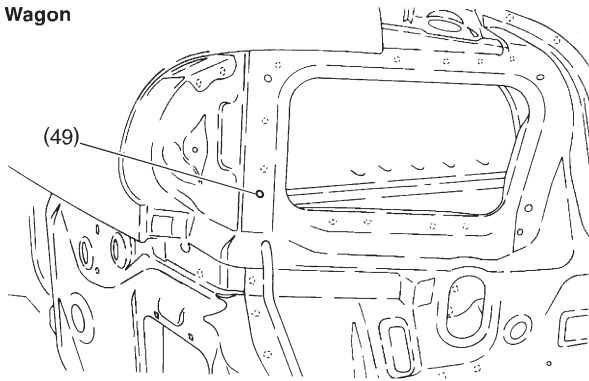

H5M0861A

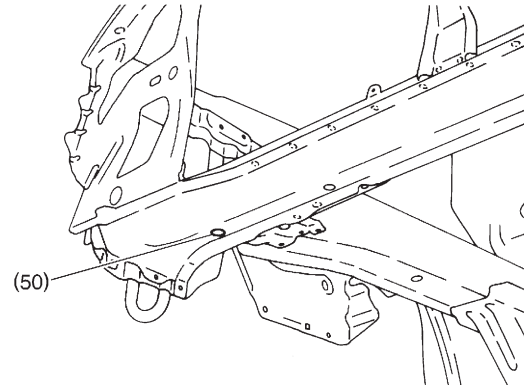

H5M0865A

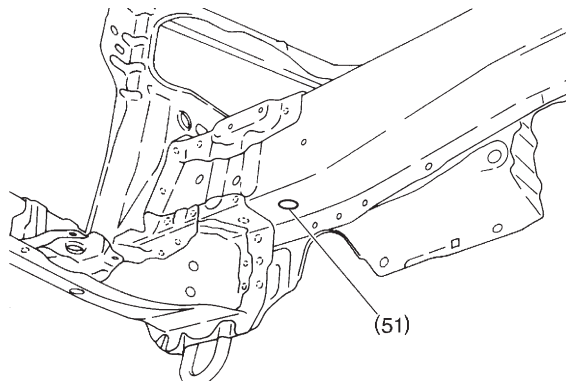

H5M0862A

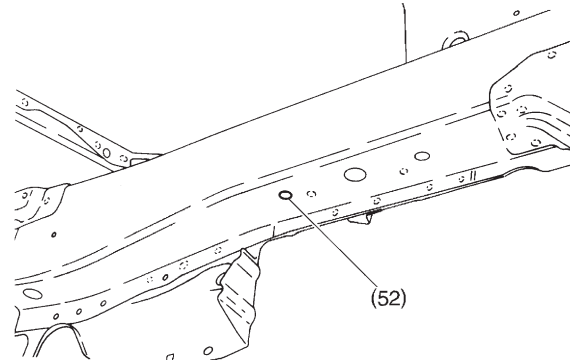

H5M0866A

DATUM POINTS

Body Structure

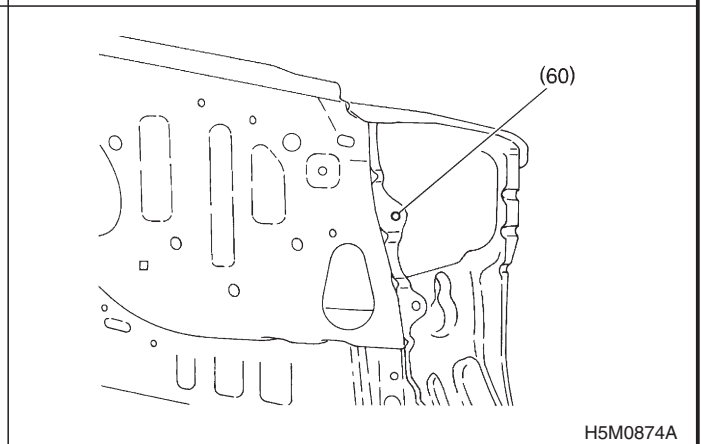
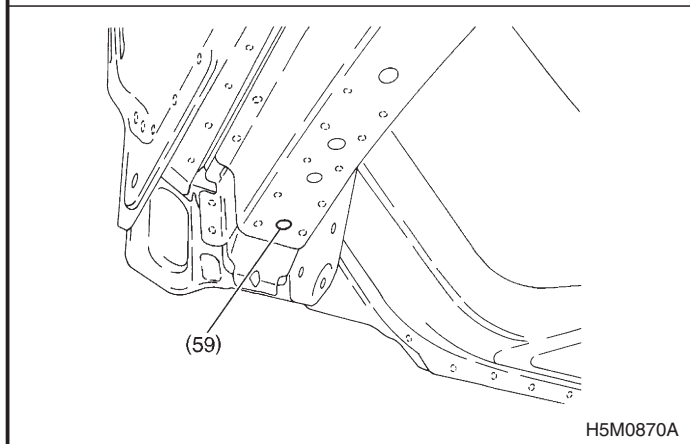
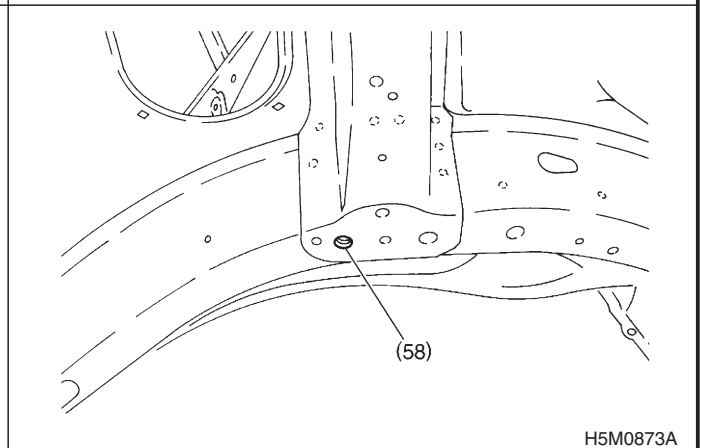
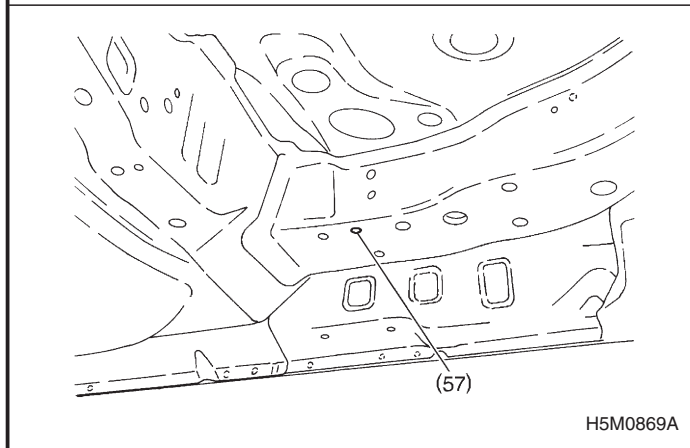
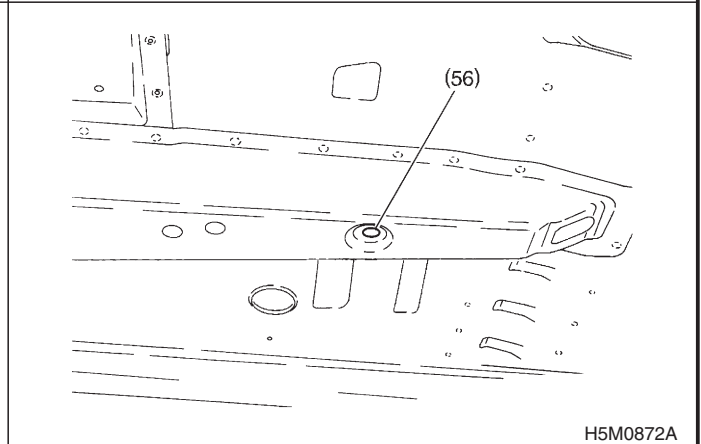
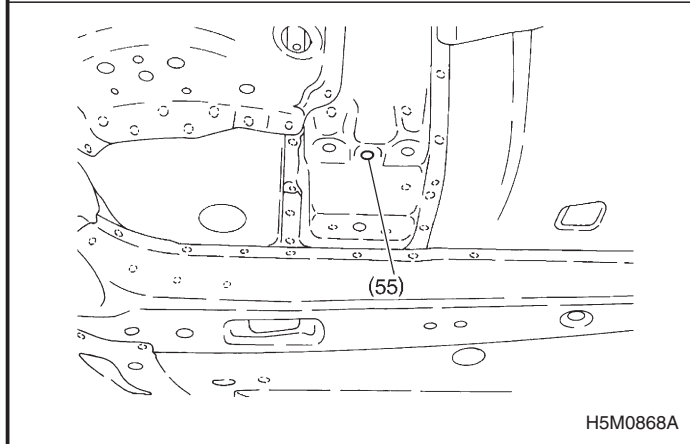
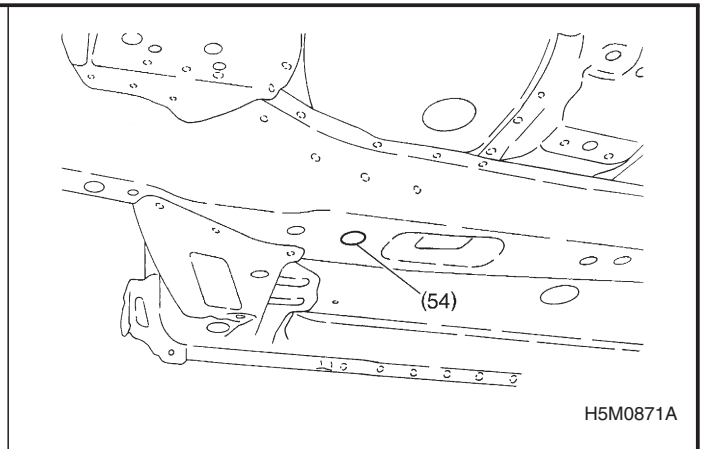
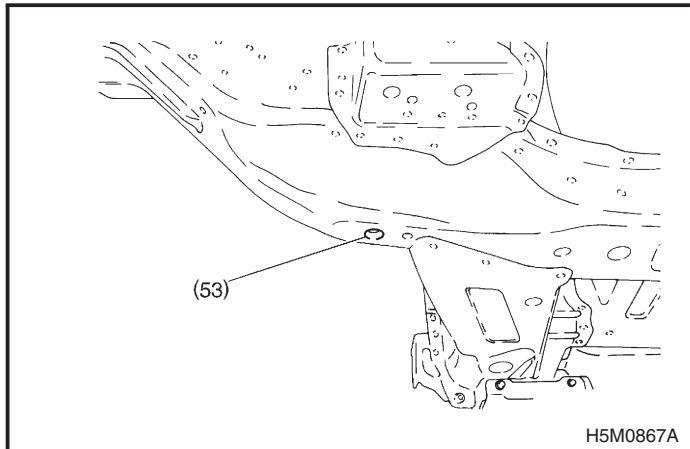

DATUM POINTS

Body Structure

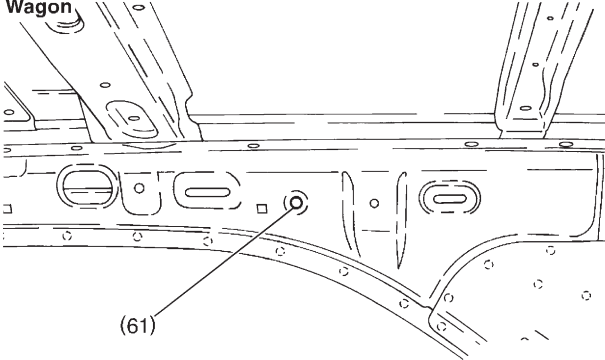
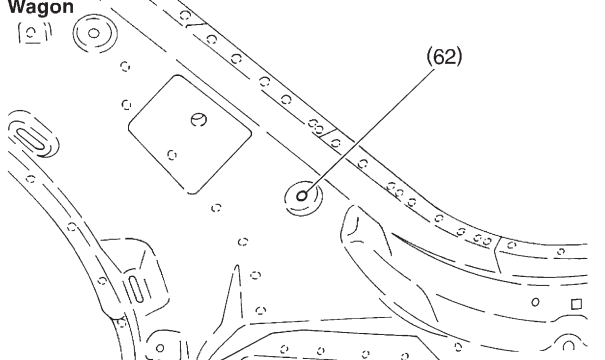
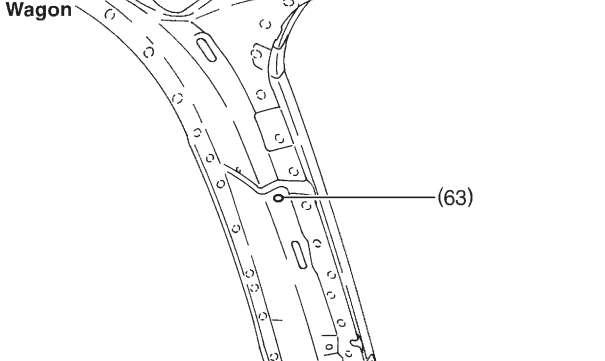
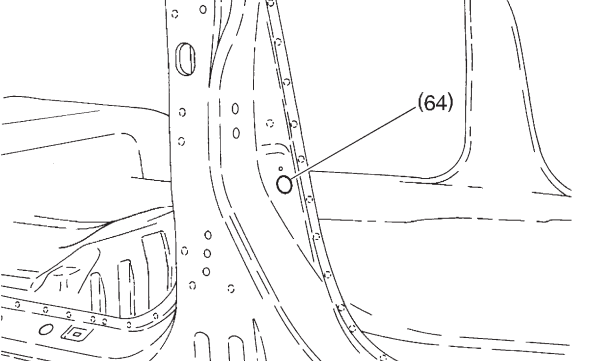
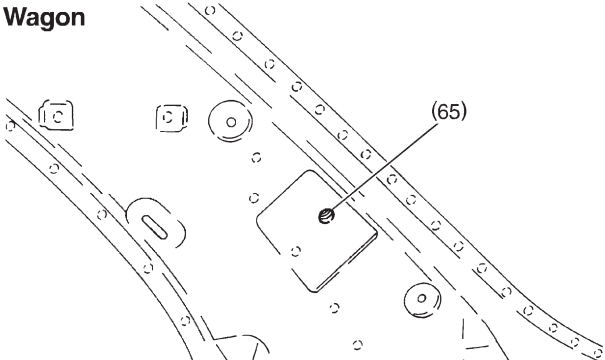
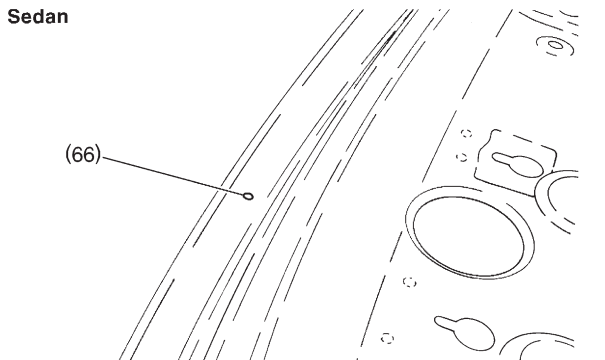
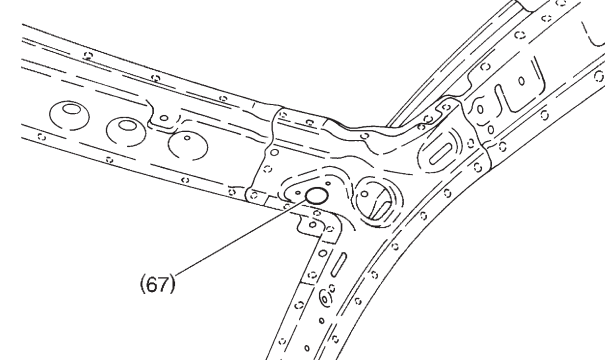
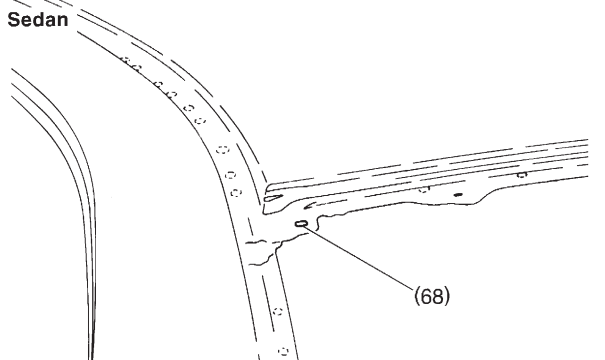
<p>Wagon</p>  <p>(61)</p> <p>H5M0875A</p>	<p>Wagon</p>  <p>(62)</p> <p>H5M0879A</p>
<p>Wagon</p>  <p>(63)</p> <p>H5M0876A</p>	 <p>(64)</p> <p>H5M0880A</p>
<p>Wagon</p>  <p>(65)</p> <p>H5M0670B</p>	<p>Sedan</p>  <p>(66)</p> <p>H5M0881A</p>
 <p>(67)</p> <p>H5M0878A</p>	<p>Sedan</p>  <p>(68)</p> <p>H5M0882A</p>

DATUM POINTS

Body Structure

