

ENGINE AND TRANSMISSION MOUNTING SYSTEM *2-11*

	Page
C COMPONENT PARTS	2
1. Engine Mounting	2
2. Transmission Mounting	3
W SERVICE PROCEDURE	5
1. Engine	5
2. Transmission	18

1. Engine Mounting

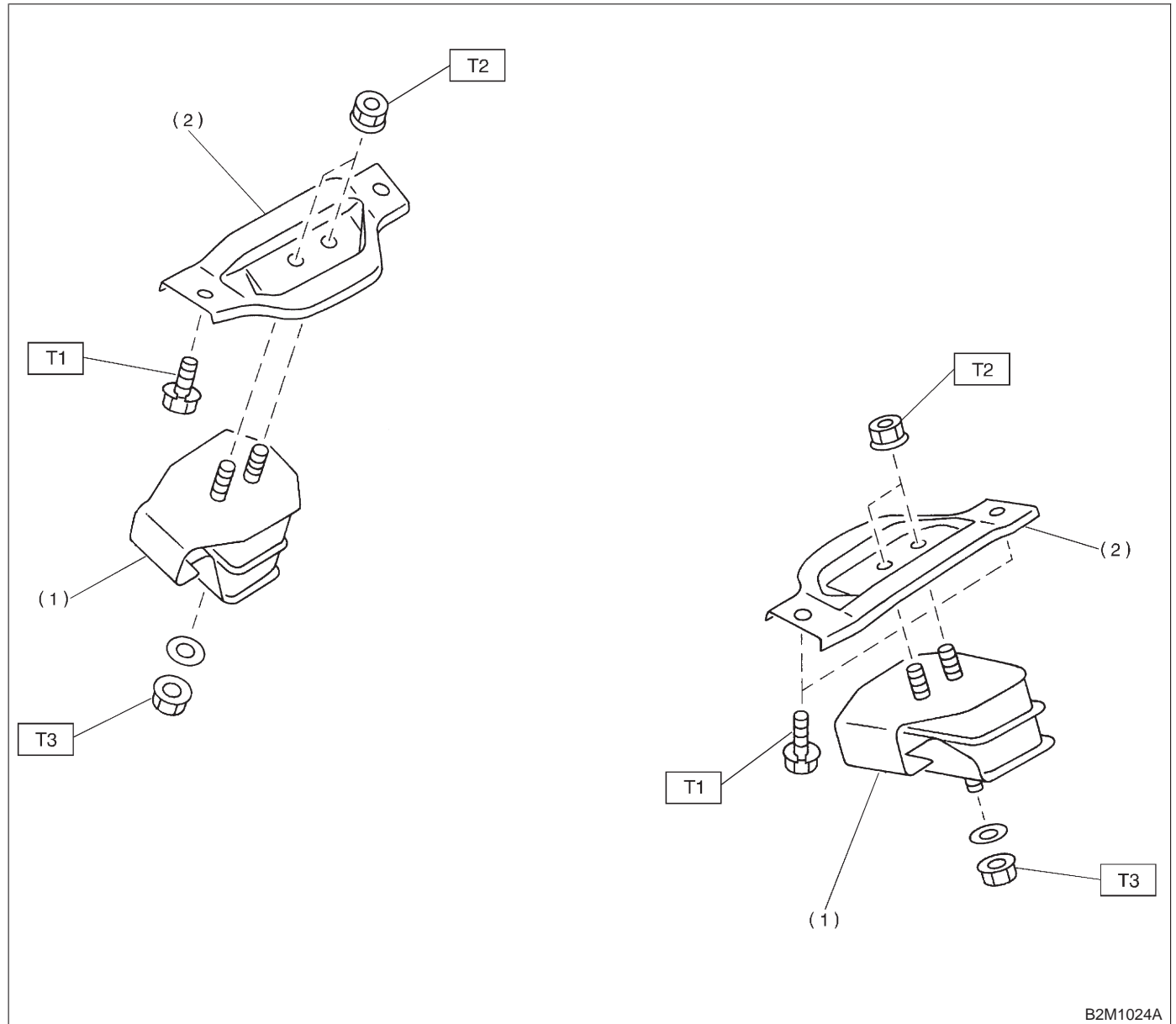

- (1) Front cushion rubber
 (2) Front engine mounting bracket

Tightening torque: N·m (kg·m, ft·lb)

T1: 26±7 (2.7±0.7, 19.5±5.1)

T2: 41±10 (4.2±1.0, 30±7)

T3: 83±15 (8.5±1.5, 61±11)

2. Transmission Mounting

A: MT MODEL

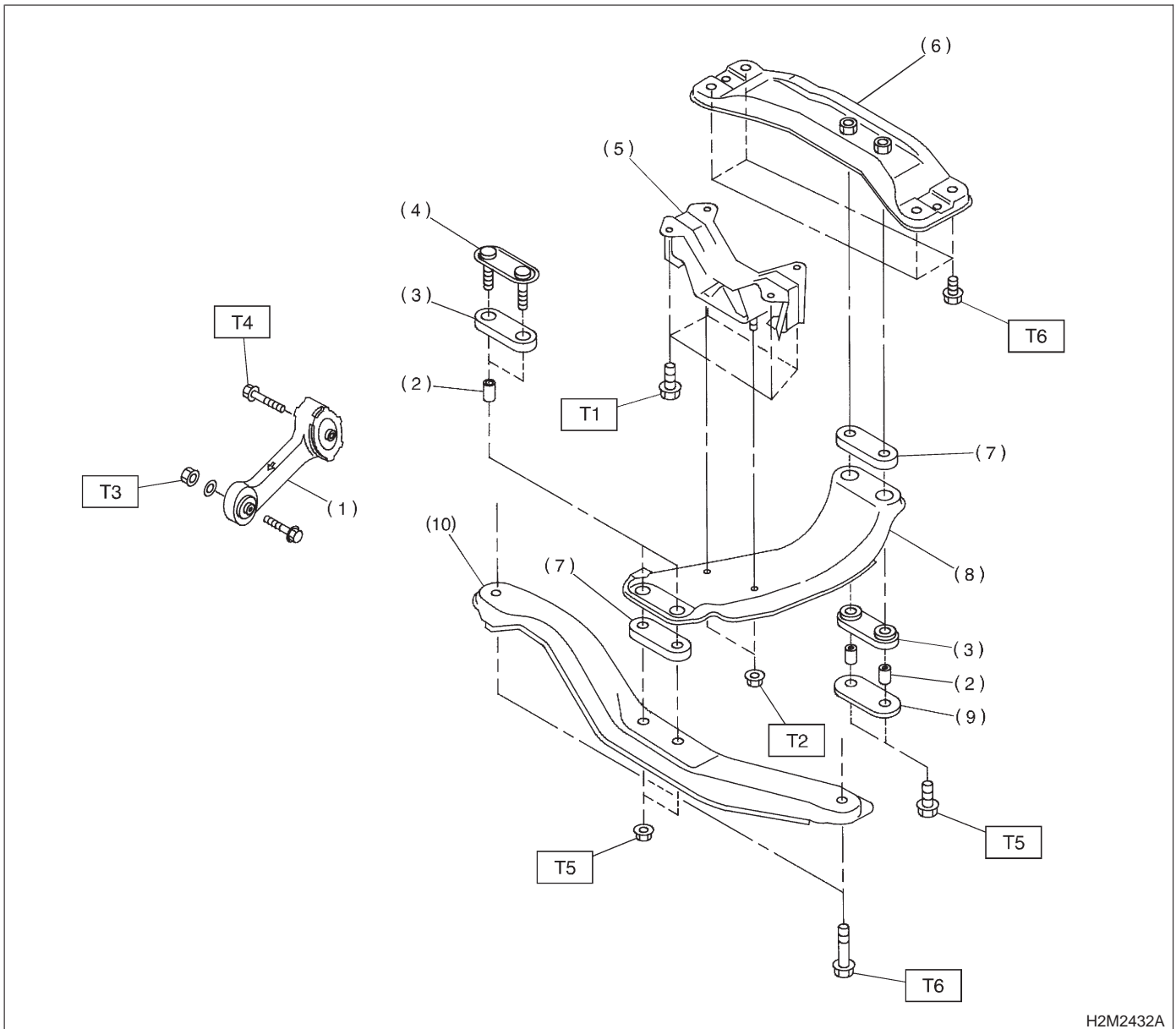

H2M2432A

- | | |
|-------------------------|------------------------|
| (1) Pitching stopper | (8) Center crossmember |
| (2) Spacer | (9) Rear plate |
| (3) Cushion C | (10) Front crossmember |
| (4) Front plate | |
| (5) Rear cushion rubber | |
| (6) Rear crossmember | |
| (7) Cushion D | |

Tightening torque: N-m (kg-m, ft-lb)

T1: 33±5 (3.4±0.5, 24.6±3.6)

T2: 37±10 (3.8±1.0, 27±7)

T3: 49±5 (5.0±0.5, 36.2±3.6)

T4: 57±10 (5.8±1.0, 42±7)

T5: 69±15 (7.0±1.5, 51±11)

T6: 137±20 (14±2, 101±14)

B: AT MODEL

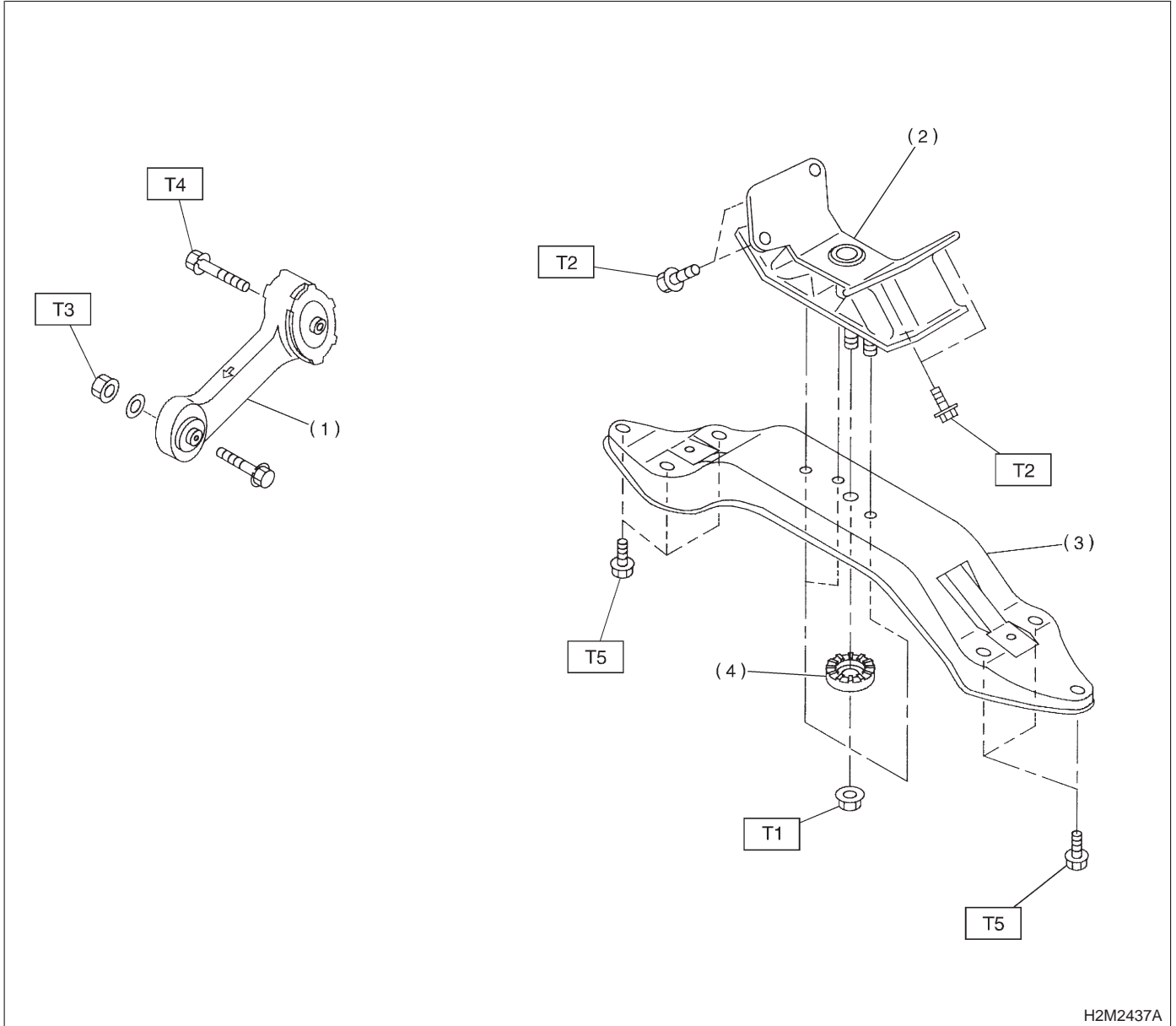

- (1) Pitching stopper
- (2) Rear cushion rubber
- (3) Crossmember
- (4) Stopper

Tightening torque: N·m (kg·m, ft·lb)

T1: 37±10 (3.8±1.0, 27±7)

T2: 38±15 (3.9±1.5, 28±11)

T3: 49±5 (5.0±0.5, 36.2±3.6)

T4: 57±10 (5.8±1.0, 42±7)

T5: 69±15 (7.0±1.5, 51±11)

1. Engine

A: GENERAL PRECAUTION

- 1) Remove or install engine in an area where chain hoists, lifting devices, etc. are available for ready use.
- 2) Be sure not to damage coated surfaces of body panels with tools or stain seats and windows with coolant or oil. Place a cover over fenders, as required, for protection.
- 3) Prior to starting work, prepare the following: Service tools, clean cloth, containers to catch coolant and oil, wire ropes, chain hoist, transmission jacks, etc.
- 4) Lift-up or lower the vehicle when necessary. Make sure to support the correct positions. <Ref. to 1-3 [G7B0].>

B: REMOVAL

- 1) Set the vehicle on lift arms.
- 2) Open front hood fully and support with stay.
- 3) Release fuel pressure.
 - (1) Disconnect fuel pump connector.

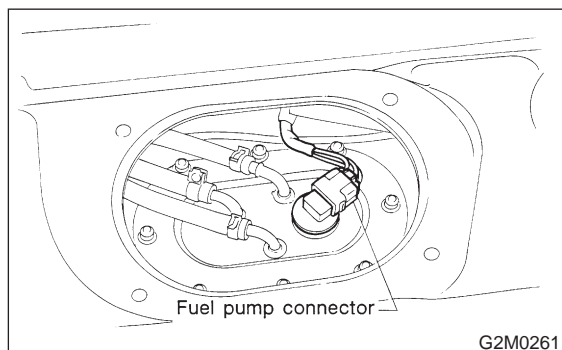

- (2) Start the engine, and run until it stalls.
 - (3) After the engine stalls, crank it for five seconds more.
 - (4) Turn ignition switch to "OFF".
 - (5) Remove filler cap.
- 4) Disconnect battery cables and remove battery from vehicle.

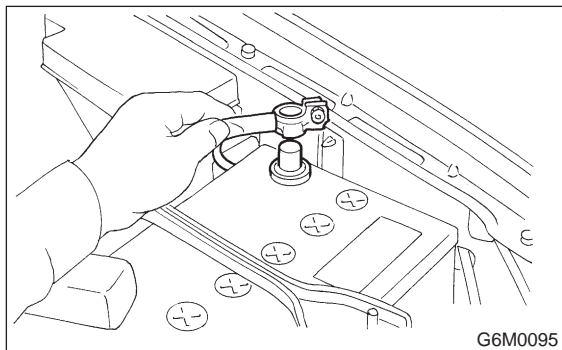

- 5) Drain coolant. Set container under the vehicle, and remove drain cock from radiator.

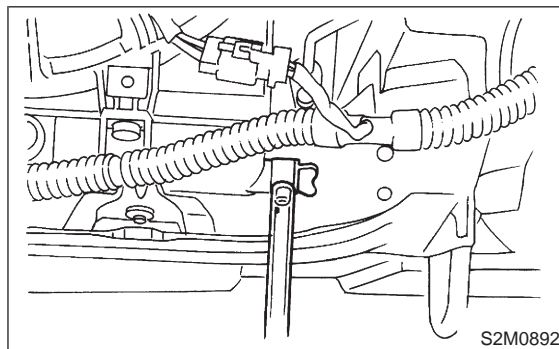

- 6) Remove cooling system.
 - (1) Disconnect connectors from radiator main fan and sub fan motors.

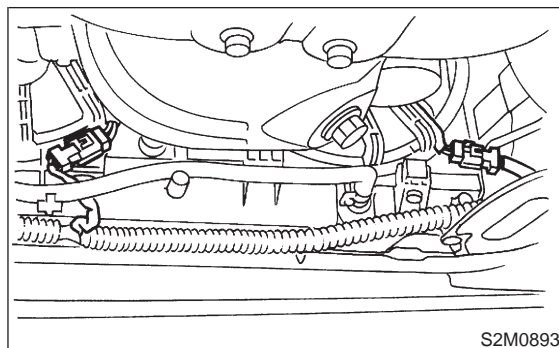

- (2) Disconnect radiator outlet hose from thermostat cover, and remove ATF cooler hose from clip of radiator.

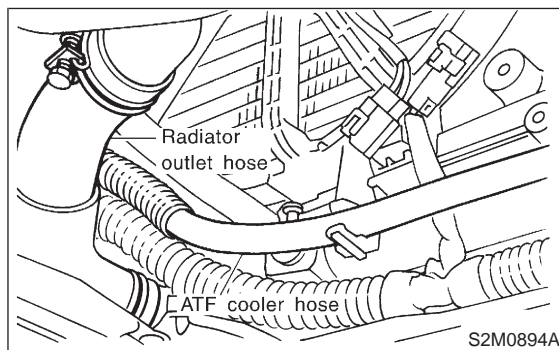

- (3) Disconnect ATF cooler hoses from radiator.

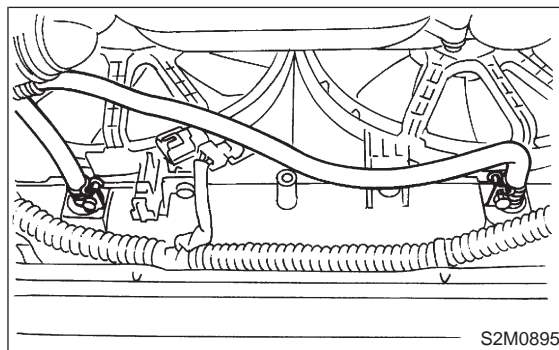

1. Engine

- (4) Remove ATF cooler pipe from cylinder head.

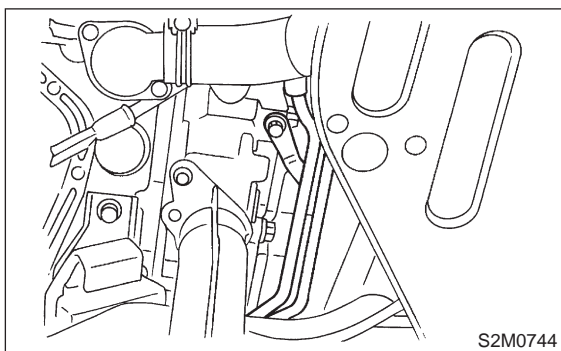

- (5) Remove V-belt cover.

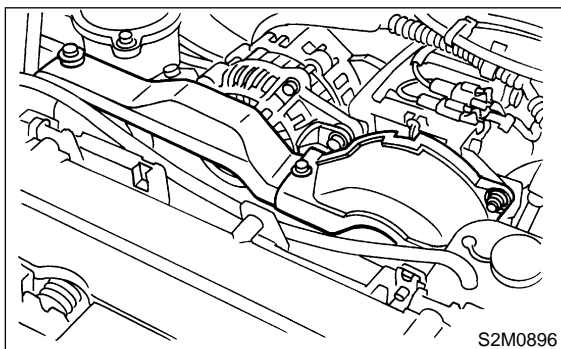

- (6) Disconnect radiator inlet hose from radiator.

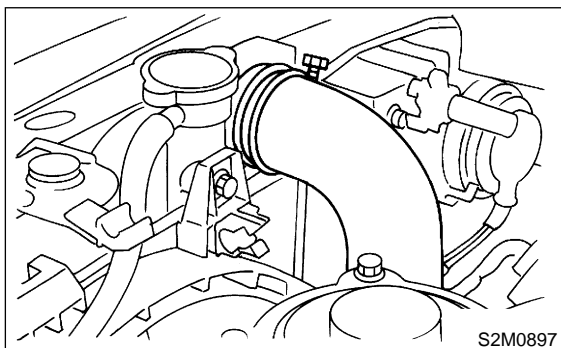

- (7) Remove radiator upper bracket, and remove radiator assembly from vehicle.

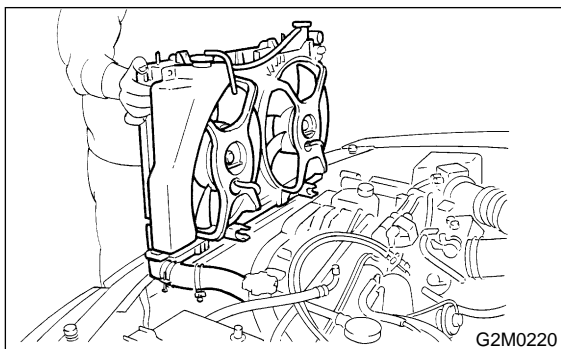

- 7) Collect refrigerant, and remove pressure hoses.
(With A/C)

- (1) Place and connect the attachment hose to the refrigerant recycle system.

- (2) Collect refrigerant from A/C system.
(3) Disconnect A/C flexible hoses from A/C compressor.

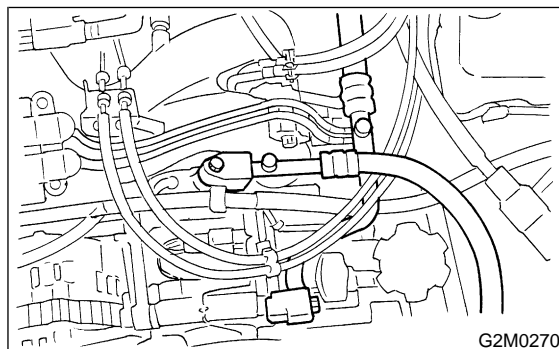

- 8) Remove air intake system.

- (1) Disconnect connector from mass air flow sensor. (Except 2200 cc California spec. vehicles)

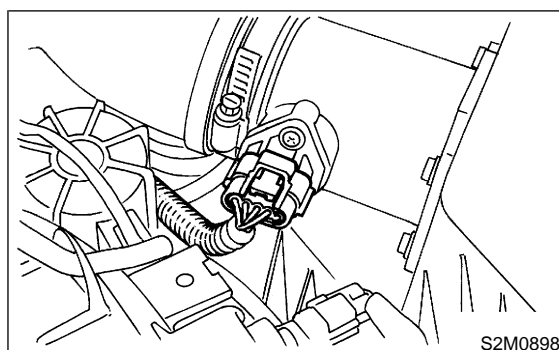

- (2) Remove air intake duct with air cleaner upper cover, and remove air cleaner element. (Except 2200 cc California spec. vehicles) <Ref. to 2-7 [W1A0].> and <Ref. to 2-7 [W18A0].>
(3) Remove air cleaner case and duct. (2200 cc California spec. vehicles) <Ref. to 2-7 [W1A0].>

9) Remove chamber stay.

- **MT vehicles**

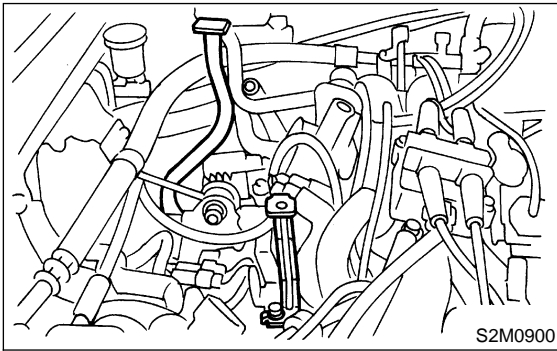

- **AT vehicles**

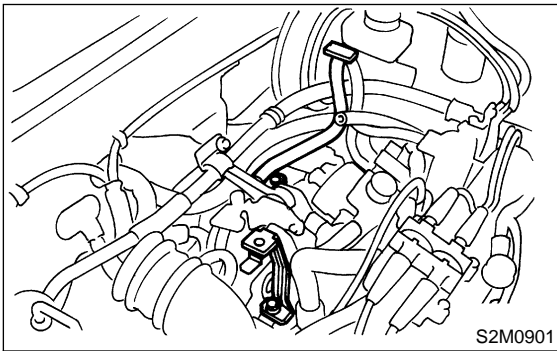

10) Disconnect connectors, cables and hoses.

(1) Disconnect the following connectors.

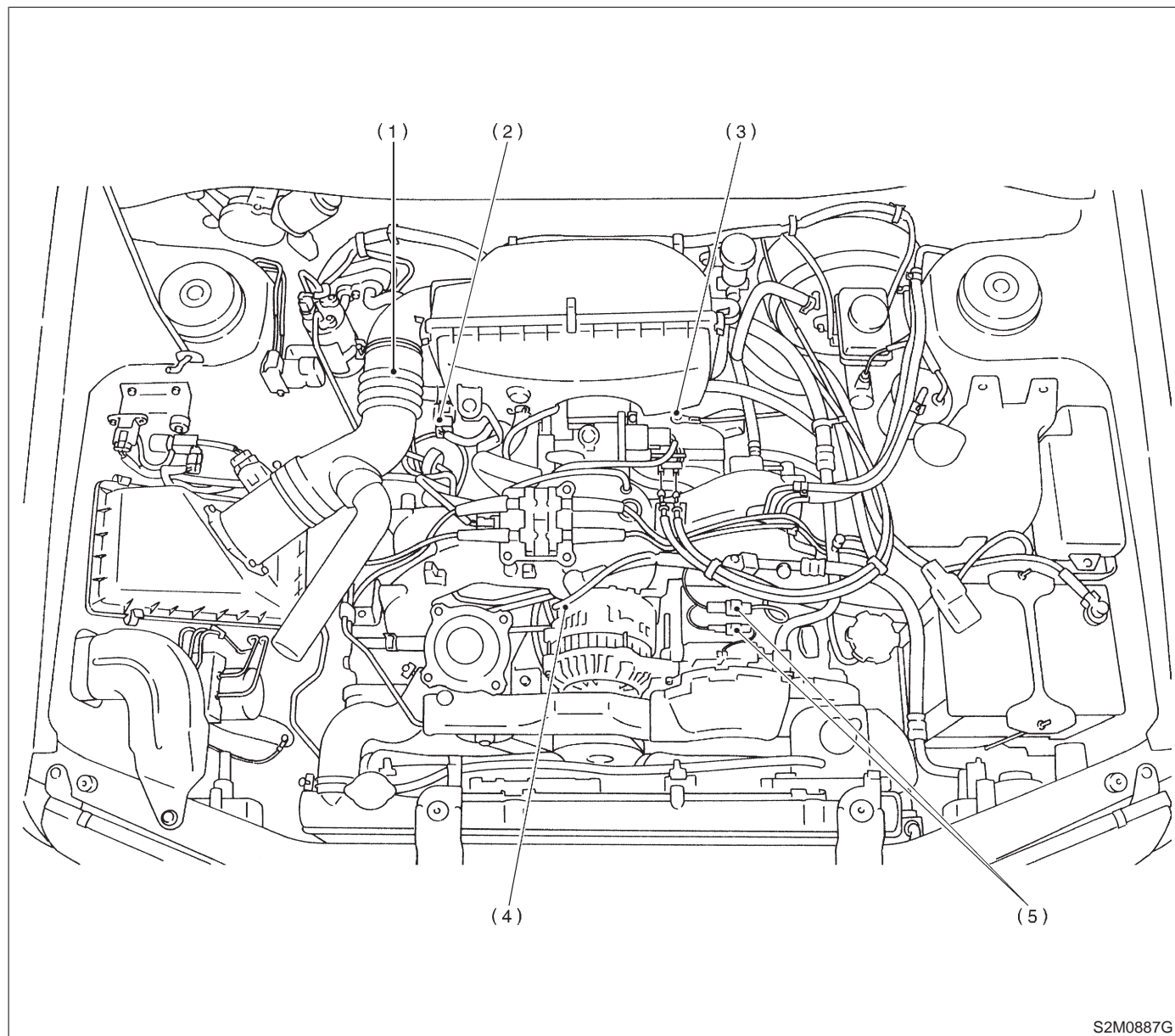

S2M0887G

- (1) Front oxygen sensor connector
- (2) Engine harness connectors
- (3) Engine ground terminal stay

- (4) Alternator connector and terminal

- (5) A/C compressor connectors
(With A/C)

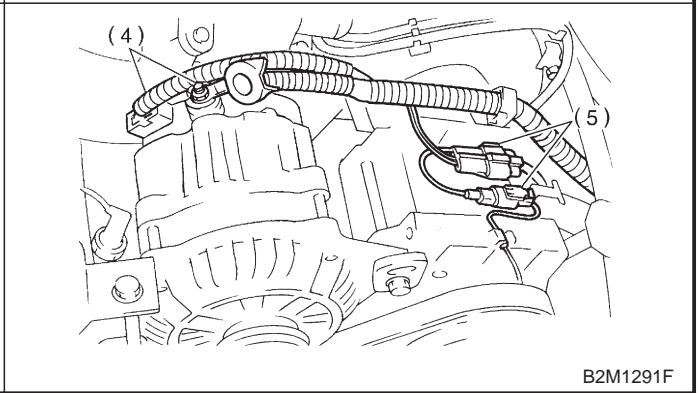
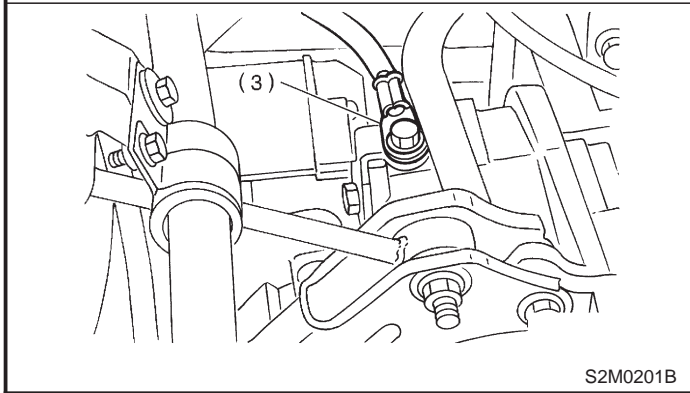
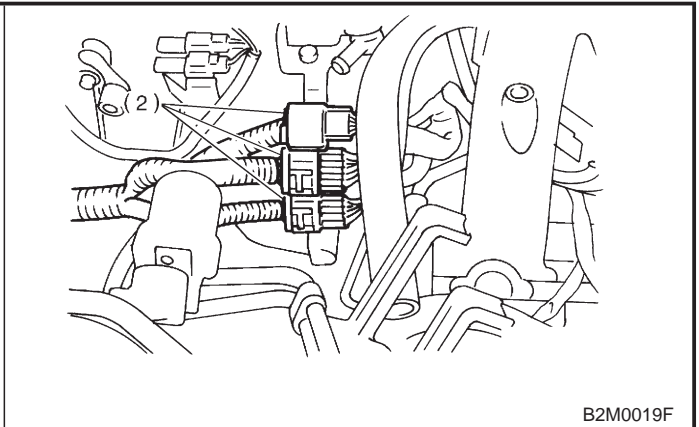
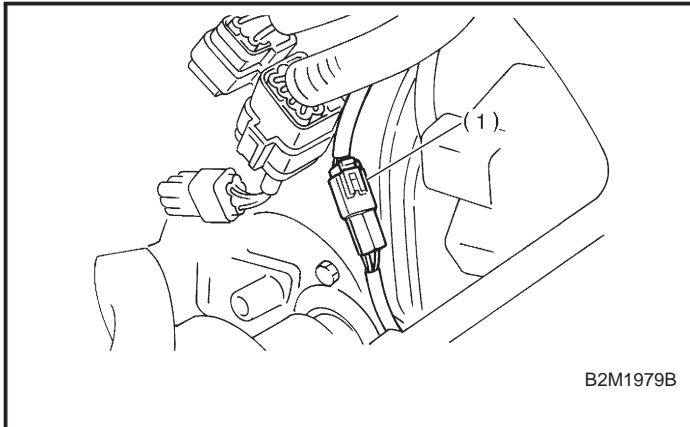

(2) Disconnect the following cables.

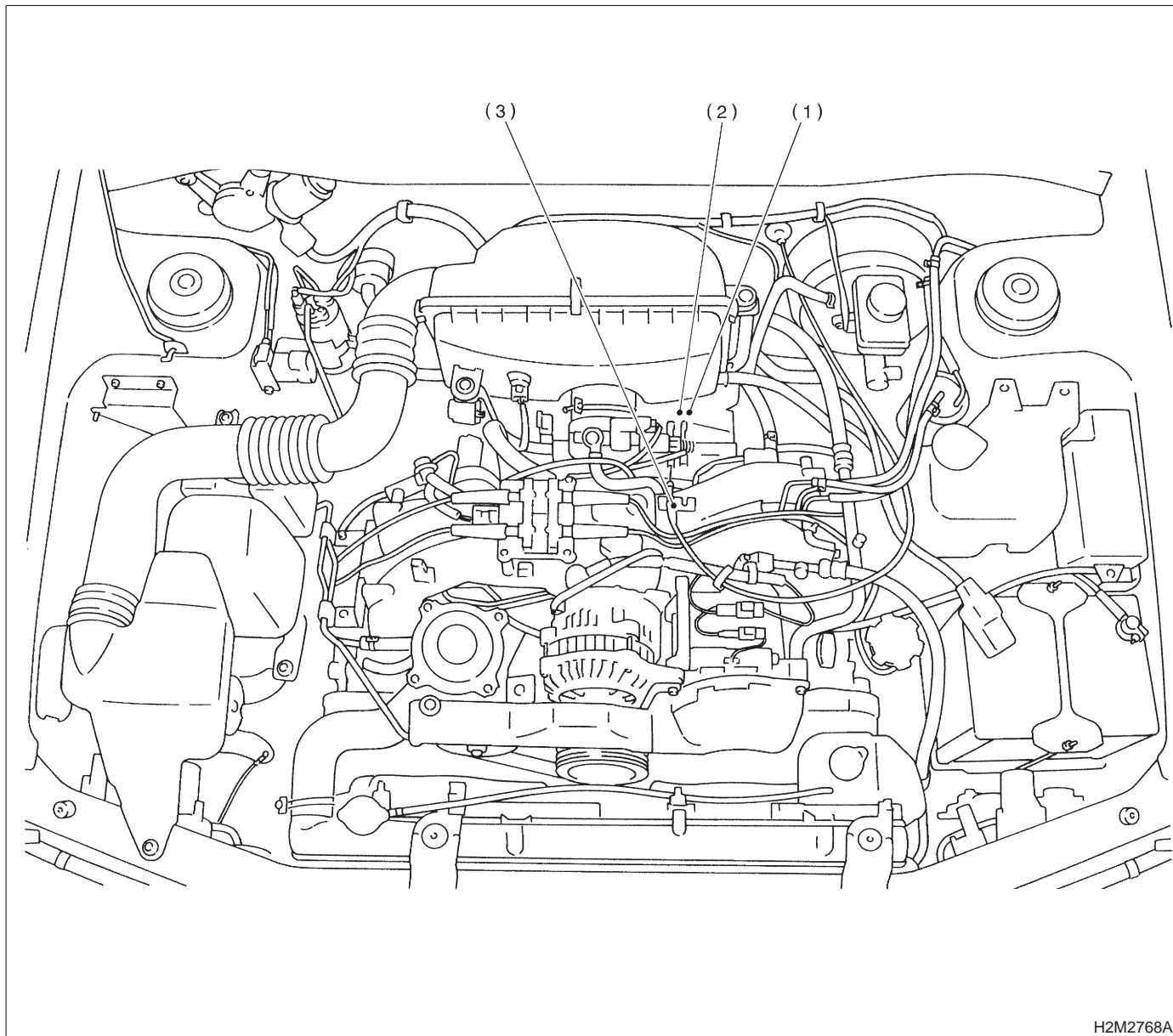

H2M2768A

(1) Clutch release spring (2200 cc MT vehicle)

(2) Clutch cable (2200 cc MT vehicle)

(3) Accelerator cable

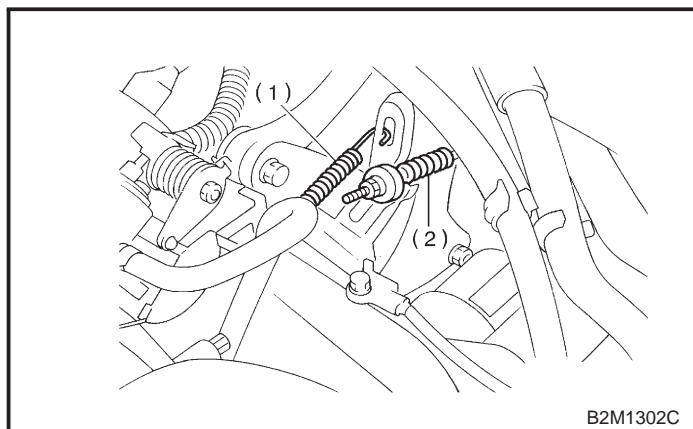

B2M1302C

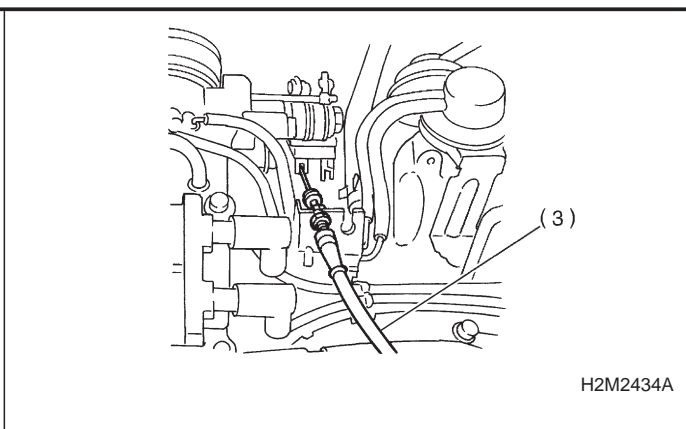

H2M2434A

(3) Disconnect the following hoses.

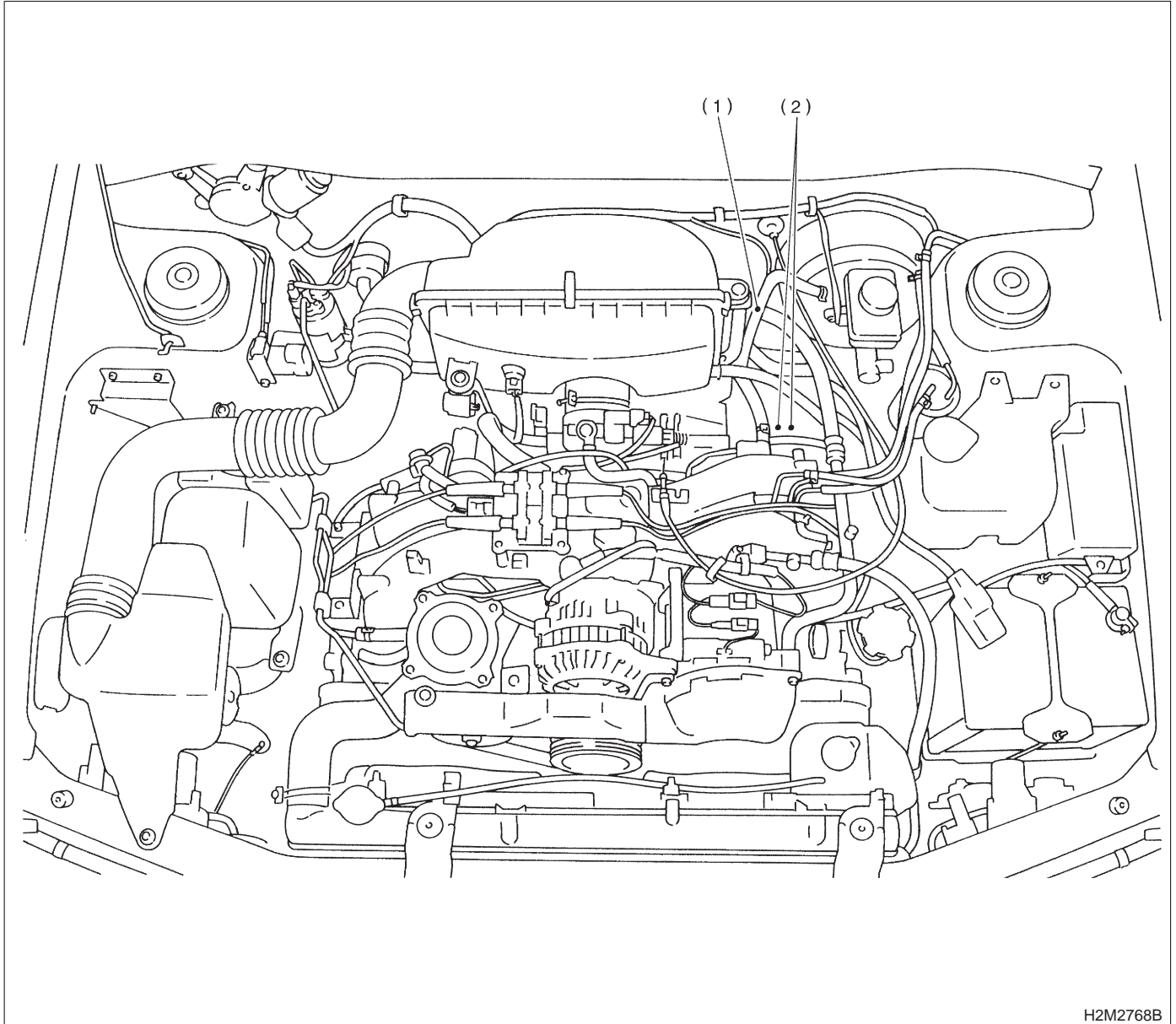

H2M2768B

(1) Brake booster vacuum hose

(2) Heater inlet and outlet hoses

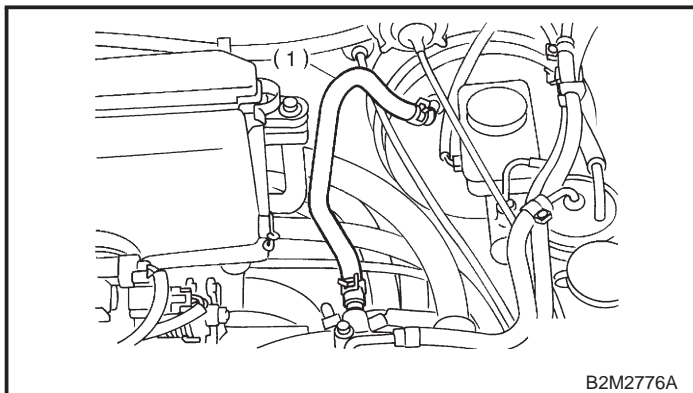

B2M2776A

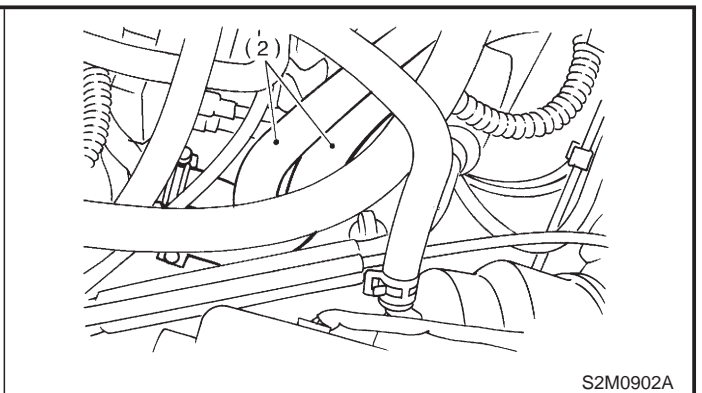

S2M0902A

11) Remove power steering pump from bracket.

1. Engine

- (1) Loosen lock bolt and slider bolt, and remove front side V-belt.

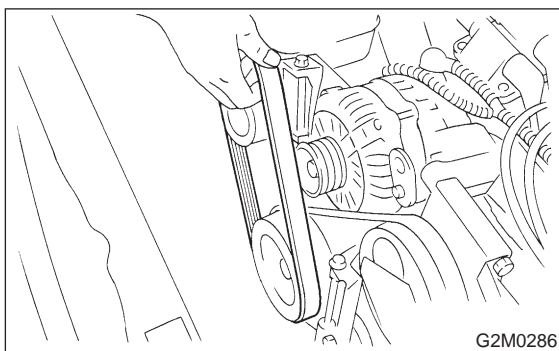

- (2) Remove pipe with bracket from intake manifold.

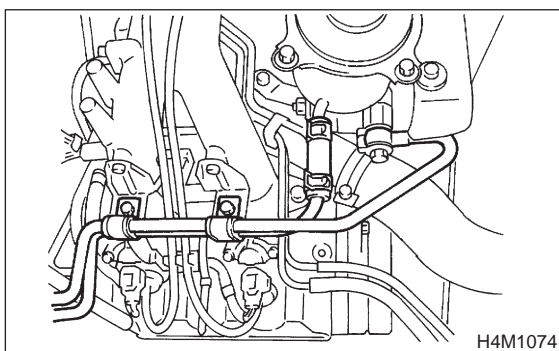

- (3) Remove bolts which install power steering pump from bracket.

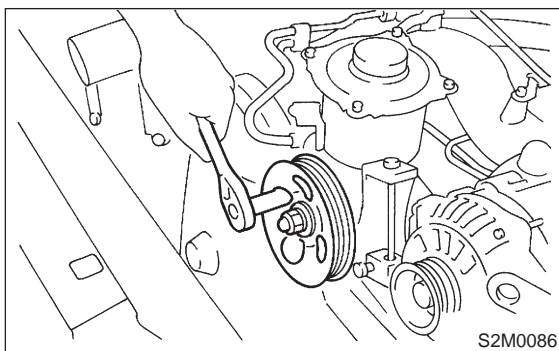

- (4) Place power steering pump on the right side wheel apron.

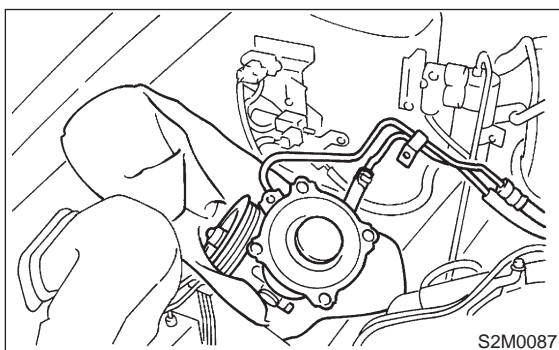

- 12) Remove front exhaust pipe and center exhaust pipe.

- (1) Lift-up the vehicle.
(2) Disconnect connector from rear oxygen sensor.

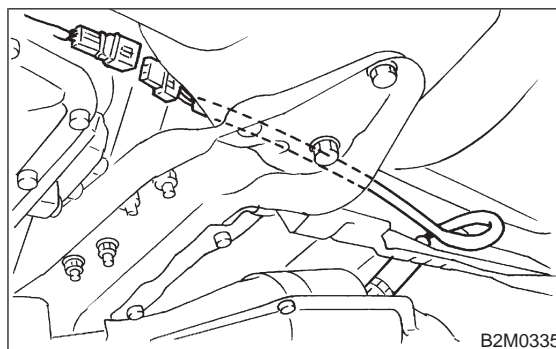

- (3) Remove nuts which install front exhaust pipe onto engine.

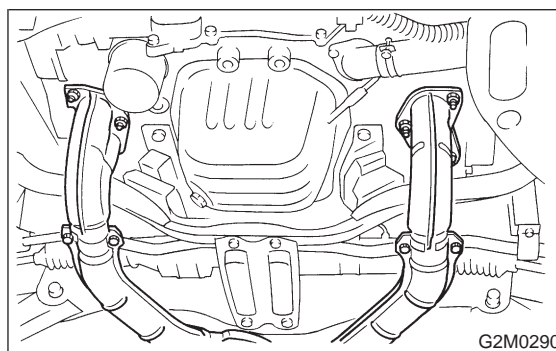

- (4) Separate center exhaust pipe from rear exhaust pipe.

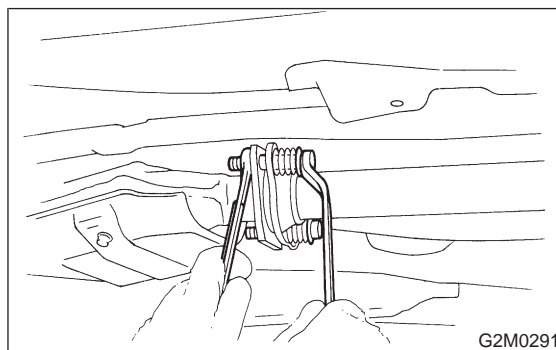

- (5) Remove bolt which installs center exhaust pipe on hunger bracket.

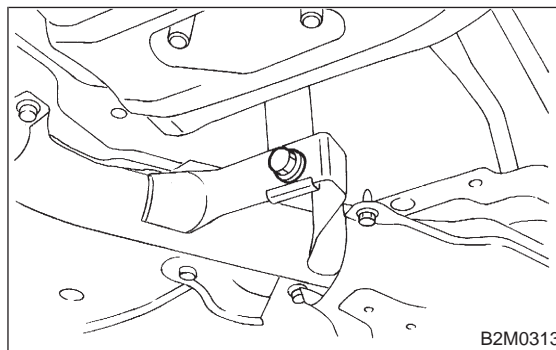

- (6) Take off front and center exhaust pipes.

CAUTION:

Exhaust pipe will drop when all bolts are removed. So, hold it when removing the last bolt.

13) Remove nuts which hold lower side of transmission to engine.

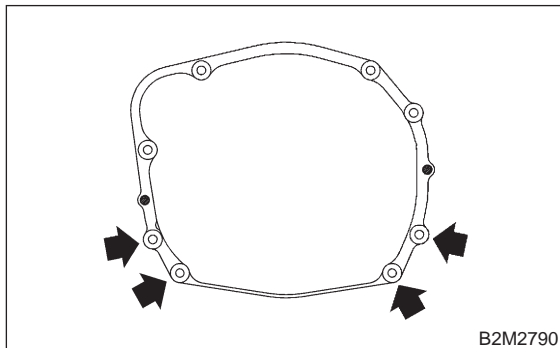

14) Remove nuts which install front cushion rubber onto front crossmember.

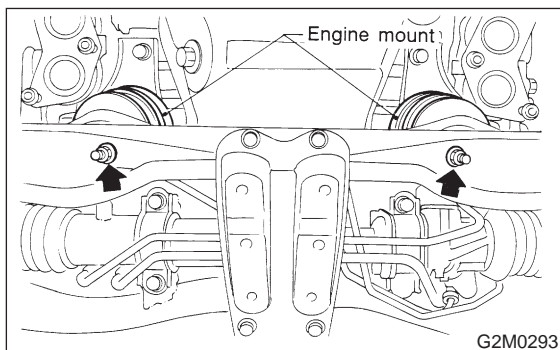

15) Separate torque converter from drive plate.
(AT model)

- (1) Lower the vehicle.
- (2) Remove service hole plug.
- (3) Remove bolts which hold torque converter to drive plate.
- (4) Remove other bolts while rotating the engine using ST.

2200 cc vehicles:

ST 499977300 CRANK PULLEY WRENCH

2500 cc vehicles:

ST 499977100 CRANK PULLEY WRENCH

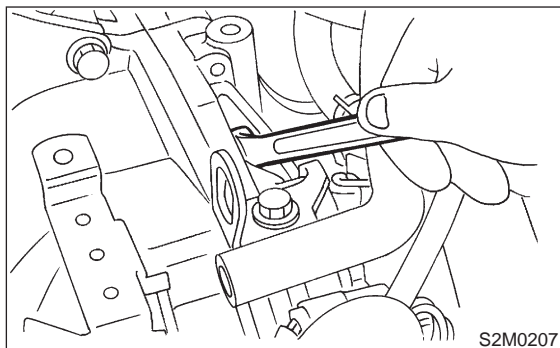

16) Remove pitching stopper.

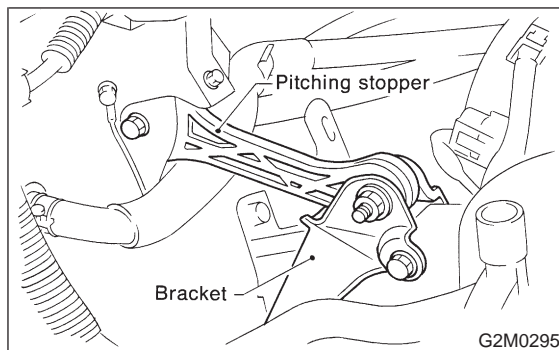

17) Disconnect fuel delivery hose, return hose and evaporation hose.

CAUTION:

- Disconnect hose with its end wrapped with cloth to prevent fuel from splashing.
- Catch fuel from hose into container.

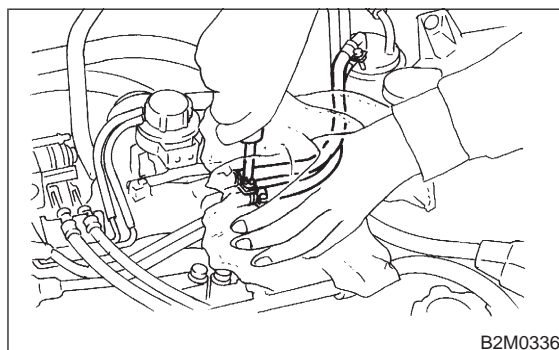

18) Support engine with a lifting device and wire ropes.

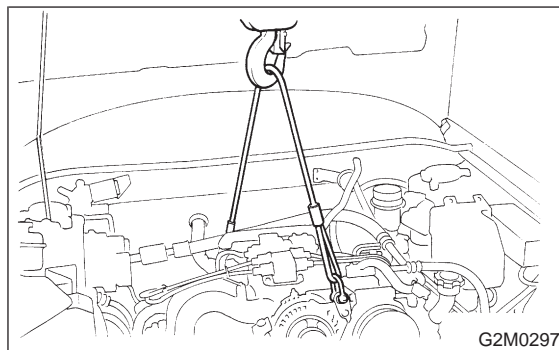

1. Engine

19) Support transmission with a garage jack.

CAUTION:

Before moving engine away from transmission, check to be sure no work has been overlooked. Doing this is very important in order to facilitate re-installation and because transmission lowers under its own weight.

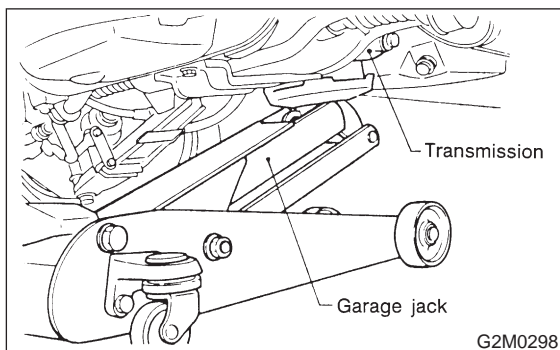

20) Remove bolts which holds upper side of transmission to engine.

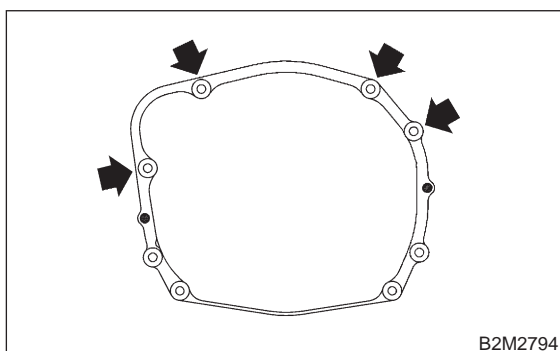

21) Remove engine from vehicle.

- (1) Slightly raise engine.
- (2) Raise transmission with garage jack.
- (3) Move engine horizontally until mainshaft is withdrawn from clutch cover.
- (4) Slowly move engine away from engine compartment.

CAUTION:

Be careful not to damage adjacent parts or body panels with crank pulley, oil pressure gauge, etc.

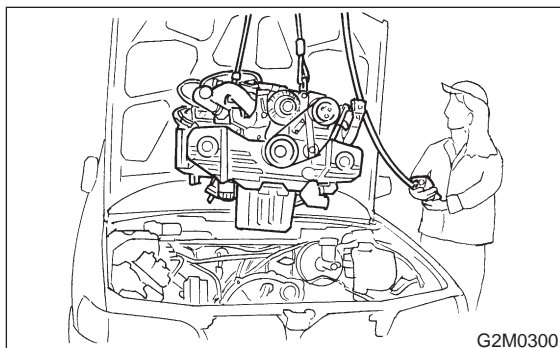
**C: INSTALLATION**

1) Install engine onto transmission.

- (1) Position engine in engine compartment and align it with transmission.

CAUTION:

Be careful not to damage adjacent parts or body panels with crank pulley, oil pressure gauge, etc.

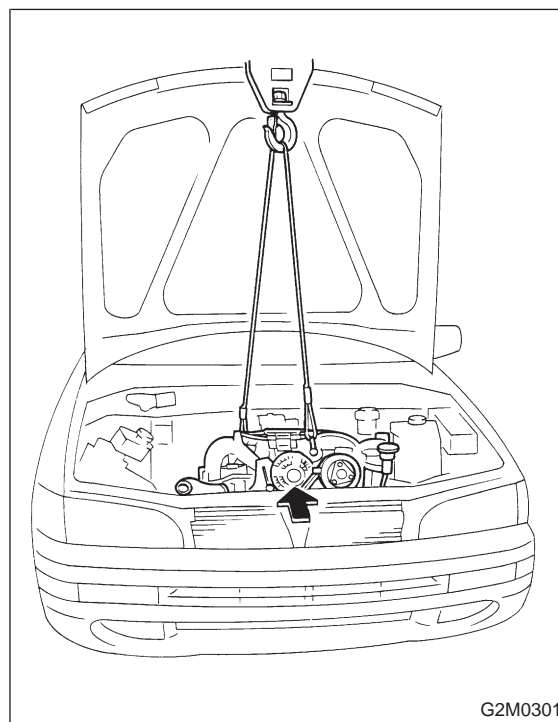

(2) Apply a small amount of grease to splines of mainshaft.

2) Tighten bolts which hold upper side of transmission to engine.

Tightening torque:

50±4 N·m (5.1±0.4 kg-m, 36.9±2.9 ft-lb)

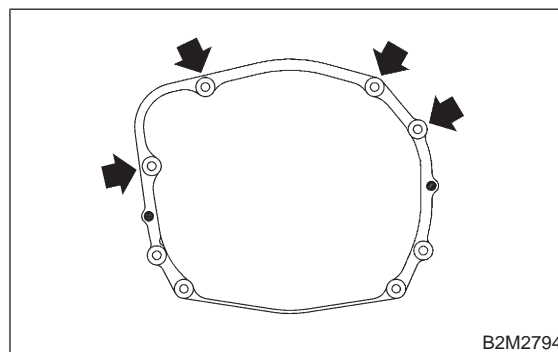

- 3) Remove lifting device and wire ropes.

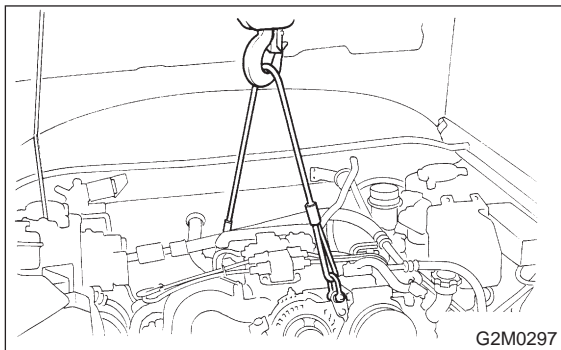

- 4) Remove garage jack.
5) Install pitching stopper.

Tightening torque:

T1: 57 ± 10 N-m (5.8 ± 1.0 kg-m, 42 ± 7 ft-lb)

T2: 49 ± 5 N-m (5.0 ± 0.5 kg-m, 36.2 ± 3.6 ft-lb)

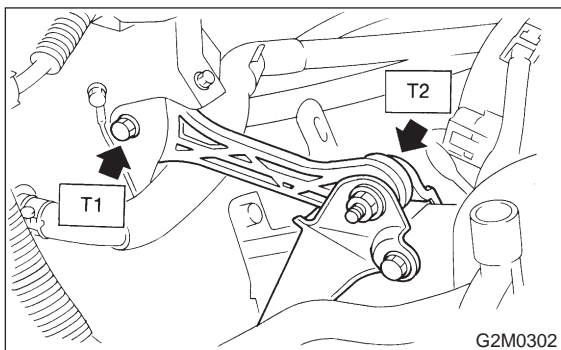

- 6) Install torque converter onto drive plate. (AT model)

(1) Tighten bolts which hold torque converter to drive plate.

(2) Tighten other bolts while rotating the engine by using ST.

2200 cc vehicles:

ST 499977300 CRANK PULLEY WRENCH

2500 cc vehicles:

ST 499977100 CRANK PULLEY WRENCH

CAUTION:

Be careful not to drop bolts into torque converter housing.

Tightening torque:

25 ± 2 N-m (2.5 ± 0.2 kg-m, 18.1 ± 1.4 ft-lb)

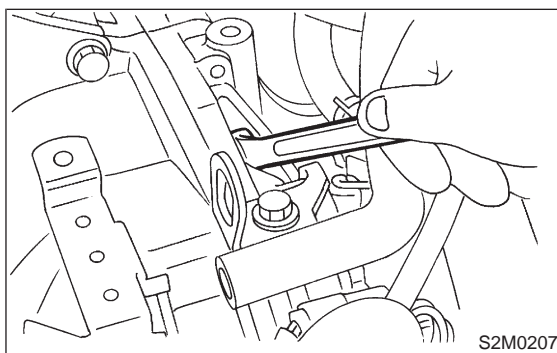

- (3) Clog plug onto service hole.

- 7) Install power steering pump on bracket.

(1) Install power steering pump on bracket, and tighten bolts.

Tightening torque:

39 ± 10 N-m (4.0 ± 1.0 kg-m, 29 ± 7 ft-lb)

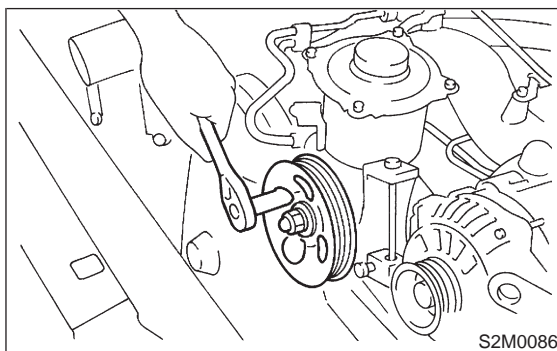

1. Engine

- (2) Install power steering pipe bracket on right side intake manifold, and install spark plug codes.

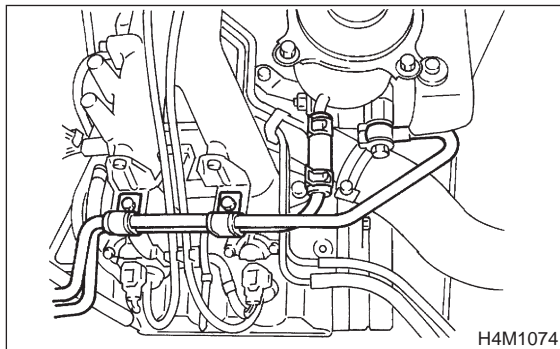

- (3) Install front side V-belt, and adjust it.
<Ref. to 1-5 [G2B0].>

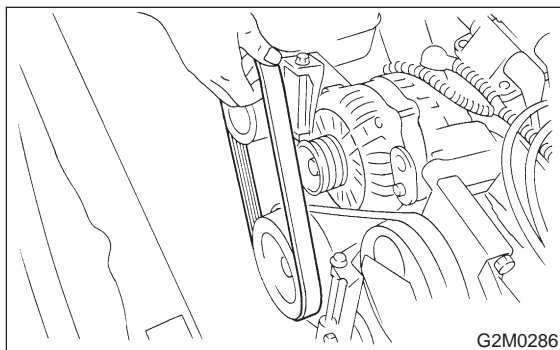

- 8) Tighten nuts which hold lower side of transmission to engine.

Tightening torque:

$50 \pm 4 \text{ N-m}$ ($5.1 \pm 0.4 \text{ kg-m}$, $36.9 \pm 2.9 \text{ ft-lb}$)

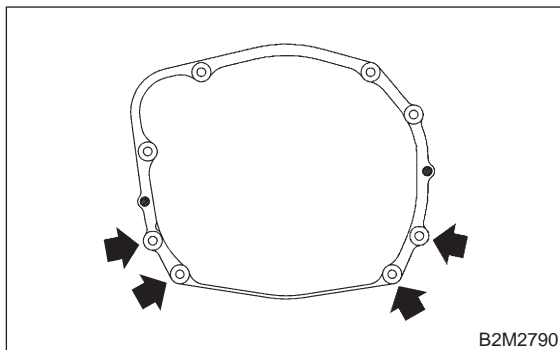

- 9) Tighten nuts which install front cushion rubber onto crossmember.

Tightening torque:

$69 \pm 15 \text{ N-m}$ ($7.0 \pm 1.5 \text{ kg-m}$, $51 \pm 11 \text{ ft-lb}$)

CAUTION:

Be sure to tighten front cushion rubber mounting bolts in the innermost elliptical hole in the front crossmember.

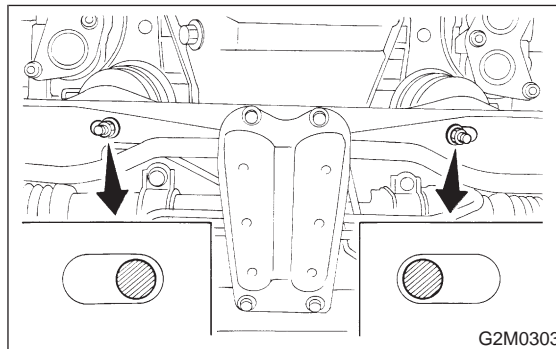

- 10) Install front exhaust pipe and center exhaust pipe. <Ref. to 2-9 [W1B0].>

- 11) Connect rear oxygen sensor connector.

- 12) Connect the following hoses.

- (1) Fuel delivery hose, return hose and evaporation hose
- (2) Heater inlet and outlet hoses
- (3) Brake booster vacuum hose

- 13) Connect the following connectors.

- (1) Engine ground terminal
- (2) Engine harness connectors
- (3) Front oxygen sensor connector
- (4) Alternator connector and terminal
- (5) A/C compressor connectors (With A/C)

- 14) Connect the following cables.

- (1) Accelerator cable
- (2) Clutch cable (2200 cc MT vehicle)
- (3) Clutch release spring (2200 cc MT vehicle)

CAUTION:

After connecting each cable, adjust them.

- 15) Install air intake system.

- (1) Install air cleaner element.
- (2) Install air intake duct with air cleaner upper cover. (Except 2200 cc California spec. vehicles) <Ref. to 2-7 [W1A0].> and <Ref. to 2-7 [W18A0].>
- (3) Install air intake chamber.

- (4) Connect connector to mass air flow sensor.

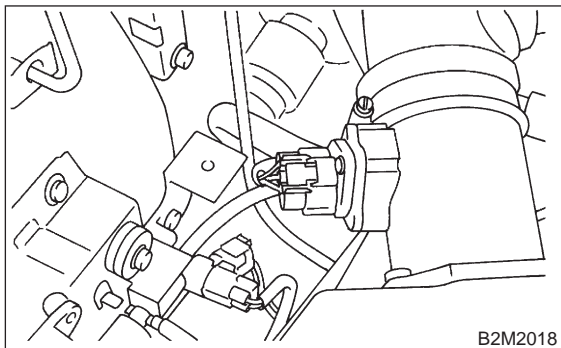

- (5) Install air intake duct with air cleaner case. (2200 cc California spec. vehicles) <Ref. to 2-7 [W1A0].>

- 16) Install A/C flexible hoses. (With A/C) <Ref. to 4-7 [W16A0].>

CAUTION:

Use new O-rings.

Tightening torque:

$25 \pm 7 \text{ N-m}$ ($2.5 \pm 0.7 \text{ kg-m}$, $18.1 \pm 5.1 \text{ ft-lb}$)

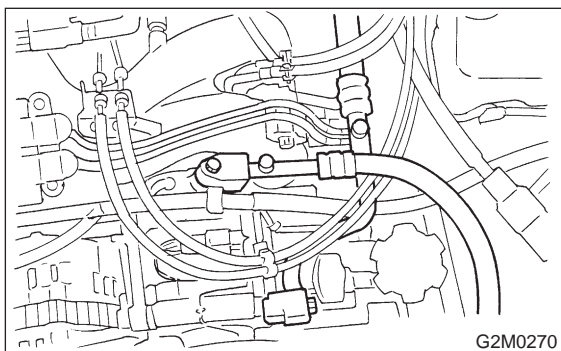

- 17) Install cooling system.

- (1) Attach radiator mounting cushions to pins on lower side of radiator.

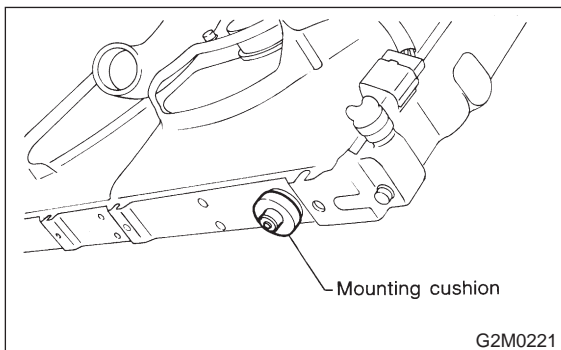

- (2) Fit cushions on lower side of radiator, into holes on body side and install radiator.

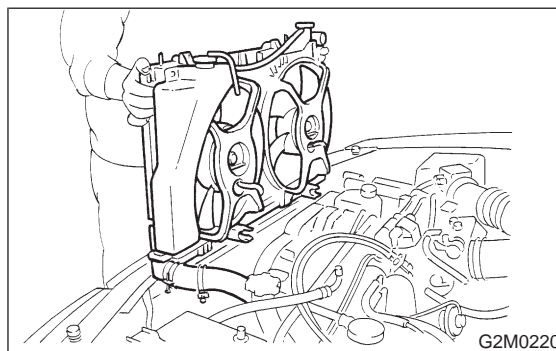

- (3) Install radiator brackets and tighten bolts.

Tightening torque:

$13.7 \pm 1.5 \text{ N-m}$ ($1.4 \pm 0.15 \text{ kg-m}$, $10.1 \pm 1.1 \text{ ft-lb}$)

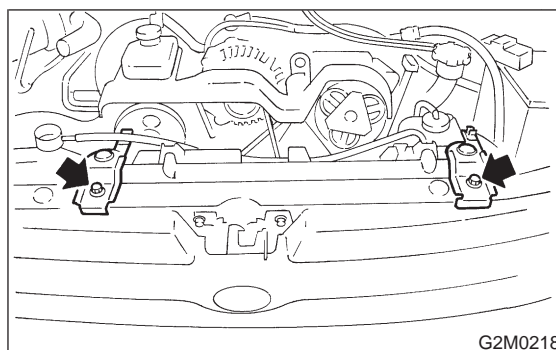

- (4) Connect radiator inlet hose.

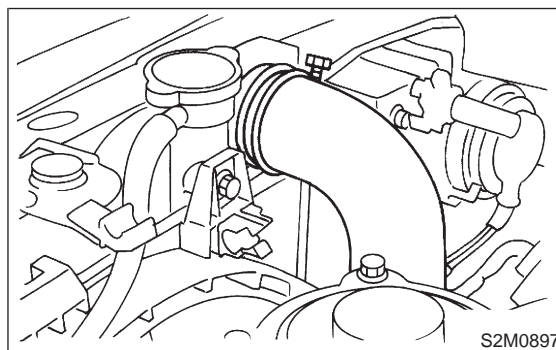

- (5) Connect radiator fan motor connector.

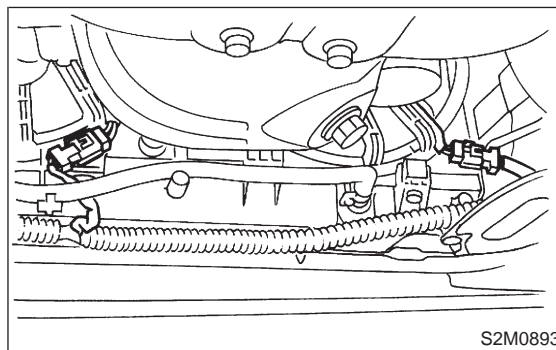

- (6) Connect radiator outlet hose.

- (7) Connect ATF cooler hoses. (AT vehicles)

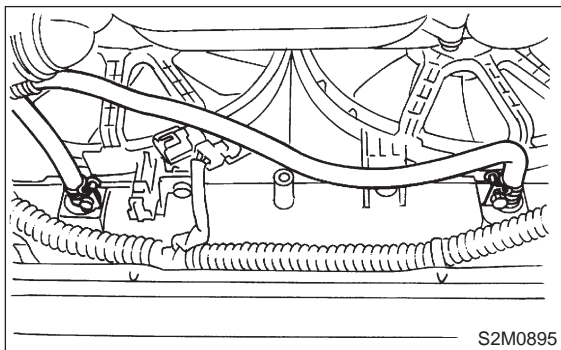

- (8) Install ATF cooler pipe to cylinder head.
(2200 cc AT vehicle)
(9) Install V-belt cover.

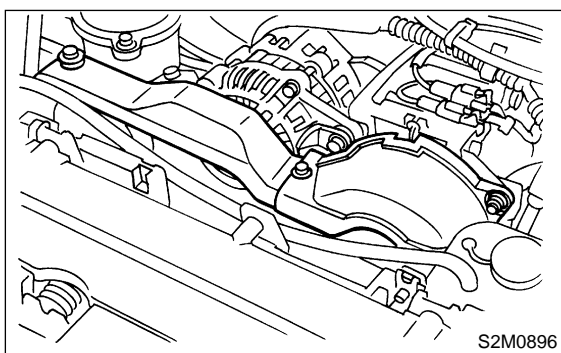

- 18) Install battery in the vehicle, and connect cables.
19) Fill coolant.
<Ref. to 2-5 [W1B0].>

Engine coolant capacity:

5.8 l (6.1 US qt, 5.1 Imp qt)

- 20) Check ATF level and correct if necessary. (AT model)
<Ref. to 3-2 [W1B1].>
21) Charge A/C system with refrigerant.
<Ref. to 4-7 [W700].>
22) Remove front hood stay, and close front hood.
23) Remove the vehicle from lift arms.

2. Transmission

A: GENERAL PRECAUTION

- 1) Remove or install transmission in an area where chain hoists, lifting devices, etc. are available for ready use.
- 2) Be sure not to damage coated surfaces of body panels with tools or stain seats and windows with coolant or oil. Place a cover over fenders, as required, for protection.
- 3) Prior to starting work, prepare the following: Service tools, clean cloth, containers to catch coolant and oil, wire ropes, chain hoist, transmission jacks, etc.
- 4) Lift-up or lower the vehicle when necessary. Make sure to support the correct positions. <Ref. to 1-3 [G7B0].>

B: REMOVAL

- 1) Open front hood fully, and support with stay.
- 2) Disconnect battery ground terminal.
- 3) Remove air intake duct and chamber. (Except 2200 cc California spec. vehicles) <Ref. to 2-7 [W1A0].> and <Ref. to 2-7 [W18A0].>
- 4) Install air intake duct with air cleaner case. (2200 cc California spec. vehicles) <Ref. to 2-7 [W1A0].>
- 5) Remove chamber stay.

● MT vehicles

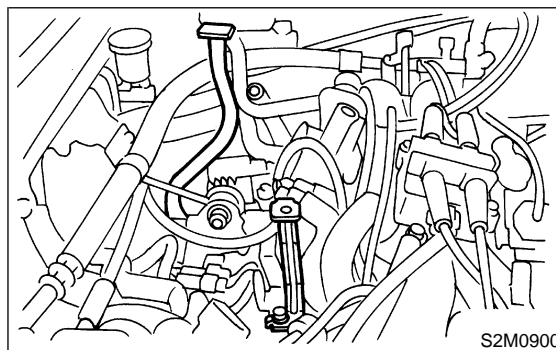

● AT vehicles

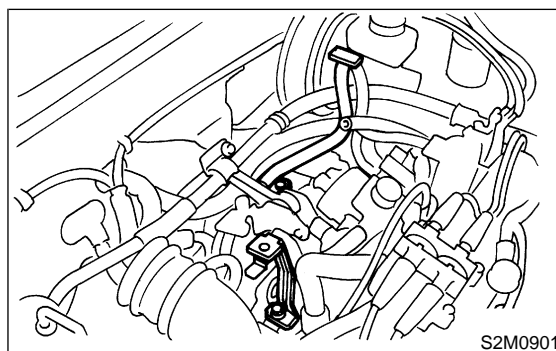

- 6) Disconnect the following connectors.

(1) Front oxygen sensor connector

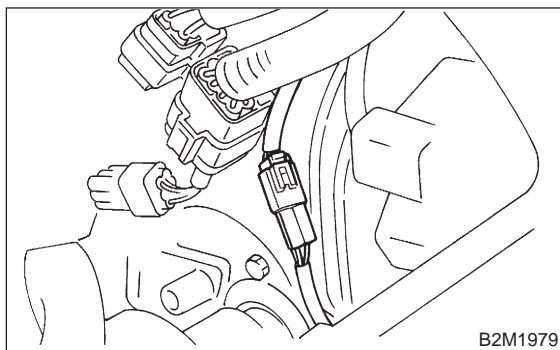

(2) Transmission harness connector (AT vehicles)

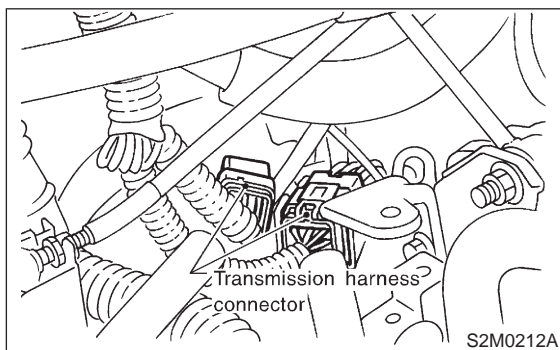

(3) Transmission ground terminal

(4) Neutral position switch connector (MT vehicles)

(5) Back-up light switch connector (MT vehicles)

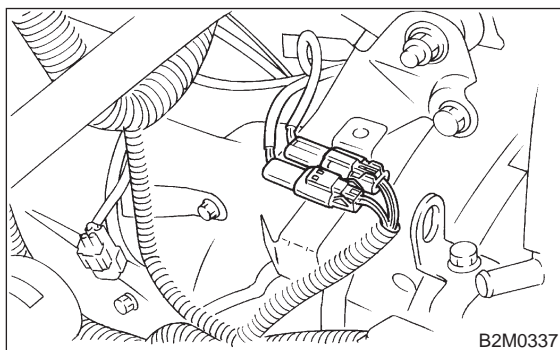

(6) Vehicle speed sensor connector (MT vehicles)

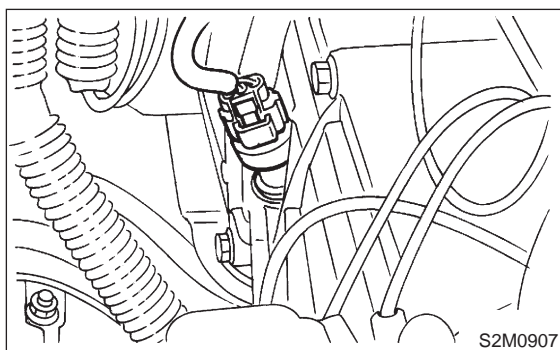

7) Disconnect the following cable. (2200 cc MT vehicle)

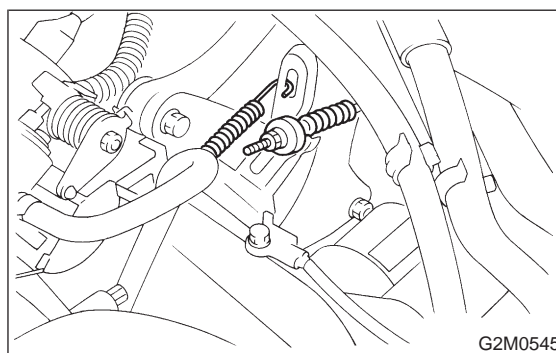

8) Remove starter.

(1) Disconnect connectors and terminal from starter.

(2) Remove bolt which installs upper side of starter.

(3) Remove nut which installs lower side of starter, and remove starter from transmission.

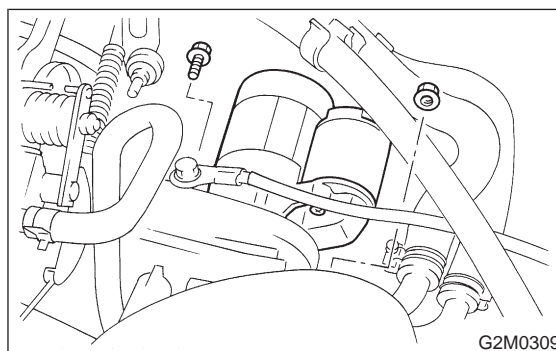

9) Remove pitching stopper.

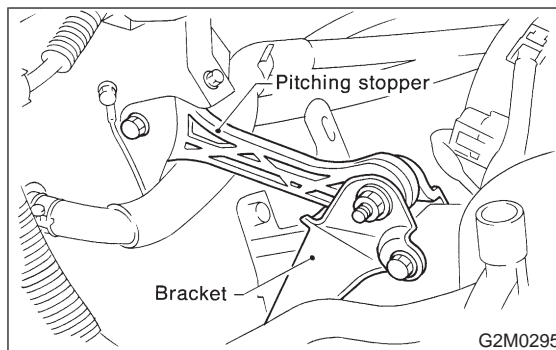

10) Separate torque converter from drive plate. (AT vehicles)

(1) Remove service hole plug.

- (2) Remove bolts which hold torque converter to drive plate.

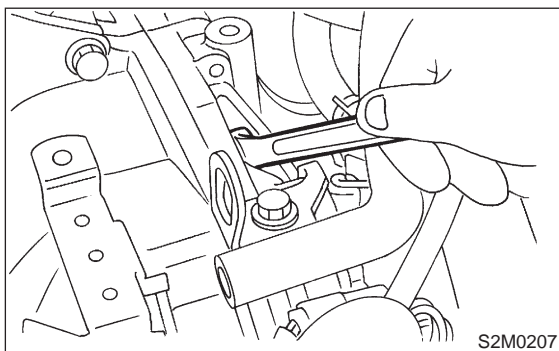

- (3) While rotating the engine, remove other bolts using ST.

2200 cc vehicles:

ST 499977300 CRANK PULLEY WRENCH

2500 cc vehicles:

ST 499977100 CRANK PULLEY WRENCH

CAUTION:

Be careful not to drop bolts into torque converter housing.

- 11) Remove ATF level gauge. (AT vehicles)

CAUTION:

Plug opening to prevent entry of foreign particles into transmission fluid.

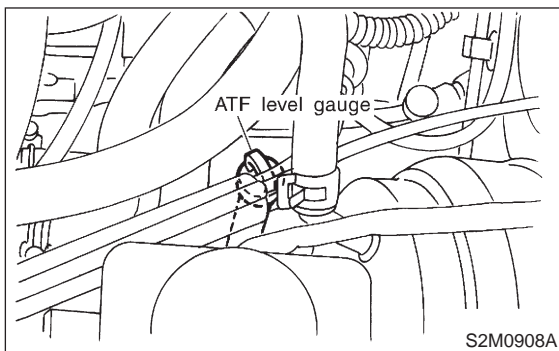

- 12) Remove operating cylinder. (2500 cc MT vehicle)

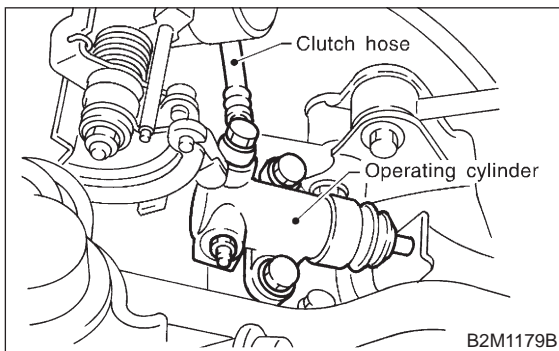

- 13) Set ST.

ST 41099AA020 ENGINE SUPPORT ASSY

NOTE:

Also is available Part No. 927670000.

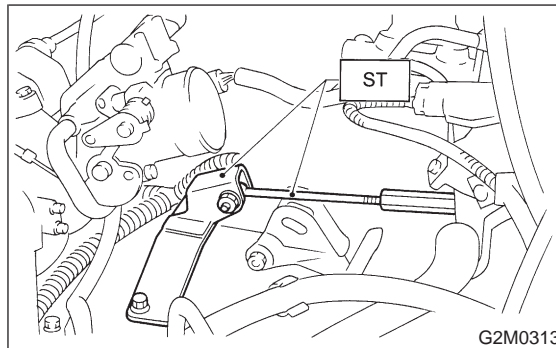

- 14) Remove bolt which holds right upper side of transmission to engine.

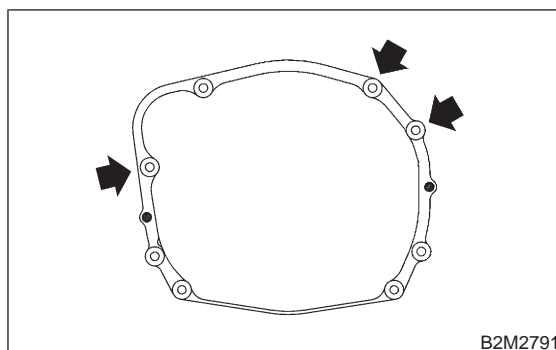

- 15) Remove exhaust system.

(1) Lift-up the vehicle.

(2) Disconnect connector from rear oxygen sensor.

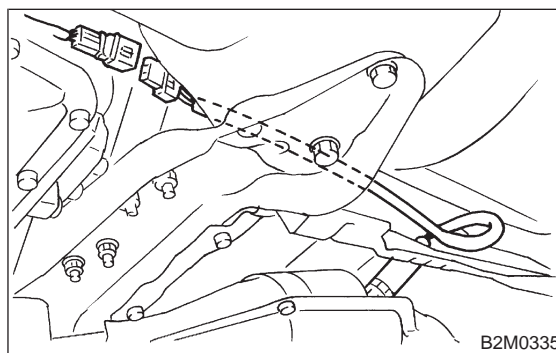

- (3) Remove nuts which install front exhaust pipe onto engine.

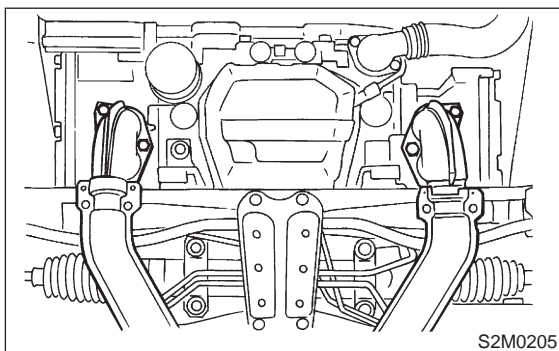

- (4) Separate center exhaust pipe from rear exhaust pipe.

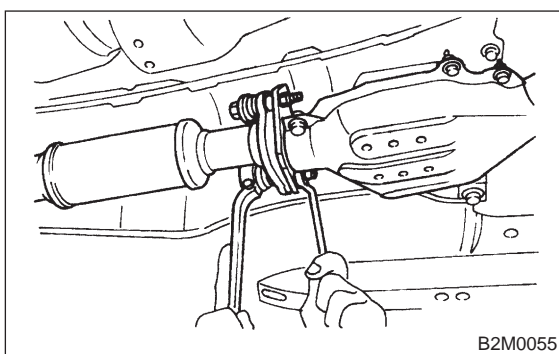

- (5) Remove bolt which installs center exhaust pipe to hanger bracket.

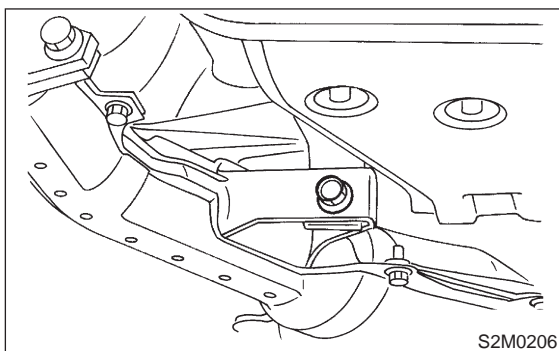

- (6) Take off front and center exhaust pipes.

- (7) Remove rear exhaust pipe.

CAUTION:

When removing exhaust pipes, be careful each exhaust pipe does not drop out.

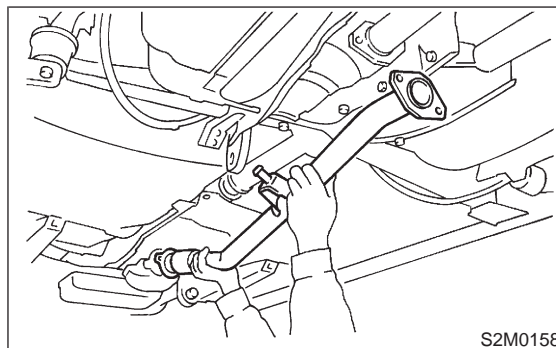

- (8) Remove heat shield cover of rear exhaust pipe.

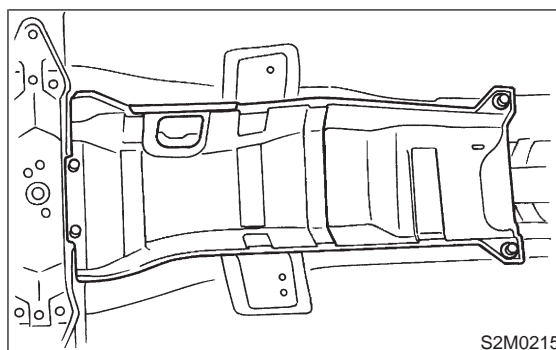

- (9) Remove hanger bracket from right side of transmission.

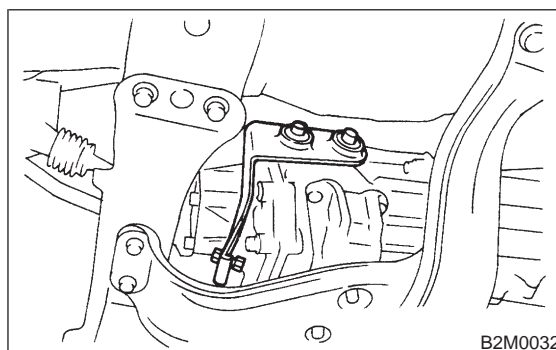

- 16) Drain ATF to remove ATF drain plug. (AT vehicles)

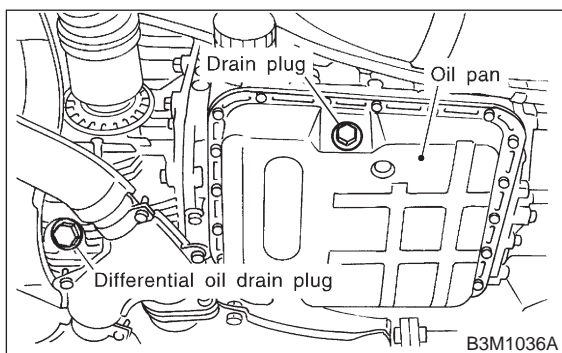

- 17) Disconnect ATF cooler hoses from pipes of transmission side, and remove ATF level gauge guide. (AT vehicles)

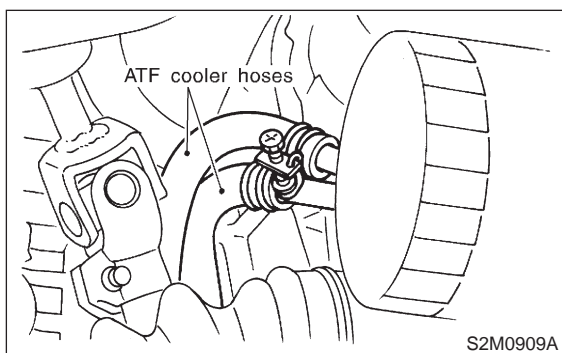

- 18) Remove propeller shaft.
(1) Remove front cover of rear differential mount.
(2) Separate propeller shaft from rear differential.

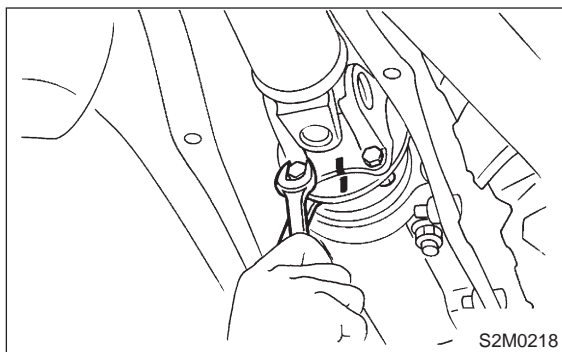

- (3) Remove bolts which hold center bearing onto body.

CAUTION:
Be careful not to drop propeller shaft.

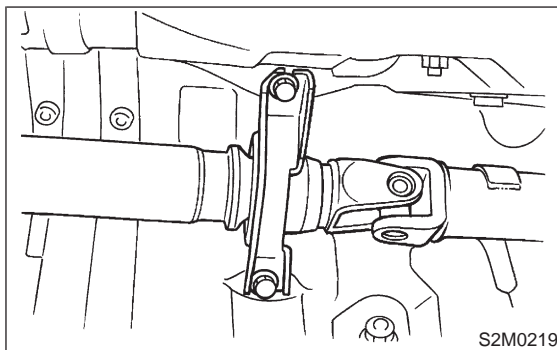

- (4) Remove propeller shaft from transmission.

CAUTION:

- Be sure to use an empty container to catch oil flowing out when removing propeller shaft.
- Be sure not to damage oil seals and the frictional surface of sleeve yoke.
- Be sure to plug the opening in transmission after removal of propeller shaft.

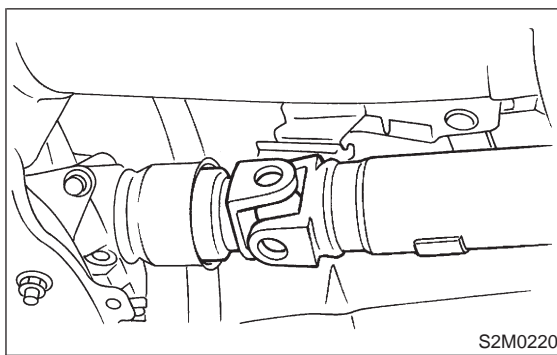

- 19) Remove gear shift rod and stay from transmission. (MT vehicles)
(1) Remove spring.
(2) Disconnect stay from transmission.
(3) Disconnect rod from transmission.

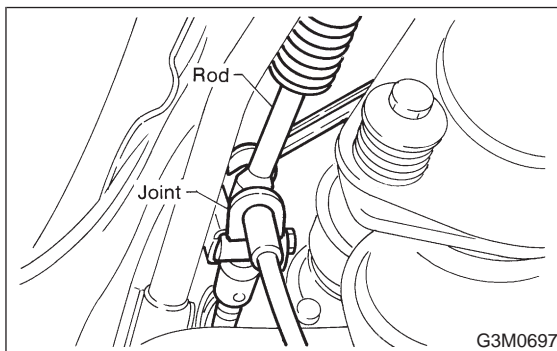

- 20) Remove shift selector cable. (AT vehicles)
(1) Disconnect shift selector cable from selector lever.

- (2) Remove cable bracket from body.

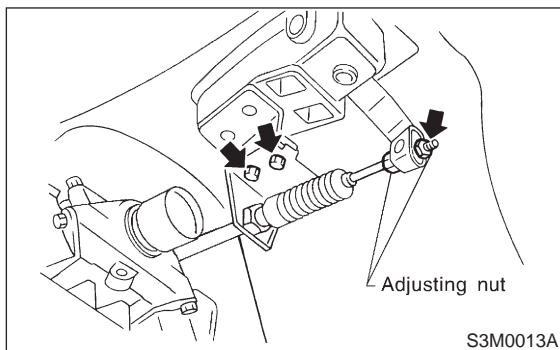

- 21) Remove bolts which install stabilizer clamps onto crossmember.

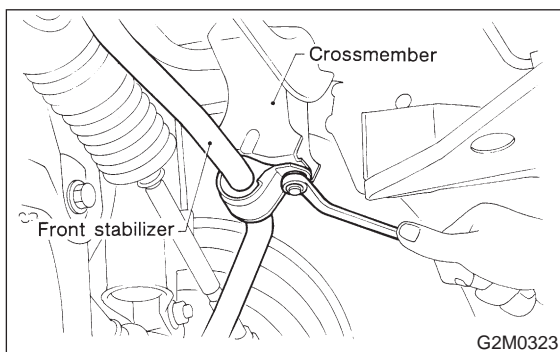

- 22) Remove front drive shafts from transmission.
(1) Remove transverse link from housing.

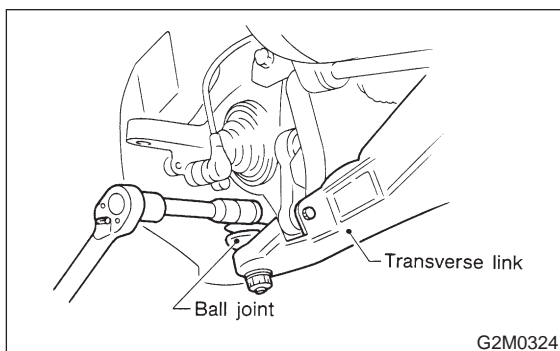

- (2) Lower transverse link.

- (3) Remove spring pins and separate front drive shafts from each side of the transmission.

CAUTION:

Discard removing spring pin. Replace with a new one.

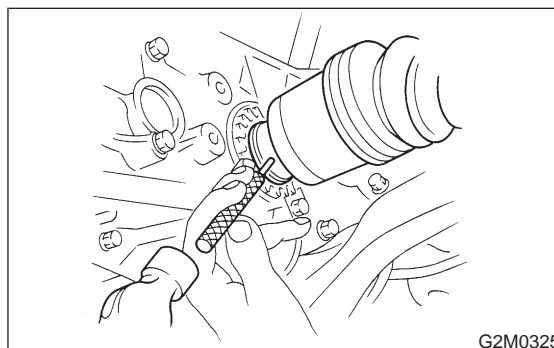

- 23) Remove nuts which hold lower side of transmission to engine.

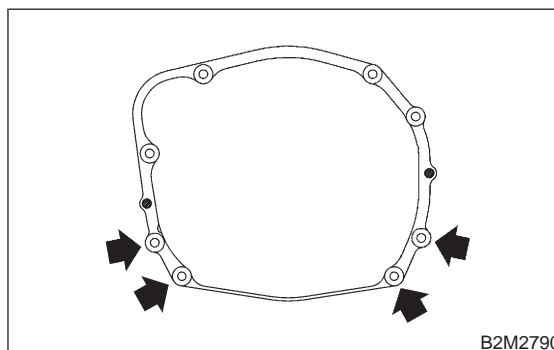

- 24) Place transmission jack under transmission.

CAUTION:

- Always support transmission case with a transmission jack.
- On AT vehicles, make sure that the support plates of transmission jack don't touch the oil pan.

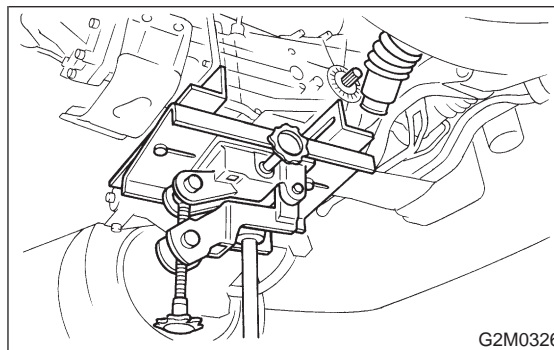

25) Remove transmission rear crossmember.

● **MT vehicles**

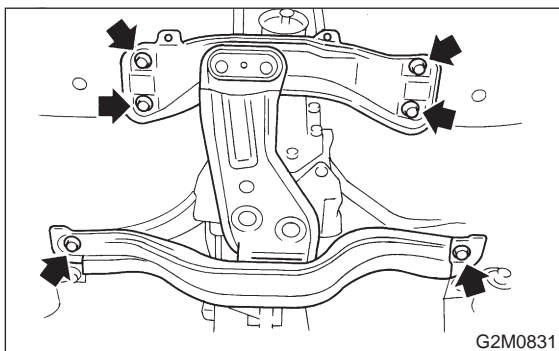

● **AT vehicles**

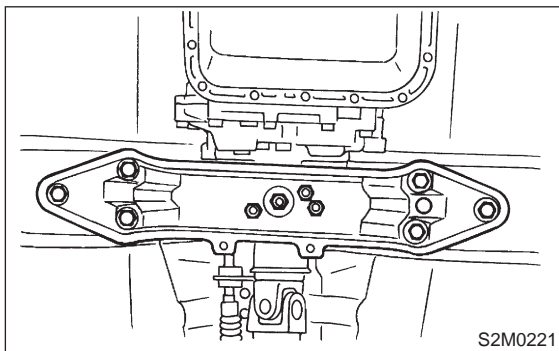

26) Remove transmission.

CAUTION:

- Move transmission jack toward rear until mainshaft is withdrawn from clutch cover. (MT vehicles)
- Move transmission and torque converter as a unit away from engine. (AT vehicles)

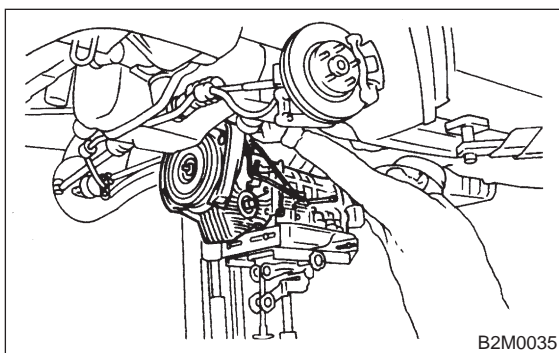

C: INSTALLATION

1) Install ST to torque converter clutch case. (AT vehicles)

ST 498277200 STOPPER SET

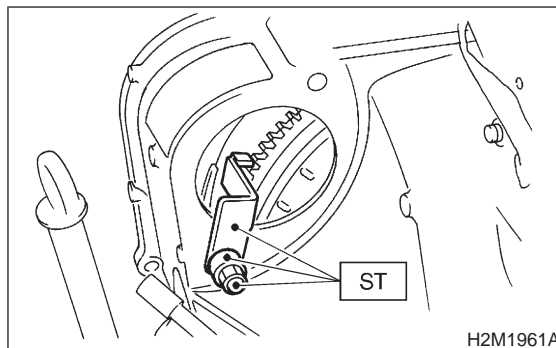

2) Install transmission to engine.

(1) Gradually raise transmission with transmission jack.

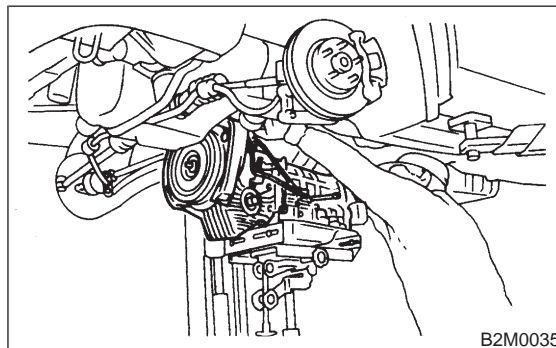

(2) Engage them at splines.

CAUTION:

Be careful not to strike main shaft against clutch cover. (MT vehicles)

3) Install transmission rear crossmember.

● **MT vehicles**

Tightening torque:

T1: 69 ± 15 N·m (7.0 ± 1.5 kg-m, 51 ± 11 ft-lb)

T2: 137 ± 20 N·m (14 ± 2 kg-m, 101 ± 14 ft-lb)

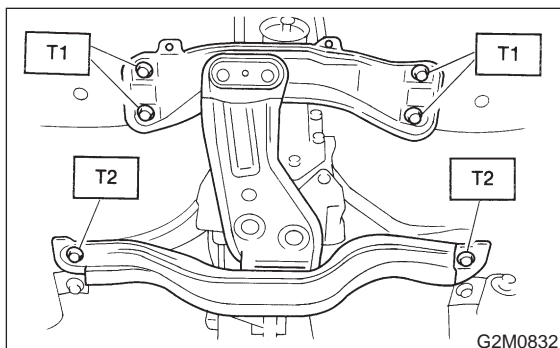

● **AT vehicles**

Tightening torque:

T1: 37 ± 10 N·m (3.8 ± 1.0 kg-m, 27 ± 7 ft-lb)

T2: 69 ± 15 N·m (7.0 ± 1.5 kg-m, 51 ± 11 ft-lb)

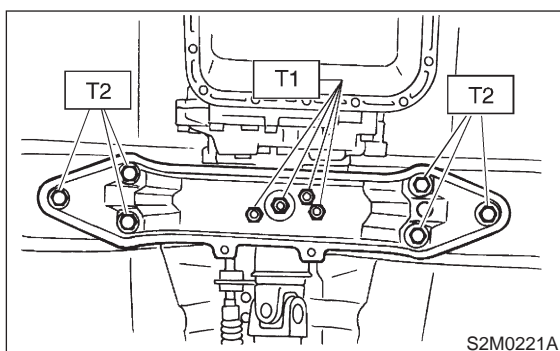

4) Take off transmission jack.

5) Tighten nuts which hold lower side of transmission to engine.

Tightening torque:

50 ± 4 N·m (5.1 ± 0.4 kg-m, 36.9 ± 2.9 ft-lb)

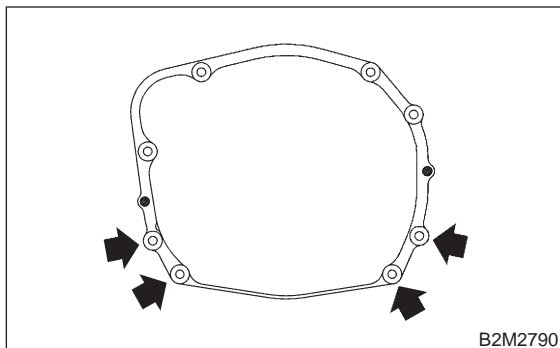

6) Tighten bolt which holds right upper side of transmission to engine.

Tightening torque:

50 ± 4 N·m (5.1 ± 0.4 kg-m, 36.9 ± 2.9 ft-lb)

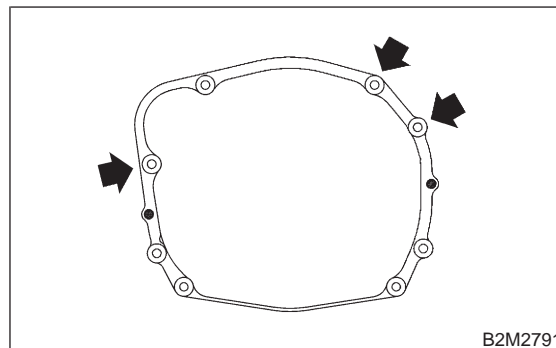

7) Install torque converter to drive plate. (AT vehicles)

(1) Tighten bolts which hold torque converter to drive plate.

(2) Tighten other bolts while rotating the engine by using ST.

2200 cc vehicles:

ST 499977300 CRANK PULLEY WRENCH

2500 cc vehicles:

ST 499977100 CRANK PULLEY WRENCH

CAUTION:

Be careful not to drop bolts into torque converter housing.

Tightening torque:

25 ± 2 N·m (2.5 ± 0.2 kg-m, 18.1 ± 1.4 ft-lb)

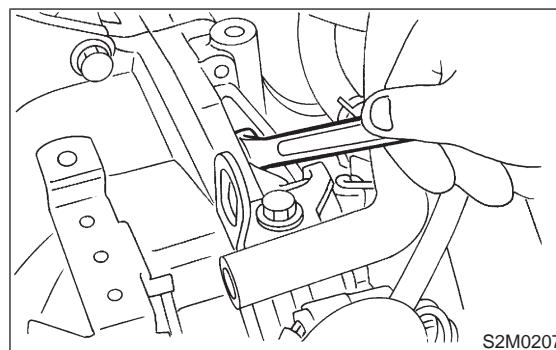

(3) Clog plug onto service hole.

- 8) Install operating cylinder. (2500 cc MT vehicle)

Tightening torque:

37 ± 3 N·m (3.8 ± 0.3 kg-m, 27.5 ± 2.2 ft-lb)

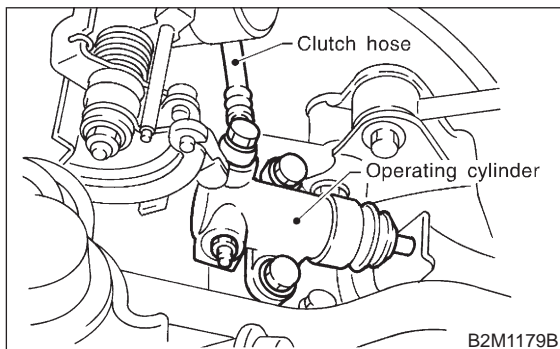

- 9) Remove special tools.

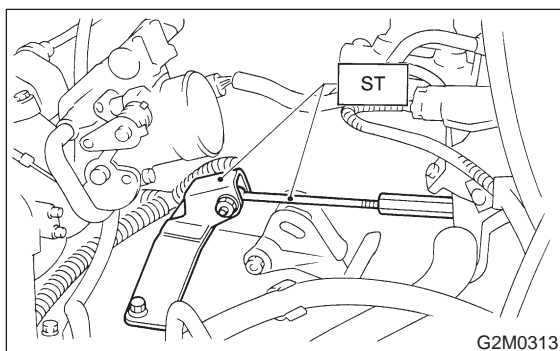

- 10) Install pitching stopper.

Tightening torque:

T1: 57 ± 10 N·m (5.8 ± 1.0 kg-m, 42 ± 7 ft-lb)

T2: 49 ± 5 N·m (5.0 ± 0.5 kg-m, 36.2 ± 3.6 ft-lb)

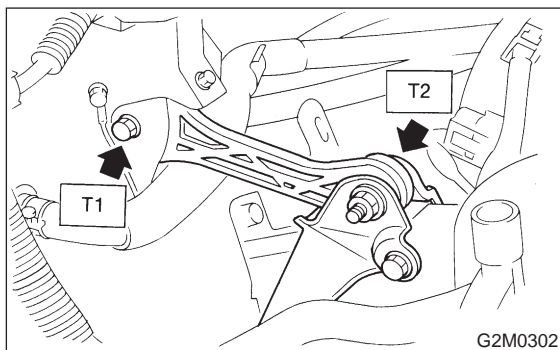

- 11) Install front drive shafts into transmission.

- (1) Lift-up the vehicle.
- (2) Install front drive shaft into transmission.
- (3) Drive spring pin into chamfered hole of drive shaft.

CAUTION:

Always use a new spring pin.

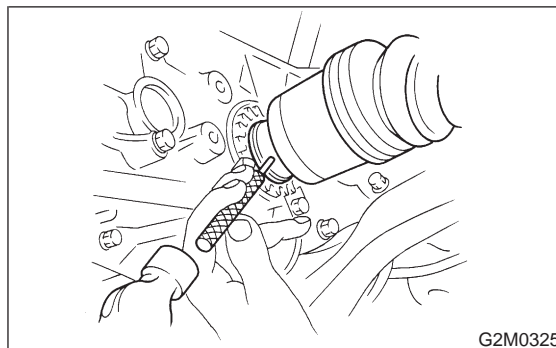

- (4) Install ball joints of lower arm into knuckle arm of housing, and tighten installing bolts.

Tightening torque:

49 ± 10 N·m (5.0 ± 1.0 kg-m, 36 ± 7 ft-lb)

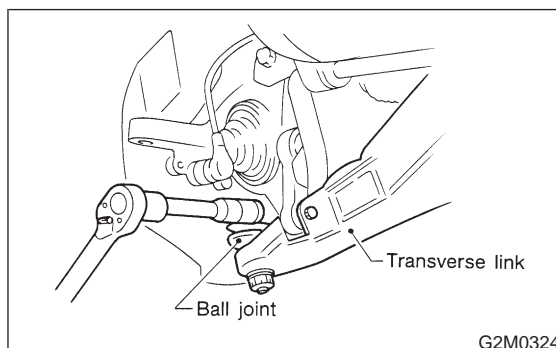

- 12) Install stabilizer clamps onto front crossmember.

Tightening torque:

25 ± 4 N·m (2.5 ± 0.4 kg-m, 18.1 ± 2.9 ft-lb)

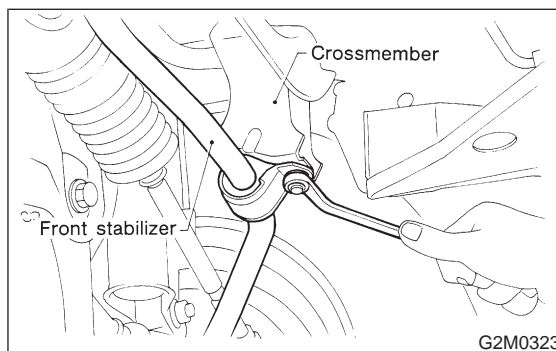

- 13) Install gear shift rod and stay. (MT vehicles)

- (1) Install gear shift rod onto transmission.

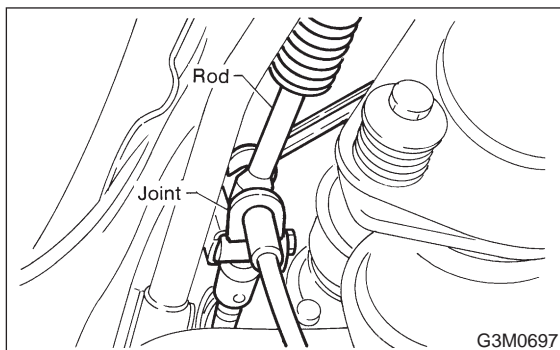

- (2) Install stay onto transmission.

- (3) Install spring.

- 14) Install shift selector cable onto selector lever. (AT vehicles)

- (1) Install selector cable into selector lever.

- (2) Install cable bracket onto body.

NOTE:

Tighten selector cable adjusting and lock nut after checking selector lever operation.

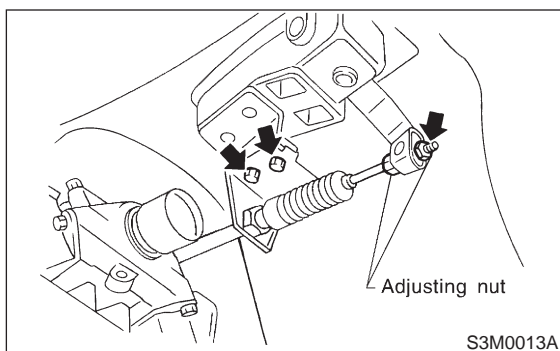

- 15) Install ATF level gauge guide, and ATF cooler hoses onto pipe. (AT vehicles)

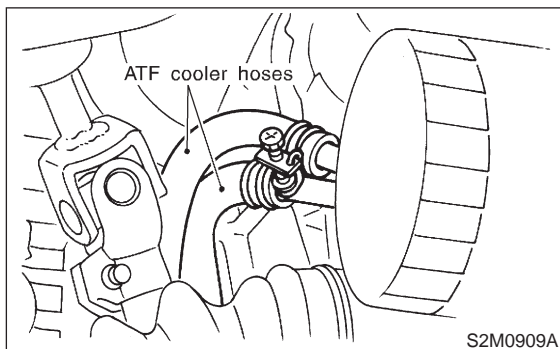

- 16) Install propeller shaft.

- (1) Install propeller shaft into transmission.

- (2) Tighten bolts which install propeller shaft onto companion flange of rear differential.

Tightening torque:

T: 31 ± 8 N·m (3.2 ± 0.8 kg·m, 23.1 ± 5.8 ft·lb)

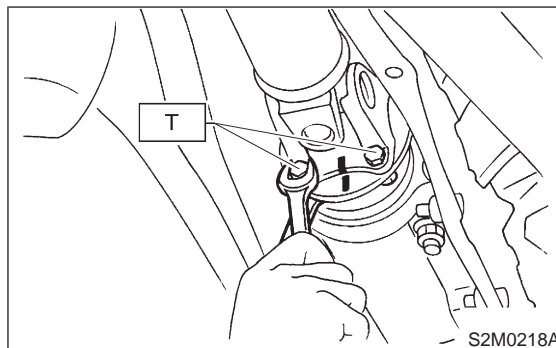

- (3) Install center bearing bracket on body.

Tightening torque:

T: 52 ± 5 N·m (5.3 ± 0.5 kg·m, 38.3 ± 3.6 ft·lb)

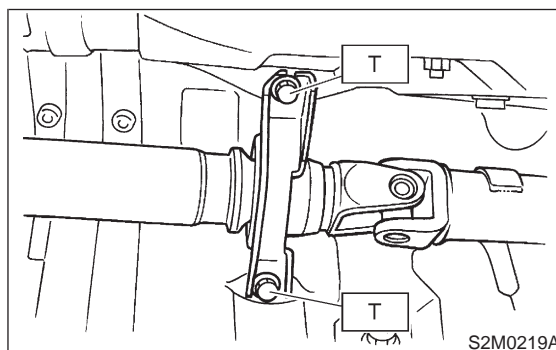

- 17) Install exhaust system.

- (1) Install heat shield cover.

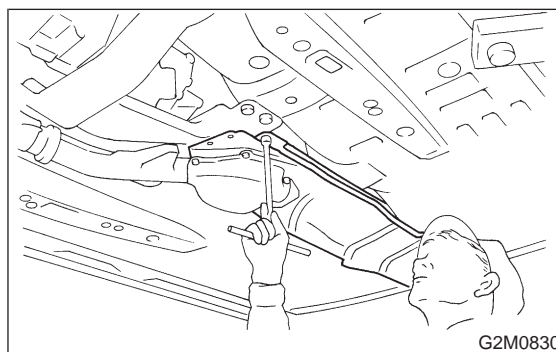

- (2) Install rear exhaust pipe to muffler.

Tightening torque:

48 ± 9 N·m (4.9 ± 0.9 kg-m, 35.4 ± 6.5 ft-lb)

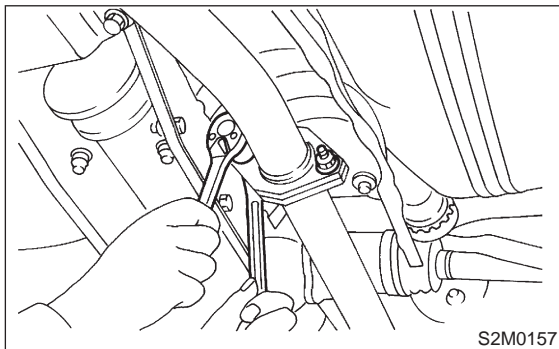

S2M0157

- (3) Install hanger bracket on right side of transmission.

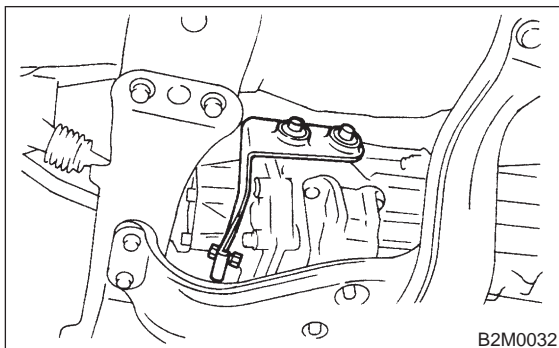

B2M0032

- (4) Install front exhaust pipe onto engine.

Tightening torque:

30 ± 5 N·m (3.1 ± 0.5 kg-m, 22.4 ± 3.6 ft-lb)

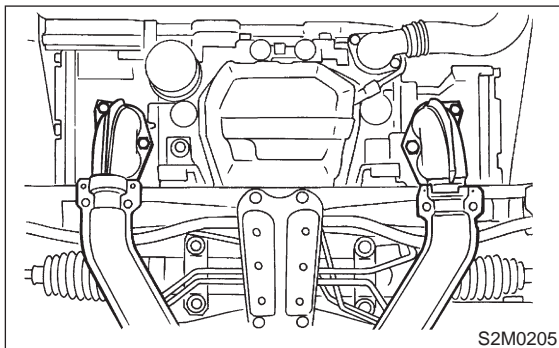

S2M0205

- (5) Install center exhaust pipe to rear exhaust pipe.

Tightening torque:

18 ± 5 N·m (1.8 ± 0.5 kg-m, 13.0 ± 3.6 ft-lb)

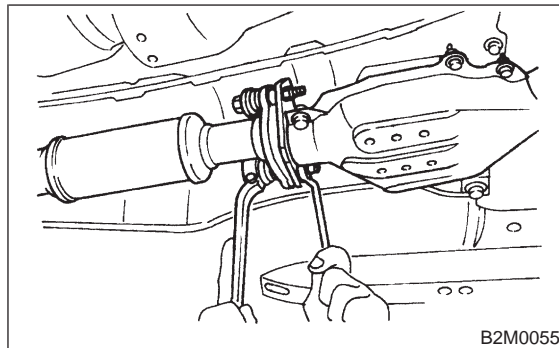

B2M0055

- (6) Tighten bolt which installs center exhaust pipe to hanger bracket.

Tightening torque:

30 ± 5 N·m (3.1 ± 0.5 kg-m, 22.4 ± 3.6 ft-lb)

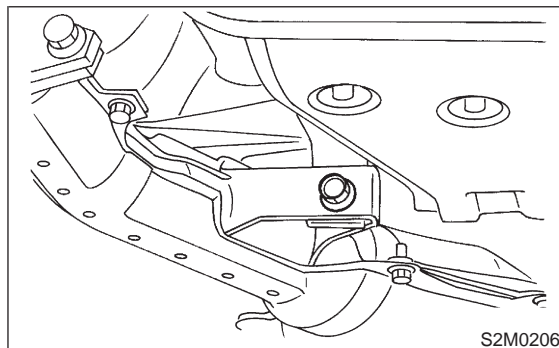

S2M0206

- (7) Connect connector to rear oxygen sensor.

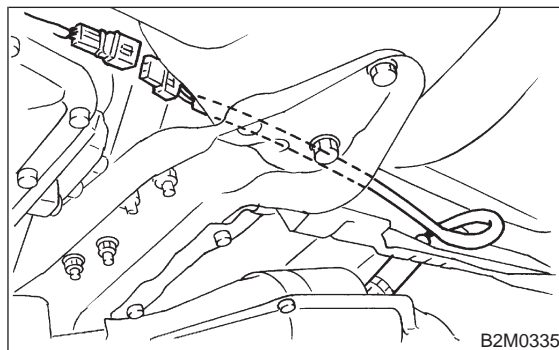

B2M0335

- 18) Install ATF level gauge. (AT vehicles)

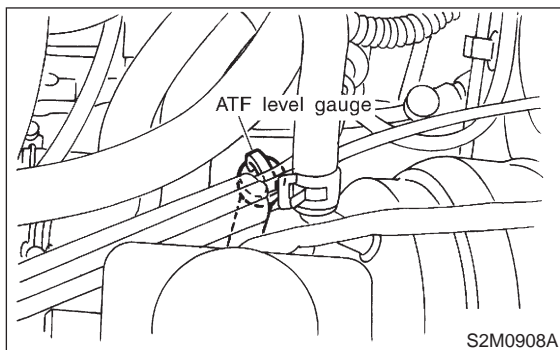

- 19) Connect the following connectors.

- (1) Transmission harness connectors

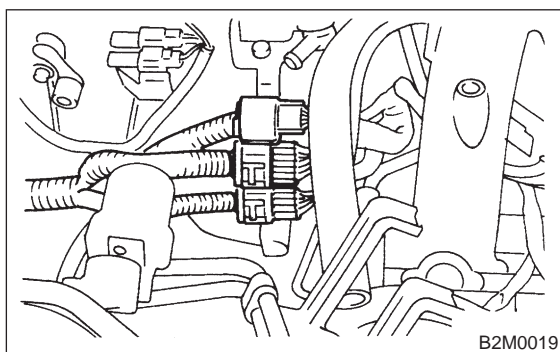

- (2) Transmission ground terminal
(3) Front oxygen sensor connector

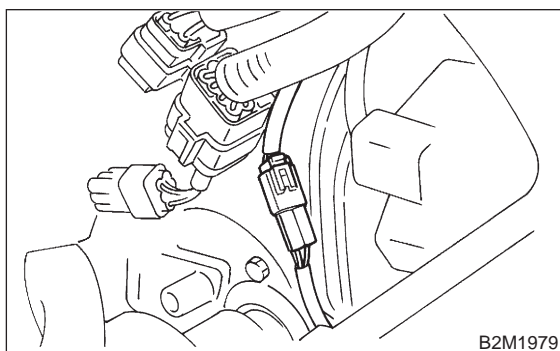

- (4) Vehicle speed sensor connector (MT vehicles)

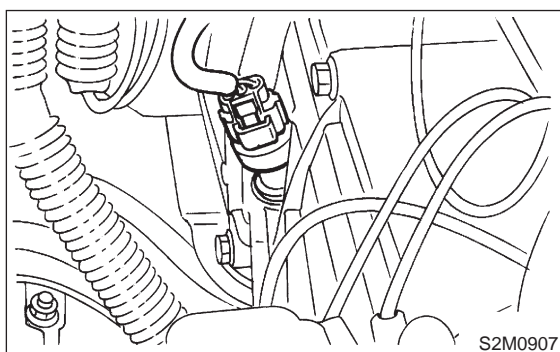

- (5) Neutral position and back-up light switch connector (MT vehicles)

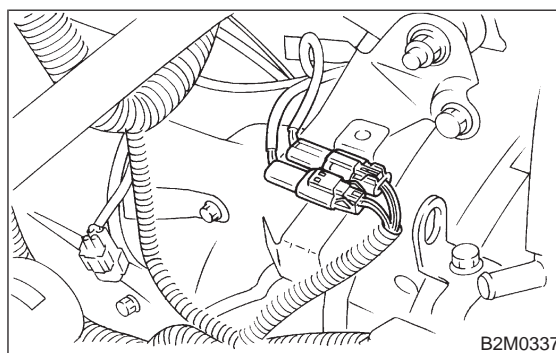

- 20) Install starter.

- (1) Install starter onto transmission case, and connect connectors and terminals.
(2) Tighten bolt and nut which install starter onto transmission.

Tightening torque:

50 ± 4 N·m (5.1 ± 0.4 kg-m, 36.9 ± 2.9 ft-lb)

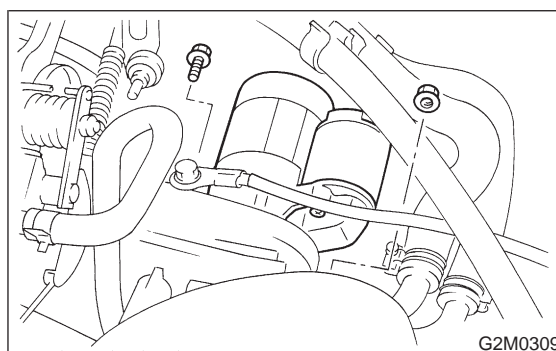

21) Install chamber stay.

● **MT vehicles**

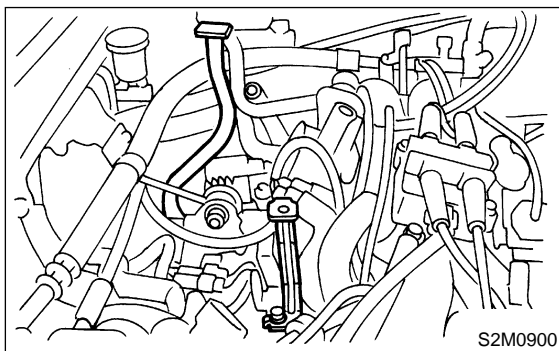

● **AT vehicles**

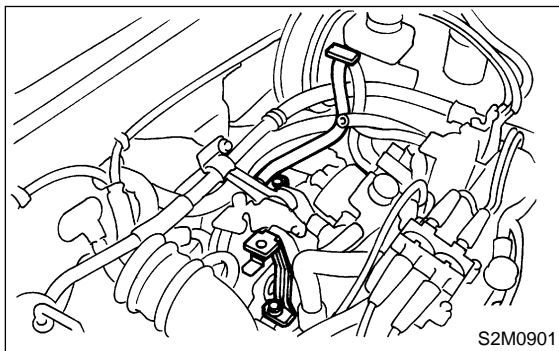

22) Install air intake duct and chamber. (Except 2200 cc California spec. vehicles) <Ref. to 2-7 [W1A0].> and <Ref. to 2-7 [W18A0].>

23) Install air intake duct with air cleaner case. (2200 cc California spec. vehicles) <Ref. to 2-7 [W1A0].>

24) Connect battery ground cable.

25) Fill ATF and differential gear oil. (AT vehicles) <Ref. to 3-2 [S1A0].>

26) Check selector lever operation. (AT vehicles) <Ref. to 3-2 [T2C0].>

27) Take off vehicle from lift arms.

28) Check the vehicle on road tester. (AT vehicles) <Ref. to 3-2 [W6A0].>