

EXHAUST SYSTEM 2-9

	Page
C COMPONENT PARTS	2
1. Exhaust System	2
W SERVICE PROCEDURE	3
1. Front Exhaust Pipe and Center Exhaust Pipe	3
2. Rear Exhaust Pipe.....	5
3. Muffler	6

1. Exhaust System

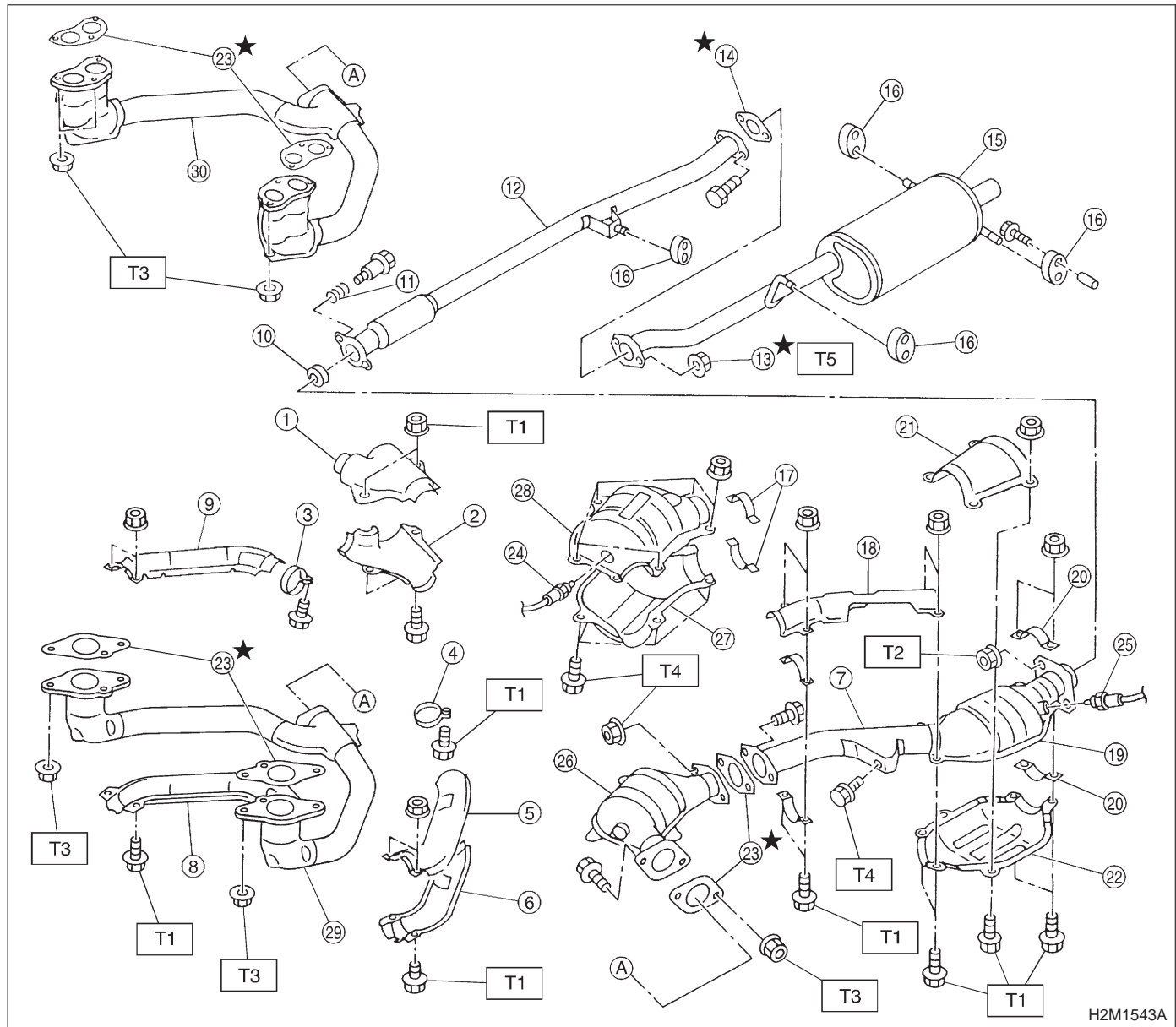

H2M1543A

- ① Upper front exhaust pipe cover CTR
- ② Lower front exhaust pipe cover CTR
- ③ Band RH
- ④ Band LH
- ⑤ Upper front exhaust pipe cover LH
- ⑥ Lower front exhaust pipe cover LH
- ⑦ Center exhaust pipe
- ⑧ Lower front exhaust pipe cover RH
- ⑨ Upper front exhaust pipe cover RH
- ⑩ Gasket
- ⑪ Spring
- ⑫ Rear exhaust pipe
- ⑬ Self-locking nut

- ⑭ Gasket
- ⑮ Muffler
- ⑯ Cushion rubber
- ⑰ Clamp
- ⑱ Upper center exhaust pipe cover
- ⑲ Rear catalytic converter
- ⑳ Clamp B
- ㉑ Upper rear catalytic converter cover
- ㉒ Lower rear catalytic converter cover
- ㉓ Gasket
- ㉔ Front oxygen sensor
- ㉕ Rear oxygen sensor
- ㉖ Front catalytic converter

- ㉗ Lower front catalytic converter cover
- ㉘ Upper front catalytic converter cover
- ㉙ Front exhaust pipe (2200 cc)
- ㉚ Front exhaust pipe (1800 cc)

Tightening torque: N·m (kg-m, ft-lb)**T1: 13±3 (1.3±0.3, 9.4±2.2)****T2: 18±5 (1.8±0.5, 13.0±3.6)****T3: 30±5 (3.1±0.5, 22.4±3.6)****T4: 35±5 (3.6±0.5, 26.0±3.6)****T5: 48±5 (4.9±0.5, 35.4±3.6)**

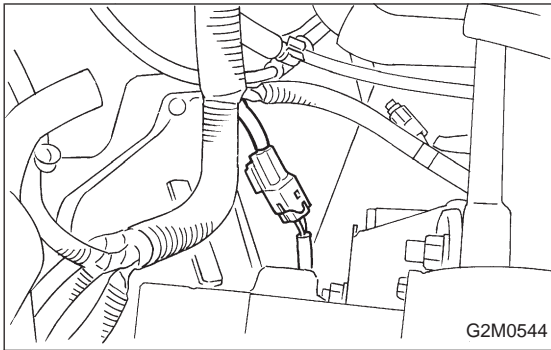

1. Front Exhaust Pipe and Center Exhaust Pipe

A: REMOVAL

1) Disconnect front oxygen sensor connector.

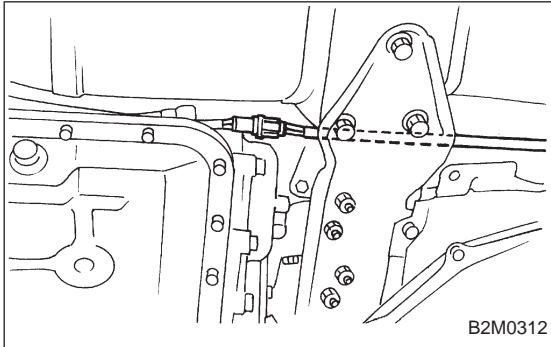

2) Lift-up the vehicle.

3) Disconnect rear oxygen sensor connector.

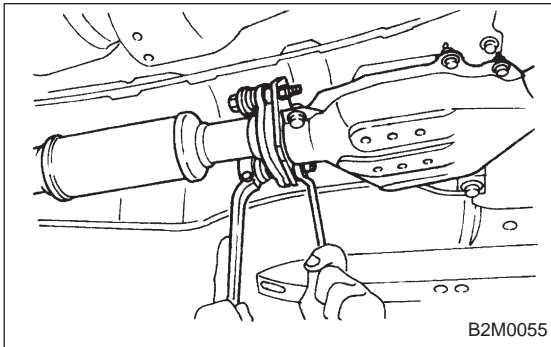

4) Separate center exhaust pipe from rear exhaust pipe.

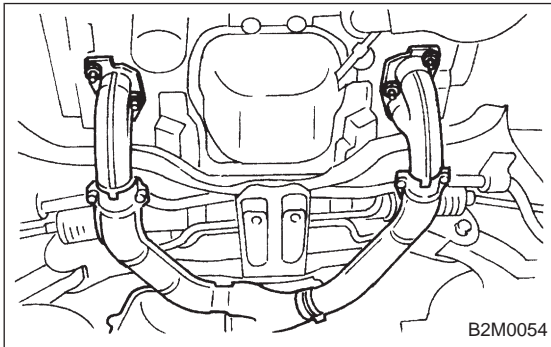

5) Remove bolts which hold front exhaust pipe onto cylinder heads.

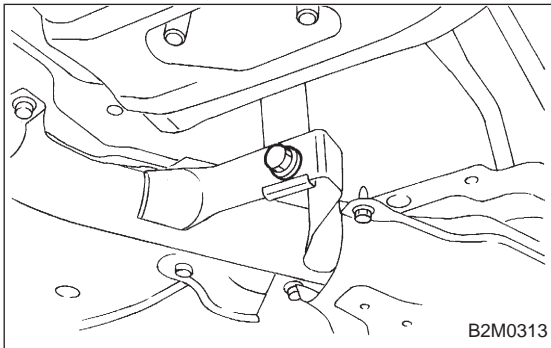

6) Remove front exhaust pipe and center exhaust pipe from hanger bracket.

CAUTION:

Be careful not to pull down front exhaust pipe and center exhaust pipe.

1. Front Exhaust Pipe and Center Exhaust Pipe

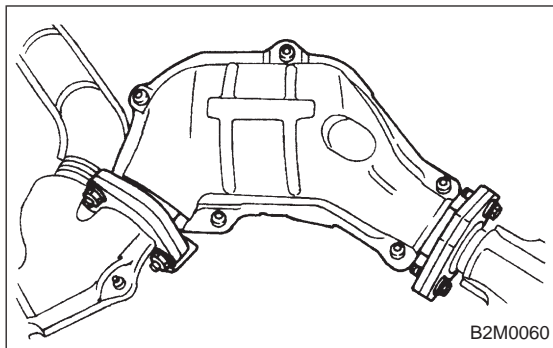

7) Separate front exhaust pipe from front catalytic converter.

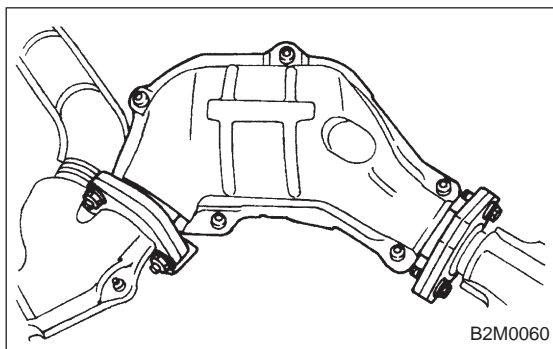
**B: INSTALLATION****CAUTION:**

Replace gaskets with new ones.

1) Install front catalytic converter to front exhaust pipe.

Tightening torque:

$30 \pm 5 \text{ N}\cdot\text{m}$ ($3.1 \pm 0.5 \text{ kg}\cdot\text{m}$, $22.4 \pm 3.6 \text{ ft}\cdot\text{lb}$)

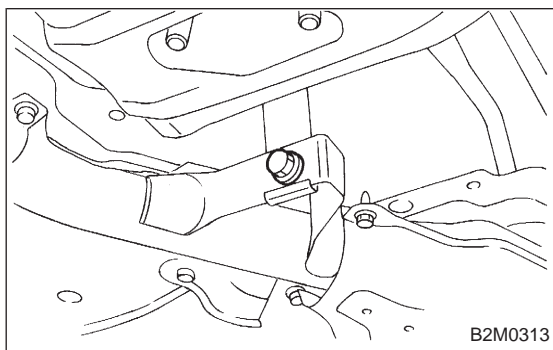

2) Install front exhaust pipe and center exhaust pipe. And temporarily tighten bolt which installs center exhaust pipe to hanger bracket.

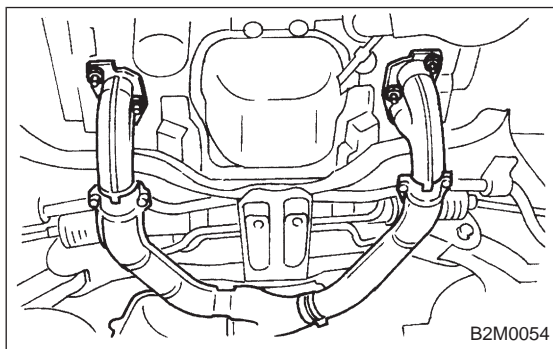

3) Tighten bolts which hold front exhaust pipe onto cylinder heads.

Tightening torque:

$30 \pm 5 \text{ N}\cdot\text{m}$ ($3.1 \pm 0.5 \text{ kg}\cdot\text{m}$, $22.4 \pm 3.6 \text{ ft}\cdot\text{lb}$)

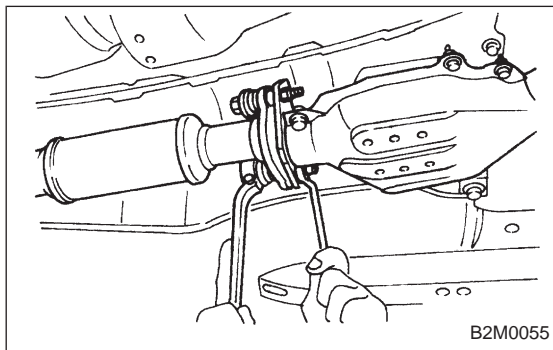

4) Install center exhaust pipe to rear exhaust pipe.

Tightening torque:

$18 \pm 5 \text{ N}\cdot\text{m}$ ($1.8 \pm 0.5 \text{ kg}\cdot\text{m}$, $13.0 \pm 3.6 \text{ ft}\cdot\text{lb}$)

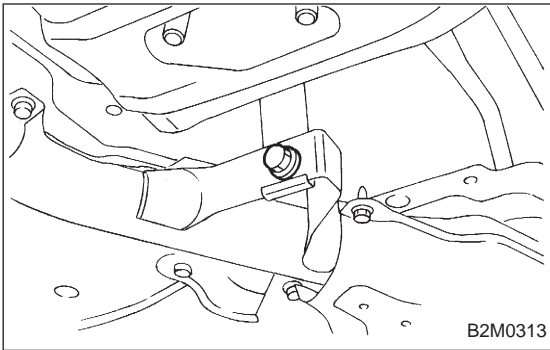

5) Tighten bolt which holds center exhaust pipe to hanger bracket.

Tightening torque:

35 ± 5 N·m (3.6 ± 0.5 kg-m, 26.0 ± 3.6 ft-lb)

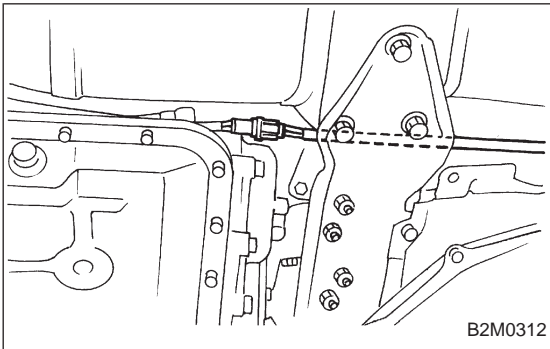

6) Connect rear oxygen sensor connector.

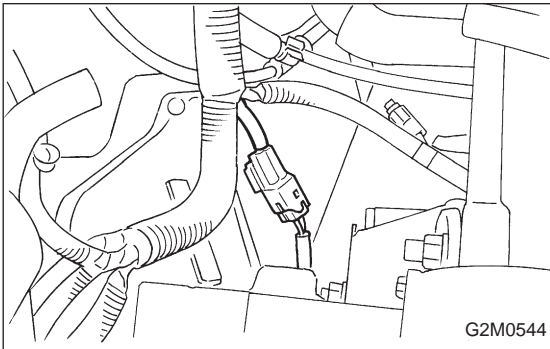

7) Lower the vehicle.

8) Connect front oxygen sensor connector.

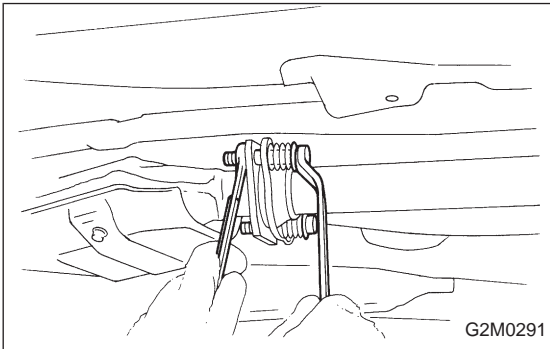

2. Rear Exhaust Pipe

A: REMOVAL

1) Separate rear exhaust pipe from front catalytic converter.

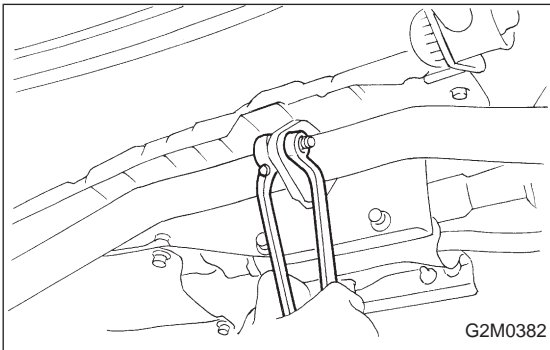

2) Separate rear exhaust pipe from muffler.

CAUTION:

Be careful not to pull down front exhaust pipe and front catalytic converter.

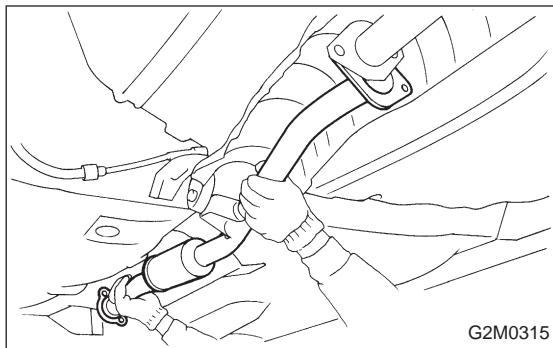

G2M0315

3) Remove rear exhaust pipe bracket from rubber cushion.

NOTE:

To facilitate removal, apply a coat of SUBARU CRC to pipe bracket in advance.

SUBARU CRC (Part No. 004301003)

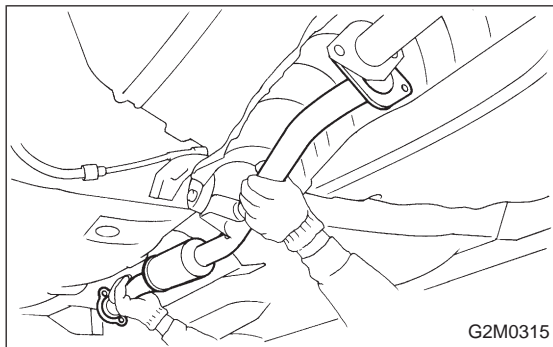

G2M0315

B: INSTALLATION

CAUTION:

Replace gaskets with new ones.

1) Install rear exhaust pipe bracket to rubber cushion.

NOTE:

To facilitate installation, apply a coat of SUBARU CRC to mating area of rubber cushion in advance.

SUBARU CRC (Part No. 004301003)

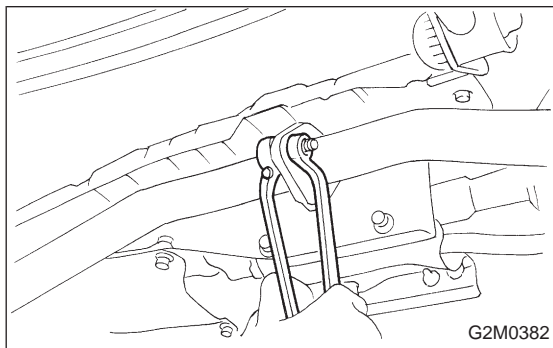

G2M0382

2) Install rear exhaust pipe to muffler.

Tightening torque:

48±5 N·m (4.9±0.5 kg-m, 35.4±3.6 ft-lb)

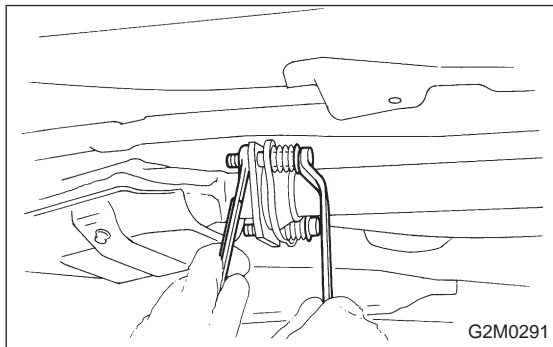

G2M0291

3) Install rear exhaust pipe to front catalytic converter.

Tightening torque:

18±5 N·m (1.8±0.5 kg-m, 13.0±3.6 ft-lb)

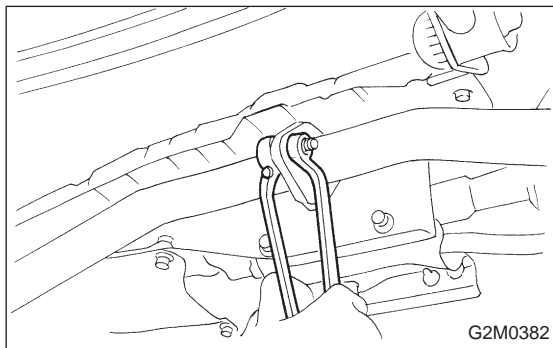

G2M0382

3. Muffler

A: REMOVAL AND INSTALLATION

1) Separate muffler from rear exhaust pipe.

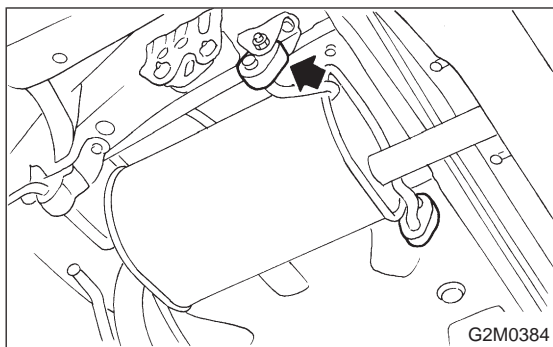

2) Remove left and right rubber cushions.

CAUTION:

Be careful not to pull down front exhaust pipe and front catalytic converter.

NOTE:

To facilitate removal, apply a coat of SUBARU CRC to mating area of rubber cushions in advance.

SUBARU CRC (Part No. 004301003)

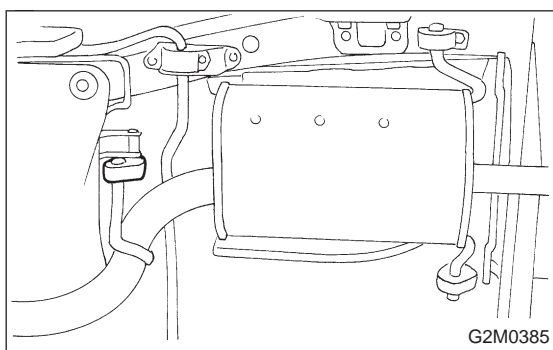

3) Remove front rubber cushion, and detach muffler assembly.

NOTE:

To facilitate removal, apply a coat of SUBARU CRC to mating area of rubber cushion in advance.

SUBARU CRC (Part No. 004301003)

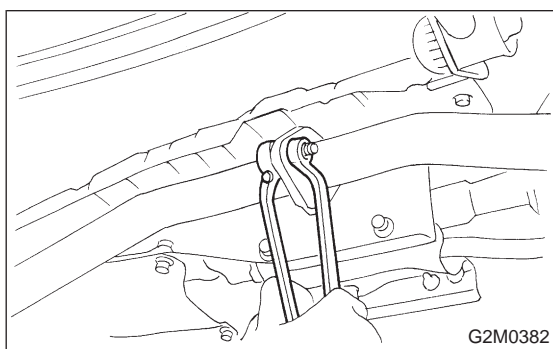

4) Installation is in the reverse order of removal.

CAUTION:

Replace gasket with a new one.

Tightening torque:

$48 \pm 5 \text{ N} \cdot \text{m}$ ($4.9 \pm 0.5 \text{ kg} \cdot \text{m}$, $35.4 \pm 3.6 \text{ ft} \cdot \text{lb}$)