

INSTRUMENT PANEL *5-4*

	Page
C COMPONENT PARTS	2
1. Instrument Panel.....	2
W SERVICE PROCEDURE	3
1. Instrument Panel AIRBAG	3

1. Instrument Panel

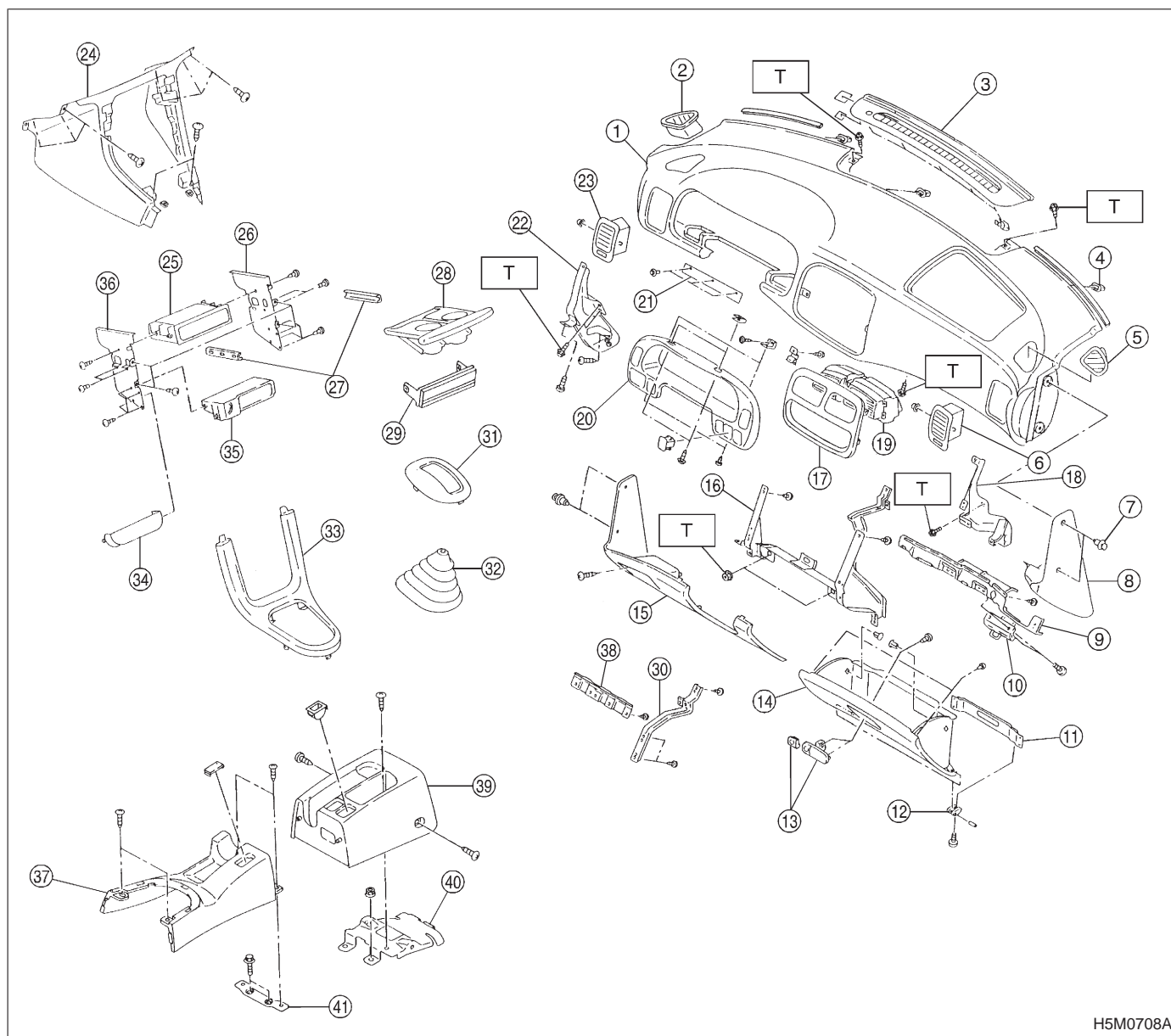

H5M0708A

- | | | |
|----------------------|-----------------------------|------------------------|
| ① Pad & frame | ①⑥ Reinf. CTR | ③① Panel (AT) ASSY |
| ② Grille SD def. (D) | ①⑦ Panel CTR (A) | ③② Shift boot |
| ③ Front def. grille | ①⑧ Reinf. (P) | ③③ Console cover |
| ④ Grommet | ①⑨ Grille CTR def. | ③④ Panel (Airbag) |
| ⑤ Grille SD def. (P) | ②⑦ Meter visor | ③⑤ Housing (Ash tray) |
| ⑥ Grille vent (P) | ②⑧ Cover | ③⑥ BRKT (Radio) LH |
| ⑦ Clip | ②⑨ Reinf. (D) | ③⑦ Center console |
| ⑧ SD panel (P) | ②⑩ Grille vent (D) | ③⑧ Reinf. airbag UPPER |
| ⑨ Reinf. airbag CTR | ②⑪ Instrument panel console | ③⑨ Rear console box |
| ⑩ Striker | ②⑫ Pocket CTR | ④① Rear console BRKT |
| ⑪ Frame pocket | ②⑬ BRKT (Radio) RH | ④② Center console BRKT |
| ⑫ Hinge | ②⑭ Rail (Cup holder) | |
| ⑬ Lock ASSY | ②⑮ Cup holder | |
| ⑭ Pocket ASSY | ②⑯ Panel (Radio) | |
| ⑮ Lower cover ASSY | ③① Reinf. airbag B | |

Tightening torque: N·m (kg·m, ft·lb)
T: 7±1 (0.7±0.1, 5.1±0.7)

1. Instrument Panel **AIRBAG**

A: REMOVAL

Airbag system wiring harness is routed near combination meter.

CAUTION:

- All Airbag system wiring harness and connectors are colored yellow. Do not use electrical test equipment on these circuits.
- Be careful not to damage Airbag system wiring harness when servicing the combination meter.

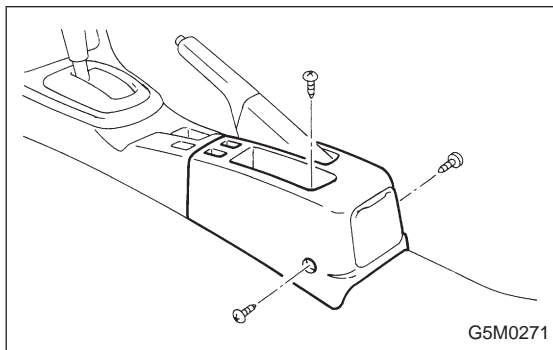

- 1) Disconnect GND cable from battery.
- 2) Remove rear console box.

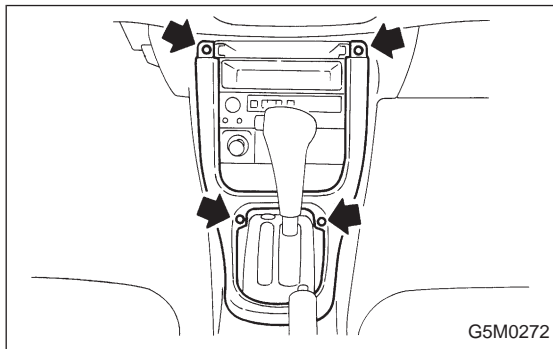

- 3) Pull cup holder.
- 4) Turn over shift lever boot of front end (MT model). Remove select lever cover (AT model).
- 5) Remove console cover.

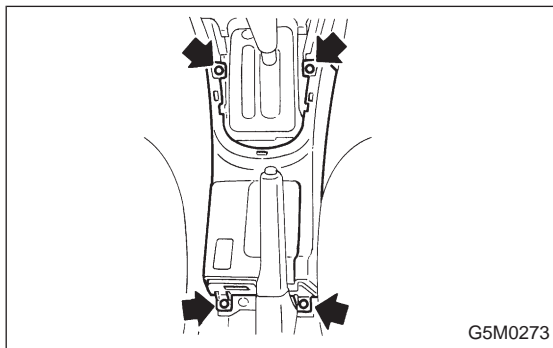

- 6) Remove center console.

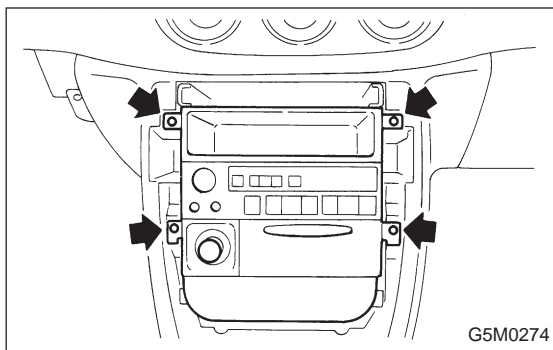

7) Remove audio assembly and then disconnect radio antenna feeder and connectors.

CAUTION:

Be sure to hold socket section and not harness when disconnecting.

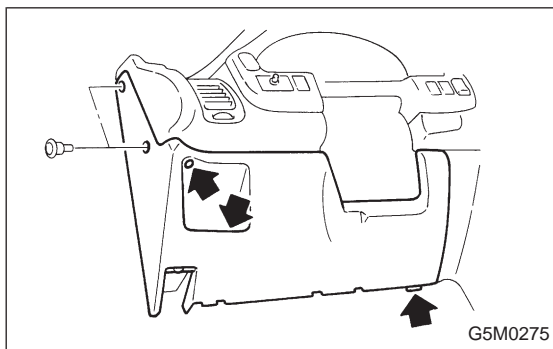

8) Remove lower cover and then disconnect connector.

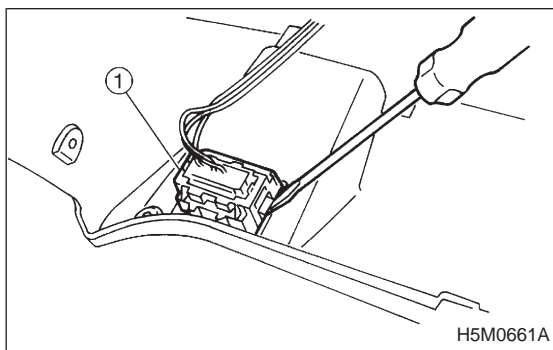

9) Disconnect data link connector ① from lower cover.

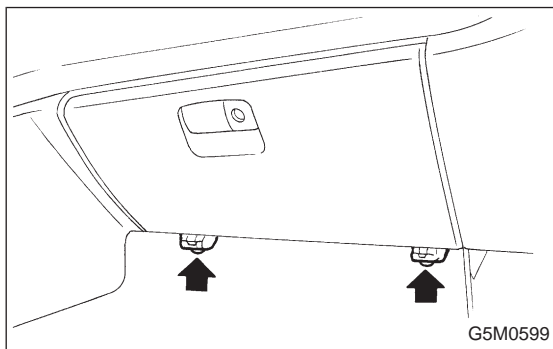

10) Remove glove box.

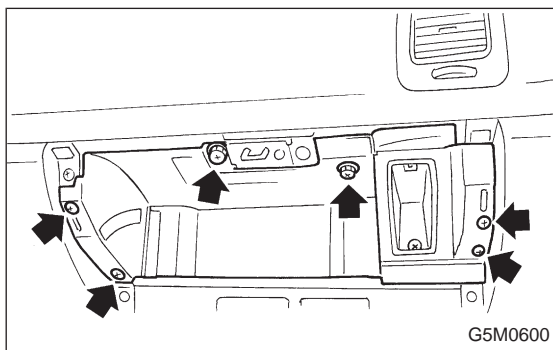

11) Remove pocket back panel.

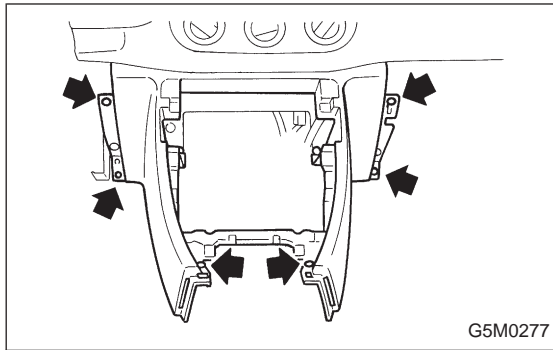

12) Remove instrument panel console.

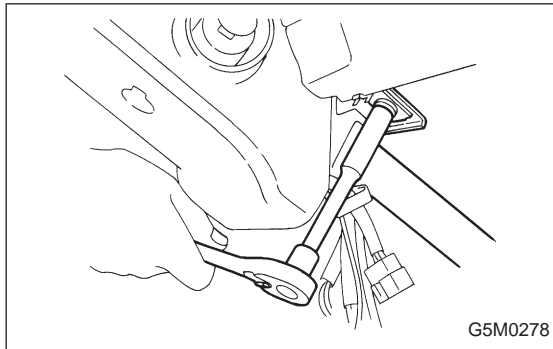

13) Remove two bolts and lower steering column.

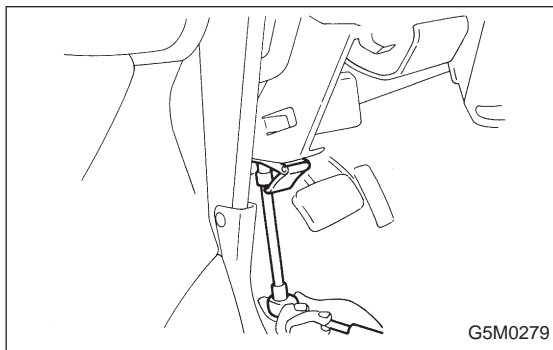

14) Remove hood opener lever.

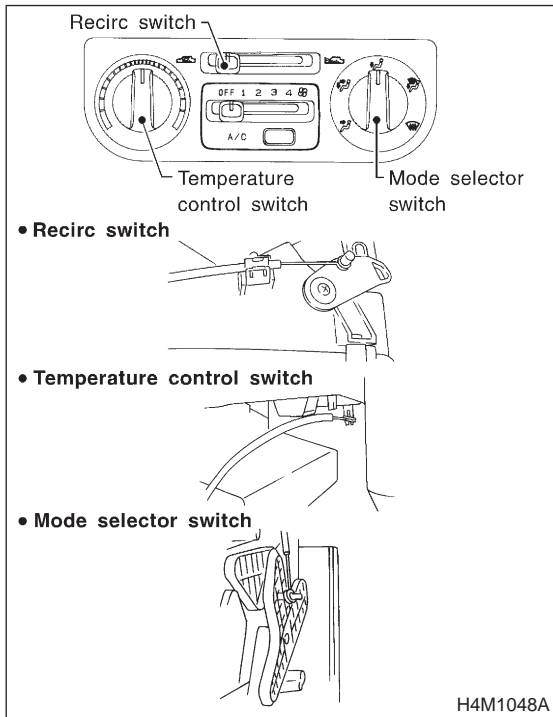

15) Set temperature control switch to "FULL HOT", mode selector switch to "DEF" position and recirc switch to "FRESH" position.

16) Disconnect temperature control cable and mode control cable from heater unit then disconnect recirc control cable from intake unit.

NOTE:

Do not move switch and link when installing.

17) Disconnect harness connectors.

①	15P/Gray
②	24P/Black
③	8P/Natural & black
④	4P/Blue
⑤	12P/Natural
⑥	20P/Blue
⑦	Airbag connector (AB10)/Yellow
⑧	6P/Black

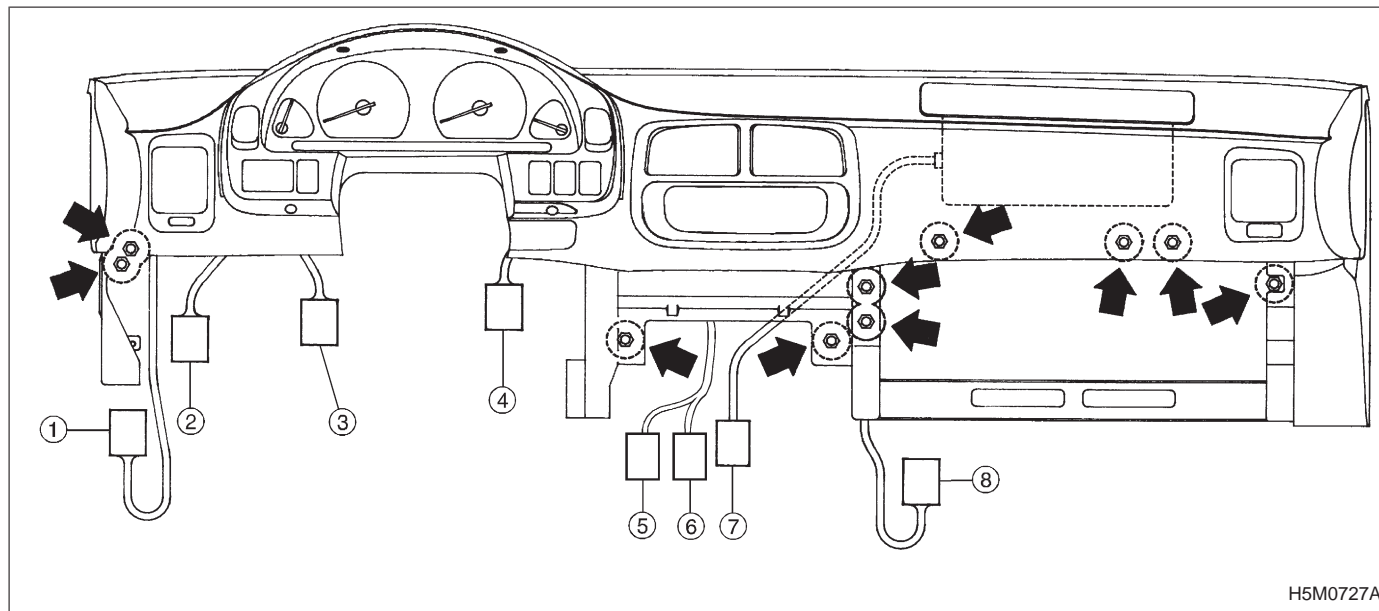
**CAUTION:**

Be sure to hold socket section and not harness when disconnecting.

NOTE:

Put matching mark, if necessary, for easy re-assembly.

18) Remove the ten bolts and nuts.

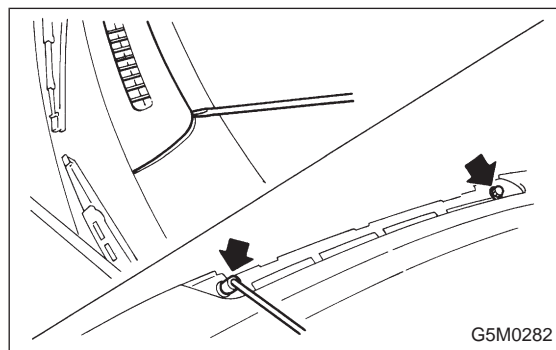

19) Remove front defroster grille and two bolts.

20) Remove instrument panel carefully from the body and then disconnect speedometer cable from back of combination meter.

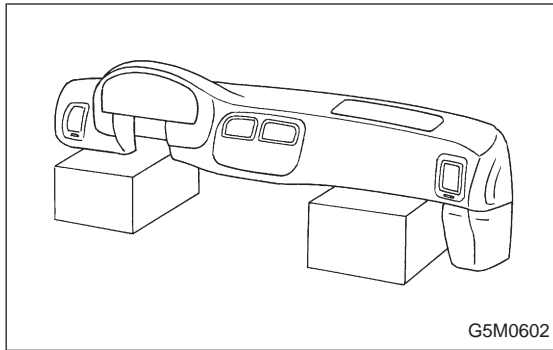

CAUTION:

When storing removed instrument panel with passenger airbag module, place it standing up on the floor.

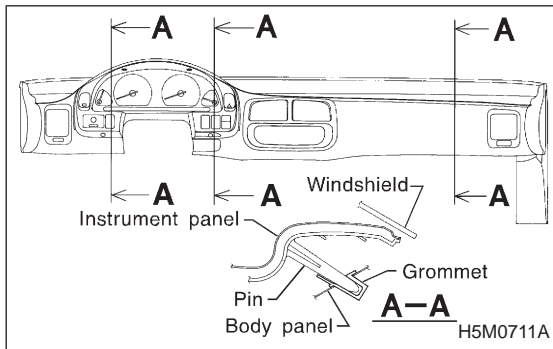

B: INSTALLATION

1) Installation is in the reverse order of removal.

NOTE:

When setting instrument panel into position, push three pins into grommet on body panel.

CAUTION:

- Be careful not to snag the harness.
- Make sure to connect harness connectors.
- Take care not to scratch the instrument panel and related parts.