

### 5. Oil Seal

#### A: INSPECTION

Check for transmission gear oil leaks at oil seal area. If there is an oil leak, replace the oil seal with new one and check the propeller shaft.

#### B: REPLACEMENT

- 1) Disconnect the ground cable from battery.
- 2) Lift up the vehicle.
- 3) Remove the transmission under cover.

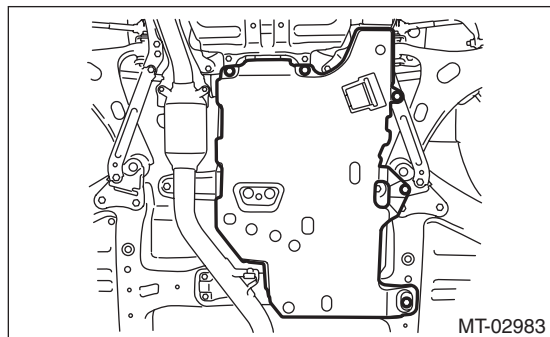

- 4) Clean the transmission exterior.
- 5) Using the TORX® bit T70, remove the drain plug, and drain the transmission gear oil completely.

#### CAUTION:

- Immediately after the vehicle has been running or after idling for a long time, the transmission gear oil will be hot. Be careful not to receive burns.
- Be careful not to spill the transmission gear oil on the exhaust pipe, to prevent emission of smoke or causing a fire. If gear oil is spilled, wipe it off completely.

- 6) Tighten the drain plug using TORX® bit T70.

#### NOTE:

Use a new gasket.

#### Tightening torque:

**44 N·m (4.5 kgf-m, 32.5 ft-lb) (aluminum gasket, silver)**

**70 N·m (7.1 kgf-m, 51.6 ft-lb) (copper gasket, brown)**

**70 N·m (7.1 kgf-m, 51.6 ft-lb) (metal gasket, black)**

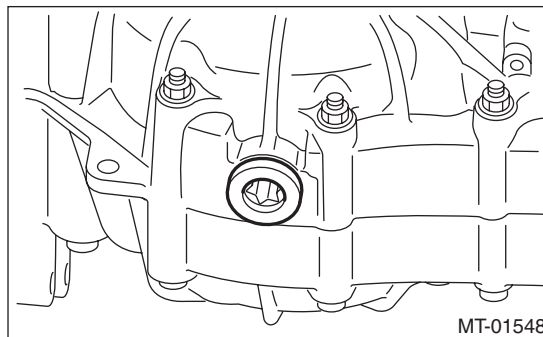

- 7) Remove the rear exhaust pipe. <Ref. to EX(H4DO)-18, REMOVAL, Rear Exhaust Pipe.>
- 8) Remove the center exhaust cover.

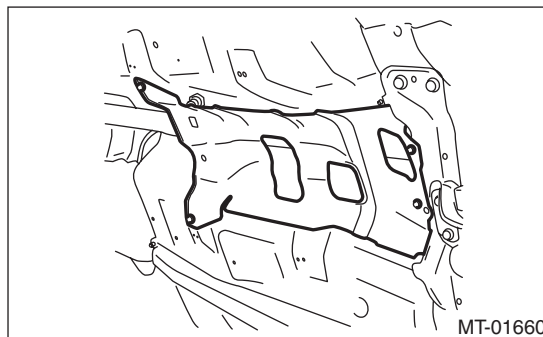

- 9) Remove the propeller shaft. <Ref. to DS-11, REMOVAL, Propeller Shaft.>
- 10) Using the ST, remove the oil seal.

ST 398527700 PULLER ASSY

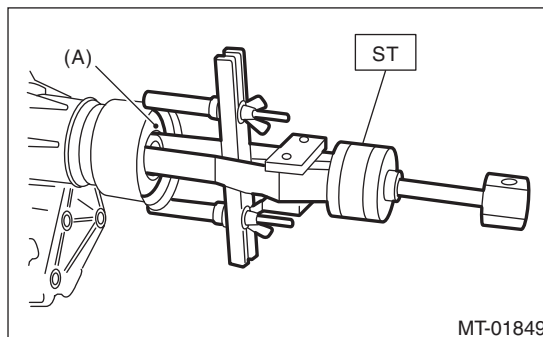

(A) Oil seal

11) Using the ST, install the oil seal.

**NOTE:**

- When grease is not applied to the oil seal lips, apply the transmission gear oil to the oil seal lips.
- Use a new oil seal.

ST 498057300 INSTALLER

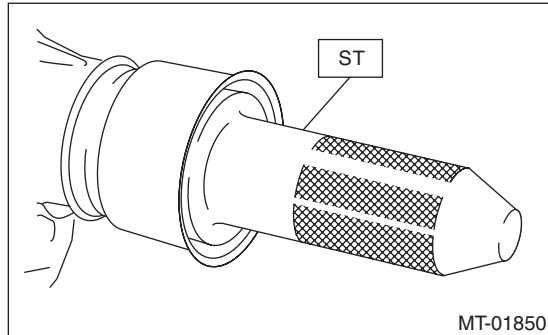

12) Install the propeller shaft. <Ref. to DS-14, INSTALLATION, Propeller Shaft.>

13) Install the center exhaust cover.

**Tightening torque:**

**18 N·m (1.8 kgf-m, 13.3 ft-lb)**

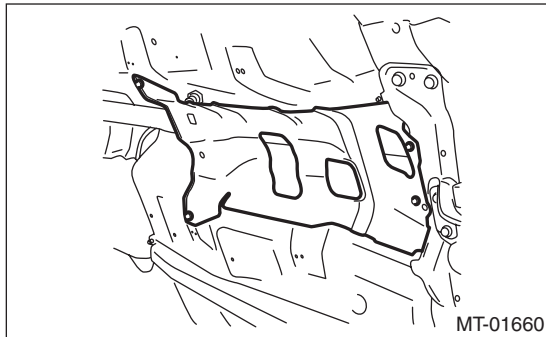

14) Install the rear exhaust pipe. <Ref. to EX(H4DO)-19, INSTALLATION, Rear Exhaust Pipe.>

15) Install the transmission under cover.

**Tightening torque:**

**18 N·m (1.8 kgf-m, 13.3 ft-lb)**

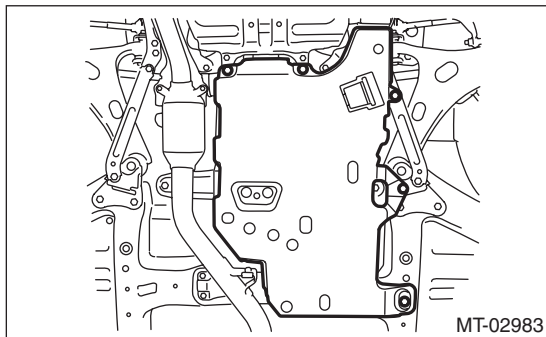

16) Lower the vehicle.

17) Pour in transmission gear oil and check the oil level. <Ref. to 6MT-24, Transmission Gear Oil.>

18) Connect the battery ground terminal.