

18.Front Wheel Speed Sensor

A: REMOVAL

CAUTION:

- Be sure to prevent water or oil from contacting the connector terminal of front wheel speed sensor. If adhesion occurs, replace with a new part.
- When removing front wheel speed sensor, CVTF may let out. If CVTF has leaked, adjust the CVTF level after installing the front wheel speed sensor.

- 1) Disconnect the ground cable from battery.
- 2) Lift up the vehicle.
- 3) Clean the transmission exterior.
- 4) Remove the front wheel speed sensor harness connector.
- 5) Remove the front wheel speed sensor.

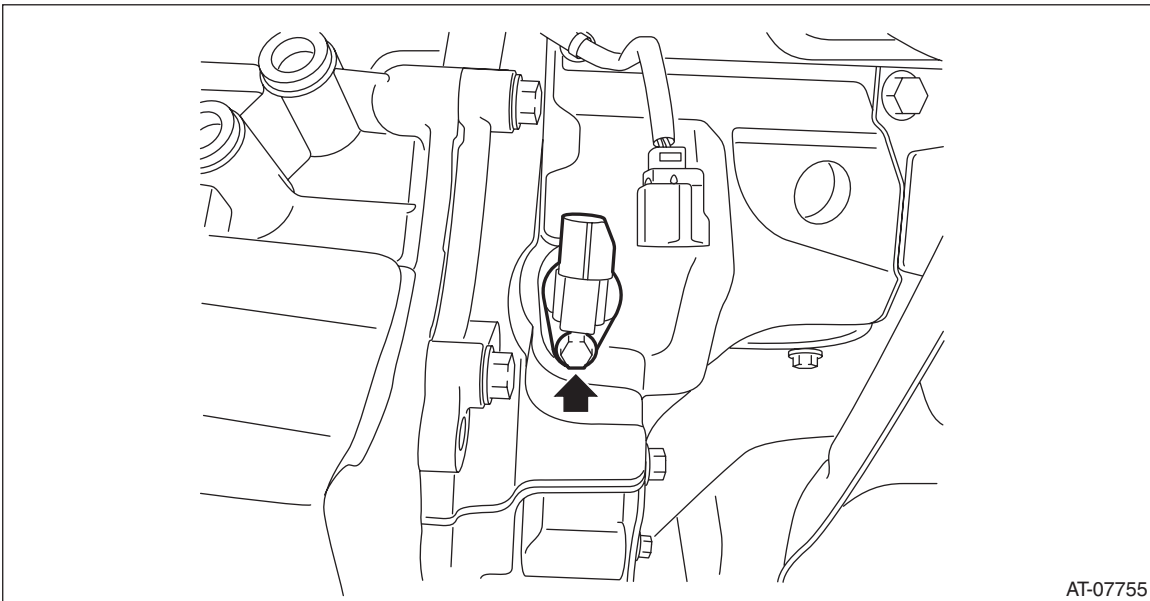

AT-07755

B: INSTALLATION

CAUTION:

- Be sure to prevent water or oil from contacting the connector terminal of front wheel speed sensor. If adhesion occurs, replace with a new part.
- After installing the front wheel speed sensor, adjust the CVTF level.

Install in the reverse order of removal.

NOTE:

- Use new O-rings.
- Apply CVTF to the O-ring.

Tightening torque:

5 N·m (0.5 kgf-m, 3.7 ft-lb)

Front Wheel Speed Sensor

CONTINUOUSLY VARIABLE TRANSMISSION

C: INSPECTION

1) Set the probe of oscilloscope to TCM harness connector.

Connector & terminal

(B54) No. 20 (+) — No. 14 (-):

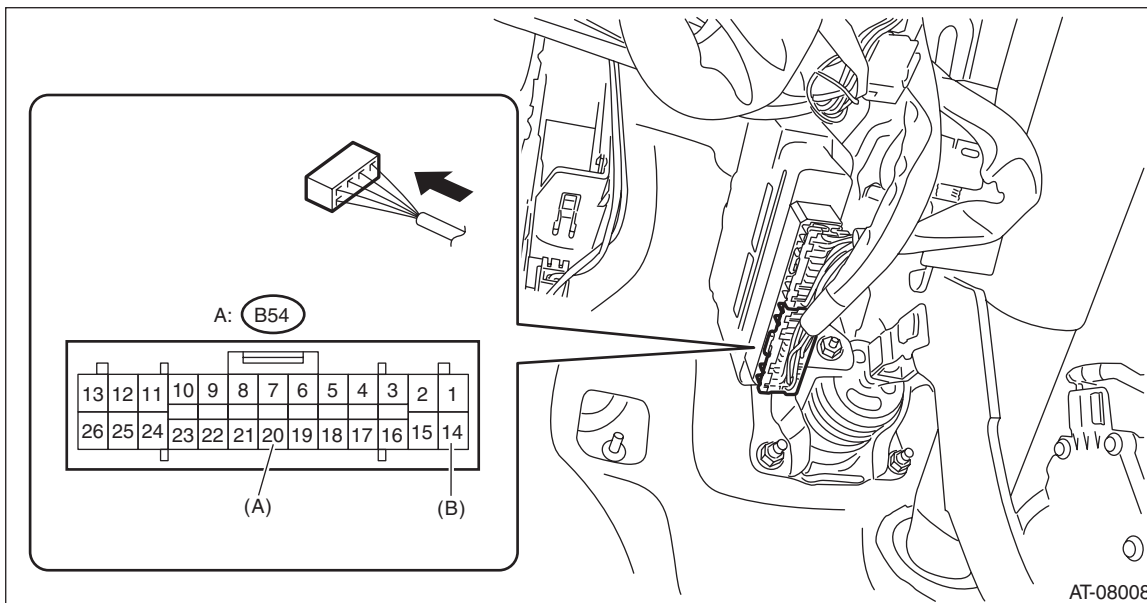

(A) + probe

(B) - probe

2) Lift up the vehicle and raise the vehicle speed up to 20 km/h (12 MPH).

3) Check the waveform of front wheel speed sensor when vehicle speed is at 20 km/h (12 MPH).

NOTE:

The waveform cycle changes as the speed changes.

