

Primary Speed Sensor

CONTINUOUSLY VARIABLE TRANSMISSION

17.Primary Speed Sensor

A: REMOVAL

CAUTION:

Be sure to prevent water or oil from contacting the connector terminal of primary speed sensor. If adhesion occurs, replace with a new part.

- 1) Disconnect the ground cable from battery.
- 2) Remove the intercooler. <Ref. to IN(H4DOTC)-35, REMOVAL, Intercooler.>
- 3) Clean the transmission exterior.
- 4) Remove the primary speed sensor harness connector.

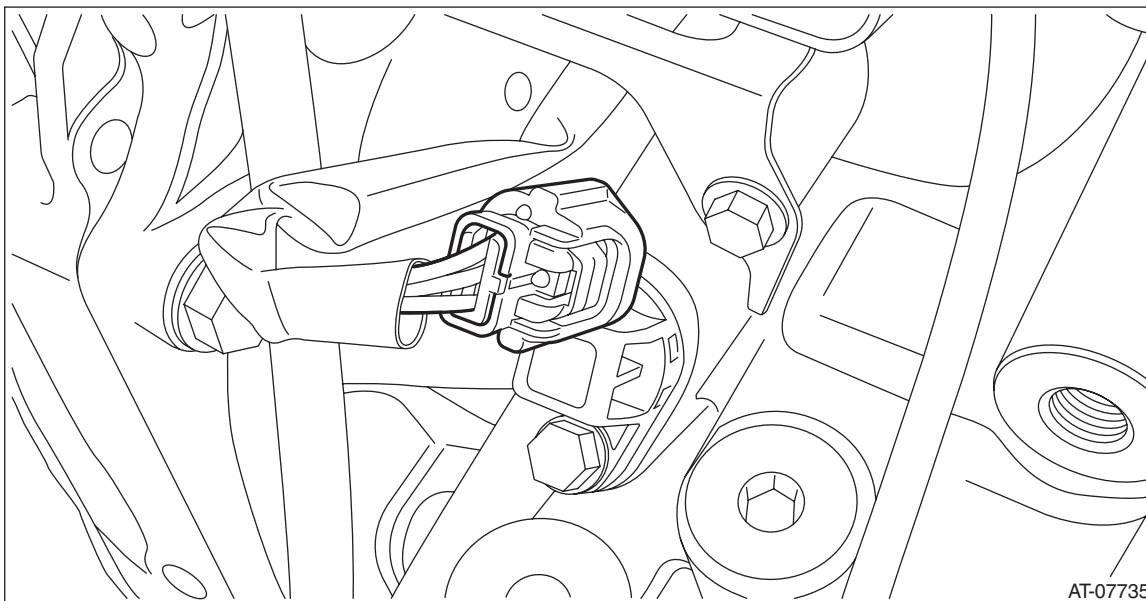

- 5) Remove the primary speed sensor and the spacer.

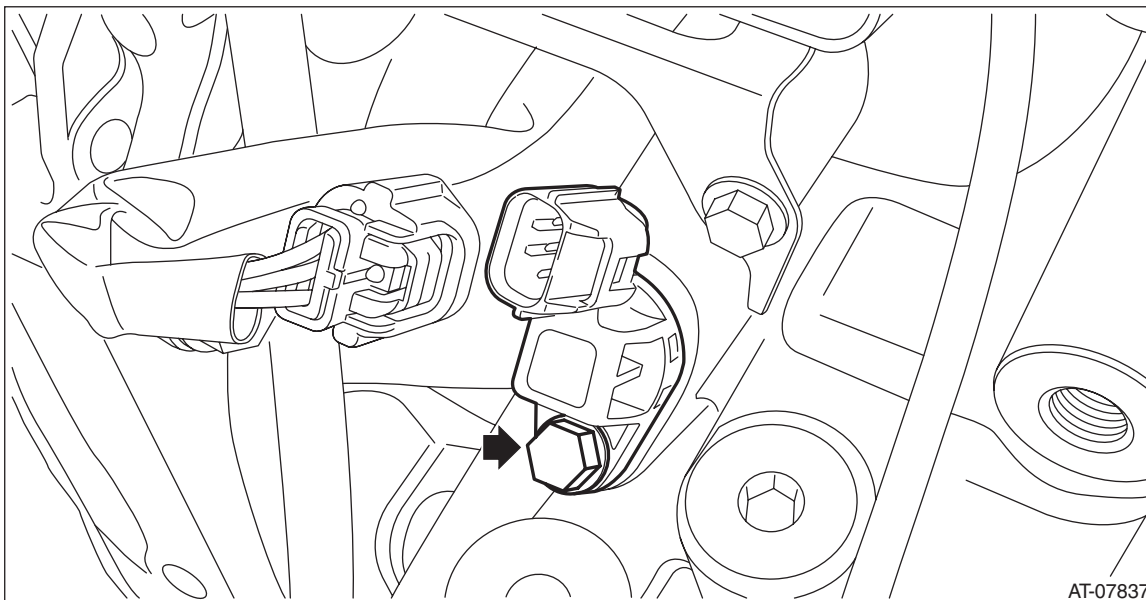

B: INSTALLATION

CAUTION:

Be sure to prevent water or oil from contacting the connector terminal of primary speed sensor. If adhesion occurs, replace with a new part.

Install in the reverse order of removal.

CAUTION:

Do not forget to install the spacer.

NOTE:

- Use new O-rings.
- Apply CVTF to the O-rings.

Tightening torque:

Primary speed sensor

5 N·m (0.5 kgf-m, 3.7 ft-lb)

C: INSPECTION

1) Set the probe of oscilloscope to TCM harness connector.

Connector & terminal

(B54) No. 6 (+) — No. 14 (-):

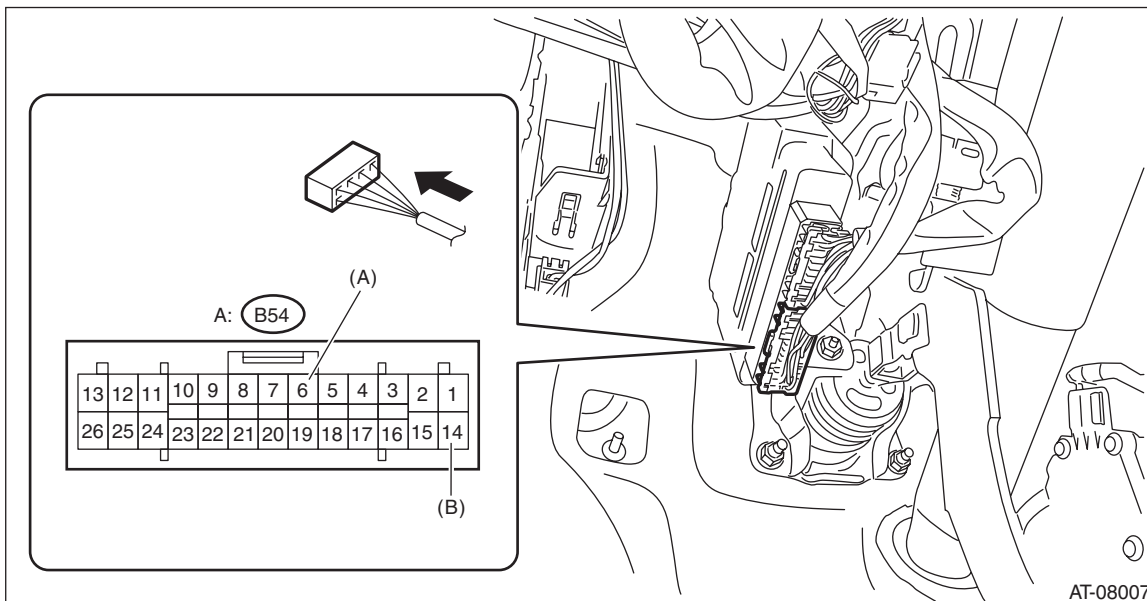

(A) + probe

(B) - probe

Primary Speed Sensor

CONTINUOUSLY VARIABLE TRANSMISSION

2) Start and warm up the engine.

3) Check the waveform of primary speed sensor with engine idling.

NOTE:

The waveform cycle changes as the speed changes.

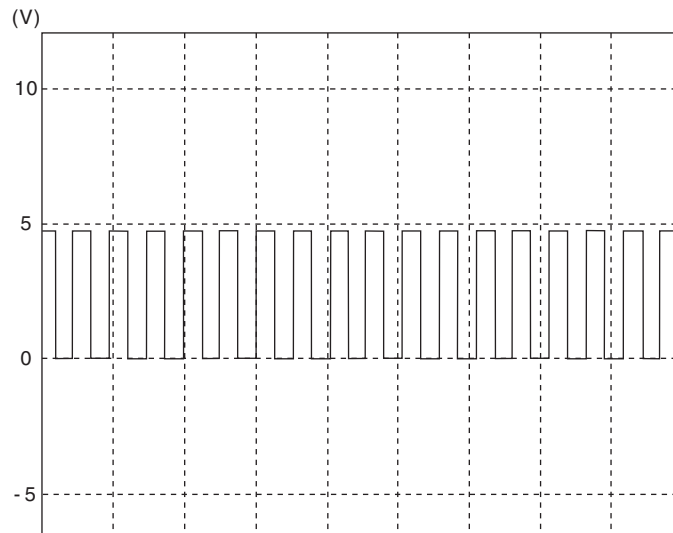

AT-08034