

## 9. Transfer Clutch Pressure Test

### A: INSPECTION

- 1) Lift up the vehicle.
- 2) Remove the under cover front - transmission.
- 3) Remove the rear exhaust pipe from center exhaust pipe.

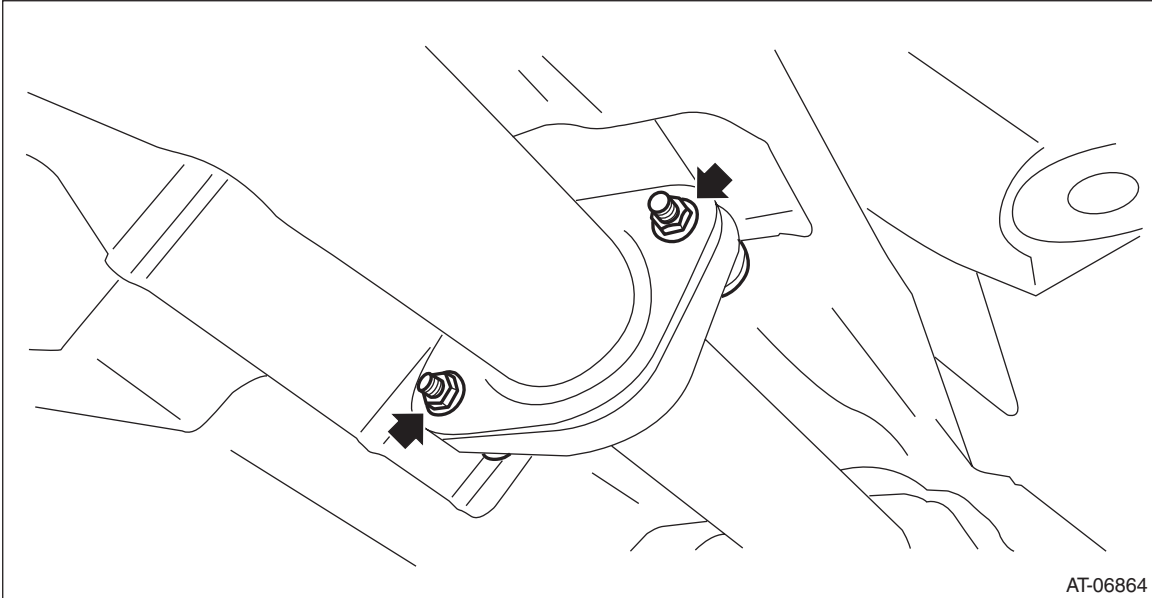

- 4) Remove the center exhaust cover.
- 5) Set the transmission jack under the transmission.
- 6) Remove the mounting bolt of rear crossmember.

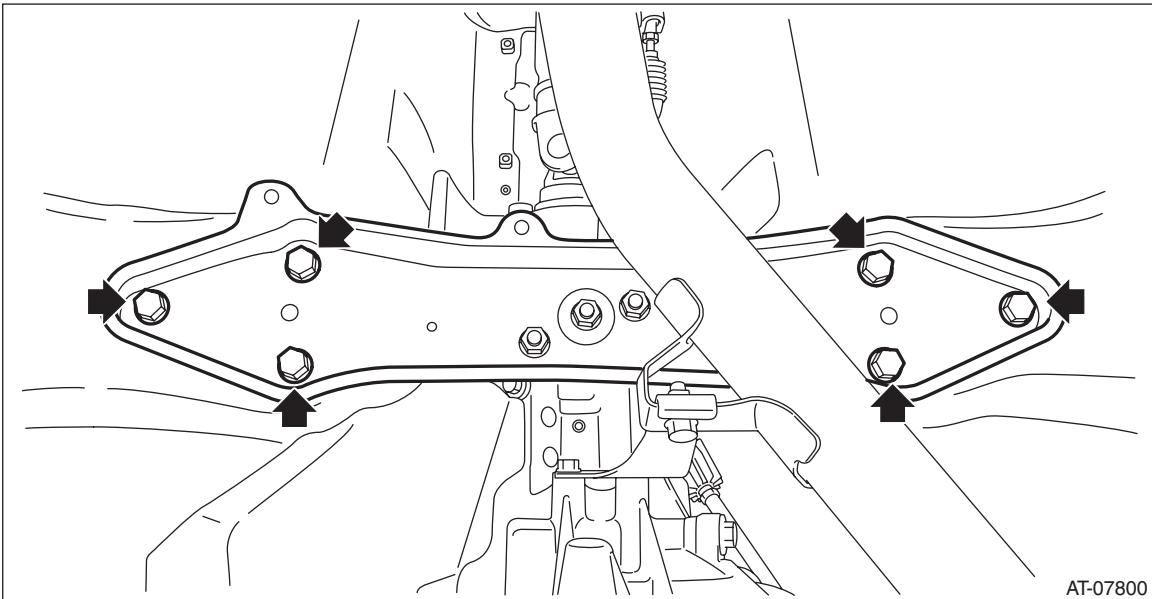

- 7) Lower the rear side of transmission until the transfer clutch pressure test plug can be removed.
- 8) Remove the transfer clutch pressure test plug.

## Transfer Clutch Pressure Test

### CONTINUOUSLY VARIABLE TRANSMISSION

9) Set the ST1, ST2, ST3 and ST4 to the transmission.

#### NOTE:

- Use ST1 ADAPTER HOSE B with genuine union screw (part No. 801914010) and gasket (part No. 803914060) attached.
- Use ST3 PRESSURE GAUGE ADAPTER with genuine O-ring (part No. 806911080) attached.

ST1 34099AC020 ADAPTER HOSE B  
ST2 34099AC010 ADAPTER HOSE A  
ST3 18681AA000 PRESSURE GAUGE ADAPTER  
ST4 498575400 OIL PRESSURE GAUGE ASSY

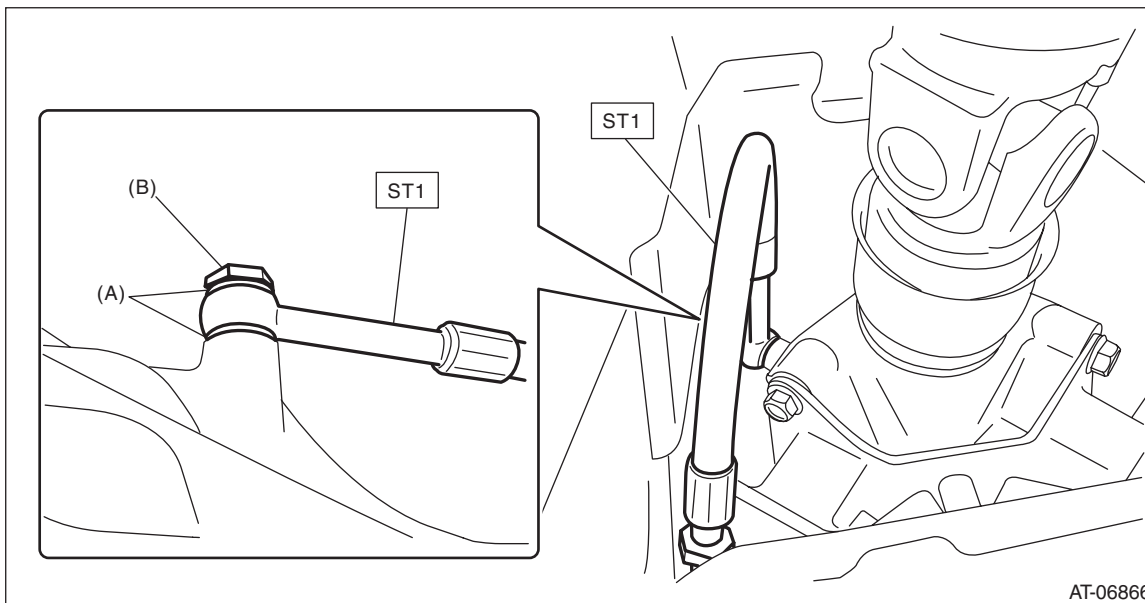

- (A) Gasket (genuine part)  
(B) Union screw (genuine part)

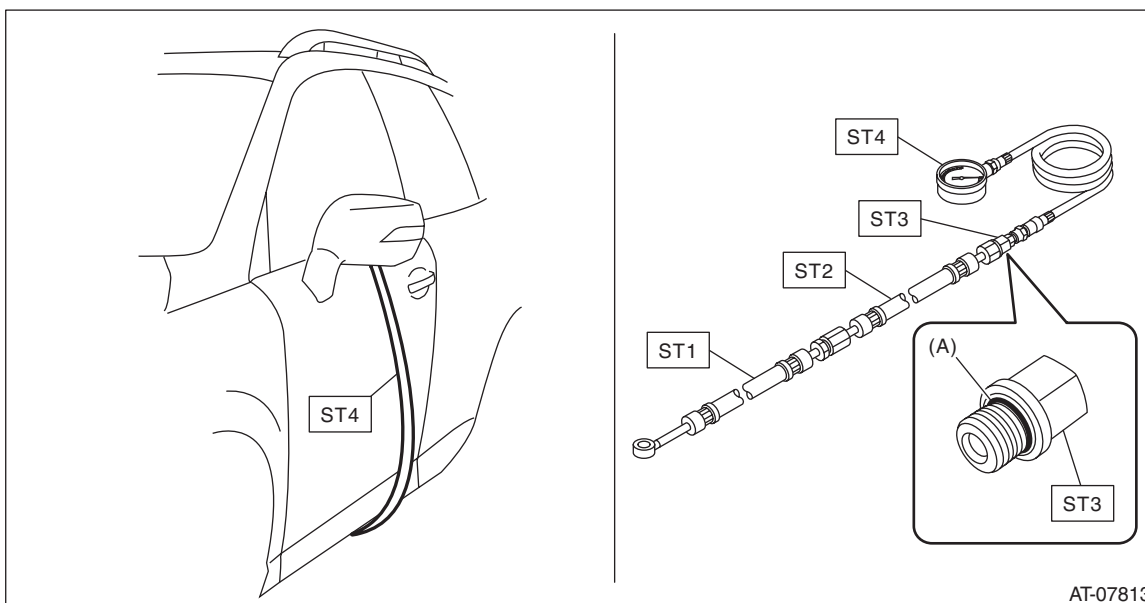

- (A) O-ring (genuine part)

## Transfer Clutch Pressure Test

CONTINUOUSLY VARIABLE TRANSMISSION

10) Raise the transmission, and install the rear crossmember.

**Tightening torque:**

**70 N·m (7.1 kgf-m, 51.6 ft-lb)**

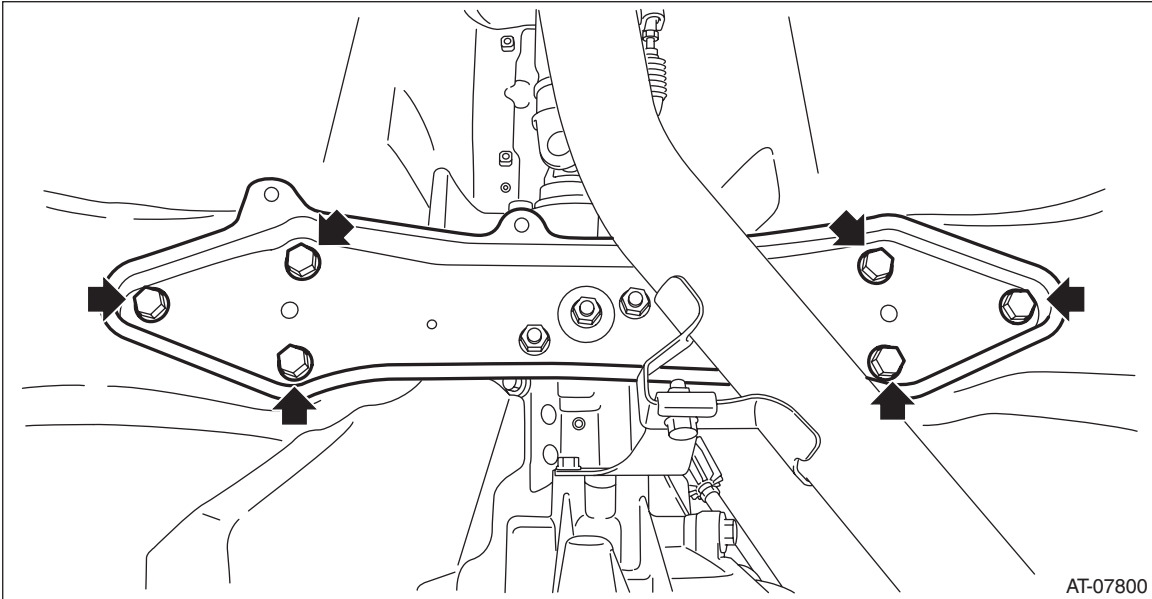

11) Install the rear exhaust pipe to center exhaust pipe.

**Tightening torque:**

**18 N·m (1.8 kgf-m, 13.3 ft-lb)**

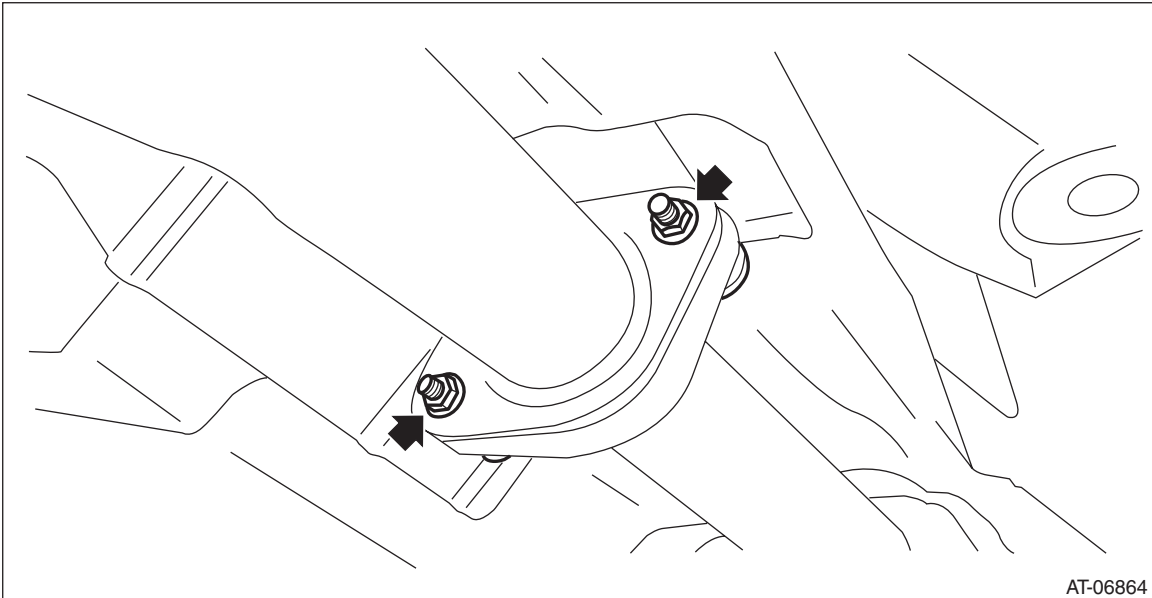

12) Lower the vehicle.

13) Connect the Subaru Select Monitor to the data link connector and read the current data.

## Transfer Clutch Pressure Test

### CONTINUOUSLY VARIABLE TRANSMISSION

14) Check the transfer clutch pressure as in secondary pressure (line pressure) test. <Ref. to CVT(TR580)-48, Secondary Pressure (Line Pressure) Test.>

#### NOTE:

- For models with X MODE switch, turn OFF the switch for inspection.
- Use Subaru Select Monitor for switching to FWD mode. <Ref. to CVT(TR580)-44, AWD ON/OFF Switching Mode.>
- If no oil pressure is produced, if it does not change in AWD mode or if oil pressure is produced in FWD mode, there may be a problem in the control valve body.

Range position	ON Duty ratio (%)	Accelerator pedal opening angle (%)	Standard transfer clutch pressure kPa (kgf/cm <sup>2</sup> , psi)	
			AWD mode	FWD mode
D	95 — 100	Fully opened (100)	1,000 — 1,200 (10.2 — 12.2, 145 — 174)	—
	60	Adjust ON Duty ratio to 60%.	400 — 700 (4.1 — 7.1, 58 — 102)	—
	0	Fully closed (0)	—	0 (0, 0)
N or P	0	Fully closed (0)	0	—

15) Lift up the vehicle.

16) Remove the rear exhaust pipe from center exhaust pipe.

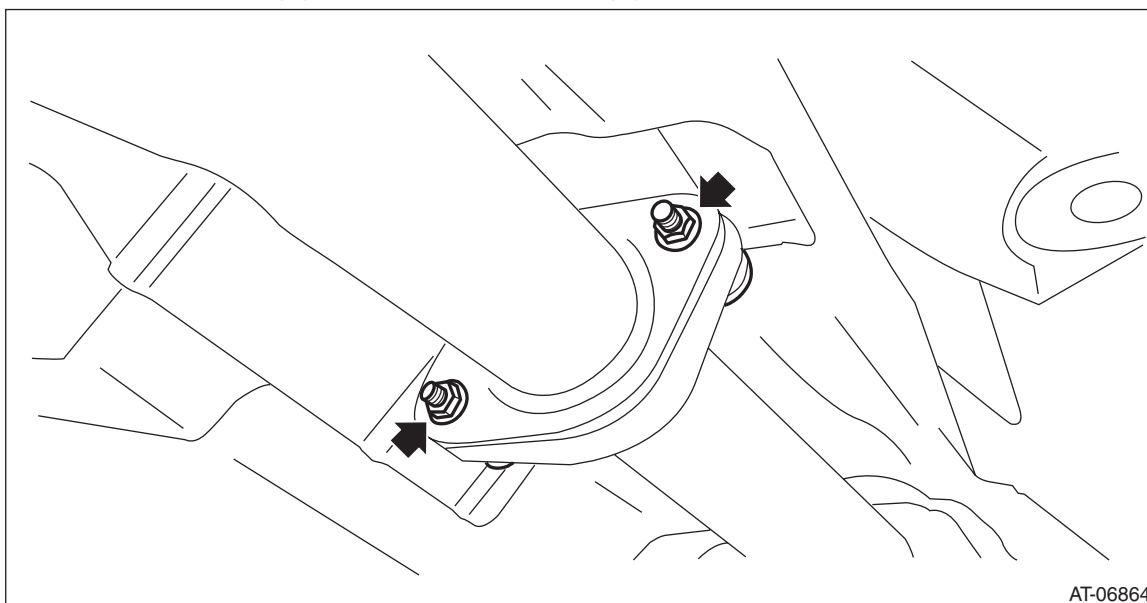

17) Set the transmission jack under the transmission.

# Transfer Clutch Pressure Test

CONTINUOUSLY VARIABLE TRANSMISSION

18) Remove the mounting bolt of rear crossmember.

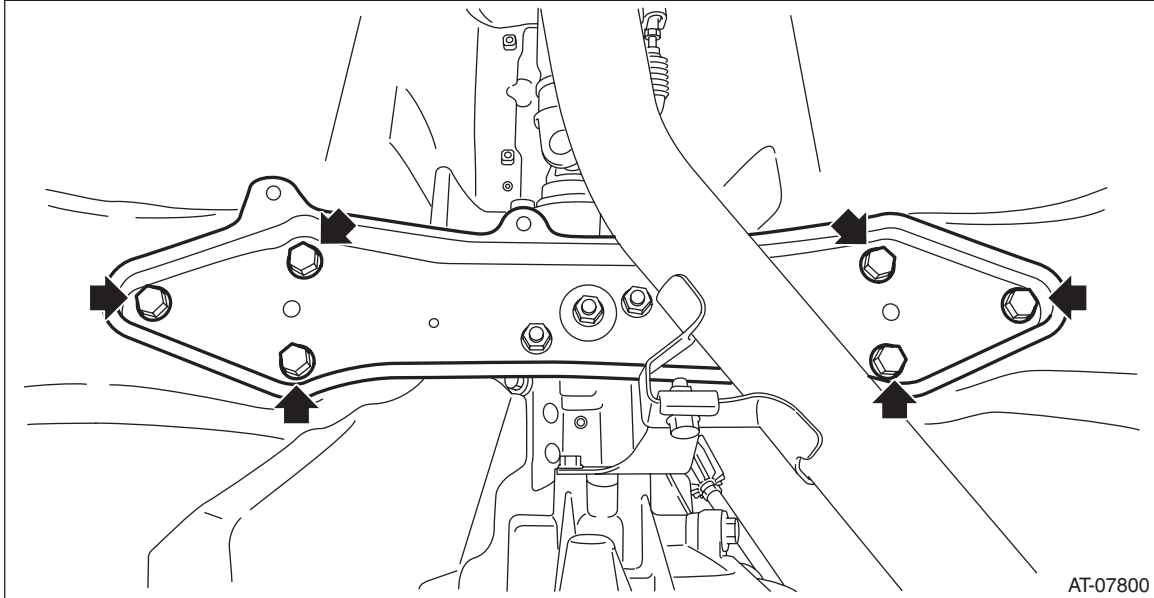

19) Lower the rear side of transmission until the ST can be removed.

20) Remove the ST and install the plug.

**NOTE:**

- Use new O-rings.
- Apply CVTF to the O-ring.

**Tightening torque:**

**25 N·m (2.5 kgf-m, 18.4 ft-lb)**

21) Raise the transmission, and install the rear crossmember.

**Tightening torque:**

**70 N·m (7.1 kgf-m, 51.6 ft-lb)**

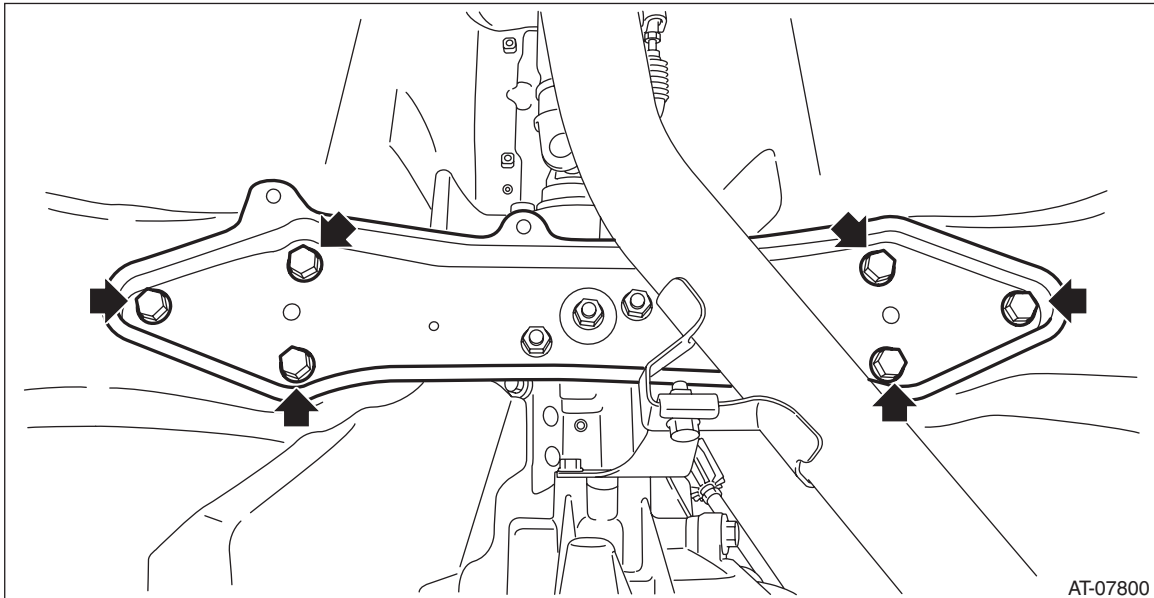

22) Install the center exhaust cover.

**Tightening torque:**

**18 N·m (1.8 kgf-m, 13.3 ft-lb)**

## Transfer Clutch Pressure Test

### CONTINUOUSLY VARIABLE TRANSMISSION

---

23) Install the rear exhaust pipe to center exhaust pipe.

NOTE:

Use a new gasket.

**Tightening torque:**

**18 N·m (1.8 kgf-m, 13.3 ft-lb)**

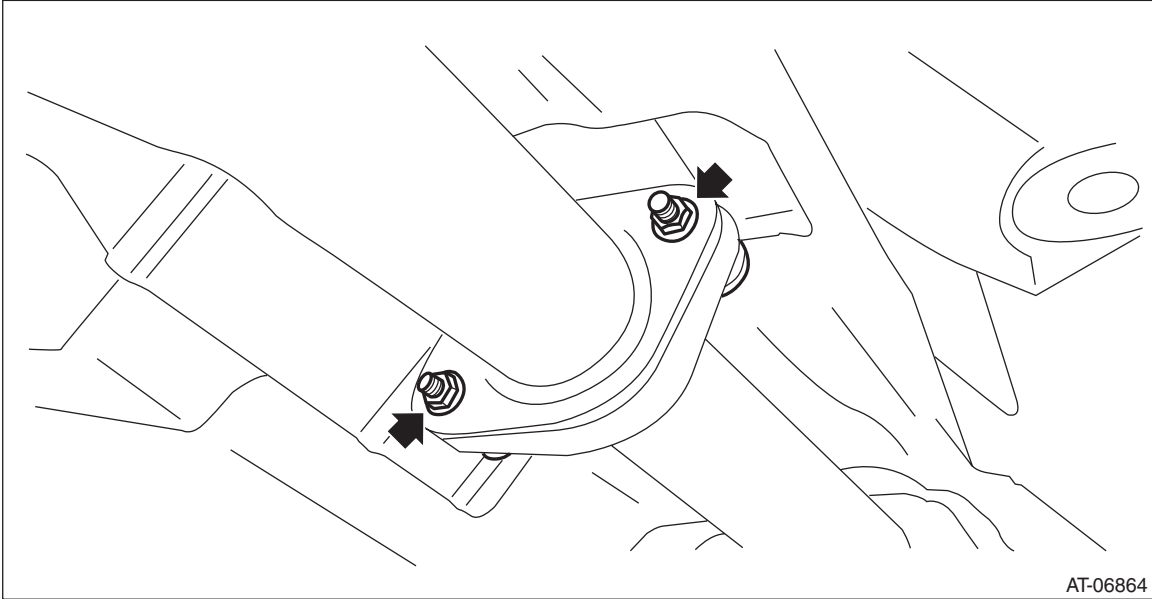

AT-06864

24) Install the under cover front - transmission.

**Tightening torque:**

**18 N·m (1.8 kgf-m, 13.3 ft-lb)**

25) Lower the vehicle.