

8. Front Wiper Motor and Link

A: REMOVAL

- 1) Disconnect the ground cable from battery.
- 2) Remove the arm assembly - windshield wiper.
 - (1) Remove the cover - windshield wiper arm.
 - (2) Remove the nuts, and remove the arm assembly - windshield wiper.

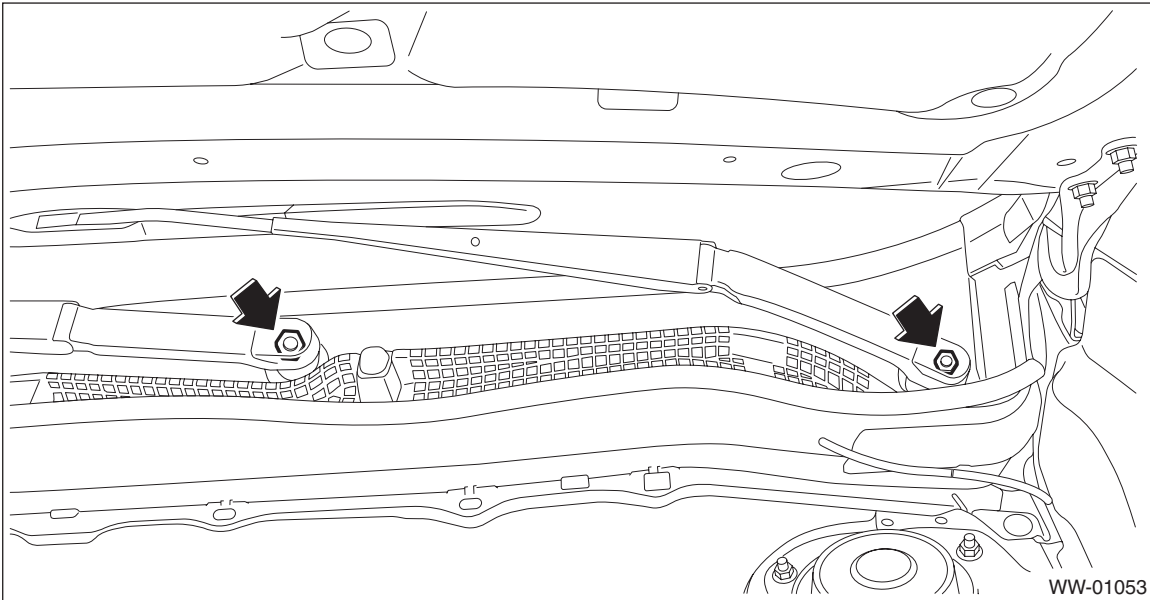

- 3) Remove the cowl panel - side.
 - (1) Remove the clips.
 - (2) Release the claws from (1) to (3) in sequence, and then remove the cowl panel - side.

CAUTION:

Pulling with excessive force may damage the cowl panel - side. If it is difficult to remove, use a plastic remover or equivalent tool.

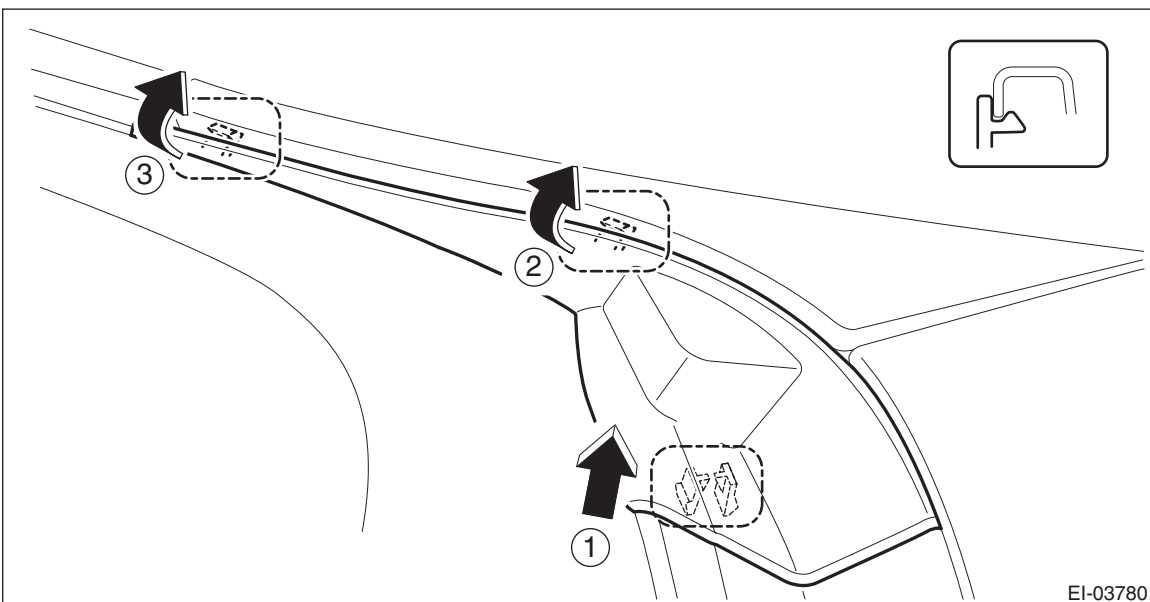

Front Wiper Motor and Link

WIPER AND WASHER SYSTEMS

4) Remove the cowl panel assembly.

CAUTION:

Before removing the cowl panel, use an air blower and nylon brush to sweep gravel from the lower area of the front side of the glass.

- (1) Disconnect the hose - windshield washer.
- (2) Remove clips (A).
- (3) Check the direction of the clip (B), and push the claws from both sides to remove it.

CAUTION:

When removing the clip (B), push the claw of the clip from both sides.

Be careful because the clips (B) can be damaged if you pull unnecessarily hard on them.

- (4) Remove the cowl panel assembly by pulling it out towards the front of the vehicle.

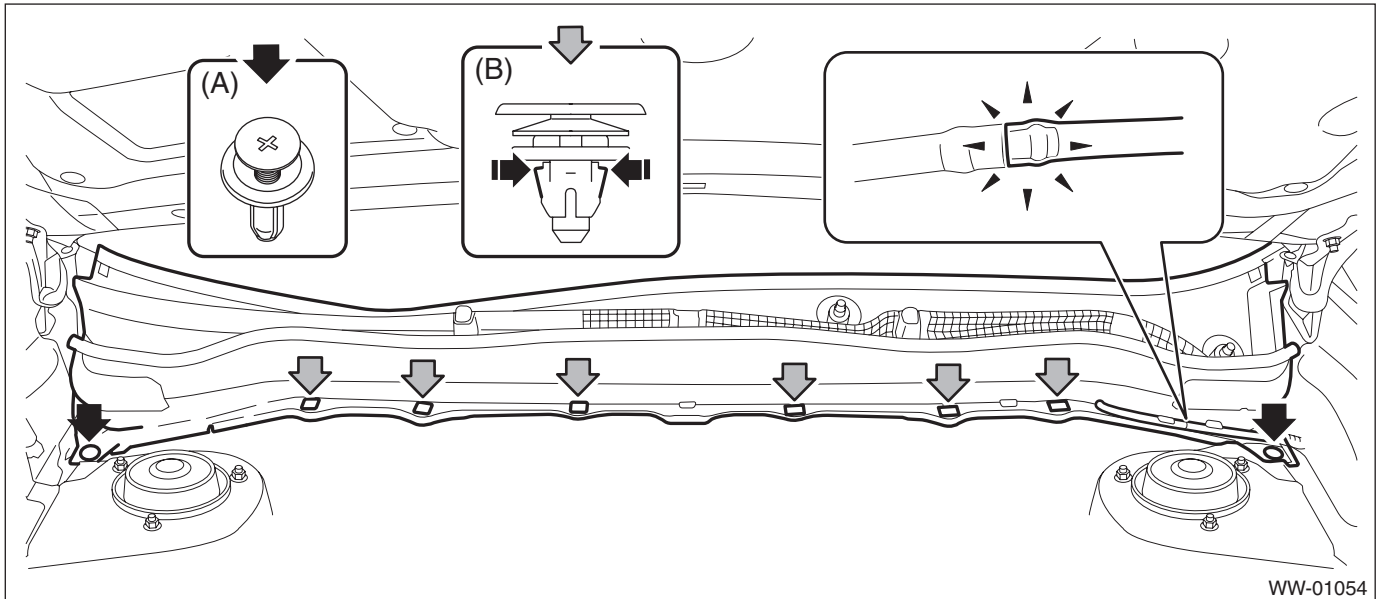

5) Remove the link assembly - windshield wiper.

- (1) Disconnect the connector of the motor assembly - windshield wiper.
- (2) Remove the bolts and harness clips, and remove the link assembly - windshield wiper.

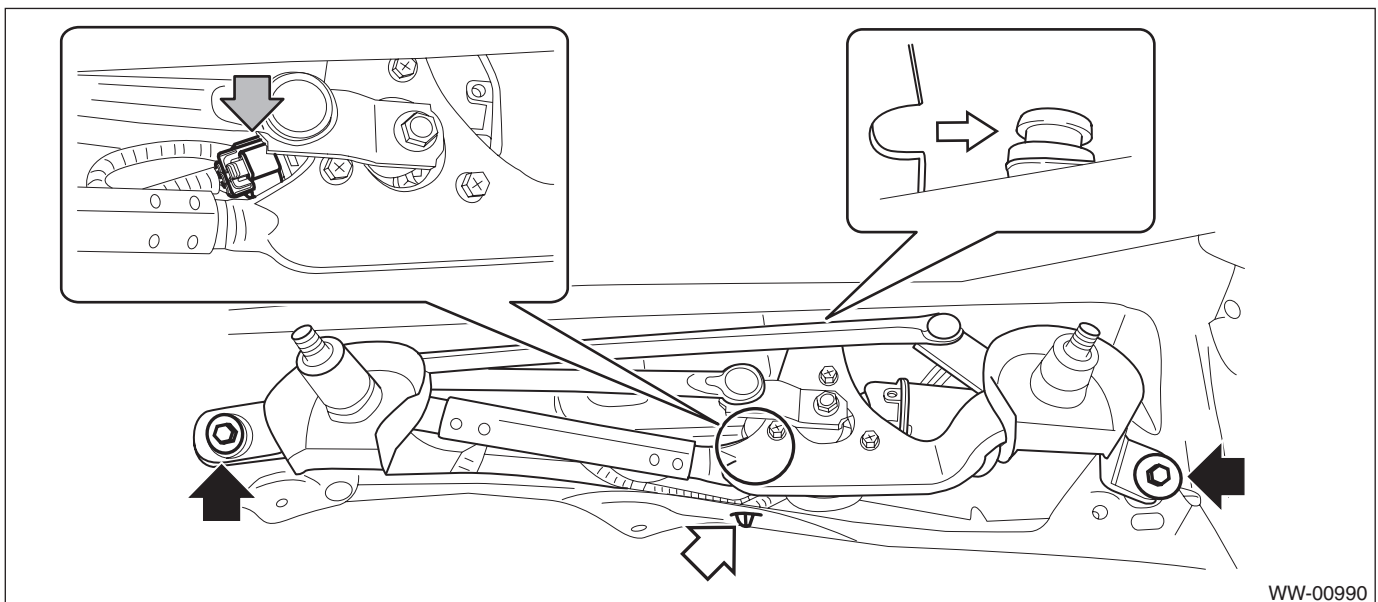

6) Remove the motor assembly - windshield wiper.

- (1) Using a flat tip screwdriver wrapped with protective tape, disconnect the link assembly - windshield wiper from the link plate.
- (2) Remove the bolts, and remove the motor assembly - windshield wiper.

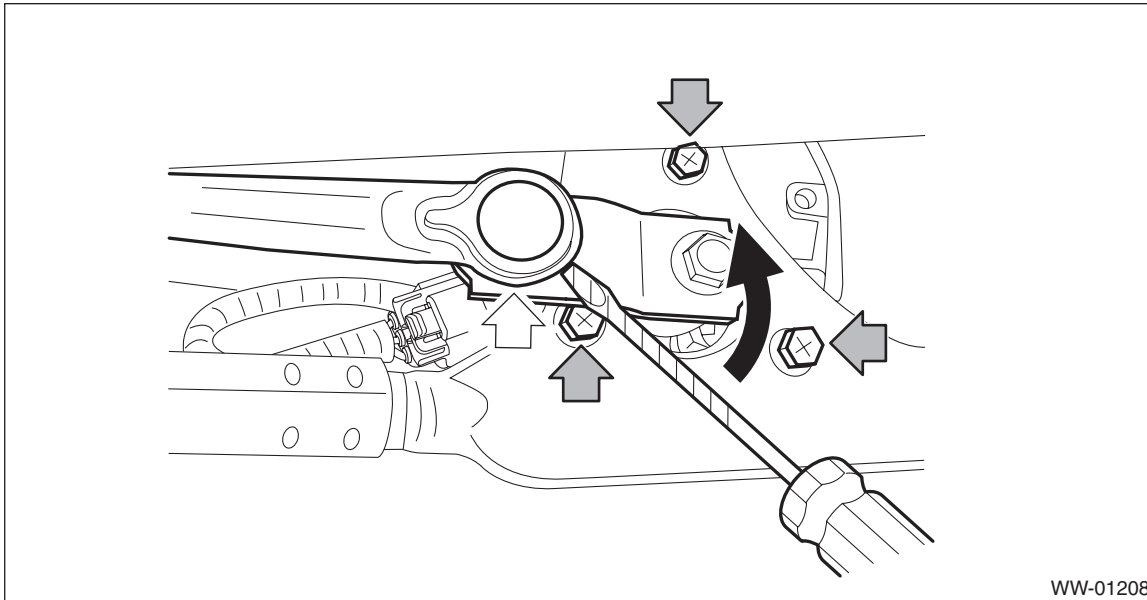

WW-01208

B: INSTALLATION

- 1) Connect the battery ground terminal.
- 2) To confirm that the motor assembly - windshield wiper is at the auto stop position, connect the harness to the motor and turn the wiper switch to ON/OFF once.

CAUTION:

During motor operation, do not touch the movable part.

- 3) Disconnect the ground cable from battery.
- 4) Install the motor assembly - windshield wiper.

CAUTION:

Set the component where the rod (B) and link plate (A) is aligned in a straight line.

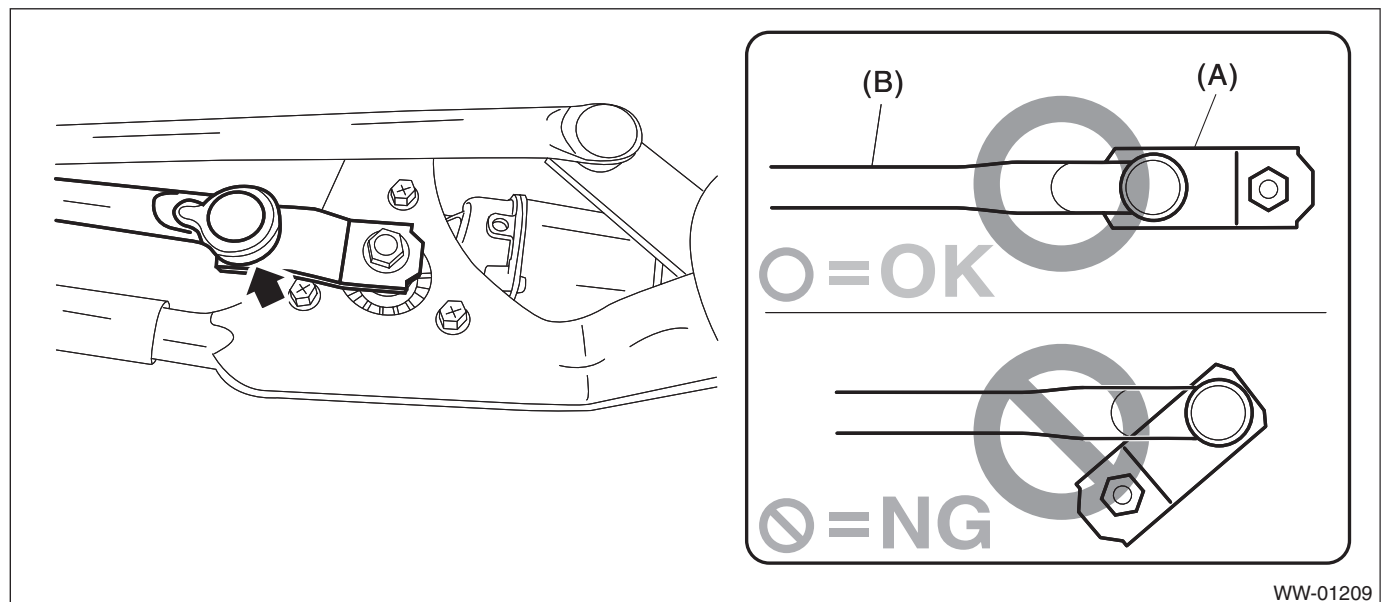

WW-01209

Front Wiper Motor and Link

WIPER AND WASHER SYSTEMS

5) Install the link assembly - windshield wiper and cowl panel in the reverse order of removal.

CAUTION:

- If the cowl panel assembly cannot be installed properly, do not hit or set it forcibly. The claws of the cowl panel or the windshield glass may be damaged.
- Before installing the windshield glass and cowl panel, make sure there are no gravel in the installing area.

Tightening torque:

Refer to "COMPONENT" of "General Description".<Ref. to WW-2, FRONT WIPER, COMPONENT, General Description.>

C: INSPECTION

- 1) When the battery is connected to the terminal of connectors, confirm that the motor operates at low speed.
- 2) When the battery is connected to the terminal of connectors, confirm that the motor operates at high speed.
- 3) Connect the battery to terminals of the connector, and remove the terminal connection with motor rotating at low speed, and stop the motor assembly - windshield wiper in mid-operation.
- 4) Connect the battery and check that the motor stops at the automatic stop position after the motor operates at low speed again.

CAUTION:

Fix the motor to prevent the motor from being shorted by moving during operation.

