

## 11.Rear Wiper Motor

### A: REMOVAL

- 1) Disconnect the ground cable from battery.
- 2) Remove the trim panel - rear gate UPR.
  - (1) Remove the claws on the trim edge.
  - (2) Release the claws in the center of trim, and remove the trim panel - rear gate UPR.

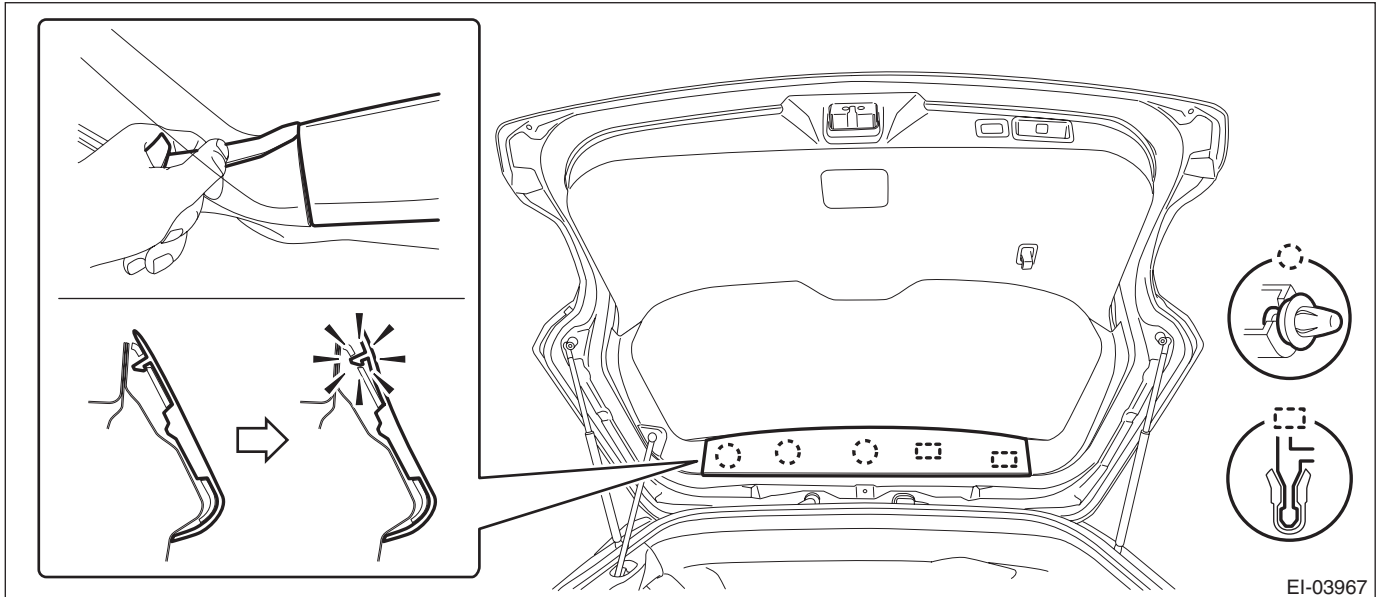

- 3) Remove the trim panel - rear gate pillar side.
  - (1) Disconnect the rod - power rear gate before removing the trim panel - rear gate pillar side LH. (Only for models with power rear gate)

### CAUTION:

For the disconnection procedure of the rod - power rear gate, refer to “REMOVAL”, “Power Rear Gate Rod” in the “POWER REAR GATE” section and observe the precautions for removal. <Ref. to PRG-15, REMOVAL, Power Rear Gate Rod.>

- (2) Release the claws.
- (3) Remove the claws on the bottom of trim, and remove the trim panel - rear gate pillar side.

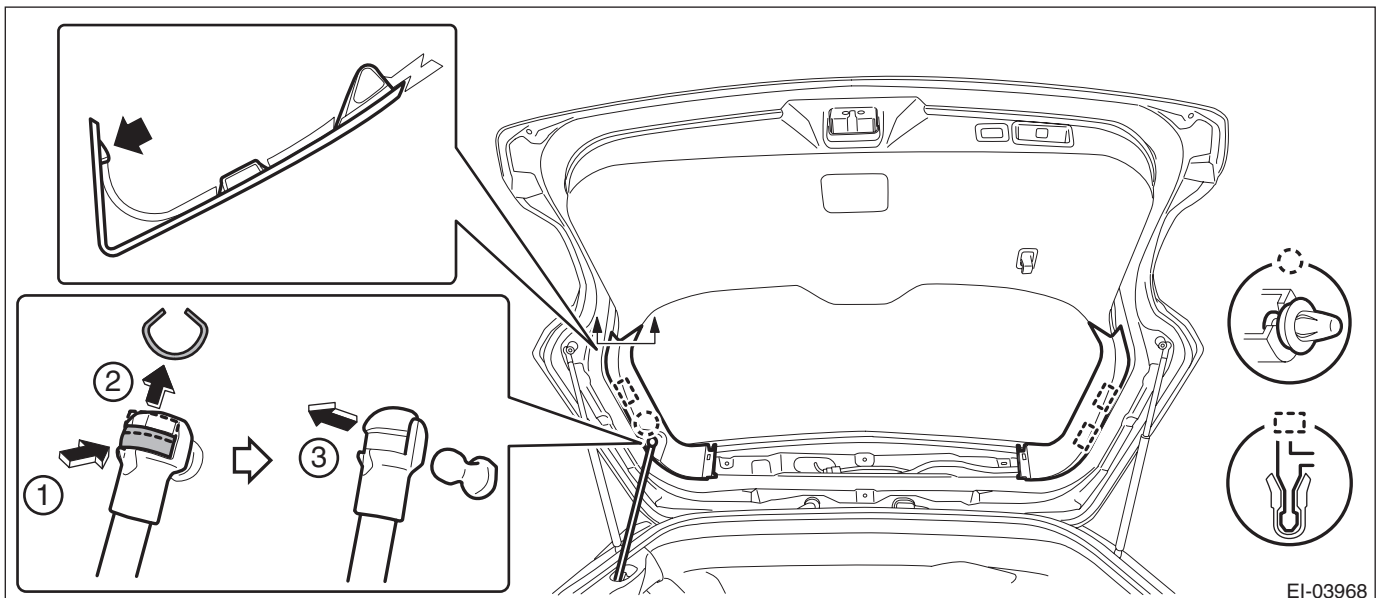

## Rear Wiper Motor

### WIPER AND WASHER SYSTEMS

#### 4) Remove the trim panel - rear gate LWR.

- (1) Remove the power rear gate inner switch and disconnect the connector. (Only for models with power rear gate)
- (2) Remove the screw and clips on both ends.
- (3) Release the clips, and remove the trim panel - rear gate LWR.

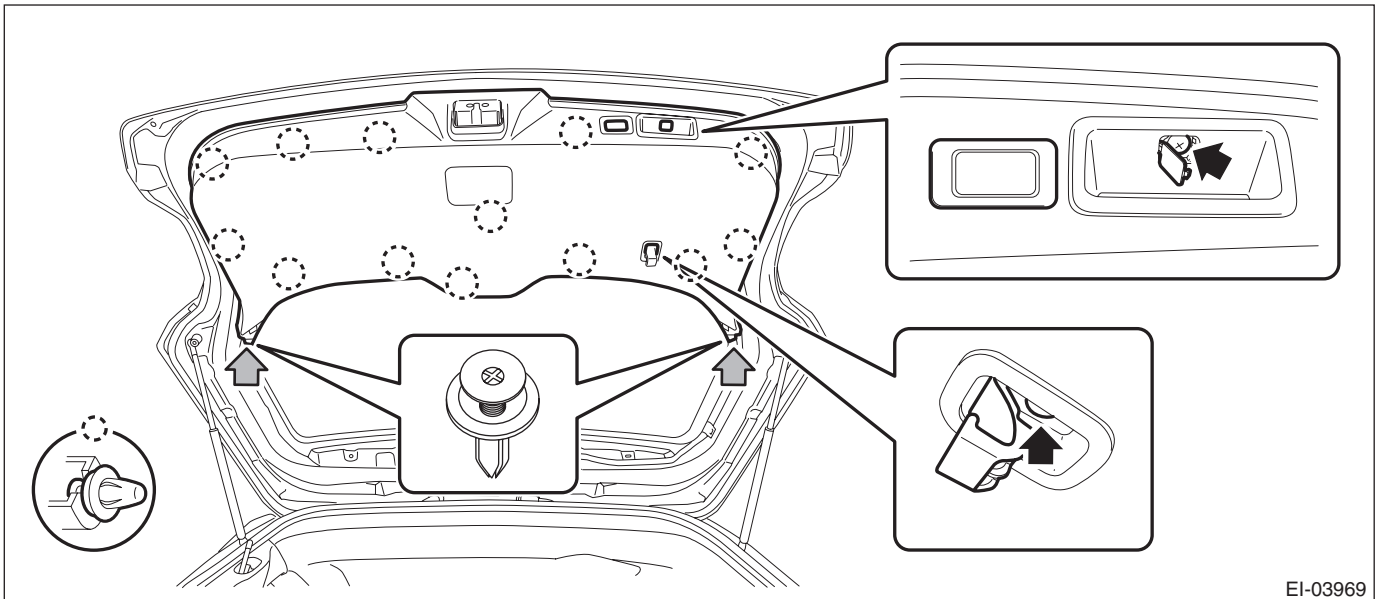

#### 5) Remove the arm assembly - rear wiper.

- (1) Remove the cover - rear wiper arm.
- (2) Remove the nut, and remove the arm assembly - rear wiper.

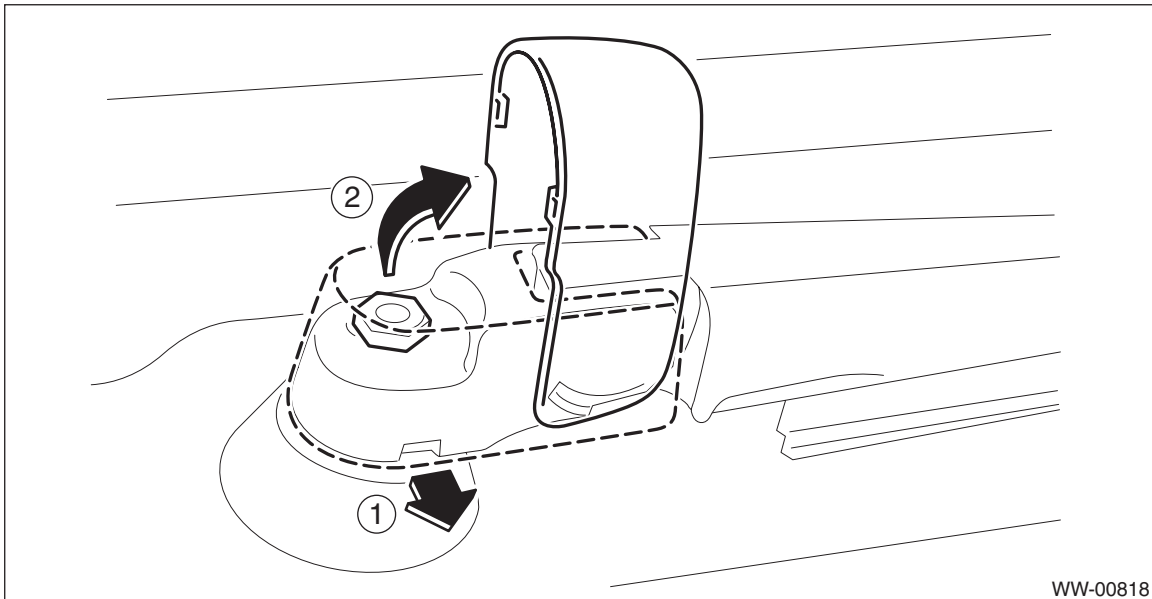

- 6) Remove the motor assembly - rear wiper.
- (1) Disconnect the harness connector of the motor assembly - rear wiper.
  - (2) Remove the bolts, and remove the motor assembly - rear wiper.

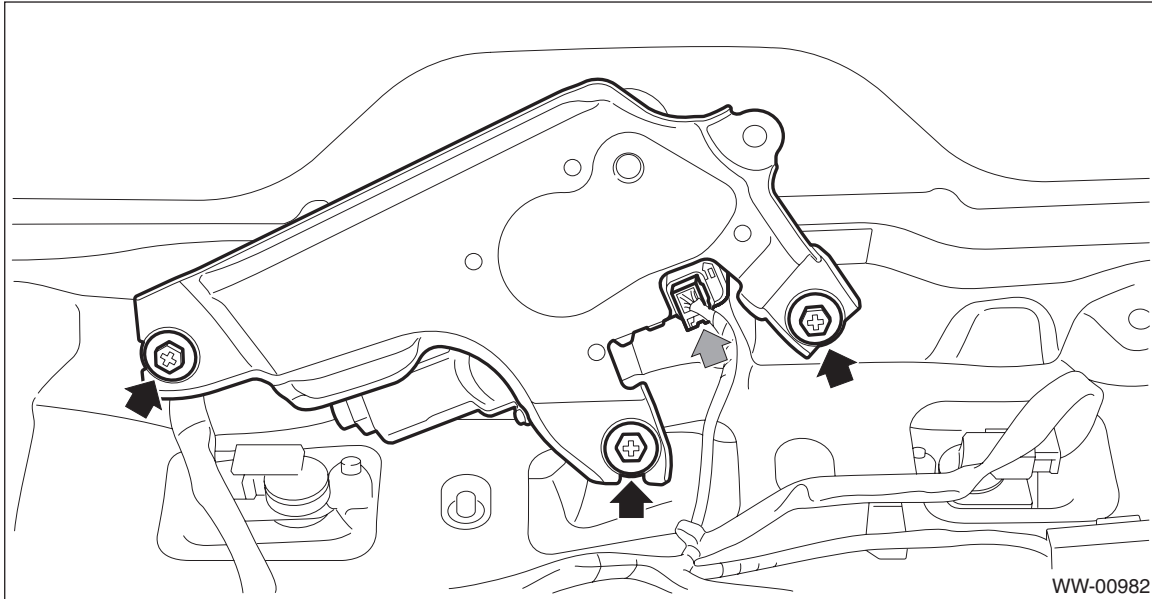

### B: INSTALLATION

- 1) Install each part in the reverse order of removal.

#### CAUTION:

For installation of the rod - power rear gate, refer to “INSTALLATION”, “Power Rear Gate Rod” in the “POWER REAR GATE” section and observe the precautions for installation. <Ref. to PRG-16, INSTALLATION, Power Rear Gate Rod.>

- 2) Check that the mark on the cap - pivot wiper faces up, as shown in the figure.

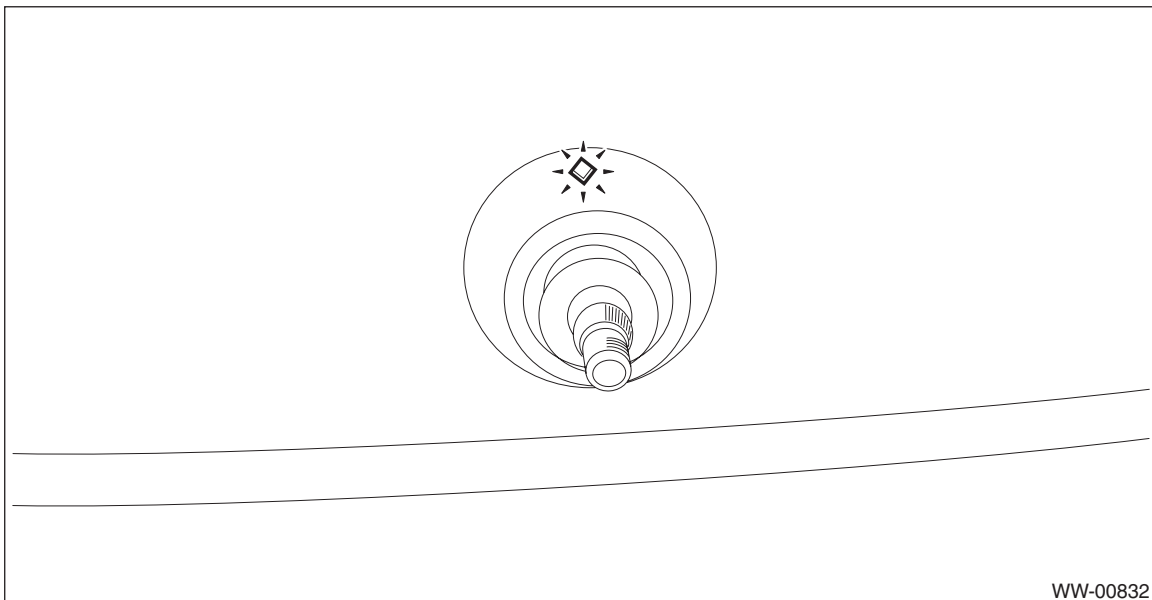

#### Tightening torque:

Refer to “COMPONENT” of “General Description”. <Ref. to WW-3, REAR WIPER, COMPONENT, General Description.>

# Rear Wiper Motor

## WIPER AND WASHER SYSTEMS

### C: INSPECTION

- 1) Connect the battery to the rear wiper motor connector, and check that the motor assembly - rear wiper operates.
- 2) Connect the battery to terminals of the connector, and remove the terminal connection with motor rotating, and stop the motor assembly - rear wiper in mid-operation.
- 3) Connect the battery and check that the motor stops at the automatic stop position after the motor operates at low speed again.

#### CAUTION:

**Fix the motor to prevent the motor from being shorted by moving during operation.**

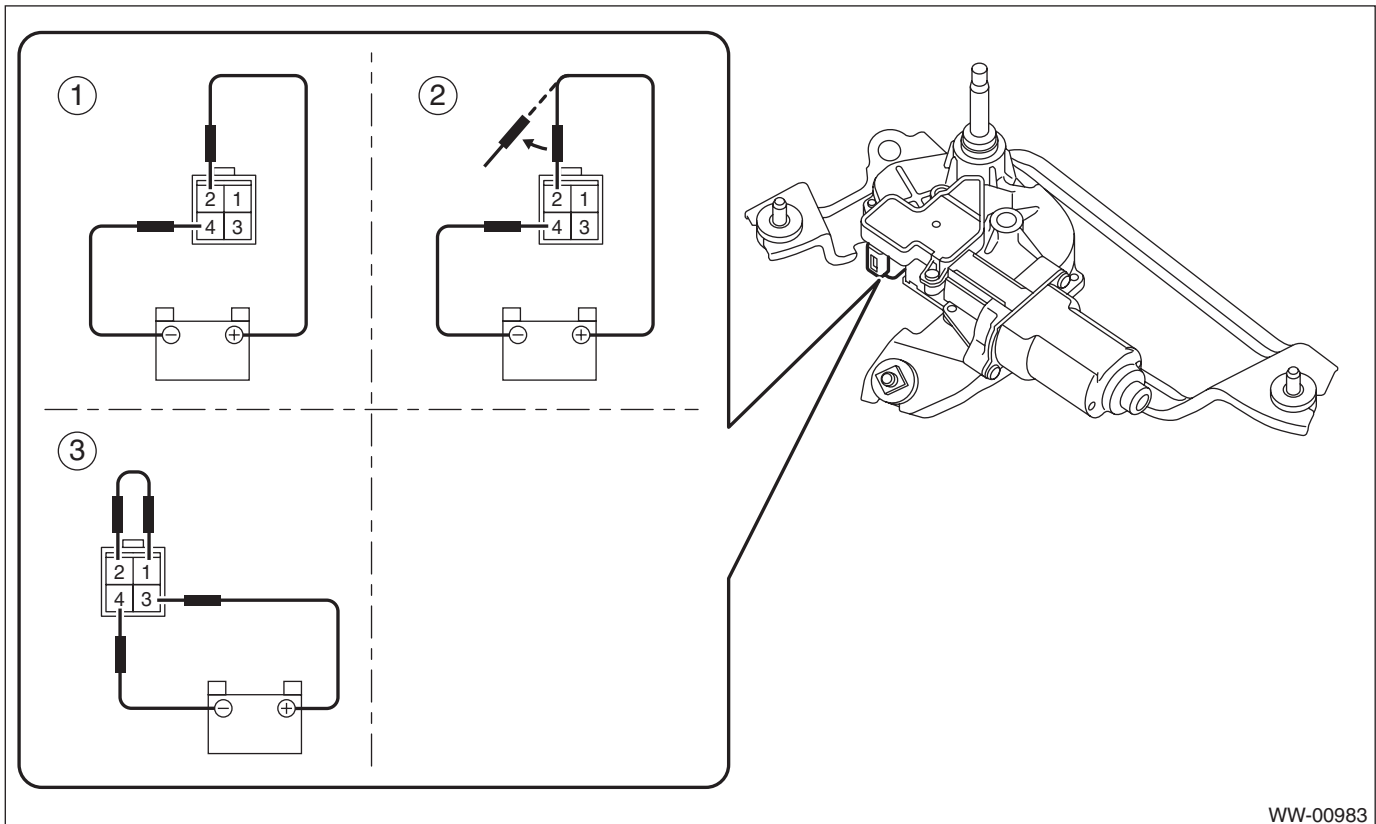

WW-00983