

6. Rear Seat Reclining System

A: REMOVAL

- 1) Disconnect the ground cable from battery.
- 2) Remove the rear seat. <Ref. to SE-34, REMOVAL, Rear Seat.>
- 3) Remove the trim panel - rear apron. <Ref. to EI-102, REMOVAL, Rear Quarter Trim.>
- 4) Remove the clips and bolts, then remove the striker - backrest rear.

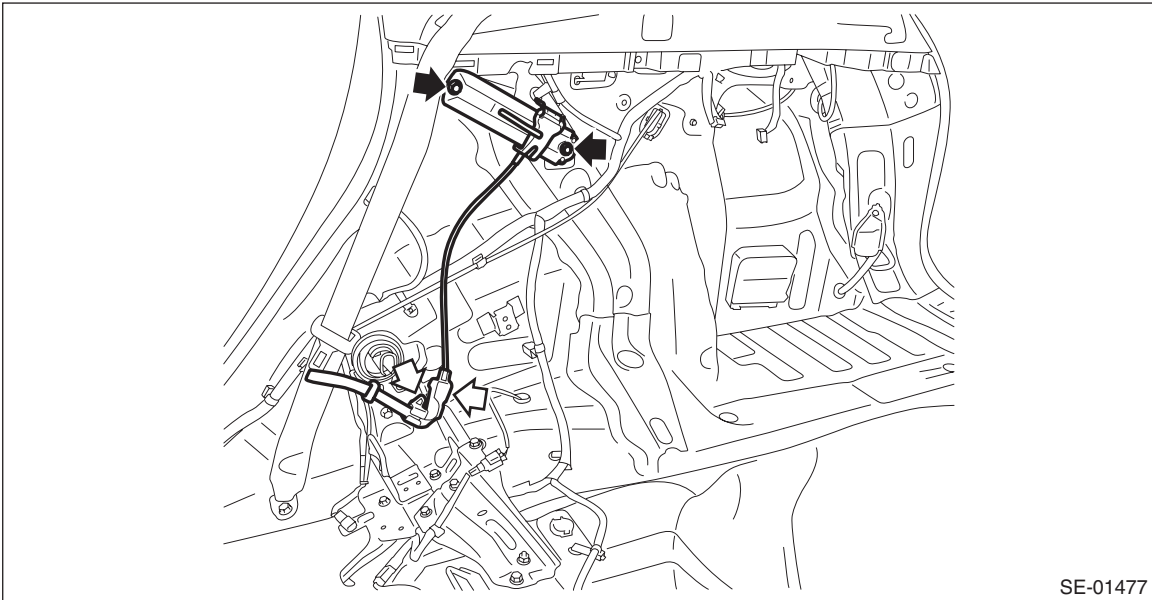

SE-01477

- 5) Remove the bolts and nuts, and remove the hinge assembly - rear backrest stay.

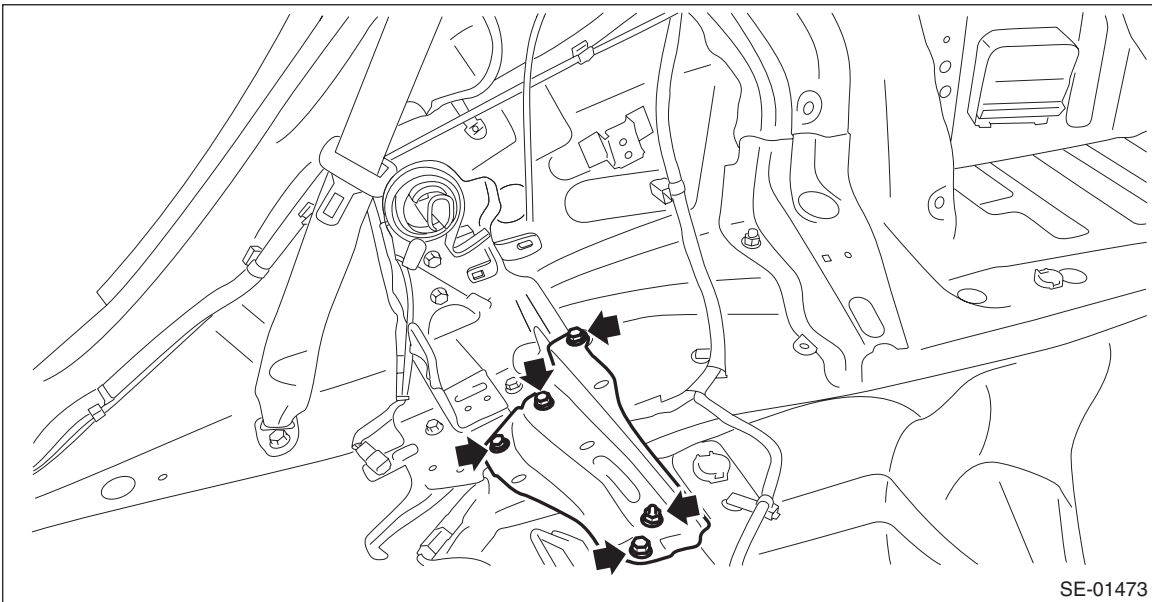

SE-01473

Rear Seat Reclining System

SEATS

6) Remove the bolts, and remove the hinge assembly - rear backrest.

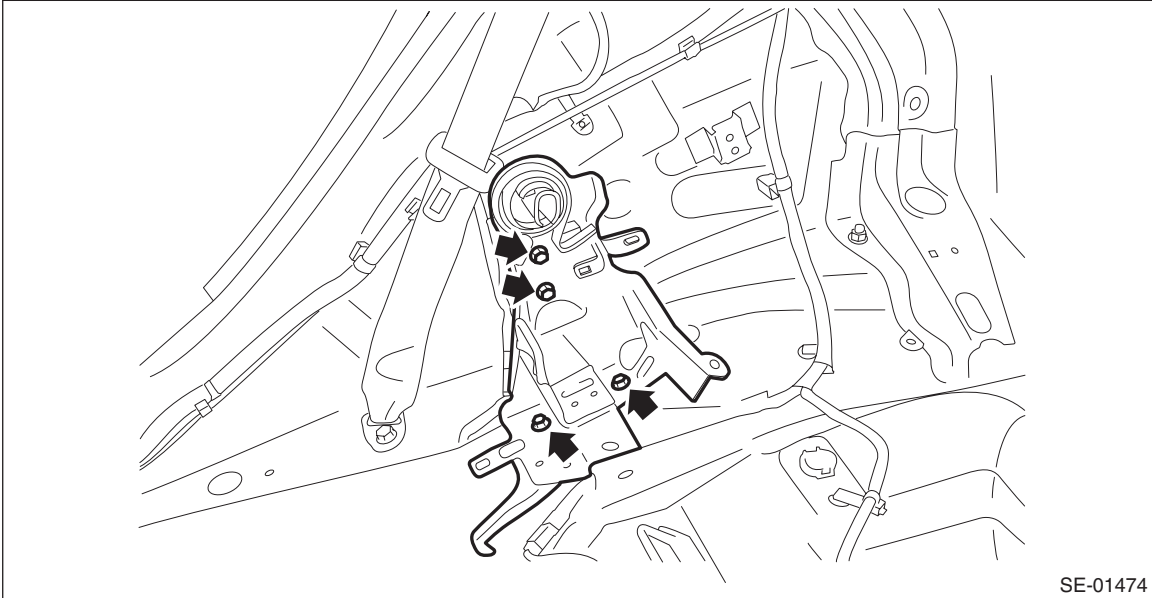

SE-01474

B: INSTALLATION

Install each part in the reverse order of removal.

NOTE:

To install the hinge assembly - rear backrest, follow the procedure below.

1. Temporarily tighten the bolt (1).
2. Tighten in the order of (2) → (3) → (4) → (1).

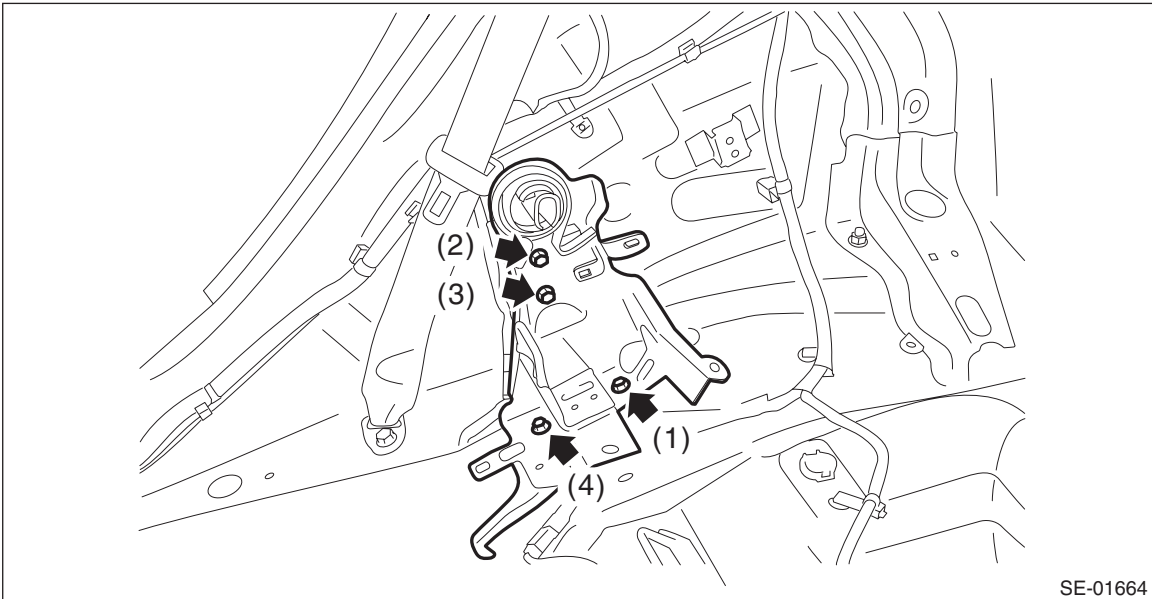

SE-01664

CAUTION:

When tightening the bolt (2), do not hold the hinge by hand. Doing so results in misalignment of the hinge installation position and may cause heavy lock force of rear seat back.

Tightening torque:

33 N·m (3.36 kgf-m, 24.3 ft-lb)