

6. Rear Seat Belt

A: REMOVAL

1. SEAT BELT OUTER - REAR RH & LH

CAUTION:

- Airbag system satellite safing sensor is located in the lower of the rear seat cushion center. Before removing the rear seat, refer to “CAUTION” of “General Description” in “AIRBAG SYSTEM” section.<Ref. to AB-9, CAUTION, General Description.>
- The airbag system is fitted with a backup power supply. After disconnecting the battery ground cable, the airbag may operate if you do not wait for 60 seconds before starting the service of airbag system.

- Do not drop or subject the pretensioner to any impact.
- Since the pretensioner and bracket are integrated as a unit, do not disassemble them.

- 1) Turn the ignition switch to OFF.
- 2) Disconnect the ground cable from battery and wait for at least 60 seconds before starting work.
- 3) Remove the rear seat cushion assembly.
 - (1) Push the corners of the rear seat cushion from above.
 - (2) While pushing the corners of the rear seat cushion from above, pull the knob of the hook - seat cushion rear towards yourself.
 - (3) While pulling the knob towards yourself, disconnect the hooks by lifting up the rear seat cushion.

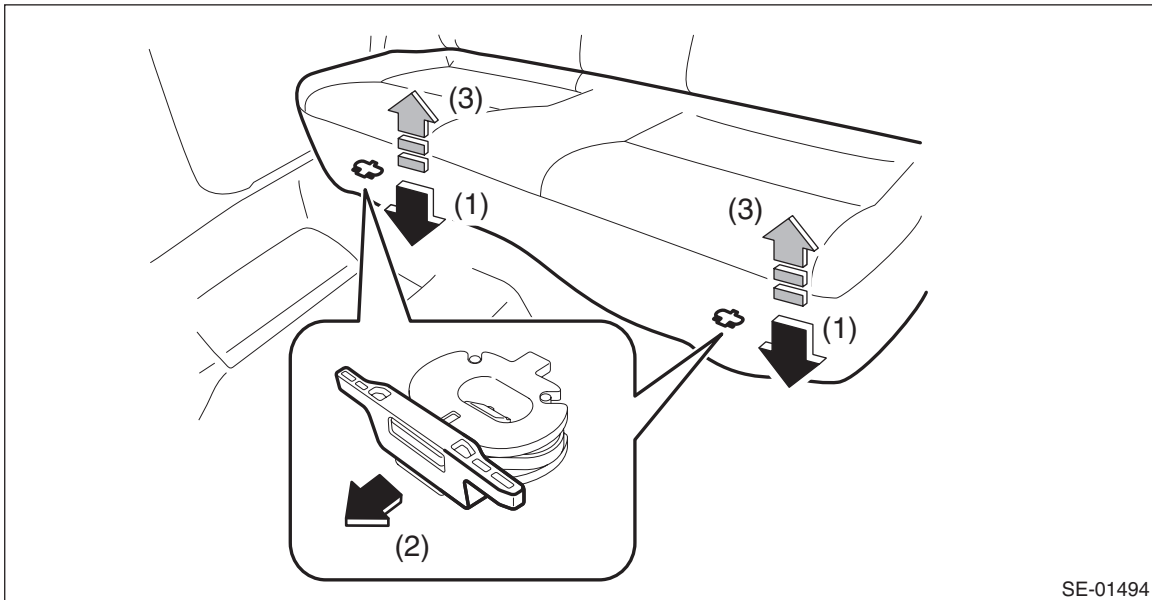

(4) Remove the hook (A) by pushing it back while lifting the front side of the rear seat cushion, and remove the rear seat cushion.

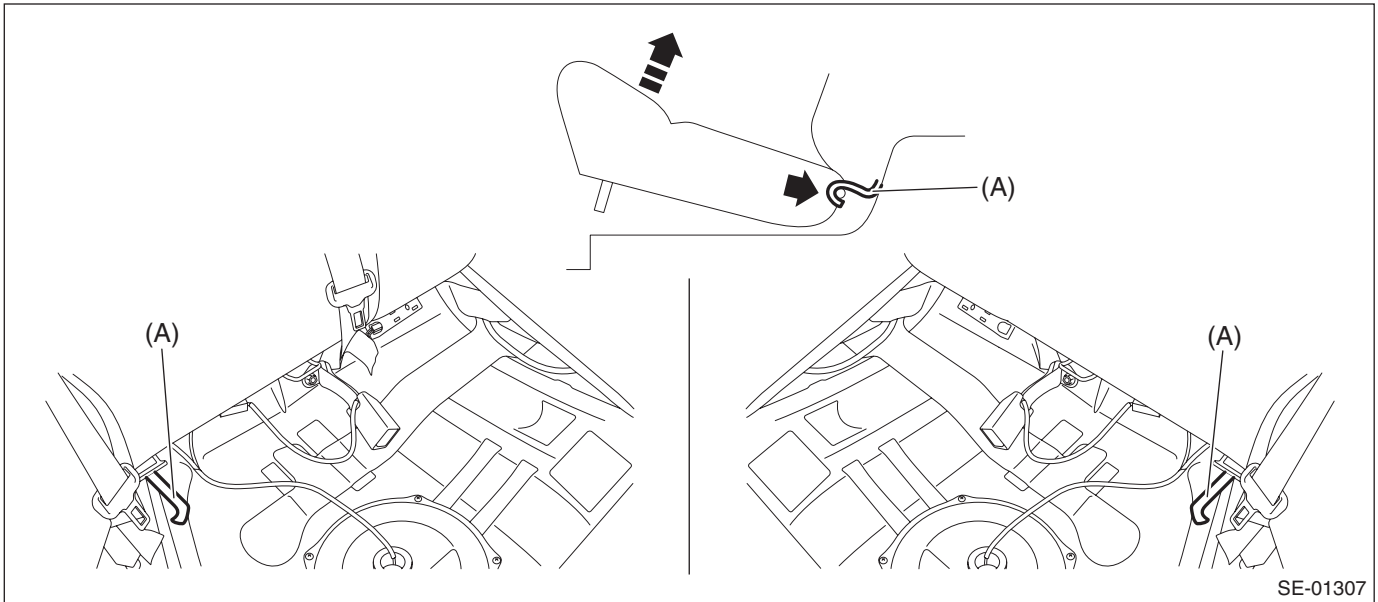

4) Release the clips and claws, and then remove the cover side sill - rear INN.

CAUTION:

Do not pull with excessive force. Doing so may damage the claws of the cover side sill - rear INN.

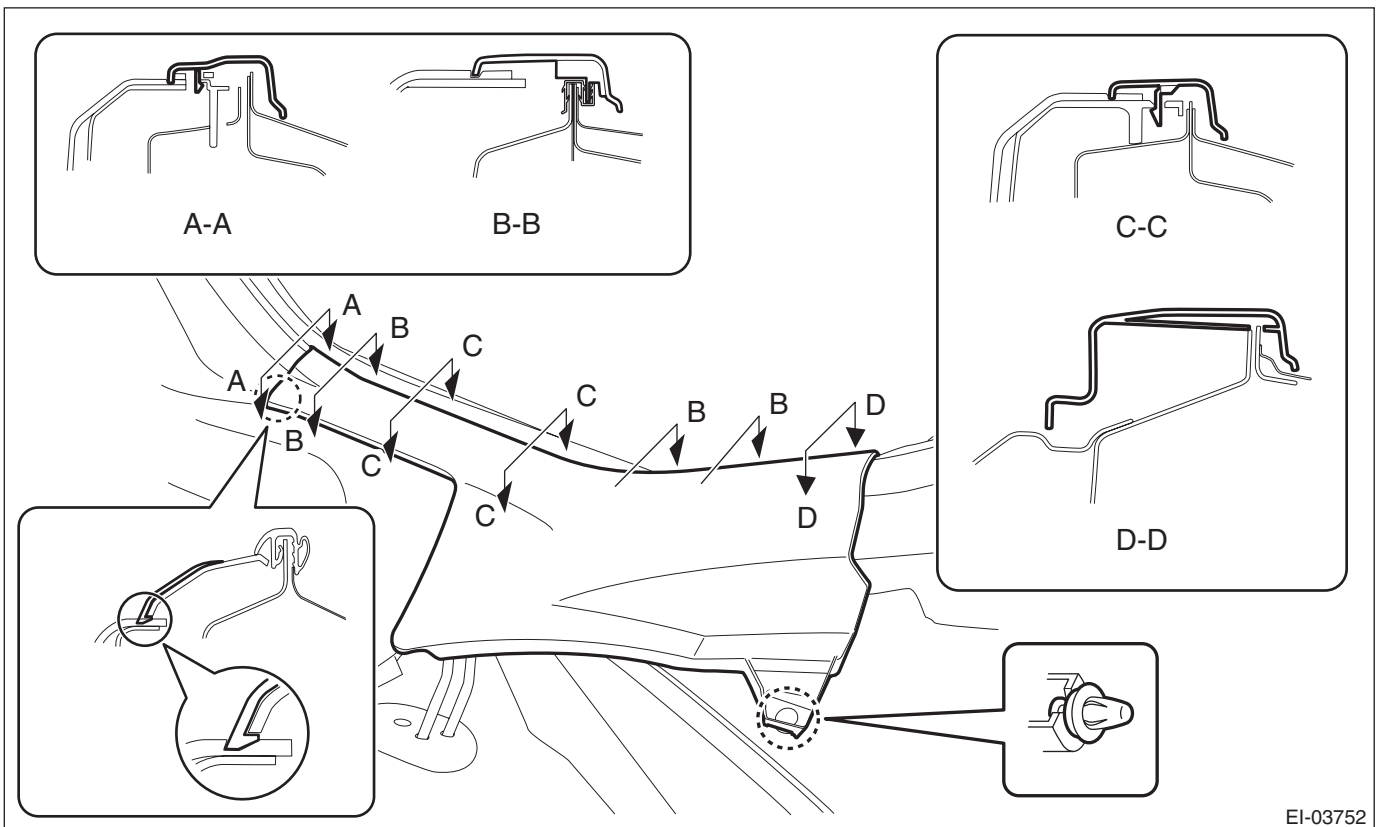

Rear Seat Belt

SEAT BELT SYSTEM

5) Remove the mat - rear floor, spacer - rear floor, and cover - trunk.

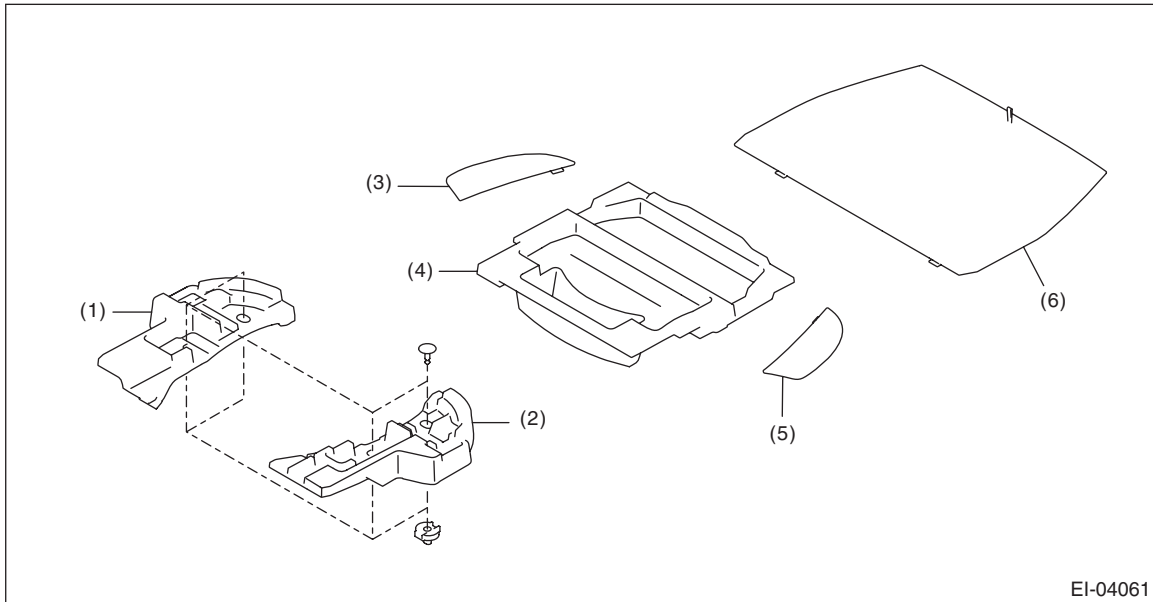

(1) Spacer - rear floor side RH

(3) Mat - rear floor RH

(5) Mat - rear floor LH

(2) Spacer - rear floor side LH

(4) Cover - trunk

(6) Mat - rear floor CTR

6) Remove the clips, and remove the trim panel - rear skirt.

CAUTION:

Do not lift the trim panel - rear skirt from the edge. Doing so may damage the part.

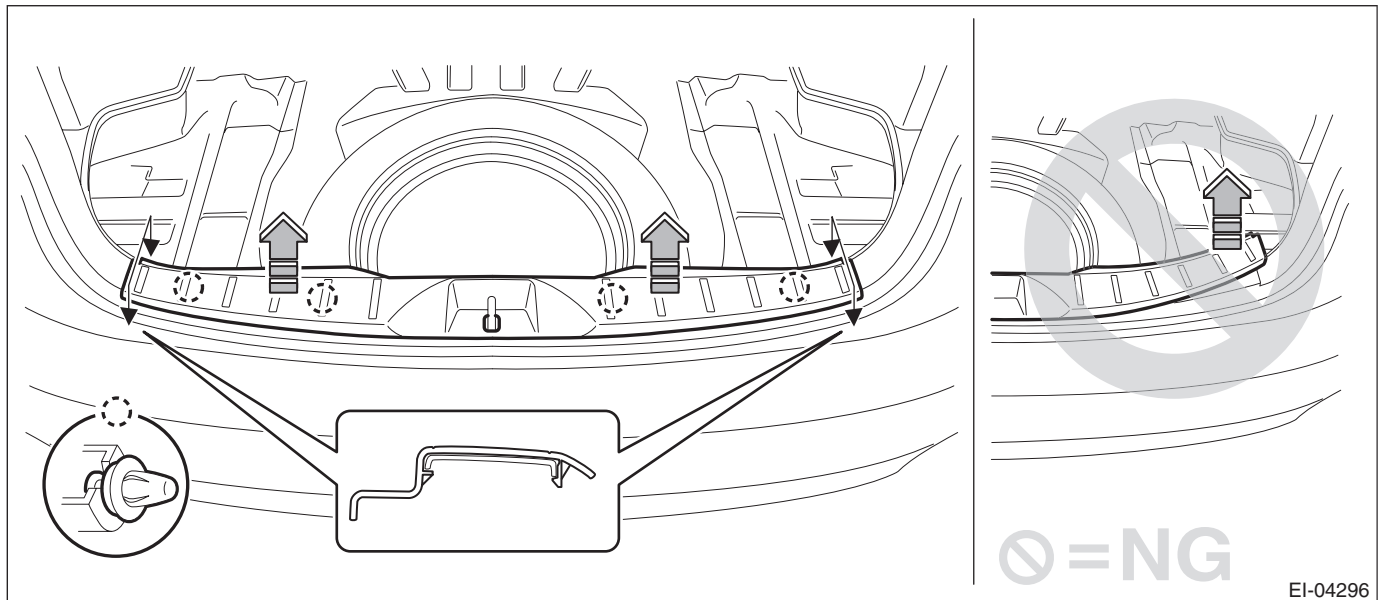

- 7) Remove the trim panel - rear apron.
- (1) Open the cover, remove the bolts, and remove the hook - luggage. (2 places)
 - (2) Remove the screws, and release the clips.
 - (3) Disconnect the connectors and remove the trim panel - rear apron.

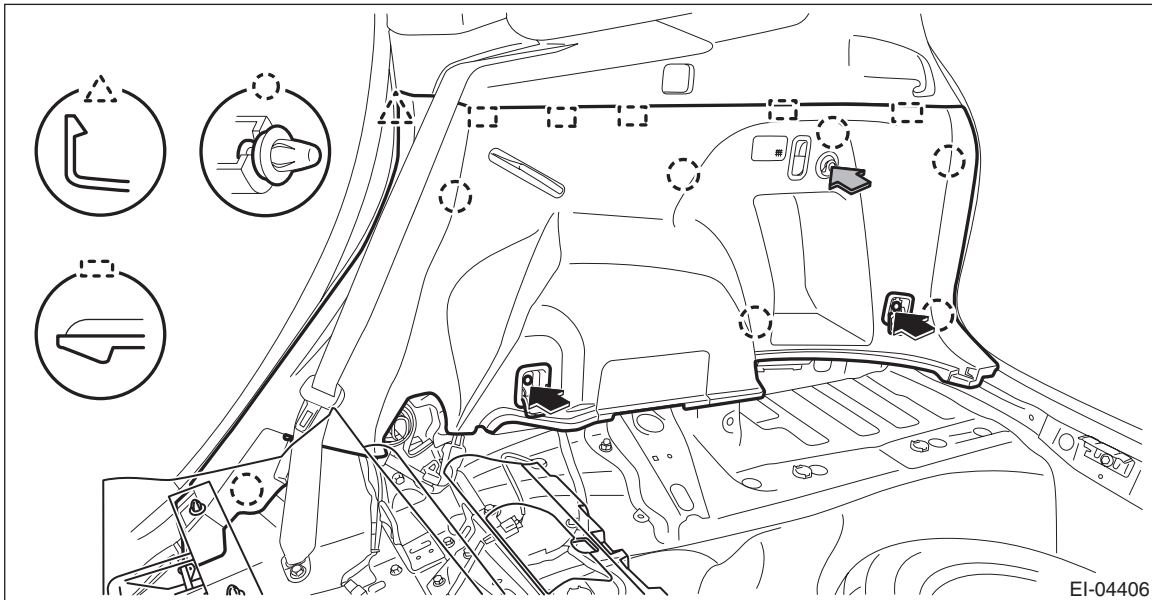

- 8) Remove the trim panel - rear quarter pillar UPR.
- (1) Disconnect the rod - power rear gate before removing the trim panel - rear quarter pillar UPR LH. (Only for models with power rear gate)

CAUTION:

For the disconnection procedure of the rod - power rear gate, refer to “REMOVAL”, “Power Rear Gate Rod” in the “POWER REAR GATE” section and observe the precautions for removal.<Ref. to PRG-15, REMOVAL, Power Rear Gate Rod.>

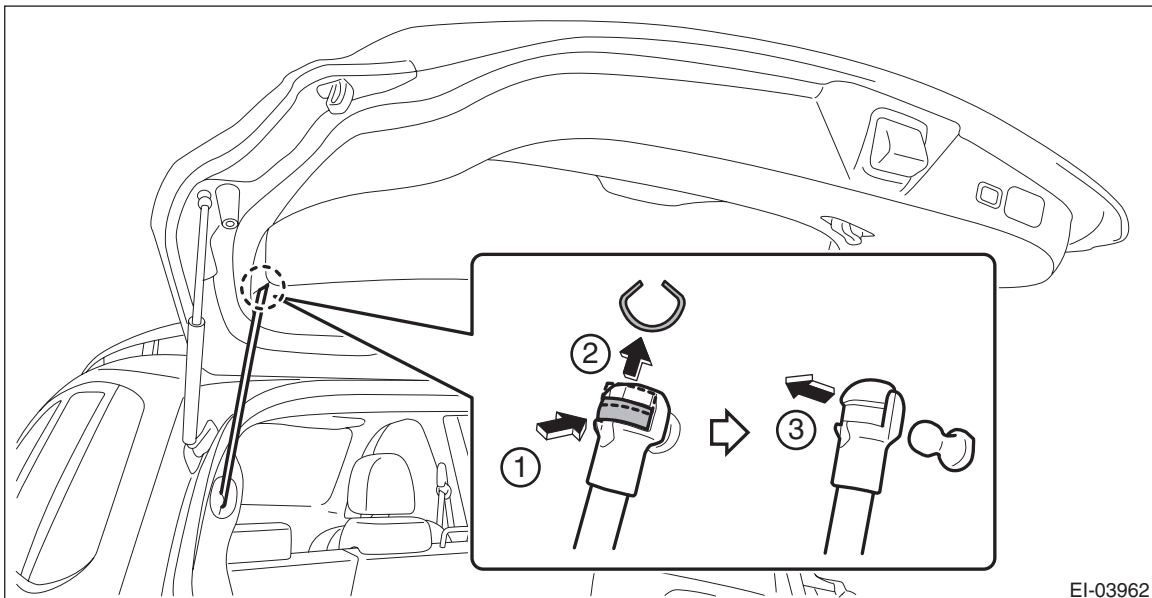

Rear Seat Belt

SEAT BELT SYSTEM

- (2) Remove the lower anchor bolts of rear seat belts.

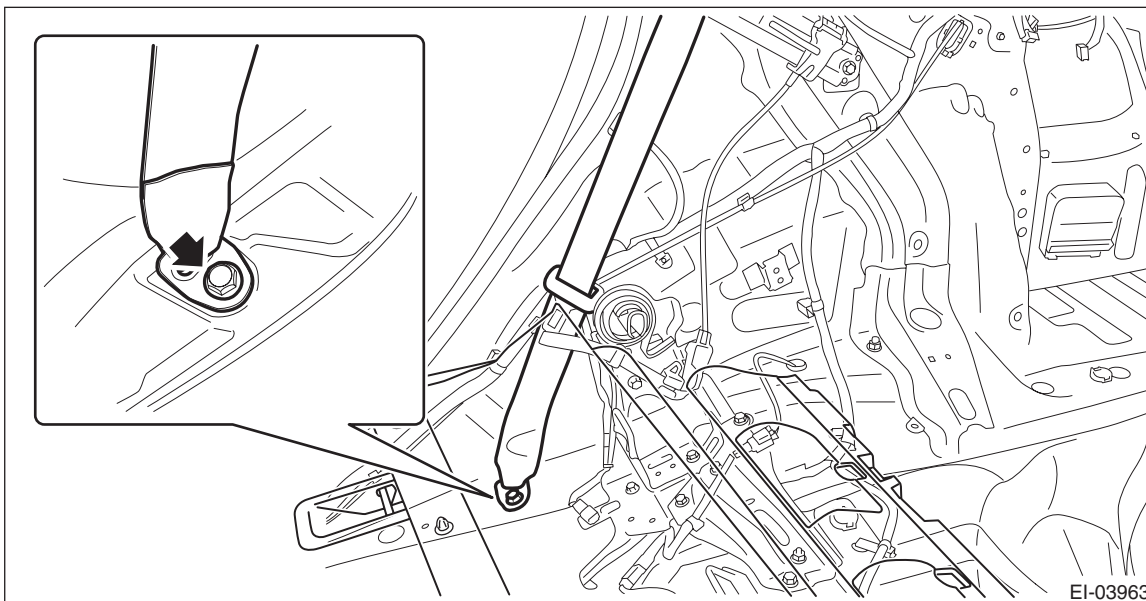

- (3) Remove the screws and clips, and remove the trim panel - rear quarter pillar UPR.

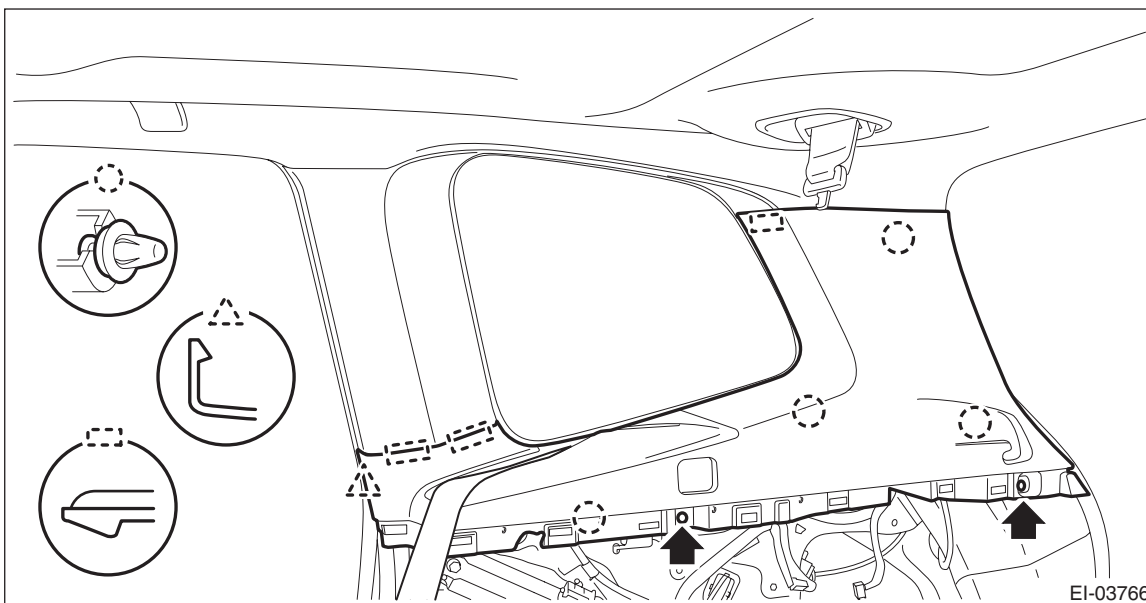

9) Remove the bolts, and remove the seat belt outer - rear.

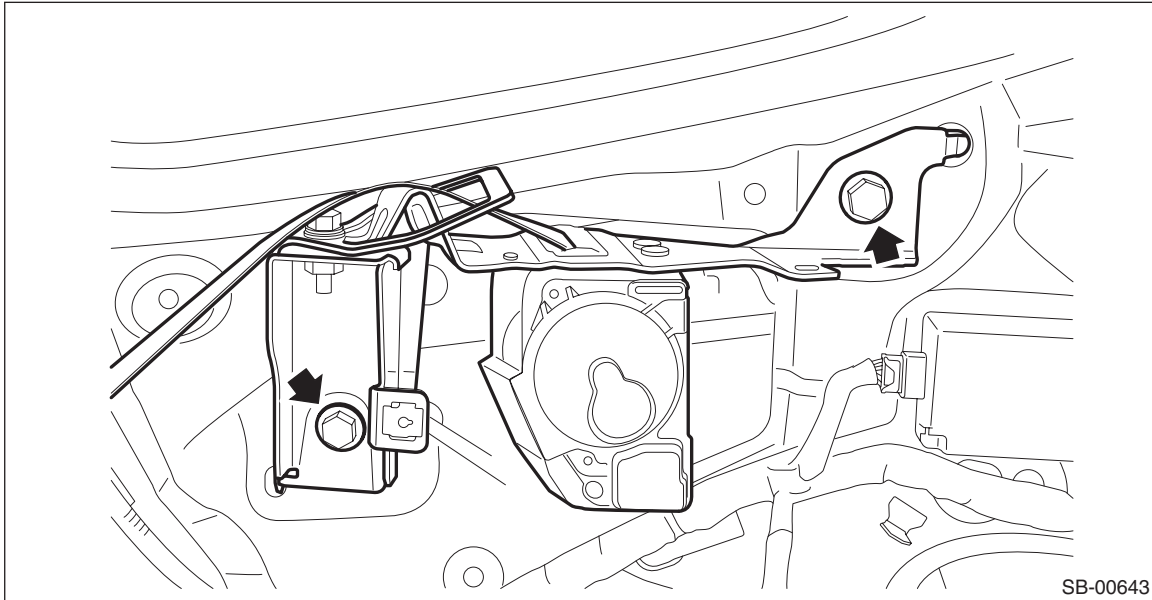

2. SEAT BELT - REAR SHOULDER CTR

CAUTION:

- Airbag system satellite safing sensor is located in the lower of the rear seat cushion center. Before removing the rear seat, refer to “CAUTION” of “General Description” in “AIRBAG SYSTEM” section.<Ref. to AB-9, CAUTION, General Description.>
- The airbag system is fitted with a backup power supply. After disconnecting the battery ground cable, the airbag may operate if you do not wait for 60 seconds before starting the service of airbag system.

- 1) Turn the ignition switch to OFF.
- 2) Disconnect the ground cable from battery and wait for at least 60 seconds before starting work.
- 3) Remove the trim panel - roof assembly.<Ref. to EI-109, REMOVAL, Roof Trim.>
- 4) Remove the bolts, and remove the seat belt - rear shoulder CTR.

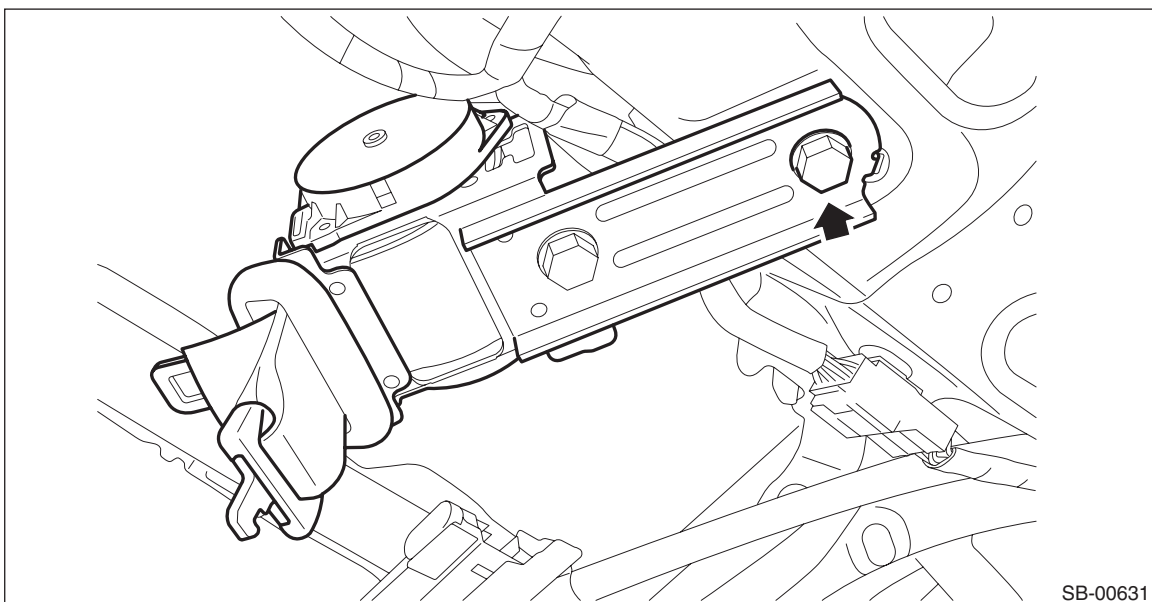

Rear Seat Belt

SEAT BELT SYSTEM

3. SEAT BELT - CTR RH AND LH

CAUTION:

- Airbag system satellite safing sensor is located in the lower of the rear seat cushion center. Before removing the rear seat, refer to “CAUTION” of “General Description” in “AIRBAG SYSTEM” section.<Ref. to AB-9, CAUTION, General Description.>

- The airbag system is fitted with a backup power supply. After disconnecting the battery ground cable, the airbag may operate if you do not wait for 60 seconds before starting the service of airbag system.

- 1) Turn the ignition switch to OFF.
- 2) Disconnect the ground cable from battery and wait for at least 60 seconds before starting work.
- 3) Remove the rear seat cushion assembly.
 - (1) Push the corners of the rear seat cushion from above.
 - (2) While pushing the corners of the rear seat cushion from above, pull the knob of the hook - seat cushion rear towards yourself.
 - (3) While pulling the knob towards yourself, disconnect the hooks by lifting up the rear seat cushion.

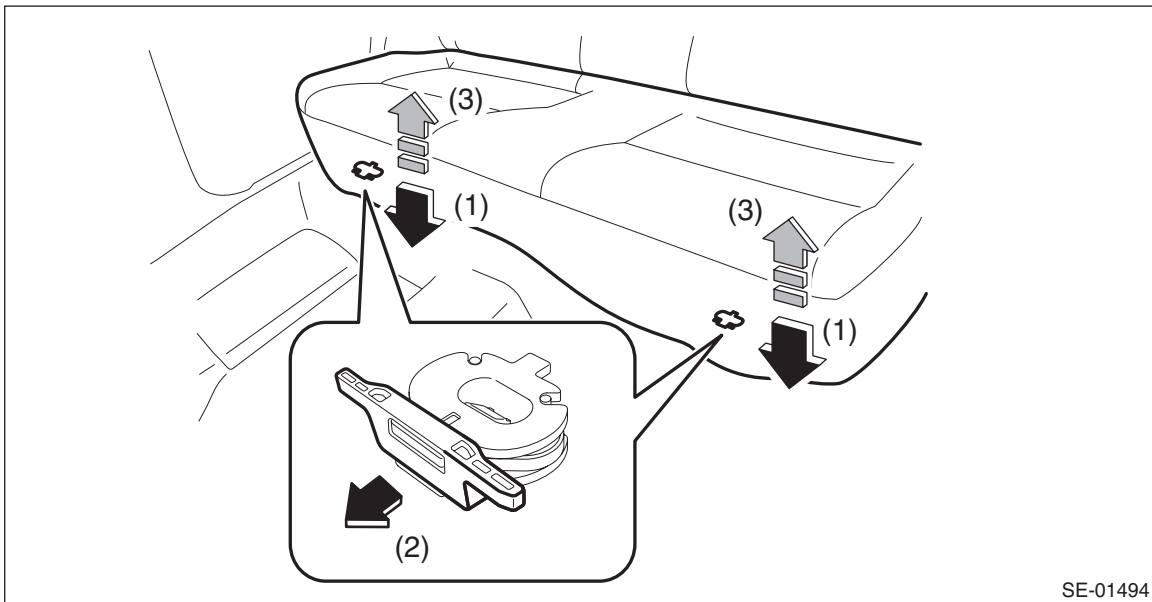

- (4) Remove the hook (A) by pushing it back while lifting the front side of the rear seat cushion, and remove the rear seat cushion.

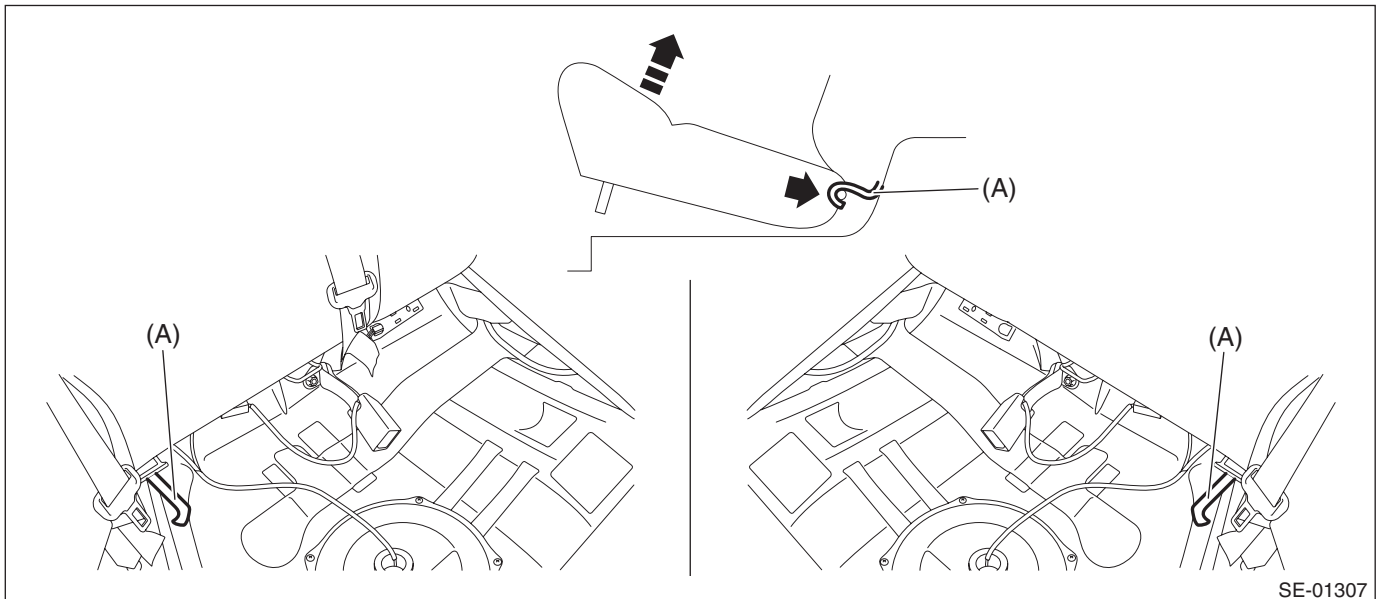

4) Remove the bolts, and remove the seat belt - CTR RH and LH.

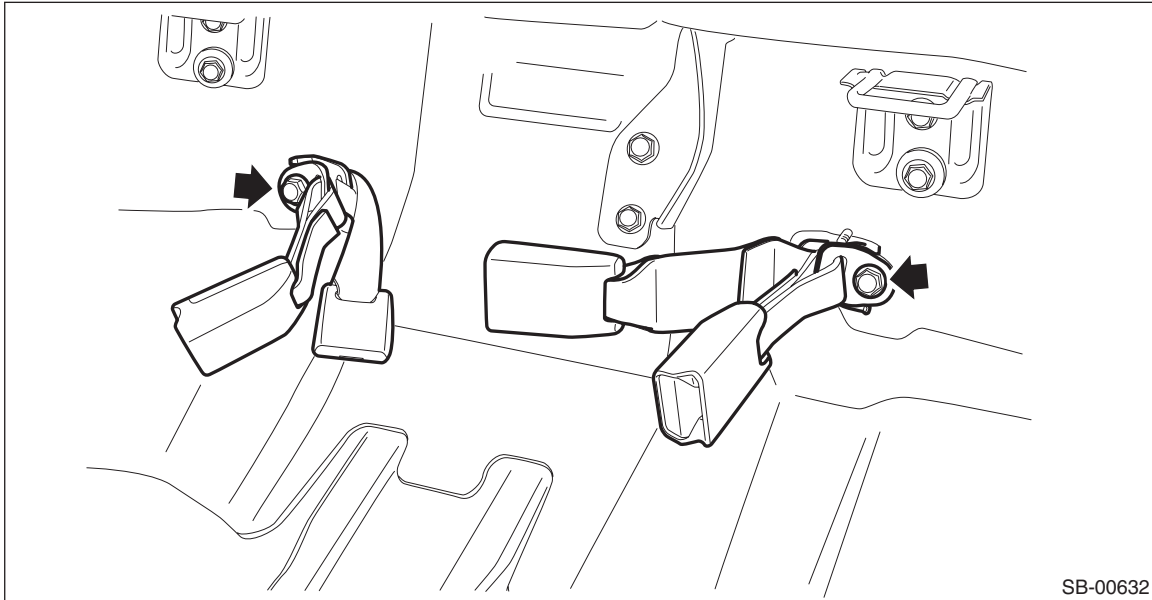

B: INSTALLATION

1. SEAT BELT OUTER - REAR RH & LH

- 1) Before installation, perform a unit inspection of retractor. <Ref. to SB-39, INSPECTION, Rear Seat Belt.>
- 2) Install the seat belt outer - rear.

CAUTION:

- During installation, make sure that the seat belts are not twisted.
- After installation, make sure that the seat belts are smoothly extended and wound.

Tightening torque:

Refer to “COMPONENT” of “General Description”. <Ref. to SB-3, REAR SEAT BELT, COMPONENT, General Description.>

- 3) Install the trim panel - rear quarter trim UPR.
- 4) Install the remaining parts in the reverse order of removal.
- 5) After installation, check the following points.
 - The seat belt is not twisted.
 - The seat belt can be pulled out and retracted smoothly.

Rear Seat Belt

SEAT BELT SYSTEM

2. SEAT BELT - REAR SHOULDER CTR

1) Install the seat belt - rear shoulder CTR.

Tightening torque:

Refer to “COMPONENT” of “General Description”. <Ref. to SB-3, REAR SEAT BELT, COMPONENT, General Description.>

2) Install the remaining parts in the reverse order of removal.

CAUTION:

- For installation of the stereo camera cover, refer to “INSTALLATION”, “Stereo Camera Cover” in the “EyeSight” section and observe the precautions for installation. <Ref. to ES-15, INSTALLATION, Stereo Camera.>
- For installation of the rod - power rear gate, refer to “INSTALLATION”, “Power Rear Gate Rod” in the “POWER REAR GATE” section and observe the precautions for installation. <Ref. to PRG-16, INSTALLATION, Power Rear Gate Rod.>
- Check that there is no damage to the tether clip on the upper part of the trim panel - front pillar UPR. If the tether clip is damaged, always replace it with a new tether clip.
- Do not reuse the tether clip removed from the upper part of the trim panel - front pillar UPR. Always replace with a new part.
- Do not reuse the upper clips of the trim panel - center pillar UPR. Once the clip is removed, its holding force is reduced. Be sure to replace it with a new clip.
- Before installing the trim panel - front pillar UPR, check the condition of protective non-woven fabric (white) of the curtain airbag. If it is damaged (airbag module cloth is exposed), replace the curtain airbag module assembly with a new part.

NOTE:

For installation of the trim panel - front pillar UPR, refer to “Upper Inner Trim”. <Ref. to EI-101, INSTALLATION, Upper Inner Trim.>

3) After installation, check the following points.

- The seat belt is not twisted.
- The seat belt can be pulled out and retracted smoothly.

3. SEAT BELT - CTR RH AND LH

1) Install the seat belt - CTR RH/LH.

Tightening torque:

Refer to “COMPONENT” of “General Description”. <Ref. to SB-3, REAR SEAT BELT, COMPONENT, General Description.>

2) Install the rear seat cushion.

3) Install the remaining parts in the reverse order of removal.

4) After installation, check the following points.

- The seat belt is not twisted.
- Check that the airbag warning light lights up for approximately 6 seconds and then turns off when connecting the battery ground cable and turning the ignition switch to ON.

C: INSPECTION

1. VISUAL INSPECTION

Check for the following, and replace with new parts if necessary.

- Seat belt is slackened, bent or worn.
- Seat belt is abnormally wound or extended.
- Seat belt inner - rear is deformed or damaged.
- Seat belt buckle cannot be engaged properly.

2. ELR LOCK MECHANISM INSPECTION

- 1) Hold the retractor in horizontal position (as installed in the vehicle) and check the ELR lock mechanism.
- 2) Tilt the retractor from the horizontal position and make sure it does not lock within the tilting angle of 15° or less.

- Seat belt outer - rear RH & LH

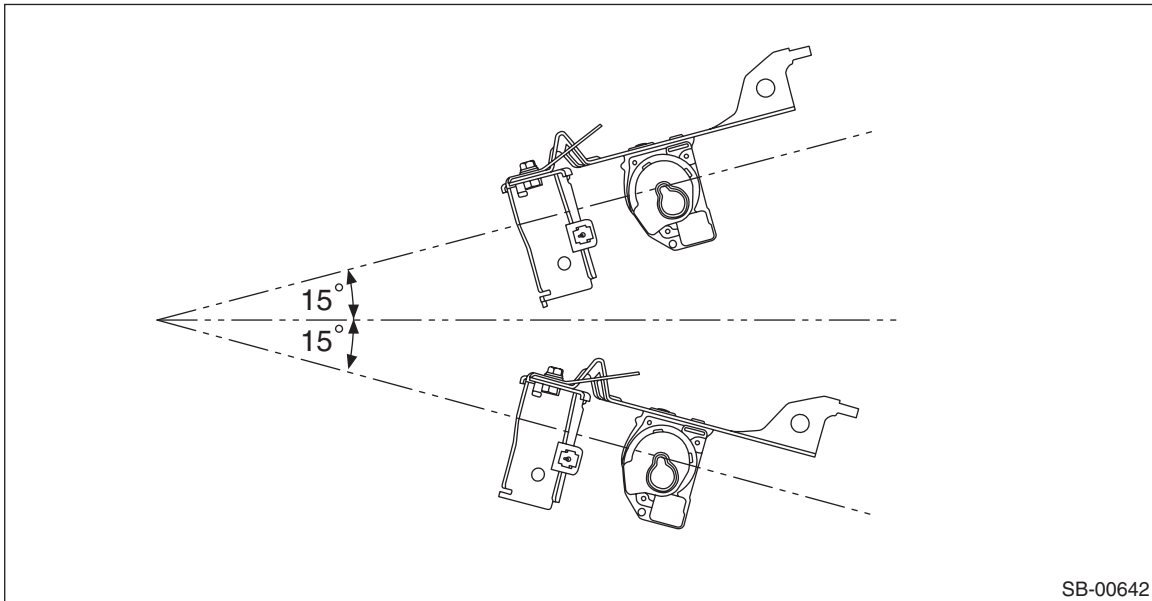

- Seat belt - rear shoulder CTR

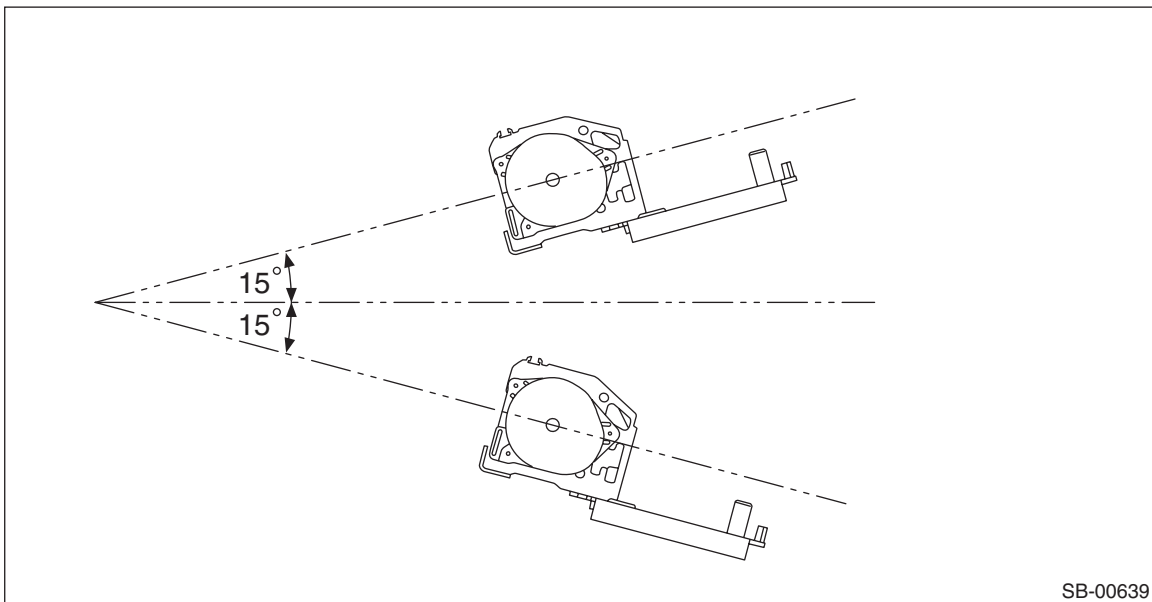

- 3) If the ELR lock mechanism does not operate properly, replace the seat belt outer - rear with a new part.