

6. Power Rear Gate Rod

A: REMOVAL

- 1) Disconnect the ground cable from battery.
- 2) Remove the rod - power rear gate.
 - (1) Disconnect the upper part of the rod - power rear gate from the rear gate.

CAUTION:

Using a small flat tip screwdriver wrapped with protective tape, remove the part by gradually applying force. Forcibly removing the part may deform the stop ring.

1. Press the rod against the ball stud bolt.
2. With the rod pressed, remove the stop ring while sliding along the ball housing groove.
3. Disconnect the rod from ball stud bolt.

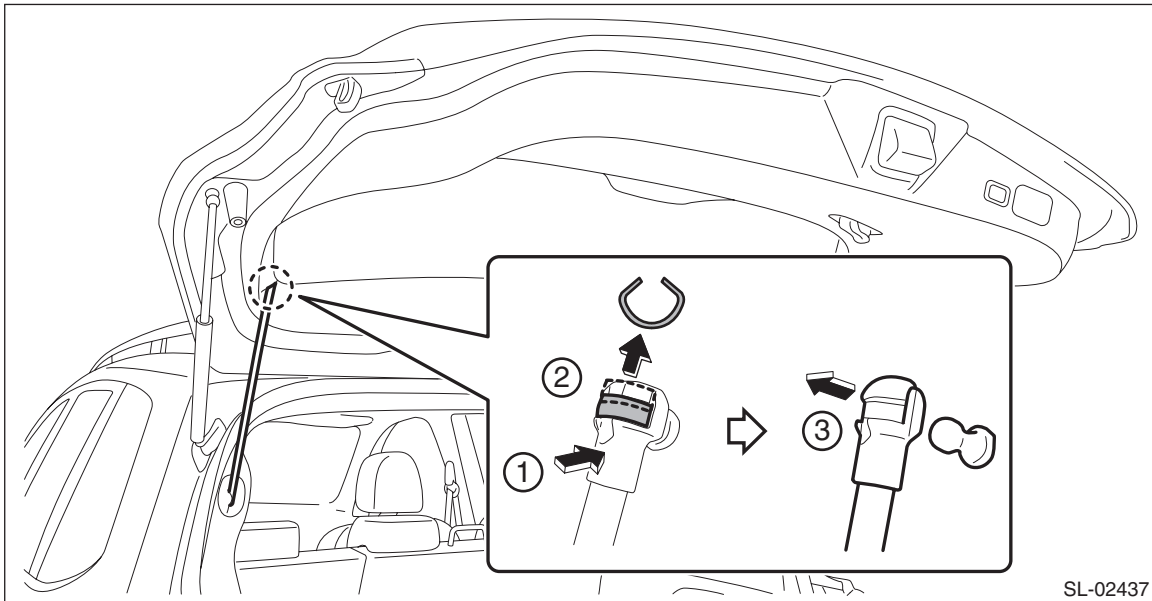

SL-02437

- (2) Release the claws and then remove the cap - rear quarter pillar UPR.

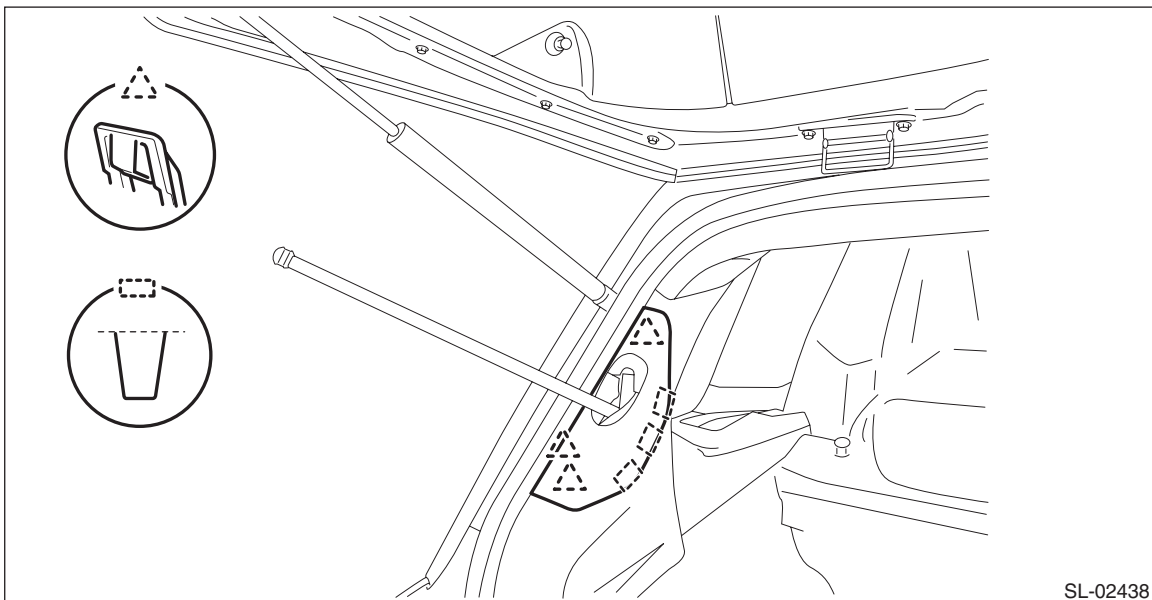

SL-02438

- (3) Disconnect the lower part of the rod - power rear gate from the power rear gate drive unit (PRG D/U), and then remove the rod - power rear gate.

NOTE:

Perform the same procedures as for the upper part of rod - power rear gate.

Power Rear Gate Rod

POWER REAR GATE SYSTEM

B: INSTALLATION

1) Install the stop ring to the rod - power rear gate.

CAUTION:

Align the stop ring to the ball housing groove, and attach the ring by gradually applying force, while paying attention not to deform it.

2) With the stop ring installed, check the clearance (a) of the stop ring.

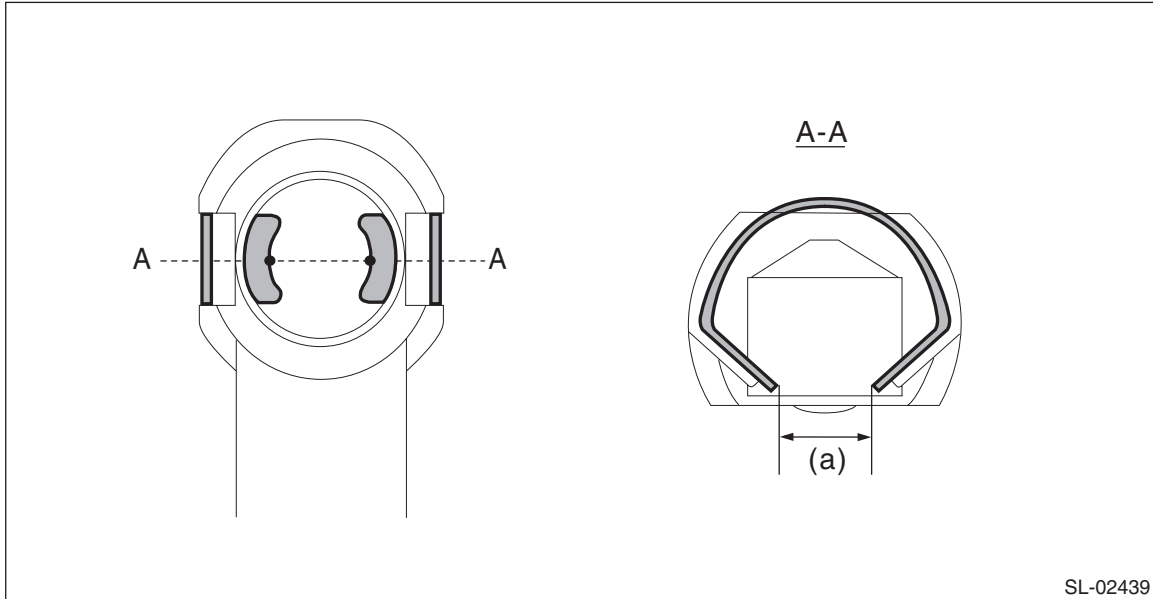

Specification:

6.4 — 7.2 mm (0.25 — 0.28 in)

Replace the stop ring if the inspection result is not within the standard value.

3) Install each part in the reverse order of removal.

CAUTION:

When installing the rod, check that the stop ring and ball stud bolt are vertically placed, and then slowly press in the rod.

C: INSPECTION

1) Check the ball housing and ball stud bolt of the rod - power rear gate for abnormal play, wear or bent.

2) Replace the rod - power rear gate if defective.