

## 34. Door Step Light

### A: REMOVAL

- 1) Disconnect the ground cable from battery.
- 2) Remove the door step light.

#### CAUTION:

**When using a flat tip screwdriver, apply protective tape or cloth and be careful not to cause damage.**

- (1) Insert a flat tip screwdriver into the slit of the door step light to release the claw.
- (2) Disconnect the connector and remove the door step light.

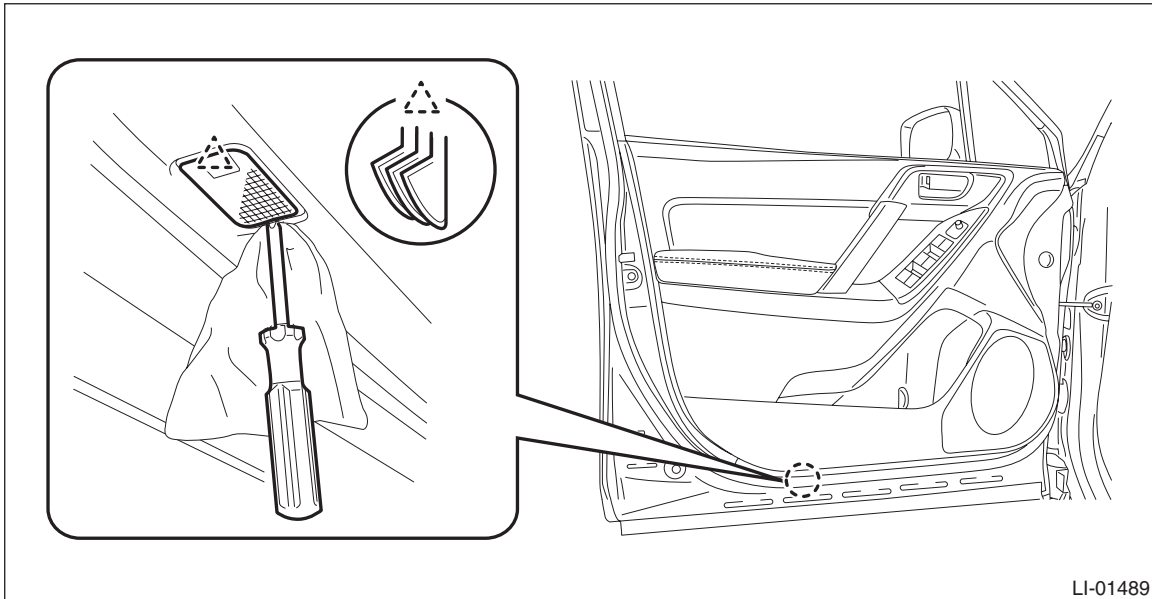

### B: INSTALLATION

Install each part in the reverse order of removal.

### C: INSPECTION

- 1) Visually check the bulb for blow out.
- 2) Check the bulb specification. <Ref. to LI-2, SPECIFICATION, General Description.>
- 3) Replace the bulb if it is found defective.