

11.Steering Switch

A: REMOVAL

- 1) Position the front wheels straight ahead. (After moving a vehicle 5 m (16 ft) or more with front wheels positioned straight ahead, make sure that the vehicle moves straight ahead.)
- 2) Turn the ignition switch to OFF.
- 3) Disconnect the ground cable from battery and wait for at least 60 seconds before starting work.
- 4) Remove the driver's airbag module.

CAUTION:

Before handling the airbag module, refer to “CAUTION” of “General Description” in “AIRBAG SYSTEM”.<Ref. to AB-9, CAUTION, General Description.>

- (1) Using a hexagon wrench etc. wrapped by protective tape, insert the snap pins and release the locks (3 locations).

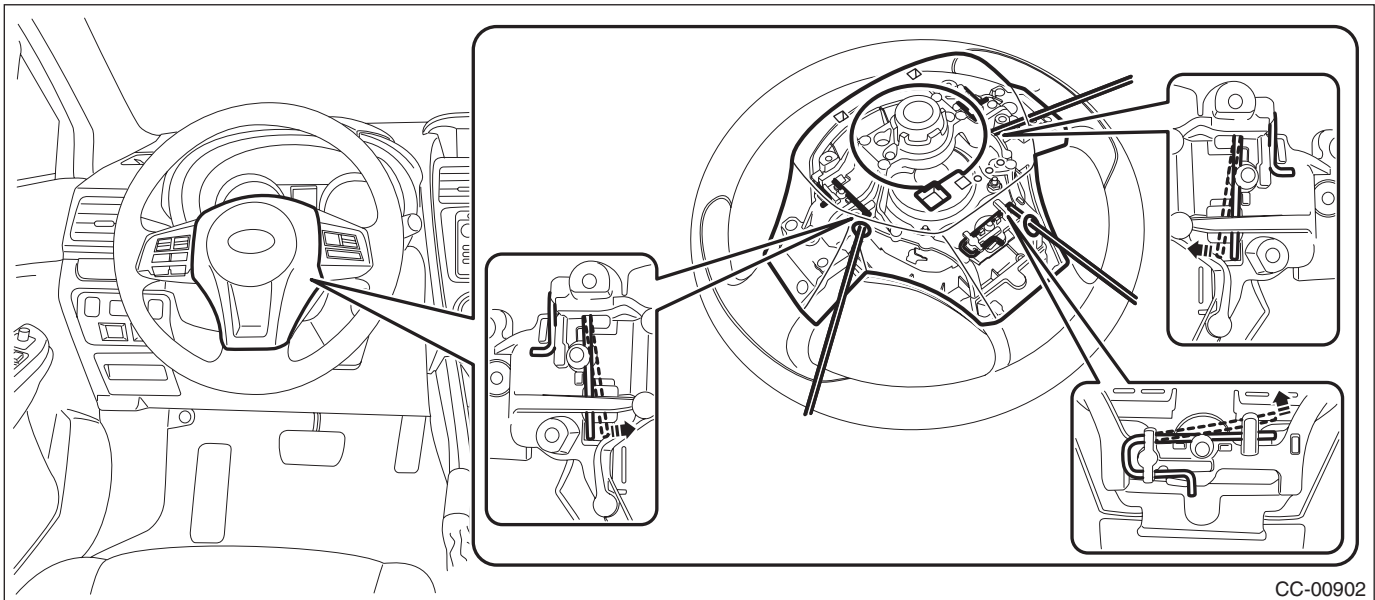

- (2) Disconnect the horn harness and airbag connector, and remove the driver's airbag module.<Ref. to AB-19, PROCEDURE, Airbag Connector.>

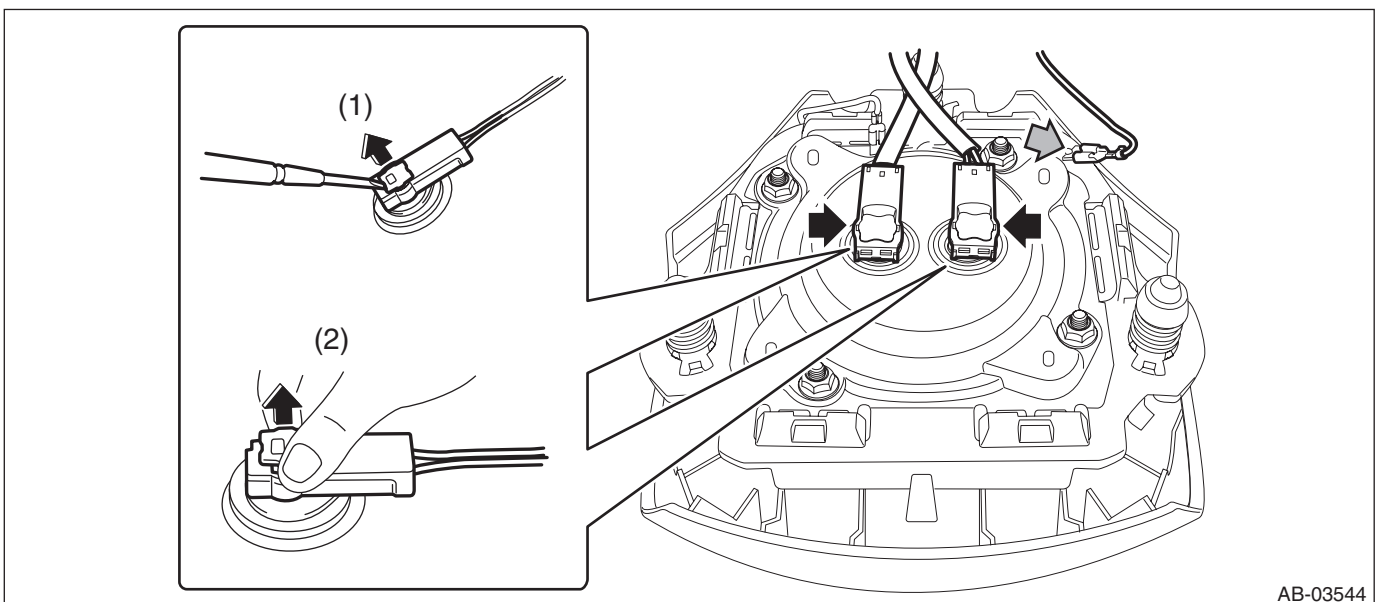

5) Remove the steering wheel.

CAUTION:

- Always use the steering wheel puller for removal to avoid deforming the steering wheel.
- If the steering wheel has been removed, make sure that the roll connector is not turned from the original position.

- (1) Disconnect the connector and remove the nut.
- (2) Put alignment marks and remove the steering wheel using a steering wheel puller.

Preparation tool:

Steering wheel puller

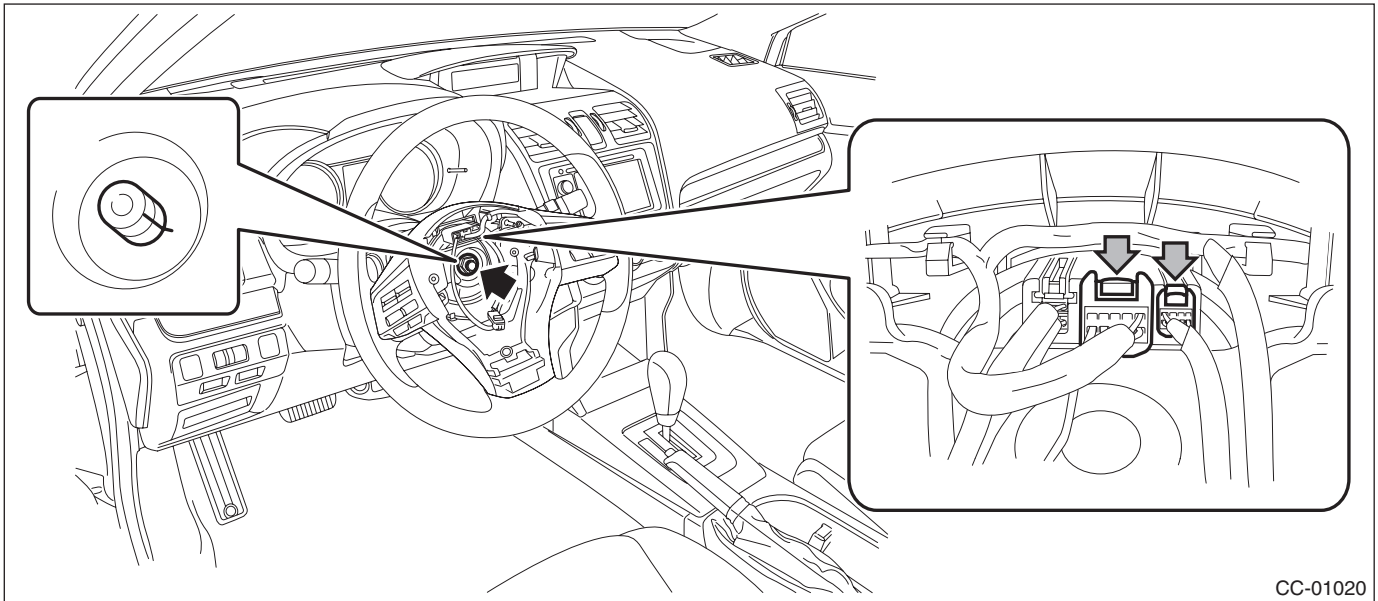

6) Remove the switch assembly - steering.

- (1) Remove the screw, disconnect the connector and remove the paddle shift switch. (Model with paddle shift)

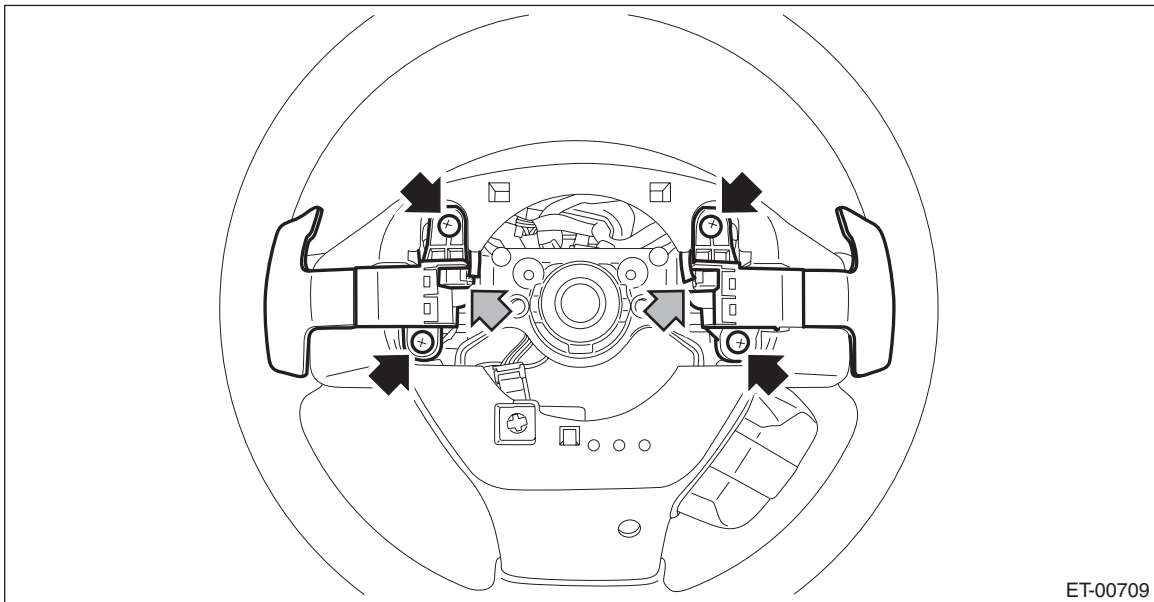

- (2) Remove the connector and screw.

Steering Switch

INSTRUMENTATION/DRIVER INFO

- (3) Release the claws and clips, detach the cover - steering wheel LWR.

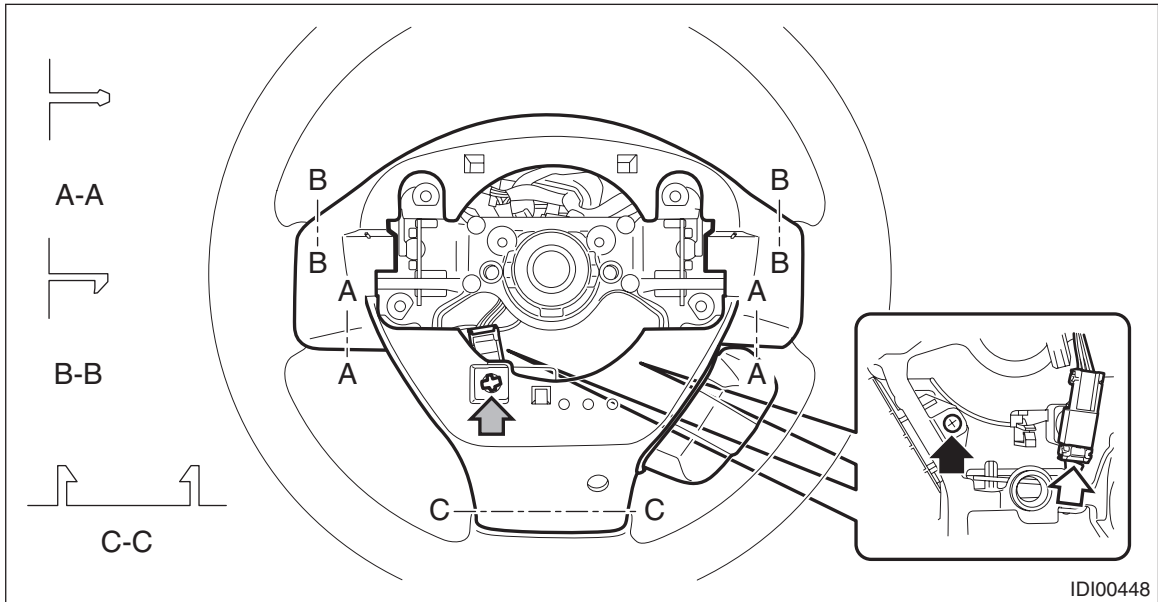

- (4) Remove the switch assembly - steering from the cover - steering wheel LWR.

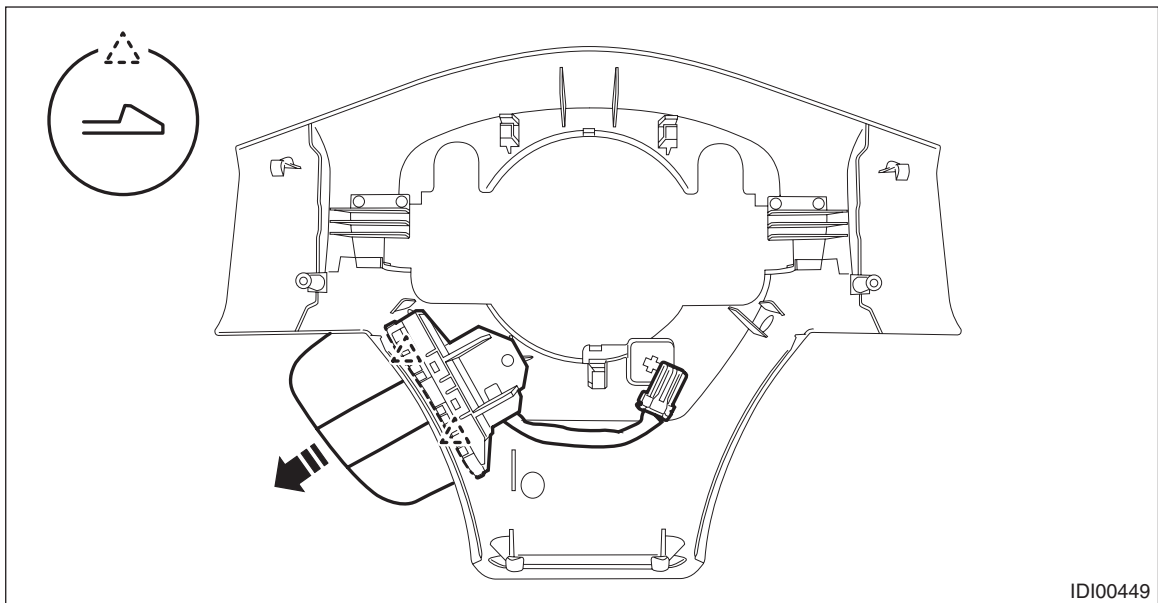

B: INSTALLATION

CAUTION:

- Before handling the airbag module, refer to “CAUTION” of “General Description” in “AIRBAG SYSTEM”.<Ref. to AB-9, CAUTION, General Description.>
- Do not allow harness and connectors to interfere or get tangled up with other parts.
- If the steering wheel and steering angle sensor (steering roll connector) are removed, adjust the steering angle sensor.<Ref. to VDC-23, ADJUSTMENT, VDC Control Module and Hydraulic Control Unit (VDCCM&H/U).>
- Securely install the switch. Improper insertion of the pin or claw of the switch may cause improper installation.

1) Before installing steering wheel, be sure to adjust the direction of steering roll connector with steering wheel.<Ref. to AB-107, ADJUSTMENT, Roll Connector.>

2) Install each part in the reverse order of removal.

NOTE:

Align the alignment marks on the steering wheel and the column assembly - steering.

Tightening torque:

Steering wheel: 39 N·m (3.98 kgf·m, 28.8 ft·lb)

Clearance:

Between cover assembly - column and steering wheel: 4 — 6 mm (0.16 — 0.24 in)

C: INSPECTION

UNIT INSPECTION

Preparation tool:

Circuit tester

1) Check the resistance between switch terminals.

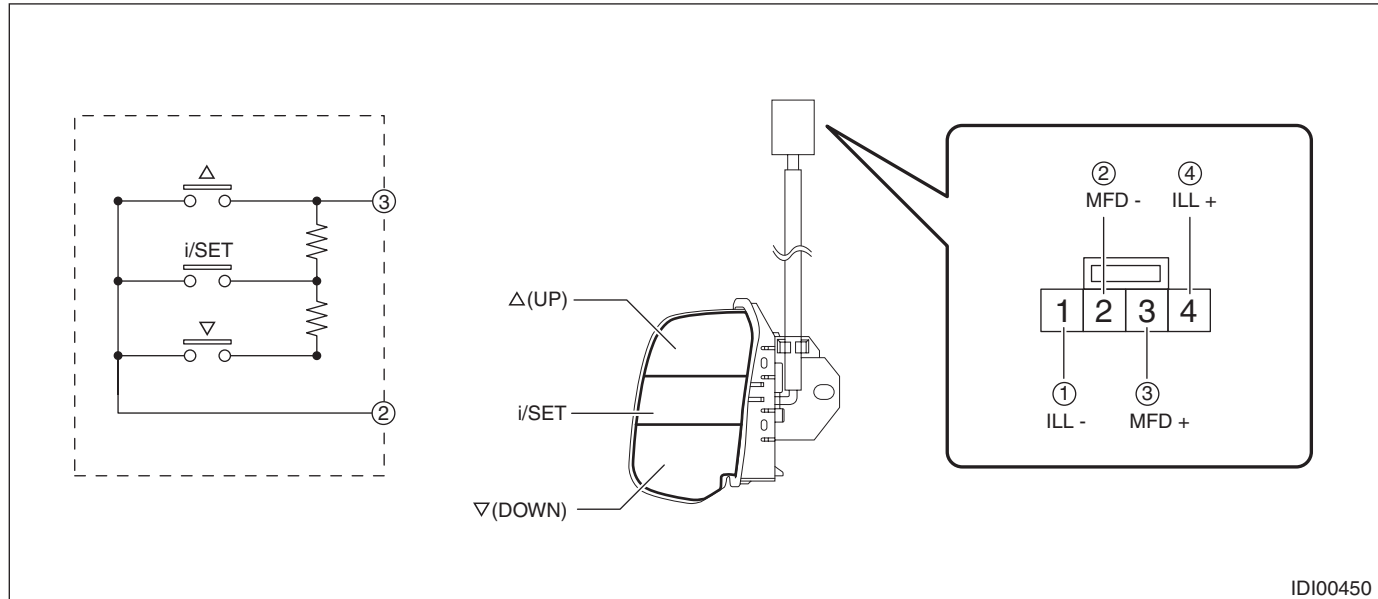

IDI00450

Terminal No.	Inspection conditions		Standard
3 — 2	Δ (UP) i/SET ▽ (DOWN)	All OFF	1 MΩ or more
3 — 2	Δ (UP)	ON	Less than 1 Ω
3 — 2	i/SET	ON	Approx. 1,000 Ω
3 — 2	▽ (DOWN)	ON	Approx. 3,670 Ω

2) Replace the switch assembly - steering if the inspection result is not within the standard.

Steering Switch

INSTRUMENTATION/DRIVER INFO

INSTRUMENTATION/DRIVER INFO (DIAGNOSTICS)

IDI(diag)

	Page
1. Basic Diagnostic Procedure	2
2. Check List for Interview	4
3. General Description	5
4. Electrical Component Location	6
5. Control Module I/O Signal	7
6. Subaru Select Monitor	10
7. Read Diagnostic Trouble Code (DTC)	14
8. Clear Memory Mode	15
9. Read Current Data	16
10. System Operation Check Mode	19
11. User Customizing	22
12. List of Diagnostic Trouble Code (DTC)	23
13. Diagnostic Procedure with Diagnostic Trouble Code (DTC)	25