

10.Rearview Mirror

A: REMOVAL

CAUTION:

Be careful not to damage the mirror surface and the glass - front window.

1) Release the claws, and then remove the cover.

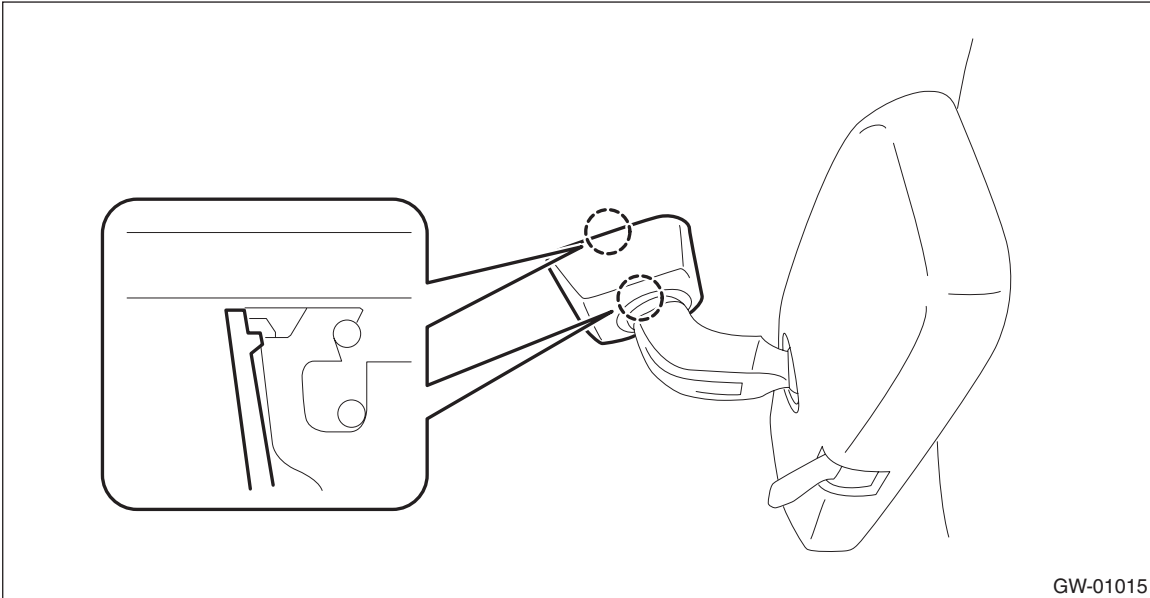

2) Release the lock lever, and slide the mirror assembly - inner rearview to remove.

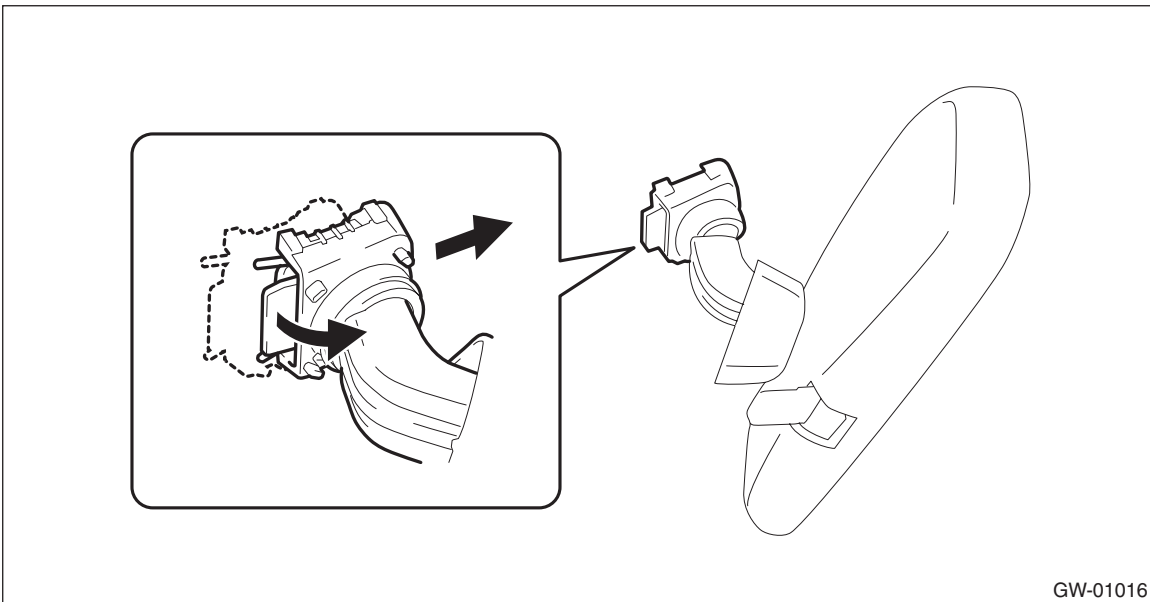

3) When the mirror mount is damaged, use something like piano wire or a spatula to remove.

B: INSTALLATION

Install each part in the reverse order of removal.

C: INSPECTION

Check the mirror and mirror mount for damage.