

9. Rear Bumper

A: REMOVAL

- 1) Disconnect the ground cable from battery.
- 2) Remove the light assembly - rear combination.

CAUTION:

Be careful not to damage the clips.

- (1) Release the bolts and clips, then pull out the light assembly - rear combination to the vehicle rear.
- (2) Disconnect the connector and remove the light assembly - rear combination.

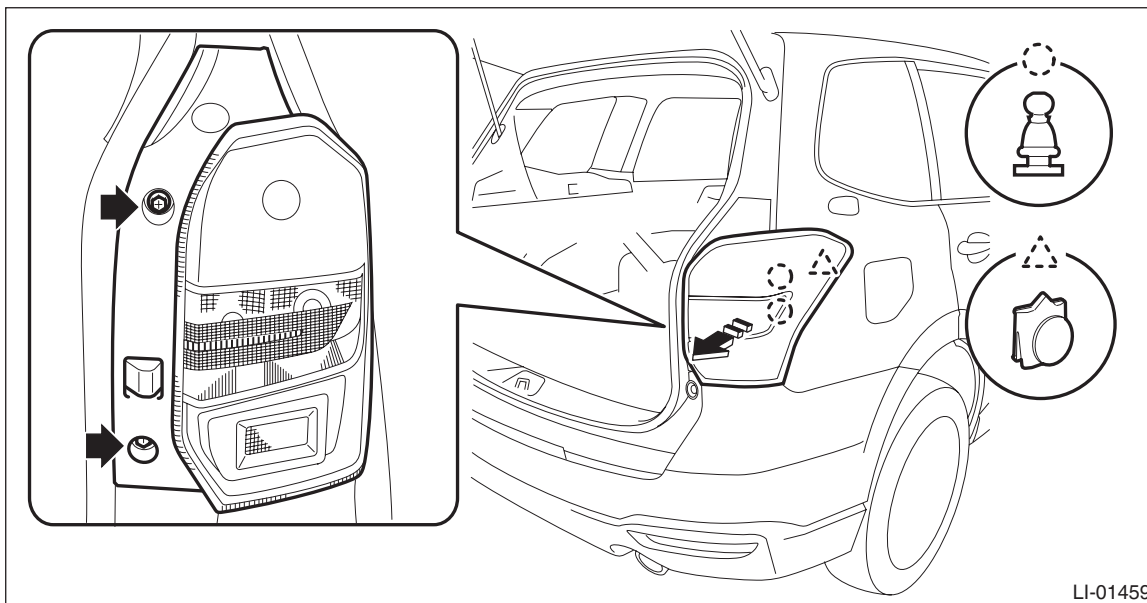

- 3) Remove the bumper face - rear.

- (1) Remove the clips inside the wheel housing.
- (2) Remove the clips at the lower side of the bumper face - rear.

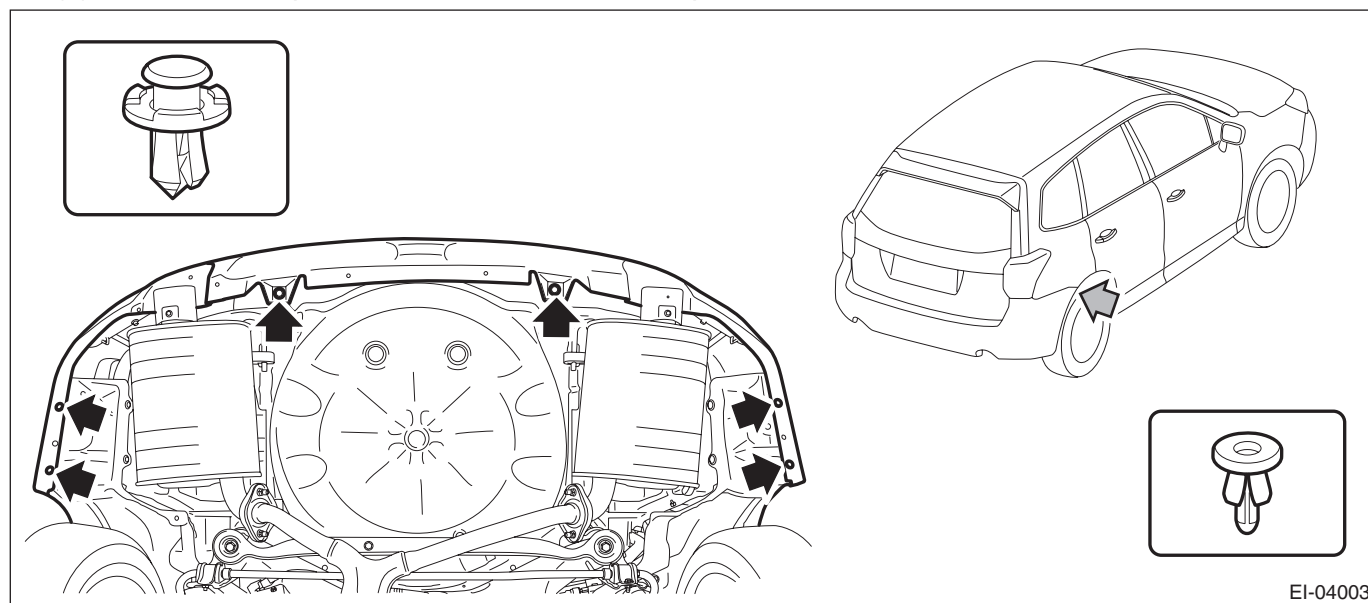

- (3) Detach (b) and (c) while pulling up (a) of the bumper face - rear.
- (4) Detach (e) while pulling up (d) of the bumper face - rear.
- (5) Detach the opposite side in the same manner.
- (6) Detach in order from (f) to (h) while pulling up the center part of the bumper face - rear.

CAUTION:

Pulling with excessive force may damage the bracket.

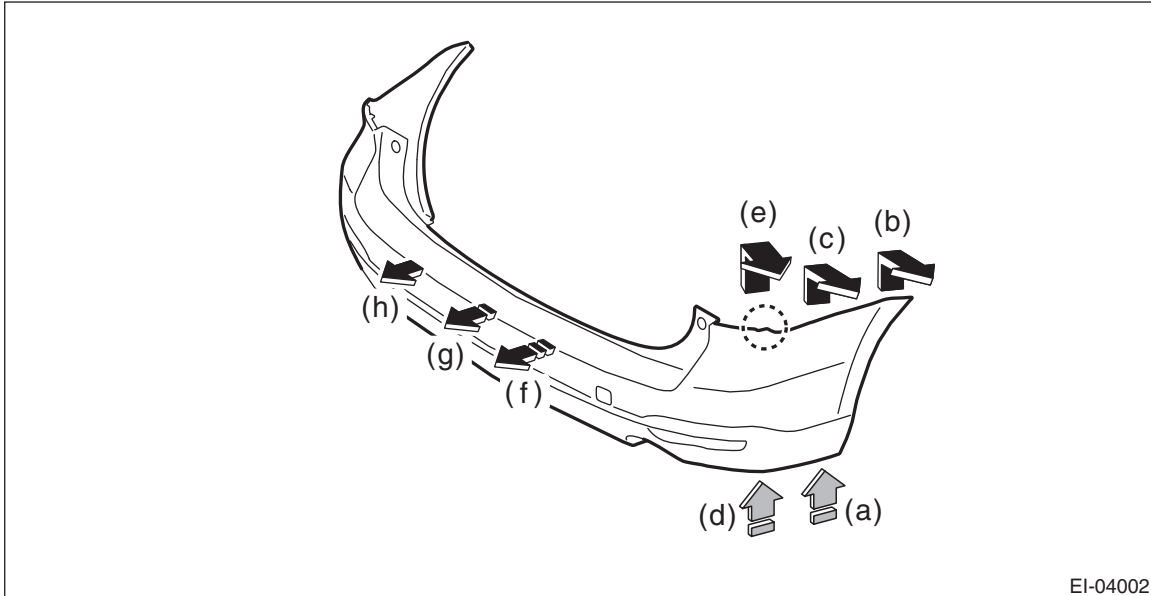

EI-04002

- 4) Remove the bolts and nuts, and remove the bumper beam COMPL - rear.

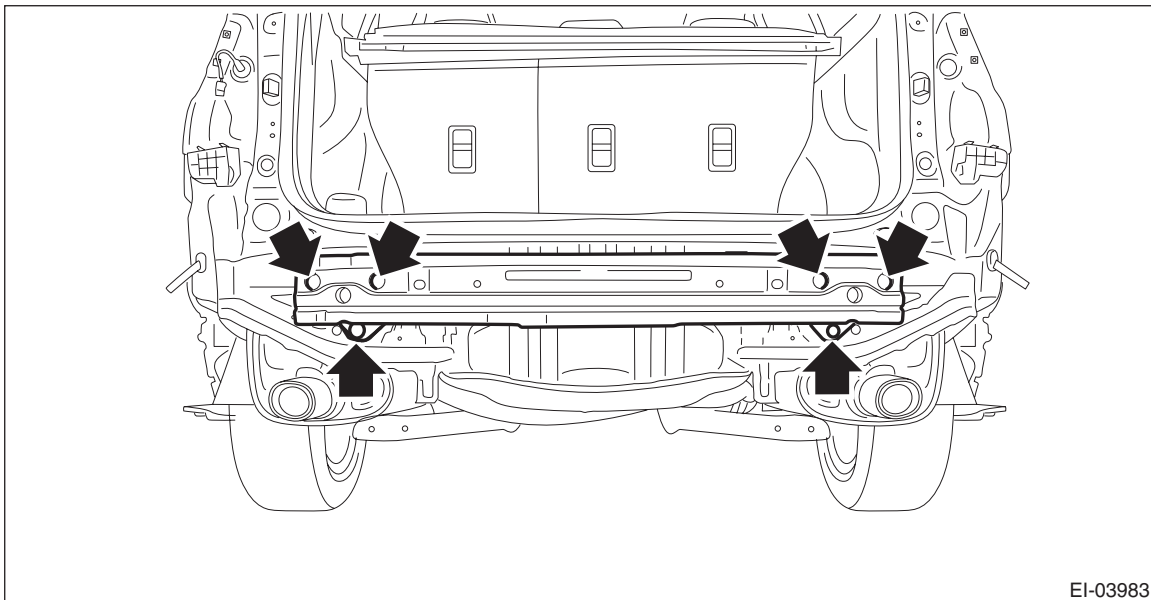

EI-03983

NOTE:

After all nuts are removed, raise the bumper beam COMPL - rear a little to remove it from vehicle body.

- 5) Remove bumper brackets.

CAUTION:

Do not reuse the removed bracket - rear bumper side. This may cause water leakage on the body panel.

- (1) Remove the screws.

Rear Bumper

EXTERIOR/INTERIOR TRIM

- (2) Turn over the trim panel - rear apron, and detach the claw of the clip from the back side.

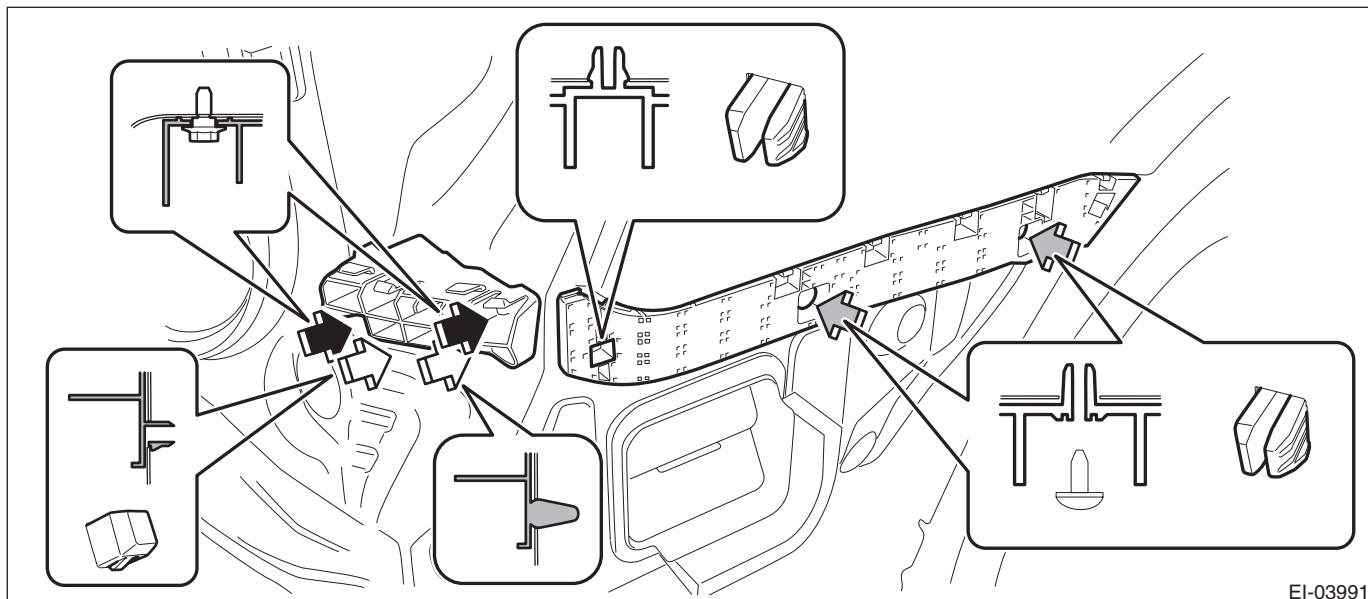

- 6) From behind the bumper face - rear, release the nuts and claws and remove the reflex reflector assembly.

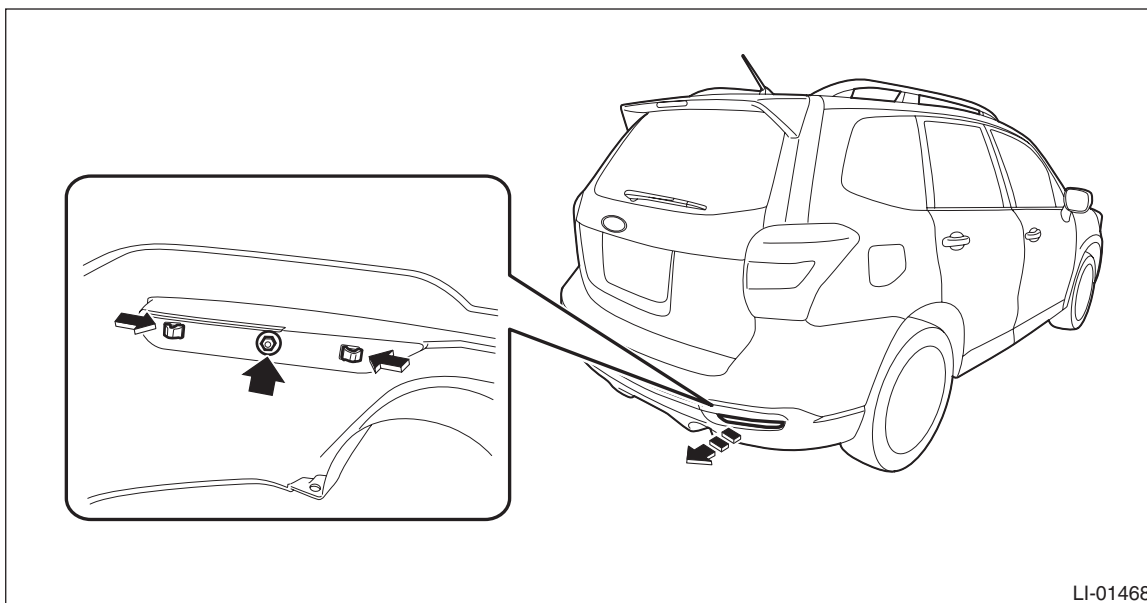

B: INSTALLATION

Install each part in the reverse order of removal.

CAUTION:

Do not reuse the removed bracket - rear bumper side. This may cause water leakage on the body panel.

NOTE:

If the bumper face - rear comes off too easily, adjust the hook of the bracket side.

Tightening torque:

Refer to "COMPONENT" of "General Description".<Ref. to EI-6, REAR BUMPER, COMPONENT, General Description.>

Light assembly - rear combination: 7.5 N·m (0.76 kgf-m, 5.5 ft-lb)

C: REPAIR

Refer to the description for front bumper repair. <Ref. to EI-37, REPAIR, Front Bumper.>