

## 3. Mud Guard

### A: REMOVAL

- 1) Lift up the vehicle.
- 2) Remove the wheels.
- 3) Remove the screws and clips to remove the mud guard.

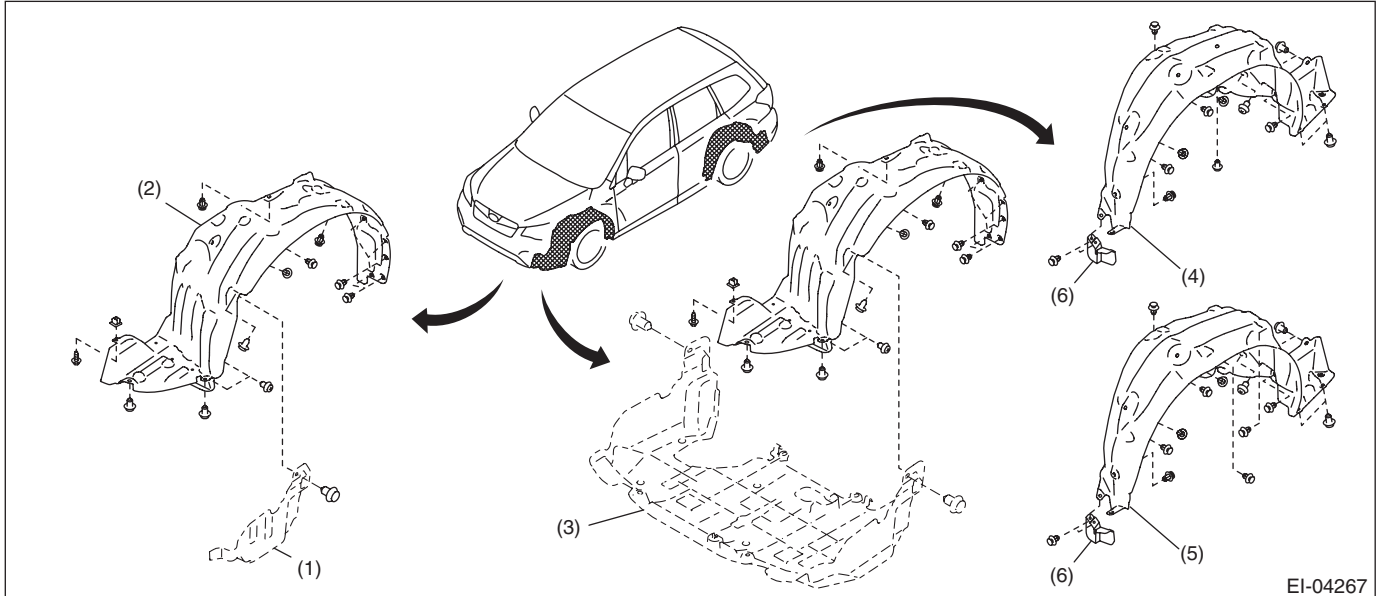

EI-04267

- |                                                   |                                              |                           |
|---------------------------------------------------|----------------------------------------------|---------------------------|
| (1) Under cover COMPL - front LH<br>(turbo model) | (3) Under cover - front (non-turbo<br>model) | (5) Mud guard - rear LH   |
| (2) Mud guard - front                             | (4) Mud guard - rear RH                      | (6) Plate - air flap rear |

### B: INSTALLATION

Install each part in the reverse order of removal.

#### **Tightening torque:**

**Wheel nut: 120 N·m (12.24 kgf-m, 88.5 ft-lb)**