

## 23.Rear Quarter Trim

### A: REMOVAL

#### CAUTION:

- Airbag system satellite safing sensor is located in the lower of the rear seat cushion center. Before removing the rear seat, refer to “CAUTION” of “General Description” in “AIRBAG SYSTEM” section.<Ref. to AB-9, CAUTION, General Description.>
- The airbag system is fitted with a backup power supply. After disconnecting the battery ground cable, the airbag may operate if you do not wait for 60 seconds before starting the service of airbag system.

- 1) Disconnect the ground cable from battery and wait for at least 60 seconds before starting work.
- 2) Remove the rear seat cushion assembly.
  - (1) Push the corners of the rear seat cushion from above.
  - (2) While pushing the corners of the rear seat cushion from above, pull the knob of the hook - seat cushion rear towards yourself.
  - (3) While pulling the knob towards yourself, disconnect the hooks by lifting up the rear seat cushion.

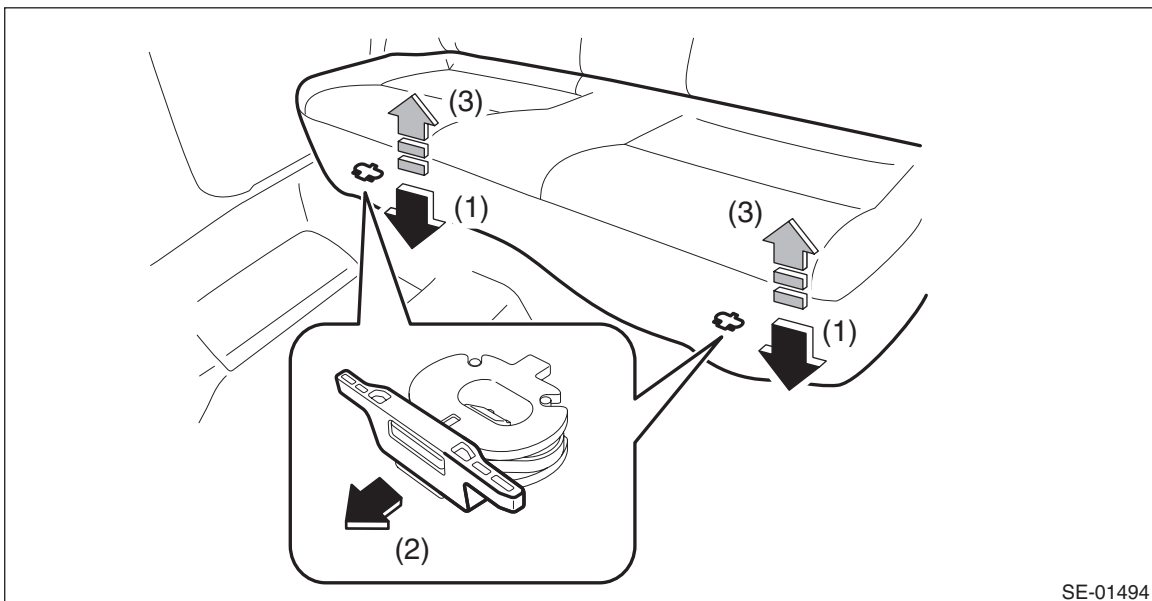

- (4) Remove the hook (A) by pushing it back while lifting the front side of the rear seat cushion, and remove the rear seat cushion.

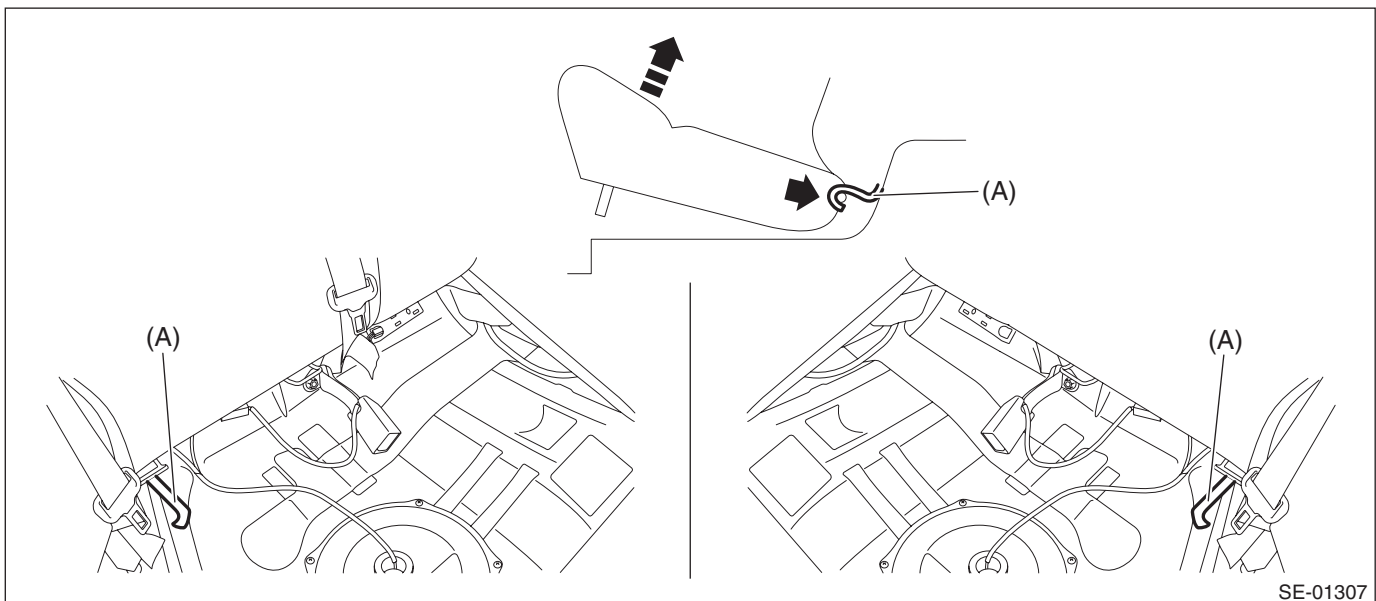

3) Release the clips and claws, and then remove the cover side sill - rear INN.

**CAUTION:**

**Do not pull with excessive force. Doing so may damage the claws of the cover side sill - rear INN.**

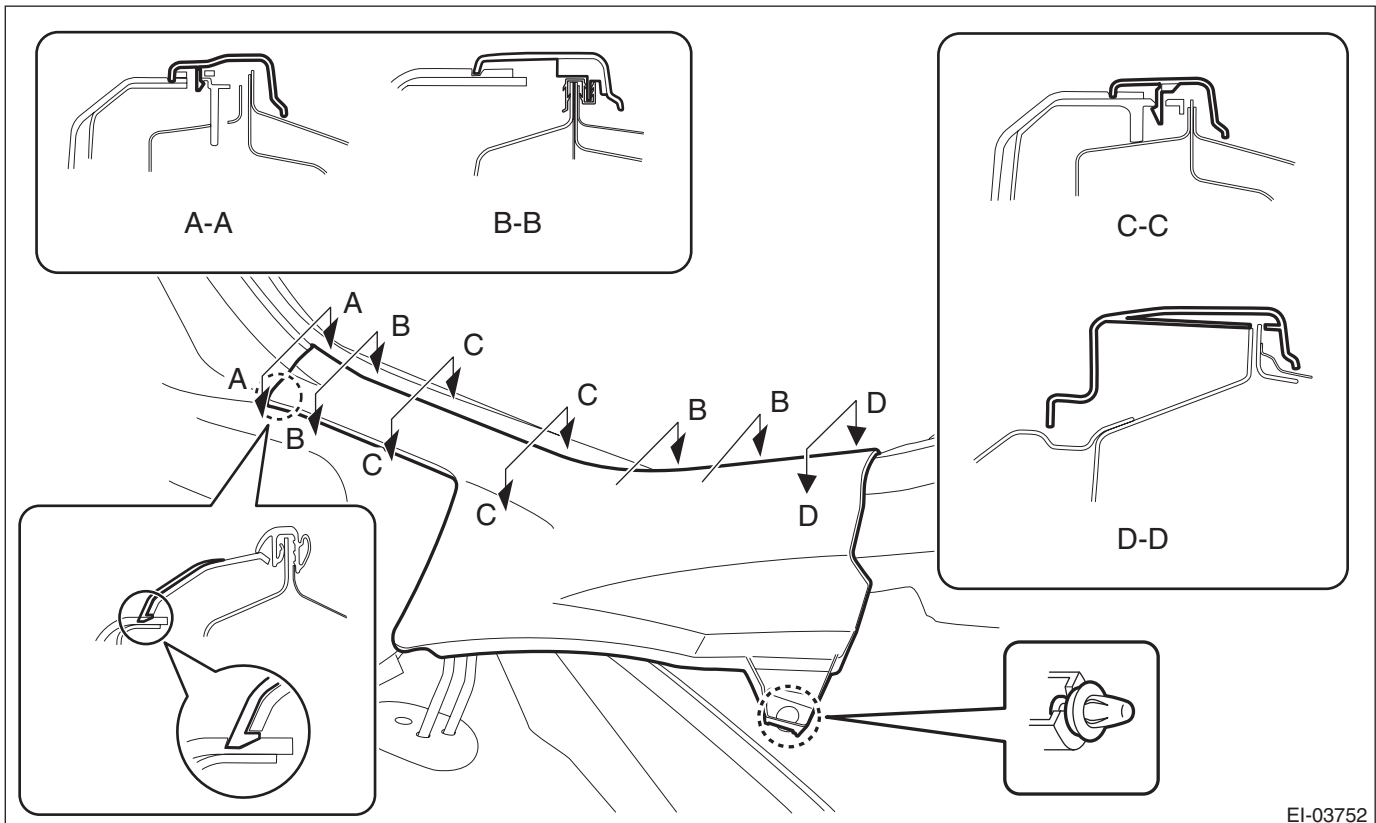

EI-03752

4) Remove the mat - rear floor, spacer - rear floor, and cover - trunk.

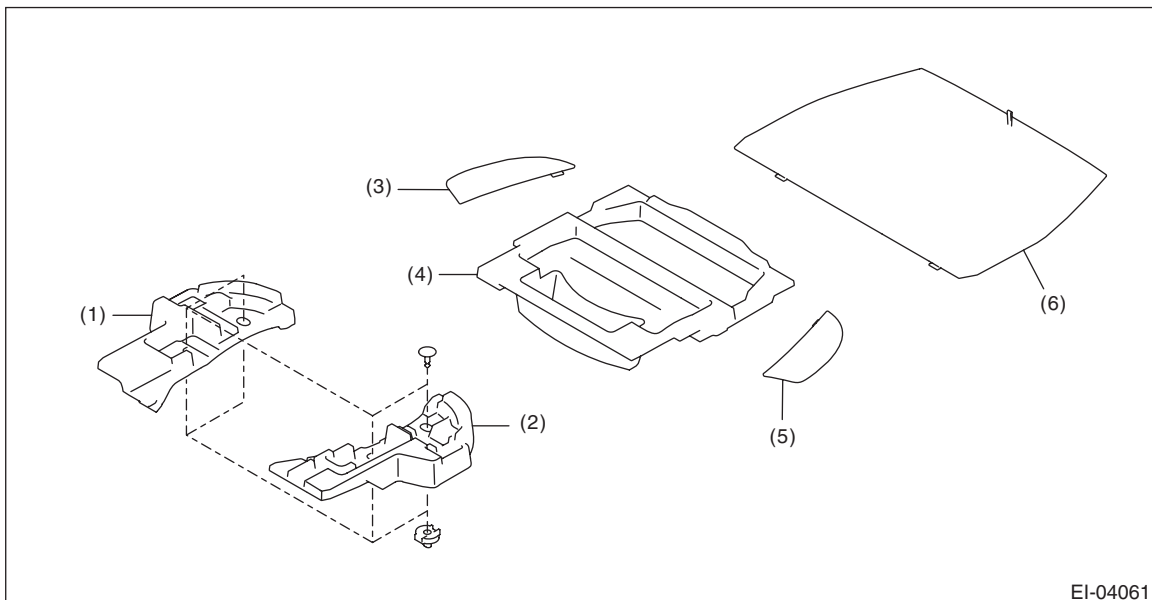

EI-04061

- (1) Spacer - rear floor side RH
- (2) Spacer - rear floor side LH

- (3) Mat - rear floor RH
- (4) Cover - trunk

- (5) Mat - rear floor LH
- (6) Mat - rear floor CTR

## Rear Quarter Trim

### EXTERIOR/INTERIOR TRIM

5) Remove the clips, and remove the trim panel - rear skirt.

#### CAUTION:

Do not lift the trim panel - rear skirt from the edge. Doing so may damage the part.

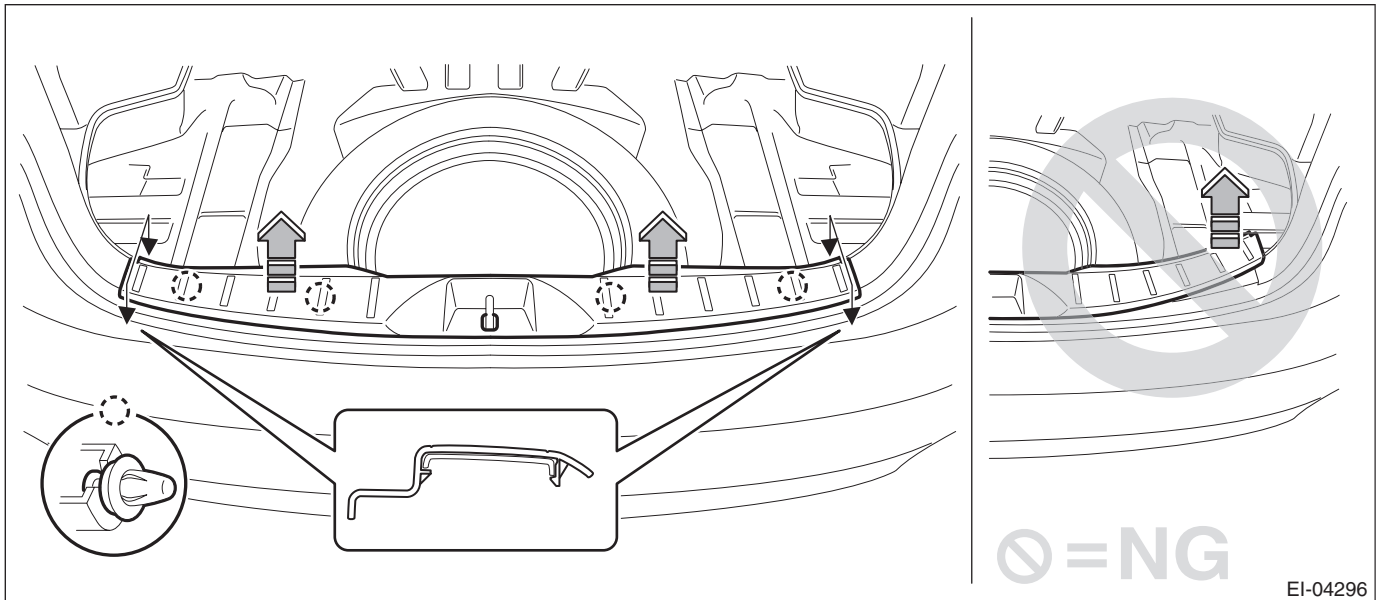

6) Remove the trim panel - rear apron.

- (1) Open the cover, remove the bolts, and remove the hook - luggage. (2 places)
- (2) Remove the screws, and release the clips.
- (3) Disconnect the connectors and remove the trim panel - rear apron.

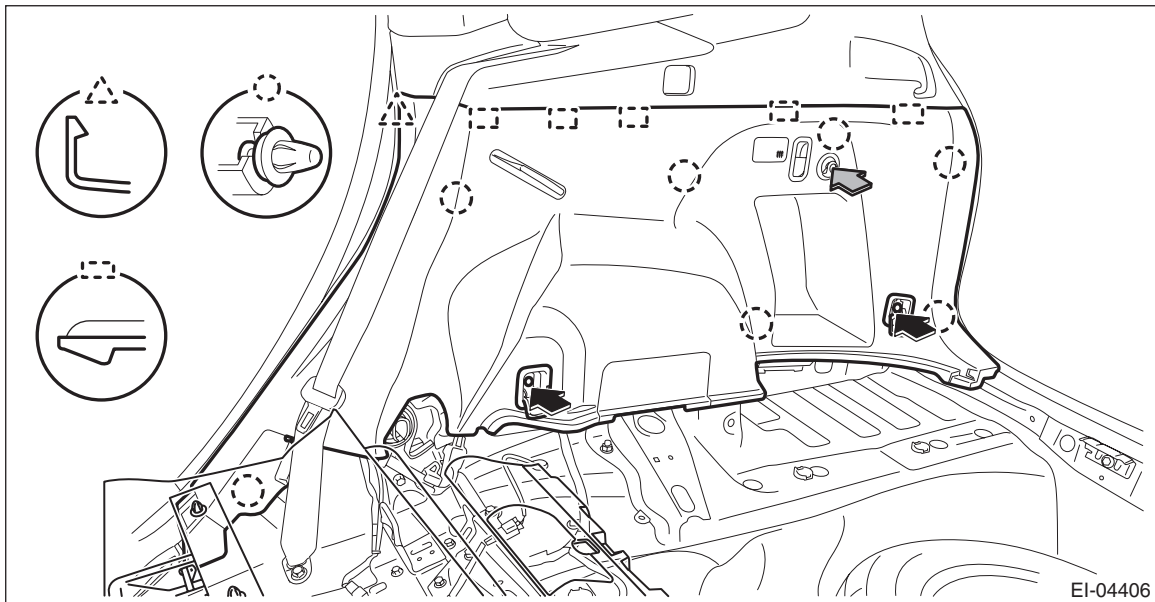

7) Remove the trim panel - rear quarter pillar UPR.

- (1) Disconnect the rod - power rear gate before removing the trim panel - rear quarter pillar UPR LH.  
(Only for models with power rear gate)

**CAUTION:**

For the disconnection procedure of the rod - power rear gate, refer to “REMOVAL”, “Power Rear Gate Rod” in the “POWER REAR GATE” section and observe the precautions for removal.<Ref. to PRG-15, REMOVAL, Power Rear Gate Rod.>

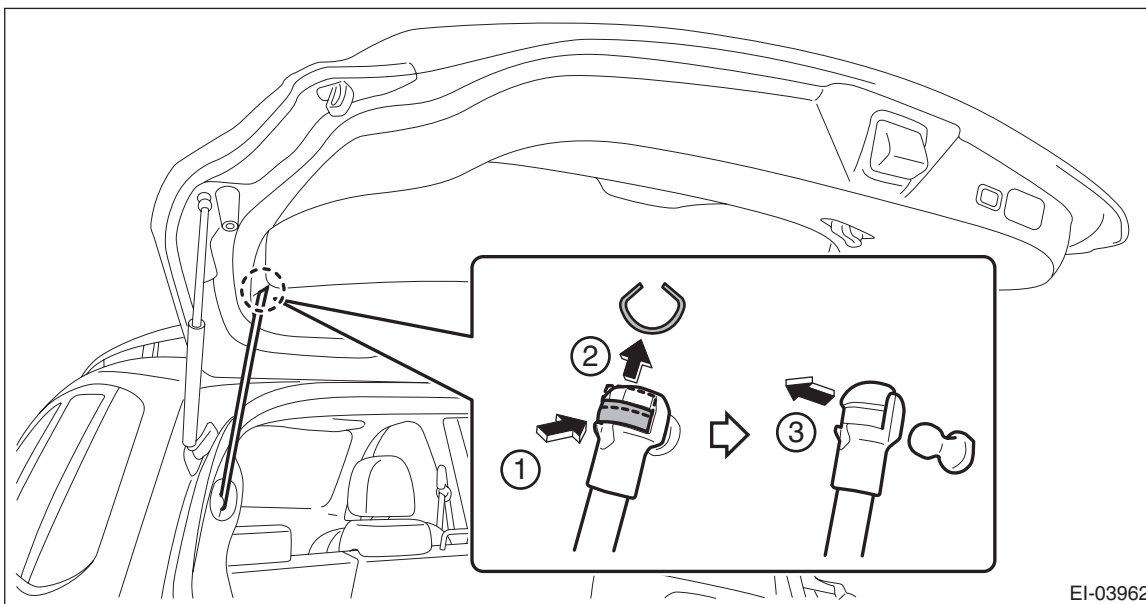

(2) Remove the lower anchor bolts of rear seat belts.

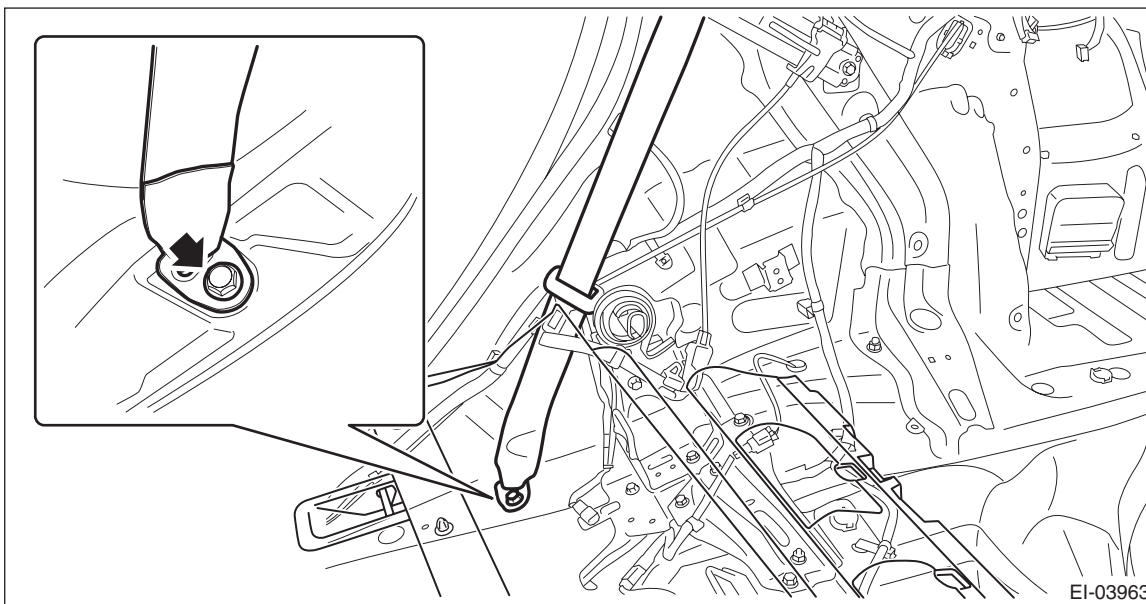

## Rear Quarter Trim

### EXTERIOR/INTERIOR TRIM

- (3) Remove the screws and clips, and remove the trim panel - rear quarter pillar UPR.

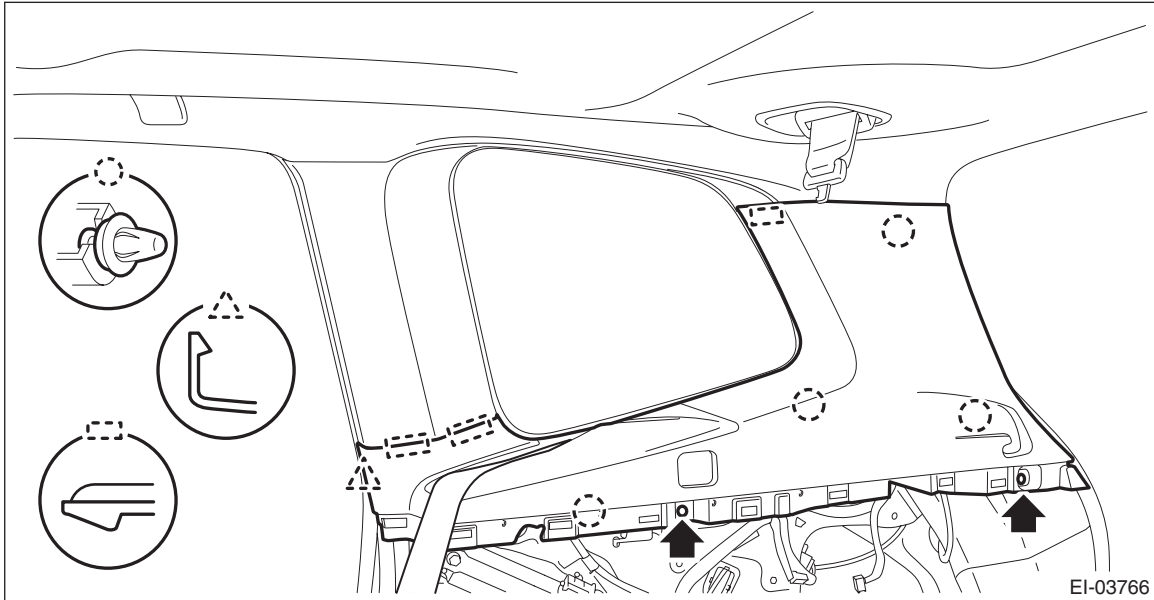

- 8) Release the clips, and remove the trim panel - rear pillar UPR.

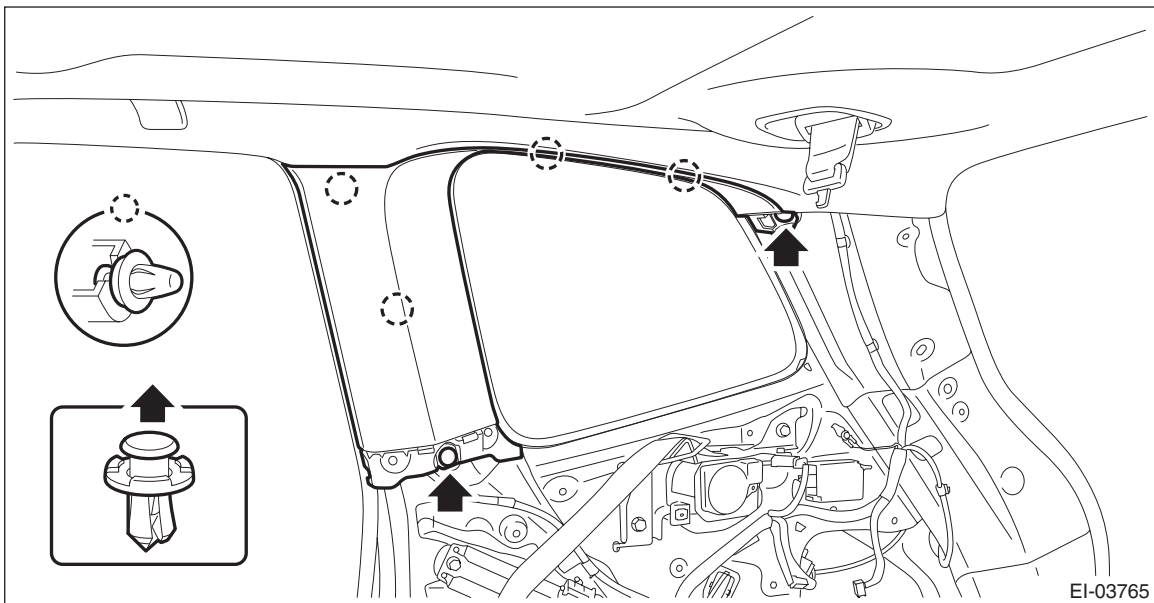

## B: INSTALLATION

### CAUTION:

For installation of the rod - power rear gate, refer to "INSTALLATION", "Power Rear Gate Rod" in the "POWER REAR GATE" section and observe the precautions for installation. <Ref. to PRG-16, INSTALLATION, Power Rear Gate Rod.>

Install each part in the reverse order of removal.

### Tightening torque:

*Rear seat belt lower anchor: 30 N·m (3.06 kgf-m, 22.1 ft-lb)*

*Trim panel - rear apron: 7.5 N·m (0.76 kgf-m, 5.5 ft-lb)*