

## 2. Front Under Cover

### A: REMOVAL

- 1) Lift up the vehicle.
- 2) Remove the bolts and clips, and remove the under cover - front.

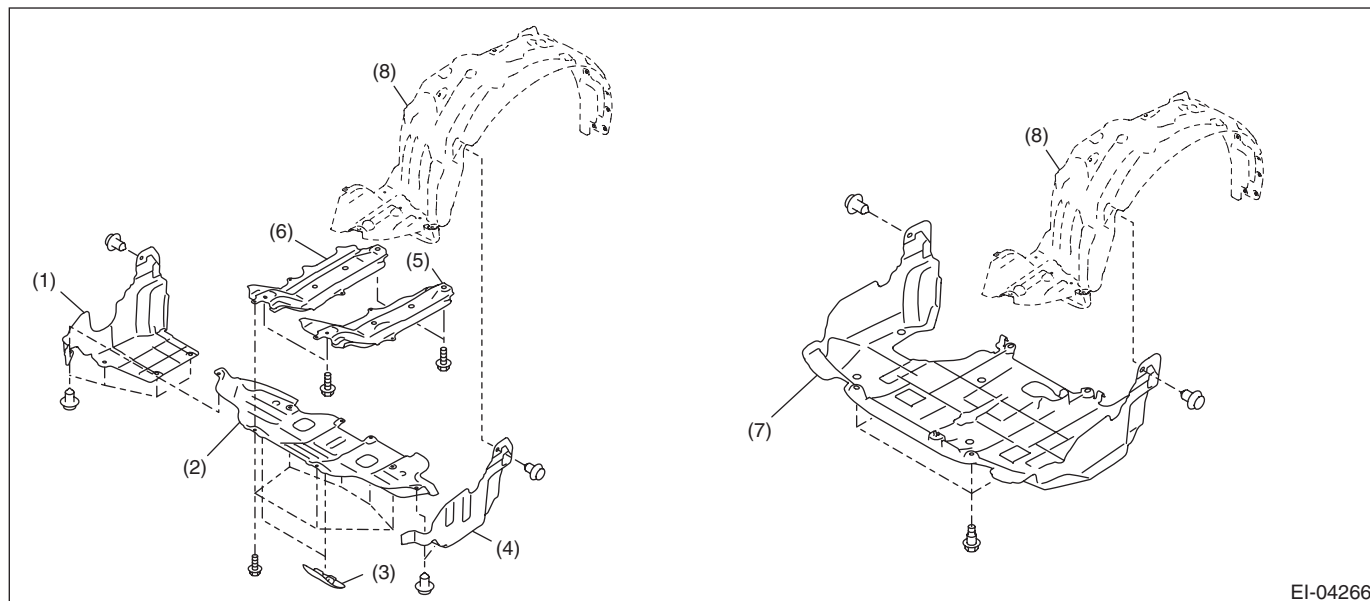

EI-04266

- |  |  |   |
|--|--|---|
| (1) Under cover COMPL - front RH (turbo model) | (4) Under cover COMPL - front LH (turbo model) | (7) Under cover - front (non-turbo model) |
| (2) Plate CTR - aluminum (turbo model)         | (5) Under cover - front guard LH (turbo model) | (8) Mud guard - front                     |
| (3) Cover - plate (turbo model)                | (6) Under cover - front guard RH (turbo model) |   |

### B: INSTALLATION

Install each part in the reverse order of removal.

#### **Tightening torque:**

**Refer to "COMPONENT" of "General Description".<Ref. to EI-2, FRONT UNDER COVER, COMPONENT, General Description.>**