

### 3. Front Fender

#### A: REMOVAL

- 1) Disconnect the ground cable from battery.
- 2) Remove the bumper face - front.
  - (1) Remove the clips, and turn over the mud guard - front, and then disconnect the connectors of the fog light assembly - front on the LH and RH sides. (Model with fog light)

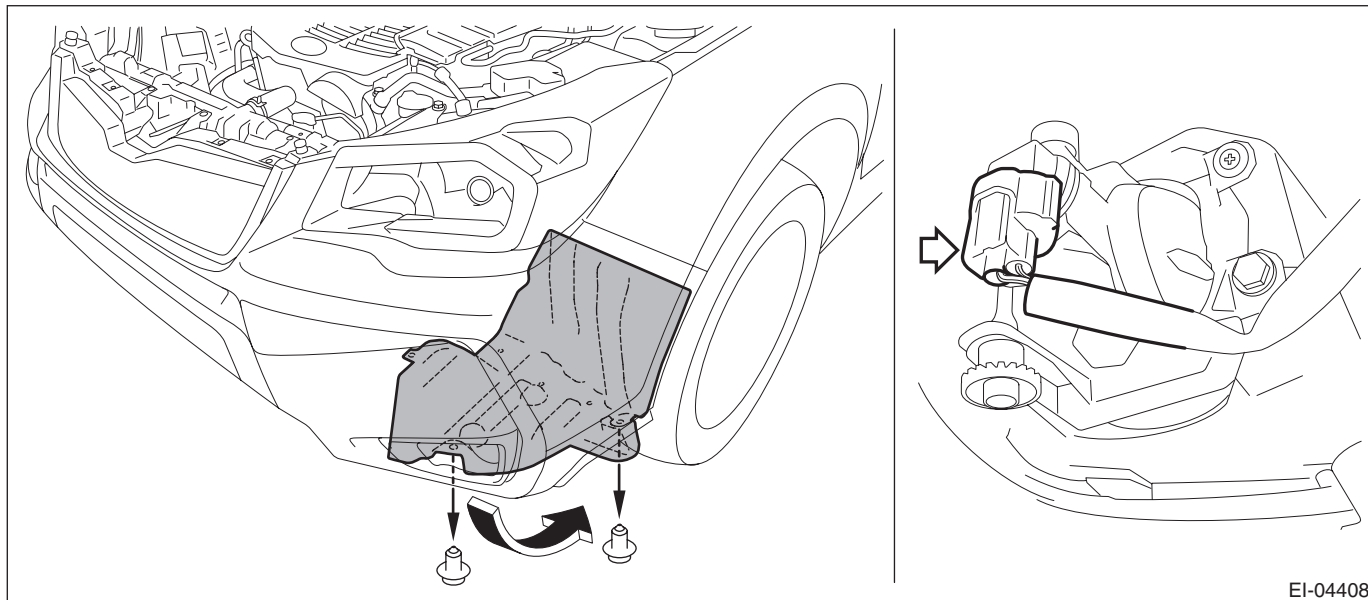

EI-04408

- (2) Remove the clips at the upper side of the bumper face - front.
- (3) Remove the clips from the fender.
- (4) Remove the clips at the lower side of the bumper face - front.

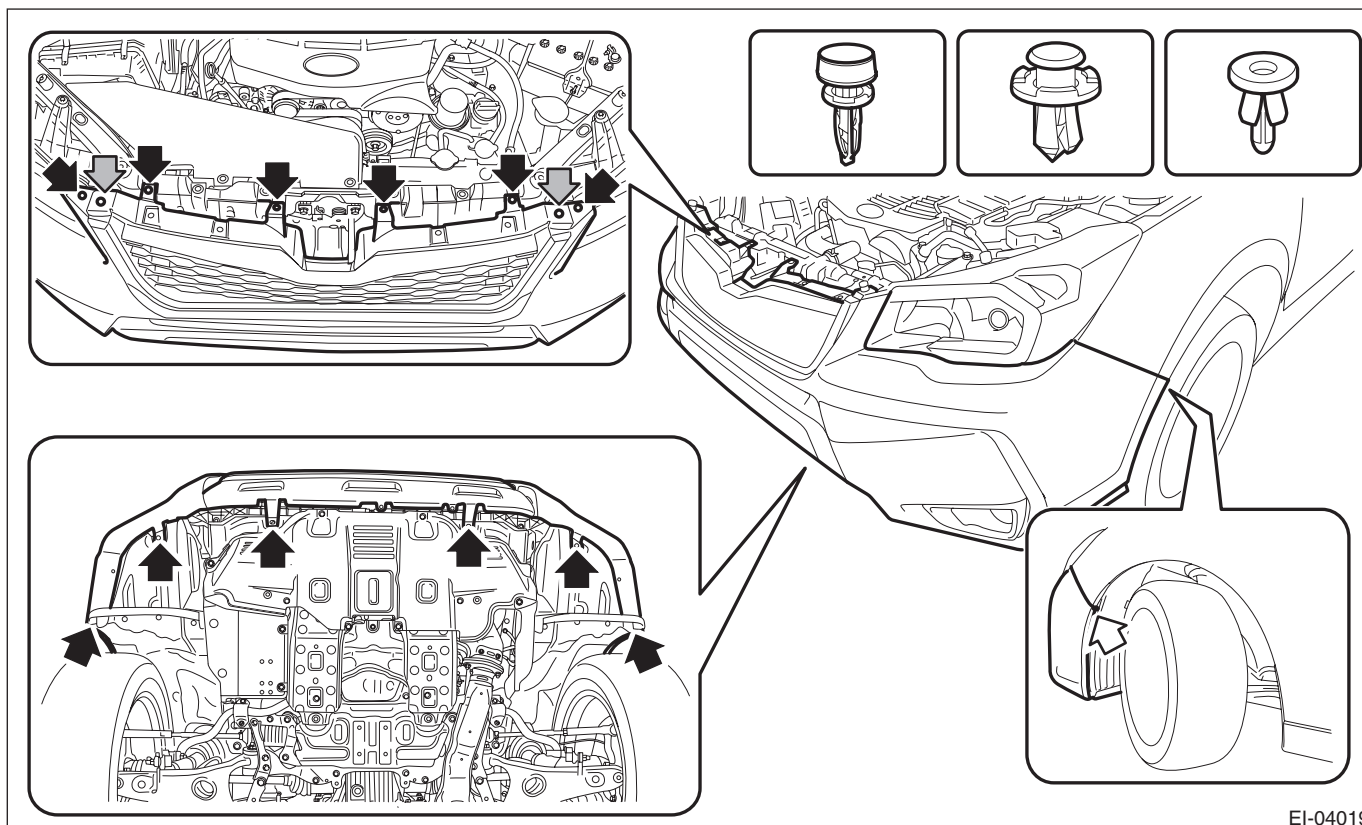

EI-04019

## Front Fender

### EXTERIOR BODY PANELS

- (5) Apply protective tape (A) to the light assembly - head.
- (6) Release the clips, and while pushing up the lower side (a) of the bumper face - front, remove in the order from (b) to (e).

#### CAUTION:

Do not pull forcibly. It may damage the flange sections of the bumper face - front.

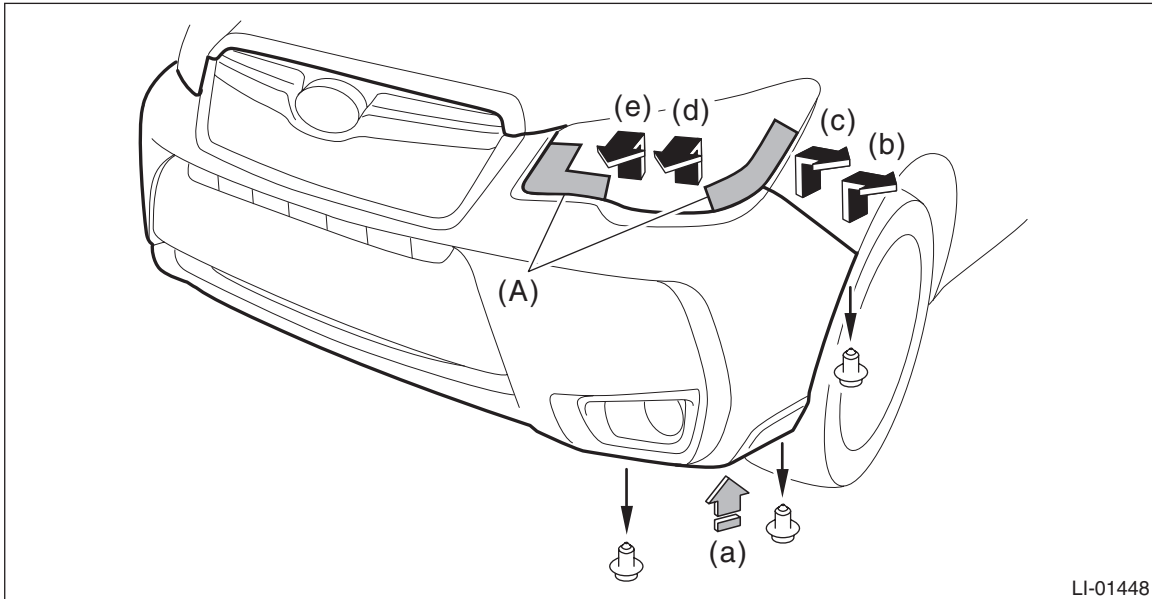

#### NOTE:

Detach the opposite side in the same manner.

#### 3) Remove the cover - front fender.

- (1) Remove the clip.
- (2) Release the claws by pulling them forward, and remove the cover - front fender.

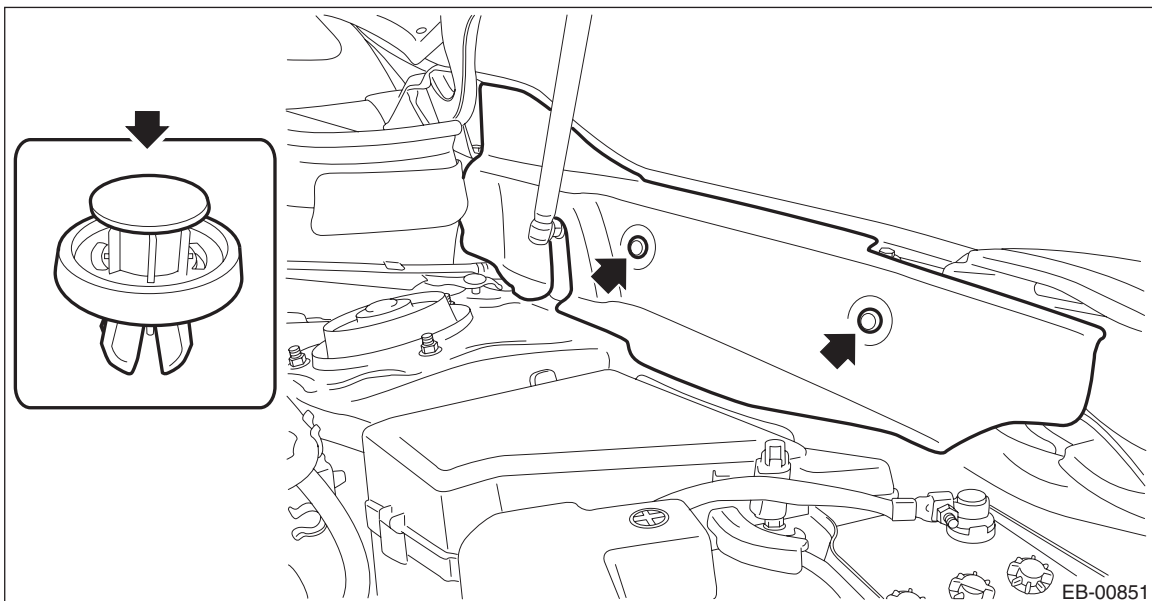

- (3) Remove the light assembly - head.<Ref. to LI-27, WHEN REMOVING RH SIDE, REMOVAL, Head-light Assembly.>

4) Remove the clips, and turn over the mud guard - front (a).

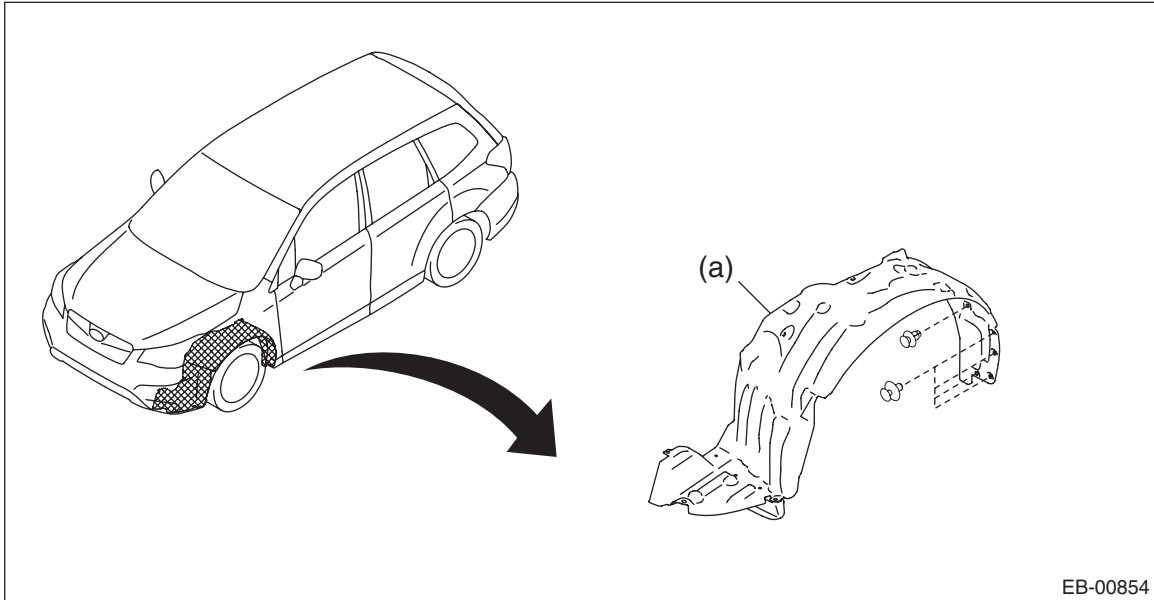

5) Remove the clips and remove the garnish assembly - fender.

**NOTE:**

- Forcibly removing the garnish assembly - fender may damage the clips.
- For easy removal of the clips, pinch the claw from the backside of fender COMPL - front with pliers, etc.

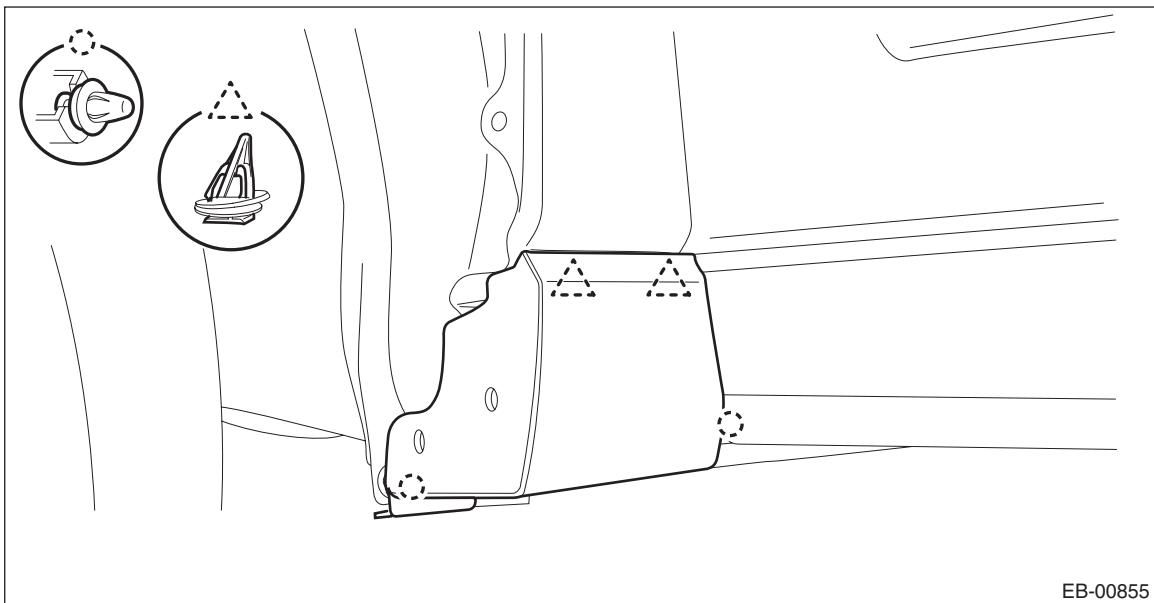

## Front Fender

### EXTERIOR BODY PANELS

---

- 6) Remove the clips, and remove the cover - front pillar assembly.

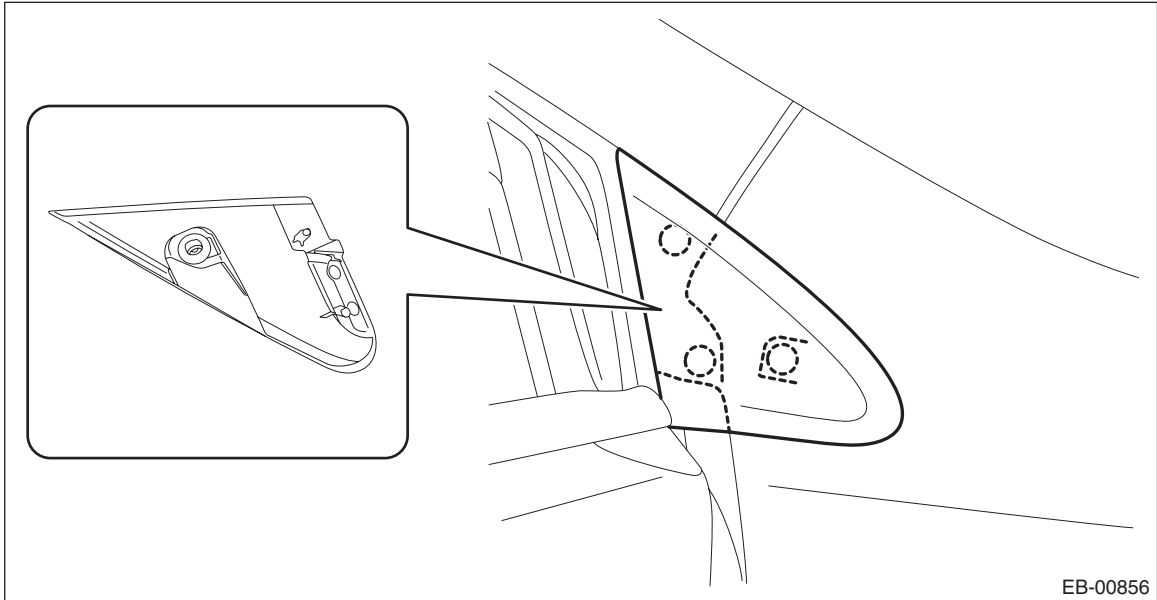

- 7) Remove the fender COMPL - front.

- (1) Remove the bolts and nuts, and remove the fender COMPL - front.

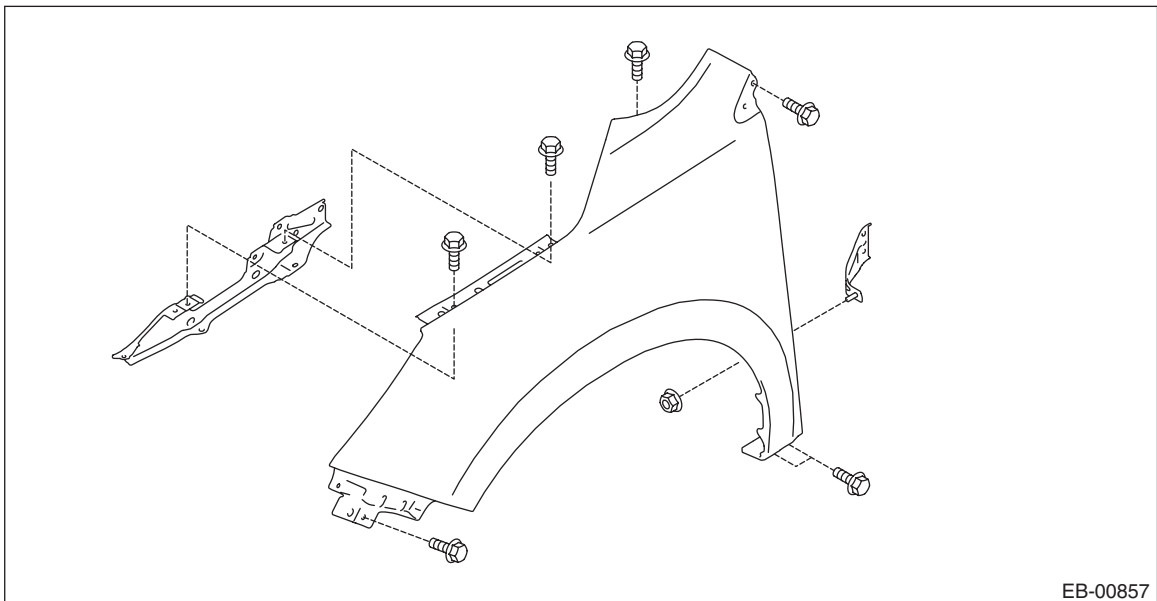

## B: INSTALLATION

1) Install each part in the reverse order of removal.

### CAUTION:

**After installing the fender COMPL - front, be sure to perform headlight beam adjustment.**

### *Tightening torque:*

***Fender COMPL - front: 5.5 N·m (0.56 kgf-m, 4.1 ft-lb)***

***Light assembly - head: 7.5 N·m (0.76 kgf-m, 5.5 ft-lb)***

### NOTE:

When installing the fender COMPL - front, make sure that a uniform clearance is created around it.

- Fender COMPL - front to Hood COMPL - front:<Ref. to EB-19, ADJUSTMENT, Front Hood.>
- Fender COMPL - front to Panel assembly - front door:<Ref. to EB-33, ADJUSTMENT, Front Door.>

2) Adjust the headlight beam and fog light beam.

- Adjust the headlight beam.<Ref. to LI-32, HEADLIGHT BEAM ADJUSTMENT, ADJUSTMENT, Headlight Assembly.>
- Adjust the fog light beam. (Model with fog light)<Ref. to LI-47, FOG LIGHT AIMING, ADJUSTMENT, Front Fog Light Assembly.>